

*File under: Nat'l Bank
DuBois*

COMMONWEALTH OF PENNSYLVANIA
DEPARTMENT OF MINES

Oil and Gas Division
HARRISBURG

033-20333

QUADRANGLE: Penfield 7 1/2' 15' PERMIT NO. 033-333
 MAP REFERENCE: 9S 17W S63 W17 & 118 KIND OF WELL: GAS
 (Oil, Gas, Other)

WELL RECORD

COMPANY:	New York State Natural Gas Corporation	Size of Casing and Tubing	Used in Drilling	Left in Well	Packers: Type, Size and Depth
ADDRESS:	2 Gateway Center, Pgh. 22, Penna.	13 3/8"	96'	96'	
FARM #	H. E. Ginter Est. ACRES 172	9 5/8"	1285'	1285'	BHS @ 1287
WELL (FARM) NO.	1 CO. SERIAL NO. N-796	7"	7335'	7335'	BHS @ 7267
ELEVATION:	1642.34 LEASE: 60986				
TOWNSHIP:	Brady COUNTY: Clearfield				
DRILLING COMMENCED:	12-1-60 DRILLING COMPLETED: 12-23-60				
PRODUCTION:	10,504,000 cubic feet				PERFORATIONS AT:
ROCK PRESSURE:	2340 psig 70 hrs.				
WELL TREATMENT:	(Shooting, Acidizing, Fracturing Etc.)				
12-22-60-Fractured w/20,000 gals. water, 200 lb. gel, 1,000 gal acid and 20,000 lb sand. Break-down pressure 3000 lbs; maximum pressure 3750 lbs					
Original open flow of 48,000 cubic ft. in chert and 25,000 cubic ft. in Oriskany increased to 10,405,000 cubic ft. A/F. R.P. b/f 2450 lbs 24 1/2 hrs. dead weight.					
RESULTS AFTER TREATMENT:		CEMENTING DATA: (Size Pipe, Depth, No. Bags, Date)			
		12-3-60 - 13 3/8" cem. w/90 sax			
		12-7-60 - 9 5/8" cem. @ 1287 w/50 sax cem & 20 sax aquagel			
ROCK PRESSURE AFTER TREATMENT:		12-16-60 - 7" cem @ 7267 w/125 sax			

REMARKS: * Well Permit Request and all initial Records Referred to this Well as "DuBois Deposit National Bank Trustee Etal". They are in fact Successor Trustee Under the Henry E. Ginter Deed of Trust. In the Interest of Brevity, We have Established and are Using the Farm Name as Recorded Above.

FORMATION	TOP	BOTTOM	GAS AT	OIL AT	WATER AT (Fresh or Salt Water)	REMARKS
Surface	0	5				
Sand & shale	5	105				
Shale & Sand	105	150				
Sand & Shale	150	340				
Coal	340	345				
Sand & Shale	345	375				
Shale & Sand	375	468				
Coal	468	474			458	
Shale & Sand	474	532				
Sand & Shale	532	735				
Sand	735	785				
Sand & Shale	785	1720				
Shale & Sand	1720	2165				
Sand & Shale	2165	4310	3385-92 (Show)			
Sand & Shale	4310	5170				
Sand & Shale	5170	5405				

(Over)

FORMATION	TOP	BOTTOM	GAS AT	OIL AT	WATER AT (Fresh or Salt Water)	REMARKS
Shale & Shells	5405	6150				
Sand & Shale	6150	6425				
Shale & Shells	6425	6686				
Lime	6686	6784				
Shale & Shells	6784	7248				
Lime	7248	7266				
Chert	7266	7314	7267 & 7300			
Sand	7314	7343	7316-25			
Lime	7343					
Total Depth		7344				
<u>Sample Study</u>						
Tully	6686					
Onondaga	7248					
Chert	7266					
Oriskany	7314	7343				

DATE January 24 1961

APPROVED New York State Natural Gas Corporation OWNER

BY *H. R. Barger* TITLE
Superintendent Operations

District Central Map 9S 17W N S 63 E W 117 & 118
 Loc. Made 10/24/60 Bk. 1916 Pg. 30 El. Bk. 1916 Pg. 31
 Approved [Signature] Date October 25, 1960

Latitude 41°10'

Longitude 70°40'

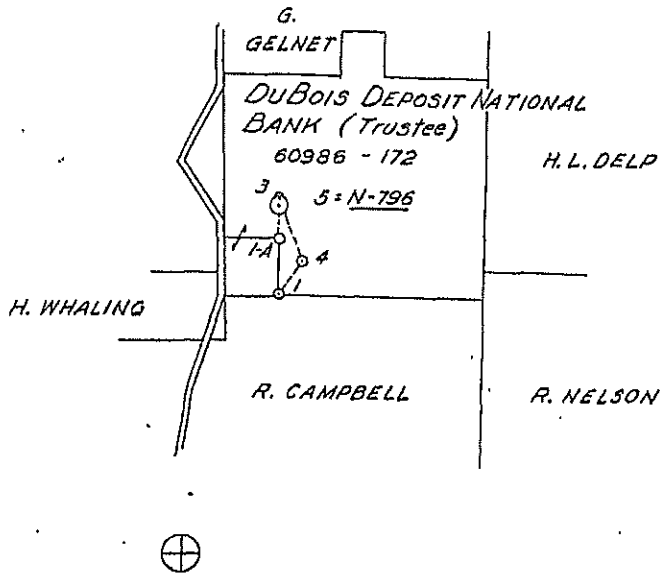

STA.	BRG.	DIST.
1-1A	N 7° 00' E	500'
1-3	N 7° 00' E	848'
3-4	S 13° 49' E	591'
4-1	S 42° 06' W	365'
3-5	S 7° 00' W	75'

- New Location
- Drill Deeper
- Abandonment
- Re-drill

Company NEW YORK STATE NATURAL GAS CORPORATION
 Address #2 Gateway Center, Pittsburgh 22, Pa.
H.E. Ginter
 Farm DuBois Deposit National Bank Trustee et al
 Tract _____ Acres 172 Lease No. 60986
 Well (Farm) No. #1 Co. Serial No. N-796
 Angle of Deviation, if any _____
 Elevation 1642.34 Quadrangle UNIONSBURG Penfield
 County Clearfield Township Brady
 Engineer R. A. Doman
 Engineer's Registration No. 14016
 File No. _____ Drawing No. _____
 Date 10/25/60 Scale 1"=1320'

COMMONWEALTH OF PENNSYLVANIA
 DEPARTMENT OF MINES

Oil and Gas Division
 HARRISBURG

WELL LOCATION MAP
 Dept. File No. 633-20332

⊕ Denotes Values of Well on United States Topographic Maps.

Scale 15' 7'

WORKABLE COAL SEAMS TO BE PENETRATED

Name of Seam Owner of Seam

Lower Kittanning	DuBois Dep. Nat. Bank Trustee, The Union Banking and Trust Co. of DuBois Penna.

COMMONWEALTH OF PENNSYLVANIA
DEPARTMENT OF ENVIRONMENTAL RESOURCES
BUREAU OF OIL AND GAS REGULATION

DE-7-TCS
CERTIFICATE OF PLUGGING WELL

DER Office Use Only

Code
Oil & Gas Inspector
Date Approved

6/17/85 JCB

DuBois Deposit Nat. Bank, Tr. for Henry Gint
 Coal Operator Owner Lessee
 DuBois, PA 15801
 Address

Coal Operator Owner Lessee
 Address

Coal Operator Owner Lessee
 Address

COMPLETE ABOVE SECTION IF APPLICABLE

Type of Well Gas - P & A
 Name of Well Operator Consolidated Gas Transmission

443 W. Main St., Clarkburg, WV 26302-2430
 Address

September 12 19 85
 Date

Brady
 Political Subdivision, Borough, City or Township
 Clearfield County

Farm DuBois Deposit National Bank

Well (Farm) No. 4 Serial No. WN-1573

We, the undersigned representatives of the Well Operator certify that we participated in the plugging of the above well, and that the work was started August 21 19 85, and that the well was plugged as follows:

FILLING MATERIAL AND PLUGS	FROM	TO	Casing and Tubing		
			SIZE	PULLED	LEFT
95 sacks Cement	3302	2215	11 3/4"	0	253
Gal	2215	1550	8 5/8"	0	1198
140 sacks Cement	1550	1085	4 1/2"	1561	1975
100' cement up inside 8 5/8" casing					
			Depth of Coal Seam, if Any		
			285-286, 323-330		
			Description of Monument		
			Standard 6' monument to be set		

I certify that the work of plugging and filling said well was completed on the 22nd day of August, 19 85 and that the above information is true and accurate.

Consolidated Gas Transmission Corporation
 (Well Operator)

PERMIT/REGISTRATION NO. GLE-20626

PROJECT NO.

John M. Love
 (Qualified Participant)
Mike G. Smith
 (Qualified Participant)
 (Qualified Participant)

One copy of this certificate to be mailed to each coal operator, lessee, or owner, if any, and one to the Bureau of Oil and Gas Management, upon completion of plugging.

246 10-2-85

RECEIVED

OCT 18 1985

PA GEOLOGICAL SURVEY
 (Oil & Gas Geology Division)

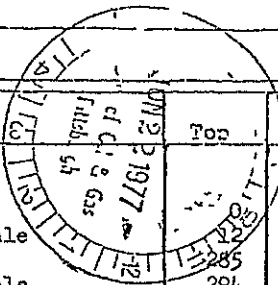

EXPLANATIONS

Name	Top	Bottom	Gas At	Oil At	With Al (Fresh or salt water)	Source of Data
Clay		12				
Sand & Shale		285				
Coal	285	294				
Sand & Shale	294	323				
Coal	323	330			FW-330	2" stream
Sand & Shale	330	1500				
Red Rock	1500	1550				
Shale	1550	1620				
Red Rock	1620	1825				
Sand & Shale	1825	3390				
Sand	3390	3410	3395 (show)			
Shale	3410	3550				
Total Depth	3550 K.B.					
<u>Gamma Ray Log Tops</u>						
Speechley Stray	2537	2576				
Speechley	2599	2676				
Tiona	2680	2710				
Balltown	2747	2823				
Sheffield	2897	2941				
1st. Brad.	3049	3137				
2nd. Brad.	3149	3221				
3rd. Brad.	3245	3262				
Kane	3390	3442				
T. D. Log	3547					

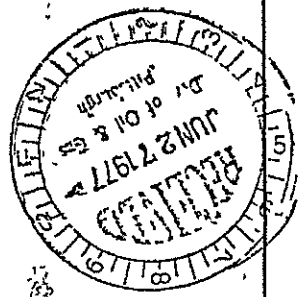

Date June 20, 1977

Approved Consolidated Gas Supply Corp. Operator

By J. E. Dwyer, Mer. of Production

Table

10,250

Latitude 41°-07'-35"

District CENTRAL Map SE 17N R 25E T 11N
Leas. Made 1-20-82 No. 2572 Pg. 15 of 15 Br. 2572 Pg. 15

Approved _____ Date _____

"A" = NE COR. QU. 3015 DEPOSIT NAT. BANK
"B" = SE COR. 100th TR.
A-B SOUTH-1351'
A-WN-1573 SUR. 2572 N-553'
S-WN-1573 SUR. 2572 W-1431'

NOTE: A. SEAM NOT SUBJECT TO PROPERTY DESCRIPTION

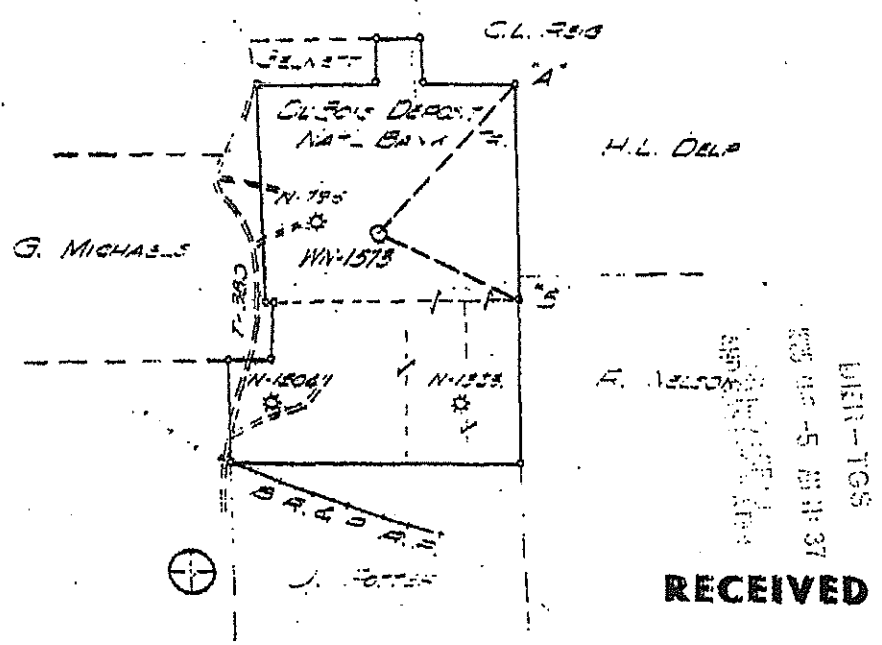

Longitude 75°-51'-30"

14,375

- New Location
- Drill Deeper
- Abandonment
- Repairs

RECEIVED

OCT 12 1985

PA GEOLOGICAL SURVEY
(Oil & Gas Geology Division)

Company CONSOLIDATED GAS SUPPLY CORP.
 Address 445 W. MAIN ST. CLARKSBURG, W. VA.
 Farm CULBOS DEPOSIT NATIONAL BANK
 Tract _____ Acres 175² Leas. No. 52985
 Well (Farm) No. _____ Co. Serial No. W1-573
 Angle of Deviation, if any _____
 Elevation 1561' Quadrangle 2572
 County BRADY Township BRADY
 Engineer Charles C. Kopp
 Engineer's Registration No. 010261-E
 File No. _____ Drawing No. 15577ANS
 Date JAN 27, 1977 Scale 1" = 1350'

COMMONWEALTH OF PENNSYLVANIA
DEPARTMENT OF MINES
Oil and Gas Division
HARRISBURG

WELL LOCATION MAP
Dept. File No. 416-20626
37-033-20626-A

⊕ Denotes Values of Well on United States Topographic Maps.
Scale 15' 7 1/2'

WORKABLE COAL SEAMS TO BE PENETRATED

Name of Seam	Owner of Seam
<u>AL SEAM</u>	<u>Consolidated Gas Supply Corp.</u>
<u>W. SEAM</u>	<u>Consolidated Gas Supply Corp.</u>
<u>W. SEAM</u>	<u>Consolidated Gas Supply Corp.</u>

7350

66

FORMATIONS

Name	Top	Bottom	Gas At	Oil At	Water At (Fresh or Salt Water)	Source of Data
Clay	0	20	*			
Shale	20	105				
Sand	105	175			FW-30	
Sandy Shale	175	185			FW-120	1" Stream
Shale	185	189				
Coal	189	192				
Shale	192	270				
Coal	270	273				
Shale & Sand	273	400				
Sand	400	480				
Shale	480	530	530-620		FW-410	1" Stream
Sand	530	620	620 (Show)		FW-540	1" Stream
Shale	620	670				
Red Rock	670	680				
Sandy Shale	680	740				
Red Rock	740	755				
Sandy Shale	755	840				
Shale	840	860				
Red Rock	860	875				
Shale	875	1049				
Sandy Shale	1049	1410				
Red Rock	1410	1430				
Sandy Shale	1430	1510				
Red Rock	1510	1550				
Sandy Shale	1550	1950				
Red Rock	1950	2030				
Shale	2030	2400				
Sandy Shale	2400	2460				
Shale	2460	2700				
Sandy Shale	2700	2940	2952-			
Sand	2940	3040	2962			
Sandy Shale	3040	3150	2992-			
Sand	3150	3160	3001			
Shale	3160	3280	3282-			
Limey Sand	3280	3330	3307			
Shale	3330	3425				
Total Depth	3425					
<p style="text-align: center;">RECEIVED JAN 21 11 27 AM '75 DIV. OF OIL & GAS DEPT. OF NATURAL RESOURCES PITTSBURGH, PA. 15222</p>						
<u>Gamua Ray Log Tops</u>						
Speechley Stray	2425	2476				
Speechley	2480	2584				
Sheffield	2794	2877				
1st. Bradford	2943	3037				
2nd. Bradford	3050	3119				
3rd. Bradford	3144	3159				
Kane	3281	3345				
T.D. (Log)	3432					

* Gas at ~~(530-620)~~ No show of gas was recorded on drillers log during rotary drilling. A show of gas was evident after landing 4 1/2" casing- 84,000 cu. ft. Log evaluation indicated potential production in the intervals shown under "STimulation" record casing was perforated and these zones were fractured.

Date July 10, 19 74

Approved Consolidated Gas Supply Corp. Operator

By [Signature]
Title
Manager of Production

DM-CG-2-56

9,400'

District CENTRAL Map 25 17W N 563 E W 117
 Loc. Made 4/22/74 Bk. 3225 Pg. 5-9 El. Bk. 3225 Pg. 6
 Approved _____ Date _____

Latitude 41°-05'-00"

Longitude 78°-42'-30"
1,100'

"A" = SE COR R.W. CAMPBELL
 "B" = NE COR R.W. CAMPBELL
 A-B NORTH 1466'
 A - WN 1323 N 39°55'W - 676'
 B - WN 1323 S 24°36'W - 1043'

NOTE: ALL BEARINGS CORRECTED TO PROPERTY DESCRIPTION

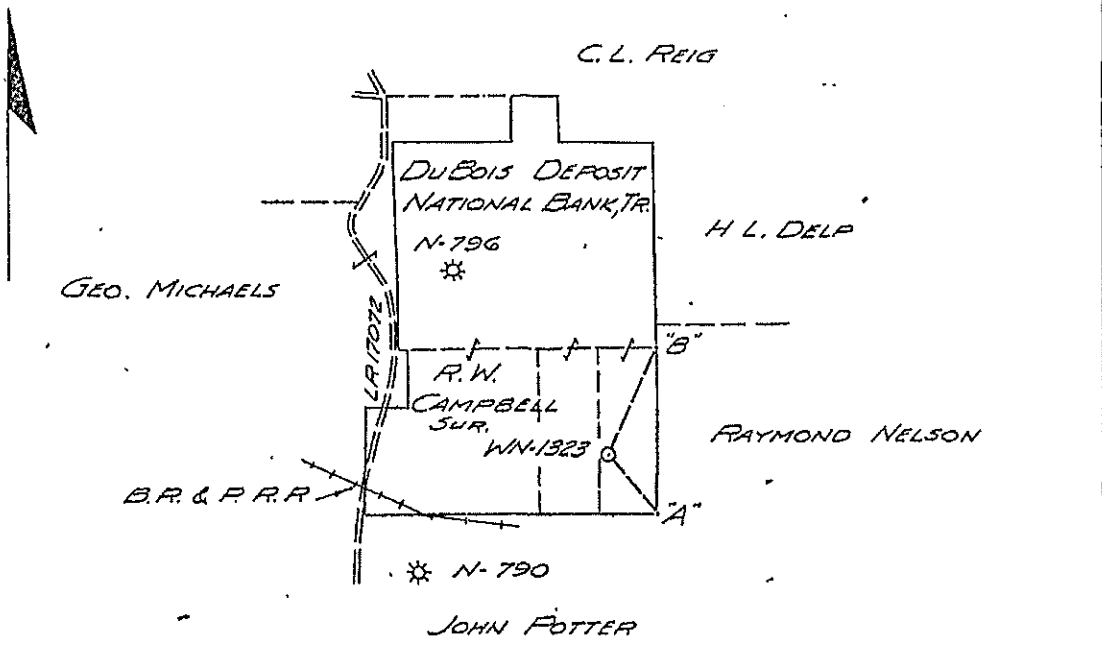

- New Location
- Drill Deeper
- Abandonment
- Repairs

Company CONSOLIDATED GAS SUPPLY CORP.
 Address 445 W. MAIN ST. CLARKSBURG, W. VA.
 Farm DUBOIS DEPOSIT NATIONAL BANK
 Tract _____ Acres 172⁸ Lease No. 60956
 Well (Farm) No. _____ Co. Serial No. WN-1323
 Angle of Deviation, if any _____
 Elevation 1572' Quadrangle LUTHERSBURG
 County CLEARFIELD Township BRADY
 Engineer Conrad Clemm
 Engineer's Registration No. 010961-E
 File No. _____ Drawing No. W.F. 44W1G
 Date APRIL 17 1974 Scale 1" = 1320'

COMMONWEALTH OF PENNSYLVANIA
 DEPARTMENT OF MINES
 Oil and Gas Division
 HARRISBURG
 WELL LOCATION MAP
 Dept. File No. CLE-20553
 ⊕ Denotes Values of Well on United States Topographic Maps.
 Scale 15' 7 1/2'
 WORKABLE COAL SEAMS TO BE PENETRATED
 Name of Seam Owner of Seam
A-4 SEAMS DELSQUERHANNA COAL & COKE
 866 05-13-74

6628

COMMONWEALTH OF PENNSYLVANIA
DEPARTMENT OF MINES
OIL AND GAS DIVISION

CERTIFICATE OF PLUGGING WELL THROUGH WORKABLE COAL SEAMS

John R. Potter
Coal Operator or Owner

New York State Natural Gas Corporation
Well Operator

D. #1

#2 Gateway Center, Room 1032

Pittsburgh, Pennsylvania
Address

Pittsburgh 22, Pa.
Address

Coal Operator or Owner

August 24, 1960
Date

Brady
Township

Address

Clearfield
County

Coal Operator or Owner

John R. Potter
Farm

Address

Well (Farm) No. #1 Serial No. N-782

W.J. Burns, Jr.
Division Representative Supervising

John R. Potter
Coal Representative Observing

We, the undersigned representatives of the well operator certify that we participated in the plugging of the above well, and that the work was started Oct. 4, 1960, and that the well was plugged as follows:

Filling Material and Plug	From	To	Casing and Tubing		
			Size	Pulled	Left
Total Depth		7637'			
Cavings	7637	7562'	13 3/8"	none	60' 2"
10 sacks of cement	7662	7536'	9 5/8"	861' 9"	294' 15"
50 sacks of cement	3358'	3154'	2" vent	none	273' 10"
50 sacks of cement	1365'	1129'			
Cut 9 5/8" csg at 861' & pulled 861.77'					
Cavings	864'	853'			Depth of Coal Seams
380 sacks of cement	853'	300'	Coal or Shale		255-265
Stone	300'	275'	Coal		409-415
Ran 273.81' Vent pipe	275'	0'	Sample study indicates no true coal found.		
Gravel	275'	270'	Description of Monument		
45 sacks of cement	270'	220'	2" vent pipe above ground		
Aquagel	220'	30'			
Stone	30'	25'			
Cement	25'	0'			

and that the work of plugging and filling said well was completed on the 10 th day of October, 1960.

Qualified Participants

John R. Potter
John R. Potter

083-20325-P

Permit No. 61-325

- 2 - W.R.C.
- 1 - J.R.P.
- 1 - C.E.A.
- 2 - File

New York State Natural Gas Corporation
Well Operator

By H. B. Berger
Title Superintendent Operations

One copy of this certificate to be mailed to each coal operator or owner, and one to the Division, by registered mail, upon completion of plugging.

PENFIELD G 206

DM-OG-4-56

COMMONWEALTH OF PENNSYLVANIA
DEPARTMENT OF MINES

1.990' S 41°05'00"
10.200' W 78°42'30" (4)

LUTHERSBURG

Oil and Gas Division
HARRISBURG

033-20325-P

QUADRANGLE: Penfield

7 1/2' 15'

PERMIT NO. ~~CEB-325-P~~

MAP REFERENCE: 10S 17W S64 W117

KIND OF WELL: Gas Dry
(Oil, Gas, Other)

WELL RECORD

COMPANY: New York State Natural Gas Corporation	Size of Casing and Tubing	Used in Drilling	Left in Well	Packers: Type, Size and Depth
ADDRESS: #2 Gateway Center, Pittsburgh 22, Pa.	13-3/8"	60'	60'	
FARM John R. Potter ACRES 68	9-5/8"	1156'	294'	BHS @ 1152
WELL(FARM)NO. #1 CO. SERIAL NO. N-782	Vent 2"		274'	
ELEVATION: 1627.80 LEASE: 58357				
TOWNSHIP: Brady COUNTY: Clearfield				
DRILLING COMMENCED: 8/7/60 DRILLING COMPLETED: 10/13/60				
PRODUCTION: Dry Hole - Plug and Abandon				PERFORATIONS AT:
ROCK PRESSURE: _____ psig _____ hrs.				
WELL TREATMENT: (Shooting, Acidizing, Fracturing Etc.)				
CEMENTING DATA: (Size Pipe, Depth, No. Bags, Date)				
8/8/60 - 13-3/8" cem. w/50 sacks				
8/11/60 - 9-5/8" cem. @ 1152' w/50 sacks cem. and 15 sacks aquagel				
RESULTS AFTER TREATMENT:				
ROCK PRESSURE AFTER TREATMENT:				

REMARKS:

FORMATION	TOP	BOTTOM	GAS AT	OIL AT	WATER AT (Fresh or Salt Water)	REMARKS
Cellar	0	18				
Sand & shale	18	210			FW 50	
Lime & shale	210	220				
Sand & shale	220	255				
Coal or shale	255	265				
Sand	265	319				
Sand & shale	319	409				
Coal	409	415				
Sand & shale	415	2885				
Shale & sand	2885	3295				
Sand & shale	3295	4130	3324 (show)			
Shale & sand shells	4130	4515				
Sand & shale	4515	4922				
Shale & sand	5060	5255				
Sand & shale	5255	5555				
Shale & sand	5555	5907				

(Over)

FORMATION	TOP	BOTTOM	GAS AT	OIL AT	WATER AT (Fresh or Salt Water)	REMARKS
Shale & shells	5907	6075				
nd & shale	6075	6175				
Shale & shell	6175	6637				
Tully lime	6637	6754				
Shale & shells	6754	7617				
Onondaga	7617	7635				
Chert	7635					
Total depth		7637 (In: Chert)				
<u>Sample Study</u>						
Tully	6638					
Onondaga	7616					
Chert	7635					

DATE November 15, 19 60

APPROVED New York State Natural Gas Corporation OWNER

BY H. L. Barger TITLE
Superintendent Operations

WELL RECORD 033-20325-P

WIPERBOOK (1/2)

2-335-P

Name John R Potter #1 Co. Clearfield Twp. Brady No. 3279
Owner NYS N-782 Contr.

2200 ft from N
23000 ft from E

Date 06/12/1960 Elev. 628
Obtained by Authority Product of Drill
Luttrell & ~~Patfield &~~

Locale by Sketch

Geol. Name	Date	Thick-ness	From	To	Geol. Name	Thick-ness	From	To
AUG 19 1960	Tully		6637		2200 ft S 41° 45'			
AUG 26 1960	Onondaga chert		7617		1000 ft E 78° 45'			
			7635	7637	Moving in rotary			
					4 5/8" @ 1152			
Sept-1960	P&A							
	Completed to 15-60							
	Mauch Chunk		635					
	Catskill		1430	1850				
	Pink rock		2300					

District Central Map 108 17W 64 W 117
 Loc. Made July 27, 1960 Pg. 15 El. Bk. 1916 Pg. 16
 Approved [Signature] Date August 1, 1960

Latitude 41° 05'

21900

Longitude 78° 40'

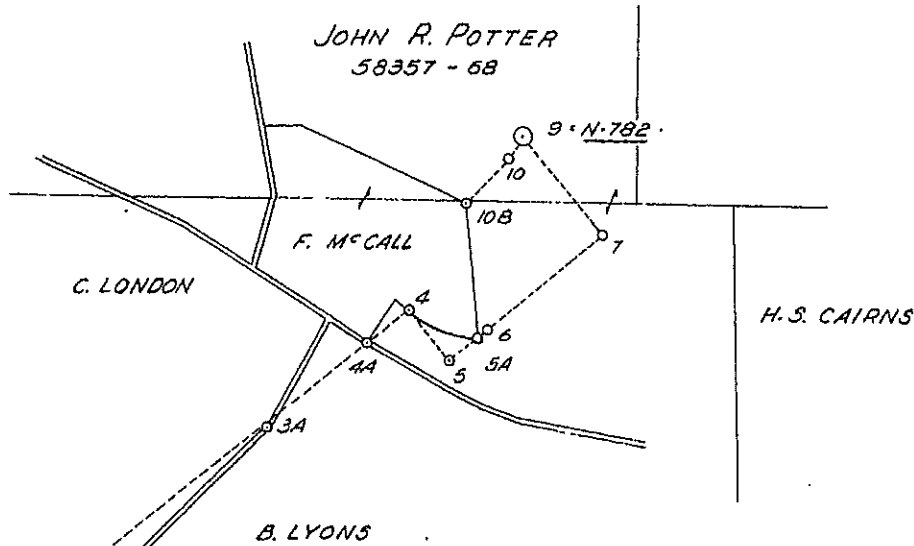

STA	BRG.	DIST.	STA	BRG.	DIST.
1-3	S32° 00' E	282'	6-7	N58° 00' E	676'
3-3A	N58° 41' E	1676'	7-9	N32° 00' W	575'
3-4	N58° 00' E	2489'	9-10	S47° 54' W	123'
4-4A	S58° 54' W	234'	10-10B	S57° 27' W	291'
4-5	S32° 00' E	293'			
5-5A	N58° 00' E	165'			
5-6	" "	235'			

- New Location
- Drill Deeper
- Abandonment
- Re-drill

Company NEW YORK STATE NATURAL GAS CORPORATION
 Address Gateway Center #2, Pittsburgh 22, Pa.
 Farm John R. Potter
 Tract _____ Acres 68 Lease No. 58357
 Well(Farm)No. 1 Co. Serial No. N-782
 Angle of Deviation, if any _____
 Elevation 1627.80 Quadrangle Penfield
 County Clearfield Township Brady
 Engineer R. A. Doman
 Engineer's Registration No. 14016
 File No. _____ Drawing No. _____
 Date 8/1/60 Scale 1"=660'

COMMONWEALTH OF PENNSYLVANIA
 DEPARTMENT OF MINES

Oil and Gas Division
 HARRISBURG

WELL LOCATION MAP
 Dept. File No. 033-20325-P

⊕ Denotes Values of Well on United States Topographic Maps.

Scale 15' 71'

WORKABLE COAL SEAMS TO BE PENETRATED

Name of Seam Owner of Seam

John Potter	Lower Kittanning

DM-OG-4-56

Pennsylvania - Driftwood Field
Halvetic Pool

COMMONWEALTH OF PENNSYLVANIA
DEPARTMENT OF MINES

1,850' S 41° 05' 00"
11,050' W 78° 42' 30" (4)

Oil and Gas Division
HARRISBURG

033-20327

QUADRANGLE: Luthersburg

7 1/2' 15'

PERMIT NO. GLB-327

MAP REFERENCE: 9S 17W S63 W117

KIND OF WELL: Gas
(Oil, Gas, Other)

WELL RECORD

COMPANY: New York State Natural Gas Corporation	Size of Casing and Tubing	Used in Drilling	Left in Well	Packers: Type, Size and Depth
ADDRESS: #2 Gateway Center, Pittsburgh 22, Pa.	13-3/8"	59'	59'	
FARM <u>John E. Potter</u> ACRES <u>68</u>	9-5/8"	1251'	1251'	BHS @ 1248'
WELL(FARM)NO. <u>2</u> CO. SERIAL NO. <u>N-790</u>	7"	7305'	7305'	BHS @ 7234'
ELEVATION: <u>1640.60</u> LEASE: <u>58357</u>				
TOWNSHIP: <u>Brady</u> COUNTY: <u>Clearfield</u>				
DRILLING COMMENCED: <u>8/31/60</u> DRILLING COMPLETED: <u>9/29/60</u>				
PRODUCTION: <u>30,370,000</u> cubic feet				PERFORATIONS AT:
ROCK PRESSURE: <u>3293</u> psig <u>4</u> days <u>max</u>				
WELL TREATMENT: (Shooting, Acidizing, Fracturing Etc.)				
<u>9/27/60 - Fractured w/20,500 gals. water, 1,000 gal. MCA, 150 lbs. gel and 20,000 lbs. sand.</u>				
<u>Breakdown pressure 2400 lbs.; maximum pressure 3600 lbs. Original open flow of 7,312,000 cubic feet increased to 30,370,000 cu ft. a/f Rock pressure b/f 3318 lbs. in 11 days</u>				
CEMENTING DATA: (Size Pipe, Depth, No. Bags, Date)				
				<u>8/31/60 - 13-3/8" cem. @ 70' w/50 sacks</u>
				<u>9/4/60 - 9-5/8" cem @ 1248' w/50 sacks cem., 15 sacks aquagel, & 25 sacks quadroflos</u>
RESULTS AFTER TREATMENT:				
ROCK PRESSURE AFTER TREATMENT:				<u>9/13/60 - 7" cem. @ 7234' w/125 sacks.</u>

REMARKS:

FORMATION	TOP	BOTTOM	GAS AT	OIL AT	WATER AT (Fresh or Salt Water)	REMARKS
Surface	0	15				
Sand & shale	15	143			FW 75	
Red shale	143	146				
Sand & shale	146	205				
Coal	205	209				
Sand & shale	209	217				
Shale & sand	217	303				
Coal or black shale	303	306				
Shale & sand	306	320				
Shale	320	340				
Sand	340	550				
Shale & sand	550	580				
Sand	580	650				
Shale & sand	650	692				
Sand	692	733				
Red shale	733	735				

(Over)

Well N 790

FORMATION	TOP	BOTTOM	GAS AT	OIL AT	WATER AT (Fresh or Salt Water)	REMARKS
Sand & shale	735	1010				
Black shale	1010	1020				
Sand & shale	1020	2293				
Shale	2293	2295				
Shale & sand	2295	2601				
Sand & shale	2601	3415				
Shale & sand	3415	4015				
Sand & shale	4015	5025				
Shale & sand	5025	5475				
Sand & shale	5475	5680				
Shale & sand	5680	5857				
Sand & shale	5857	6030				
Lime & shale	6030	6137				
Lime	6137	6195				
Shale & shells	6195	6642				
Lime	6642	6750				
Shale & shells	6750	7219				
Onondaga lime	7219	7233				
Chert	7233	7288				
Sand	7288	7317	7291-7303			
Lime	7317					
Total Depth		7318				
<u>Sample Study</u>						
Tully	6642					
Onondaga	7219					
Chert	7233					
Oriskany	7288	7317	7291-7303			

RECEIVED
DEPT. OF MINES
& MINERAL IND.

NOV 29 AM 8:44

DATE October 28, 19 60

APPROVED New York State Natural Gas Corporation OWNER

BY D. B. Barzila
TITLE

Superintendent of Operations

LUTHERSBURG (7/4) WELL RECORD 033-26327

Name John R. Potter #2 Co. Clearfield Trap. Brady No. 30293 2000' from N
 Owner NYSNG Corp #1-790 Contr. UNTSSTEP 23800 fr E

Date Sept 2, 1960 Elev. 1640.6 Product Drill Quad. Peatfield G.S Locate by Sketch
 Obtained by Authority

Geol. Name	Sept 2, 1960	Thick-ness	From	To	Geol. Name	Thick-ness	From	To
	Tully		6642					
	Onondaga chert		7219					
	Oriskany		7234					
	7300 Mef gas BF		7288	7317	Sept 23			
	RP 3342 #56 hrs			7318				
SEP 20 1960	30370 Mof gas							
	RP 3800 #							
	Completed 9-29-60							

4.37
23000
123

1-107/30

District Central Map 9S-17W NS 63 E W17
 Loc. Made 8/24/60 Bk. 1916 Pg. 19 Bl. Bk. 1916 Pg. 19
 Approved *[Signature]* Date August 25, 1960

Latitude 41° 05'

Longitude 78° 40'

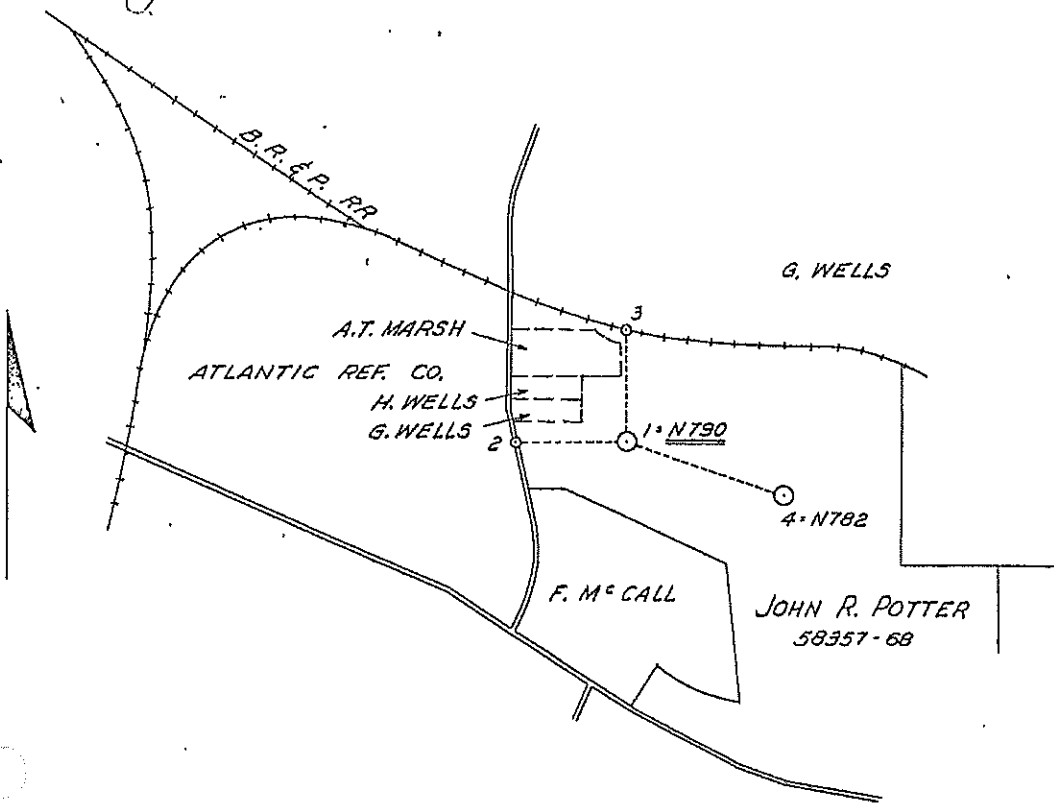

STA.	BRG.	DIST.
1-2	N83° 00' W	500'
1-3	N7° 00' E	500'
1-4	S64° 06' E	745'

- New Location
- Drill Deeper
- Abandonment
- Re-drill

Company NEW YORK STATE NATURAL GAS CORPORATION
 Address #2 Gateway Center, Pittsburgh 22, Pa.
 Farm John R. Potter
 Tract _____ Acres 68 Lease No. 58357
 Well (Farm) No. 2 Co. Serial No. N-790
 Angle of Deviation, if any _____
 Elevation 1640.60 Quadrangle Wheatsburg, Penfield
 County Clearfield Township Brady
 Engineer R. A. Doman
 Engineer's Registration No. 14016
 File No. _____ Drawing No. _____
 Date 8/25/60 Scale 1"=660'

COMMONWEALTH OF PENNSYLVANIA
 DEPARTMENT OF MINES

Oil and Gas Division
 HARRISBURG

WELL LOCATION MAP
 Dept. File No. 615-327
037-20327

⊕ Denotes Values of Well on United States Topographic Maps.

Scale 15' 7 1/2'

WORKABLE COAL SEAMS TO BE PENETRATED

Name of Seam Owner of Seam

John Potter	Lower Kittanning
-------------	------------------

AUG 31 1960

COMMONWEALTH OF PENNSYLVANIA
DEPARTMENT OF ENVIRONMENTAL RESOURCES
DIVISION OF OIL AND GAS
PITTSBURGH, PENNSYLVANIA 15222

Office Use Only



750' S 41° 05' W
11000' W 78° 45' E
LUTHERSBURG (4)

Salem Pool WELL RECORD

650

PERMIT NO. CLE-20597
PROJECT NO. _____
TYPE OF WELL (Gas Production)

81

WELL OPERATOR Consolidated Gas Supply Corp. TELEPHONE NO. 304-623-3611
ADDRESS 445 West Main St., Clarksburg, WY. ZIP 26301
FARM NAME DuBois Deposit National Bank FARM NO. 3 SERIAL NO. WN-1504 ACRES 172
TOWNSHIP Brady COUNTY Clearfield
DRILLING COMMENCED 6-18-76 DRILLING COMPLETED 6-24-76
ELEVATION 1672' QUADRANGLE PENFIELD Luthersburg 7 1/2' 15'

CASING AND TUBING RECORD

Type & Size	Amount In Well	Material Behind Pipe Cement (Sks.)	Pipe Gel (Sks.)	Packer Type	Size	Depth	Date Run						
1 3/4	309	185 to surface		Guide	1 3/4	307 G.L.	6-19-76						
8 5/8	1207	290 to surface		Guide	8 5/8	1200 G.L.	6-22-76						
4 1/2	3547	275		Float	4 1/2	3526 K.B.	6-25-76						
<table border="1"> <tr> <td>3576</td> <td>3412</td> <td>D</td> <td>X</td> <td>G</td> <td>Lease</td> </tr> </table>								3576	3412	D	X	G	Lease
3576	3412	D	X	G	Lease								
K. Measurement 11' above G.L.													

Perforation Record

Stimulation Record

Date	Interval Perforated From	To	Date	Interval Treated	Amount Fluid	Amount Sand	Injection Rate
7-9-76	2587	2595 2	7-9-76	2587-95	400 bbl	20,000#	
7-9-76	2812	2817 5	7-9-76	2812-17	400 bbl	20,000#	
7-9-76	2943	2993 50	7-9-76	2943-93	400 bbl	20,000#	
7-9-76	3402	3412 10	7-9-76	3402-12	400 bbl	20,000#	

NATURAL OPEN FLOW N.T. NATURAL ROCK PRESSURE N.T. hrs. days
AFTER TREATMENT OPEN FLOW 581 ^{MCF} ~~200~~ AFTER TREATMENT ROCK PRESSURE 1180# , 16 days

REMARKS:

RECEIVED

AUG 3 1 1976

PA. GEOLOGIC SURVEY
Oil & Gas Division

Handwritten initials and signature.

Handwritten signature: Zeno B. [unclear]

FORMATION ON REVERSE SIDE

FORMATIONS

NAME	TOP	BOTTOM	GAS AT	OIL AT	WATER AT (Fresh or Salt Water)	SOURCE OF DATA
Sand & Shale	0	420				
Sand & Shale	420	655			FW-100	1" Stream
Sand & Shale	655	825			FW-420	1" Stream
Red Rock	825	850			FW-750	1" Stream
Sand & Shale	850	1370				
Red Rock	1370	1410				
Sandy Shale	1410	1800				
Red Rock	1800	1850				
Shale	1850	1870				
Red Rock	1870	1890				
Sandy Shale	1890	2400				
Red Rock	2400	2460				
Sand & Shale	2460	3565	2870 (Show)			
Total Depth	3565					
<u>Gamma Ray Log Tops</u>						
Speechley Stray	2547	2599				
Speechley	2605	2672				
Tiona	2683	2724				
Balltown	2755	2864				
Sheffield	2864	2998				
1st. Brad.	3060	3154				
2nd. Brad.	3166	3234				
3rd. Brad.	3257	3276				
None	3400	3465				
T.D. Log	3576					

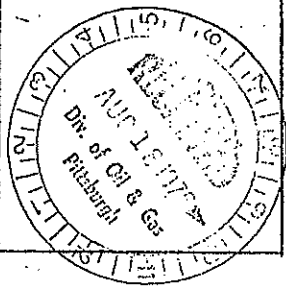

Date August 16, 1976

APPROVED Consolidated Gas Supply Corp.

By *J. E. [Signature]*
 Title
 Manager of Production

District 1-24 Map 25-17-1 N. T. 4 16 11
Loc. No. 370 Pg. 22 of 21 Pl. No. 16 Pg. 50

Latitude

Approved _____ Date _____

A - B EAST 360'
A - WN 1504 549° 21' E - 669'
B - WN 1504 518° 38' E - 460'

Longitude 75° 42' 50"

NOTE ALL BEARINGS CORRECTED TO PROPERTY DESCRIPTION

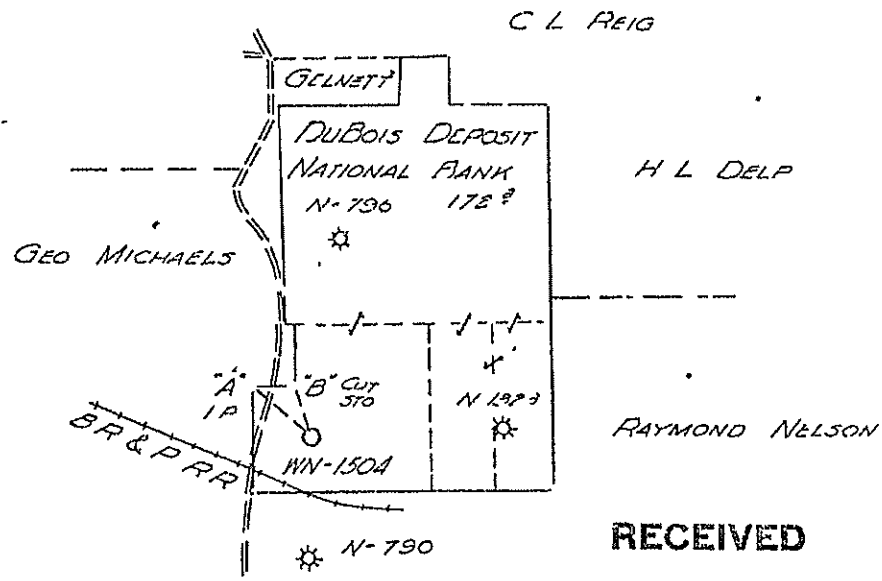

RECEIVED

APR 1 1976

PA GEO LOGIC SURVEY
Oil & Gas Division

3600

- New Location
- Drill Deeper
- Abandonment
- Repairs

Company CONSOLIDATED GAS SUPPLY CORP
 Address 415 W WAINSWICK AVE, WIA
 Farm DUBOIS DEPOSIT NAT'L BANK
 Tract _____ Acres 1.22 Lease No. 60986
 Well(Farm)No. 3 Co. Serial No. WN-1504
 Angle of Deviation, if any _____
 Elevation 1472' Quadrangle LIMERSBURG
 County CARFIELD Township BRADY
 Engineer [Signature]
 Engineer's Registration No. 010961-E
 File No. _____ Drawing No. KE 2119
 Date FEB 23 1970 Scale 1" = 320'

COMMONWEALTH OF PENNSYLVANIA
 DEPARTMENT OF MINES
 3-22-76
 Oil and Gas Division
 HARRISBURG
 WELL LOCATION MAP
 Dept. File No. CLE-20597
 ⊕ Denotes Values of Well on United States Topographic Maps.
 Scale 15' 71'
 WORKABLE COAL SEAMS TO BE PENETRATED
 Name of Seam _____ Owner of Seam _____

APPENDIX B – LABORATORY ANALYTICAL DATA

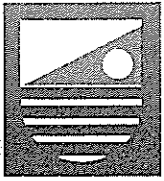

GEOCHEMICAL TESTING

Environmental and Energy Analysis

2005 N. Center Ave.
Somerset, PA 15501

814/443-1671
814/445-6666
FAX: 814/445-6729

Wednesday, October 05, 2011

RICK BONAZZA
RESOURCE MANAGEMENT SERVICES
65 FENTON ROAD
INDIANA, PA 15701

RE: BS-P

Order No.: G1109987

Dear RICK BONAZZA:

Geochemical Testing received 1 sample(s) on 9/27/2011 for the analyses presented in the following report.

There were no problems with the analyses and all QC data met NELAC, EPA, and laboratory specifications except where noted in the Case Narrative or Laboratory Results.

If you have any questions regarding these tests results, please feel free to call.

Sincerely,

Timothy W. Bergstresser
Director of Technical Services

Geochemical Testing

Date: 05-Oct-11

CLIENT: RESOURCE MANAGEMENT SERVICES
Project: BS-P
Lab Order: G1109987

CASE NARRATIVE

No problems were encountered during analysis of this workorder, except if noted in this report.

Legend:

ND - Not Detected at the Quantitation Limit	S - Spike Recovery outside accepted recovery limits
J - Indicates an estimated value.	R - RPD outside accepted recovery limits
U - The analyte was not detected at or above the listed concentration, which is below the laboratory quantitation limit.	E - Value above quantitation range
B - Analyte detected in the associated Method Blank	** - Value exceeds Action Limit
Q - Qualifier	H - Method Hold Time Exceeded
QL - Quantitation Limit	MCL - Contaminant Limit
DF - Dilution Factor	



Laboratory Results

Geochemical Testing

Date: 05-Oct-11

CLIENT:	RESOURCE MANAGEMENT SERVICES	Client Sample ID:	1/9/26
Lab Order:	G1109987		
Project:	BS-P	Sampled By:	Client
Lab ID:	G1109987-001	Collection Date:	9/26/2011 5:20:00 PM
Matrix:	AQUEOUS	Received Date:	9/27/2011 8:34:00 PM

Analyses	Result	QL	Q	Units	DF	Date Analyzed
INORGANIC NON-METALS						Analyst: LNW
Acidity to pH 8.2	-81	0		mg/L CaCO3	1	10/3/2011 4:49:00 PM
PHYSICAL TESTS						Analyst: LNW
Specific Conductance	231	1		µmhos/cm	1	10/3/2011 2:00:00 PM
PH BY SM 4500 H+B						Analyst: LNW
Lab pH	7.56	0	H	su	1	10/3/2011 2:00:00 PM
INORGANIC NON-METALS						Analyst: KLS
Total dissolved solids	128	20		mg/L	1	9/28/2011 11:27:00 AM
PHYSICAL TESTS						Analyst: KLS
Total suspended solids	< 5	5		mg/L	1	9/28/2011 8:25:36 AM
INORGANIC NON-METALS						Analyst: LNW
Alkalinity to pH 4.5	96	5		mg/L CaCO3	1	10/3/2011 2:00:00 PM
INORGANIC NON-METALS						Analyst: CAS
Nitrate - Nitrite	0.37	0.05		mg/L as N	1	9/28/2011 11:56:00 AM
INORGANIC NON-METALS						Analyst: CAS
Bromide	< 0.2	0.2		mg/L	1	9/28/2011 11:56:00 AM
Chloride	3	1		mg/L	1	9/28/2011 11:56:00 AM
Sulfate	16	2		mg/L	1	9/28/2011 11:56:00 AM
INORGANIC METALS						Analyst: JAS
Aluminum	< 0.1	0.1		mg/L	1	9/30/2011 5:01:00 AM
Barium	0.09	0.01		mg/L	1	9/30/2011 5:01:00 AM
Calcium	26.0	0.1		mg/L	1	9/30/2011 5:01:00 AM
Iron	< 0.05	0.05		mg/L	1	9/30/2011 5:01:00 AM
Magnesium	7.4	0.1		mg/L	1	9/30/2011 5:01:00 AM
Manganese	< 0.01	0.01		mg/L	1	9/30/2011 5:01:00 AM
Potassium	1.2	0.5		mg/L	1	9/30/2011 5:01:00 AM
Sodium	6.5	0.2		mg/L	1	9/30/2011 5:01:00 AM
Strontium	1.18	0.01		mg/L	1	9/30/2011 5:01:00 AM
Hardness (SM 2340B)	95.2	1.0		mg/L CaCO3	1	9/30/2011 5:01:00 AM
INDICATOR ORGANIC PARAMETERS						Analyst: ACG
Oil & Grease	< 5	5		mg/L	1	9/30/2011 7:28:00 AM



Shuttle/Cooler ID#: _____

CHAIN OF CUSTODY

Geochemical Testing

Form F-5002, 01 04

Geochemical Testing • 2005 North Center Avenue • Somerset PA 15501 • (814) 443-1671 • Fax (814) 445-6729

Billing Client: <u>AMS</u>	Contact (Company): <u>AMS</u>	Phone: () _____
Address: _____	e-mail: _____	Fax: () _____
City: _____	State: _____ Zip: _____	Preservatives by <u>DGT</u>
WO#: (LAB USE ONLY) <u>1109957</u>	Project: _____	PO/Quote#: _____

Sample Matrix: <u>GW Ground Water</u>	SW Surface Water	PW Potable Water	WW Wastewater	SO Soil	SL Sludge	nHZ Not Hazardous / HZ Hazardous	PCBs
Sample Type: <u>G Grab</u>	C Composite	D Distribution/DW	R Raw/DW	S Special/DW	O Other	Containers Supplied by: <input type="checkbox"/> Client <input checked="" type="checkbox"/>	GT Lab

Sample Location/ Description	Lab Number (LAB USE ONLY)	Sample Matrix	Date	Time (Military)	Sample Type	**Analyses Requested	Remarks/ Preservatives, etc	Number of Containers
<u>AMS 1/9/26</u>	<u>G01</u>	<u>PW</u>	<u>9/26/11</u>	<u>1720</u>	<u>G</u>	<u>BS-P + O + G + A + K</u>	Field Filtered: <u>Y/N</u>	<u>4</u>
		nHZ / HZ					Field Filtered: Y / N	
		nHZ / HZ					Field Filtered: Y / N	
		nHZ / HZ					Field Filtered: Y / N	
		nHZ / HZ					Field Filtered: Y / N	
		nHZ / HZ					Field Filtered: Y / N	

Waiver of Responsibility: Although samples were delivered without ice and at a temperature greater than 6°C, the samples are to be analyzed.

Name: _____ Date: _____

Relinquished by (Company & Signature)	Date	Time (Military)	Received by (Company & Signature)	Date	Time (Military)
<u>AMS</u>	<u>9/26/11</u>	<u>1800</u>	<u>[Signature]</u>	<u>9/27/11</u>	<u>1535</u>
<u>[Signature]</u>	<u>9-27-11</u>	<u>1235</u>	<u>[Signature]</u>	<u>9/27/11</u>	<u>20:34</u>

Be present on receipt: Yes or No Cooler Temp (°C) on receipt 3

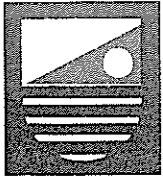

GEOCHEMICAL TESTING

Environmental and Energy Analysis

2005 N. Center Ave.
Somerset, PA 15501

814/443-1671
814/445-6666
FAX: 814/445-6729

Thursday, September 29, 2011

RICK BONAZZA
RESOURCE MANAGEMENT SERVICES
65 FENTON ROAD
INDIANA, PA 15701

RE: BS-P

Order No.: G1109782

Dear RICK BONAZZA:

Geochemical Testing received 5 sample(s) on 9/21/2011 for the analyses presented in the following report.

There were no problems with the analyses and all QC data met NELAC, EPA, and laboratory specifications except where noted in the Case Narrative or Laboratory Results.

If you have any questions regarding these tests results, please feel free to call.

Sincerely,

Timothy W. Bergstresser
Director of Technical Services

Geochemical Testing

Date: 29-Sep-11

CLIENT: RESOURCE MANAGEMENT SERVICES
Project: BS-P
Lab Order: G1109782

CASE NARRATIVE

No problems were encountered during analysis of this workorder, except if noted in this report.

Legend:

ND - Not Detected at the Quantitation Limit	S - Spike Recovery outside accepted recovery limits
J - Indicates an estimated value.	R - RPD outside accepted recovery limits
U - The analyte was not detected at or above the listed concentration, which is below the laboratory quantitation limit.	E - Value above quantitation range
B - Analyte detected in the associated Method Blank	** - Value exceeds Action Limit
Q - Qualifier	H - Method Hold Time Exceeded
QL - Quantitation Limit	MCL - Contaminant Limit
DF - Dilution Factor	



Laboratory Results

Geochemical Testing

Date: 29-Sep-11

CLIENT:	RESOURCE MANAGEMENT SERVICES	Client Sample ID:	RMS 1/9/20
Lab Order:	G1109782	Sampled By:	Client
Project:	BS-P	Collection Date:	9/20/2011 10:30:00 AM
Lab ID:	G1109782-001	Received Date:	9/21/2011 6:13:57 PM
Matrix:	AQUEOUS		

Analyses	Result	QL	Q	Units	DF	Date Analyzed
INORGANIC NON-METALS						
Acidity to pH 8.2	-29	0		mg/L CaCO ₃	1	9/27/2011 4:22:00 PM
		SM 2310B(4A)		Analyst: LNW		
PHYSICAL TESTS						
Specific Conductance	409	1		µmhos/cm	1	9/27/2011 1:18:00 PM
		EPA 120.1		Analyst: LNW		
PH BY SM 4500 H+B						
Lab pH	6.69	0	H	su	1	9/27/2011 1:18:00 PM
		SM4500-H+B		Analyst: LNW		
INORGANIC NON-METALS						
Total dissolved solids	278	20		mg/L	1	9/22/2011 10:55:00 AM
		SM 2540 C		Analyst: KLS		
PHYSICAL TESTS						
Total suspended solids	6	5		mg/L	1	9/22/2011 8:51:25 AM
		SM 2540D		Analyst: KLS		
INORGANIC NON-METALS						
Alkalinity to pH 4.5	54	5		mg/L CaCO ₃	1	9/27/2011 1:18:00 PM
		ASTM D1067-02		Analyst: LNW		
INORGANIC NON-METALS						
Nitrate - Nitrite	0.39	0.05		mg/L as N	1	9/21/2011 7:42:00 PM
		EPA 300.0		Analyst: CAS		
INORGANIC NON-METALS						
Bromide	< 0.2	0.2		mg/L	1	9/21/2011 7:42:00 PM
Chloride	91	1		mg/L	1	9/21/2011 7:42:00 PM
Sulfate	14	2		mg/L	1	9/21/2011 7:42:00 PM
		EPA 300.0		Analyst: CAS		
INORGANIC METALS						
Aluminum	< 0.1	0.1		mg/L	1	9/27/2011 12:50:00 AM
Barium	0.03	0.01		mg/L	1	9/27/2011 12:50:00 AM
Calcium	21.0	0.1		mg/L	1	9/27/2011 12:50:00 AM
Iron	0.79	0.05		mg/L	1	9/27/2011 12:50:00 AM
Magnesium	7.9	0.1		mg/L	1	9/27/2011 12:50:00 AM
Manganese	0.01	0.01		mg/L	1	9/27/2011 12:50:00 AM
Potassium	1.7	0.5		mg/L	1	9/27/2011 12:50:00 AM
Sodium	55.0	0.2		mg/L	1	9/27/2011 12:50:00 AM
Strontium	0.12	0.01		mg/L	1	9/27/2011 12:50:00 AM
Hardness (SM 2340B)	85.1	1.0		mg/L CaCO ₃	1	9/27/2011 12:50:00 AM
		EPA 200.7		Analyst: JAS		
INDICATOR ORGANIC PARAMETERS						
Oil & Grease	< 5	5		mg/L	1.01	9/26/2011 1:55:00 PM
		EPA 1664		Analyst: ACG		

Laboratory Results

Geochemical Testing

Date: 29-Sep-11

CLIENT:	RESOURCE MANAGEMENT SERVICES	Client Sample ID: RMS 2/9/20
Lab Order:	G1109782	
Project:	BS-P	Sampled By: Client
Lab ID:	G1109782-002	Collection Date: 9/20/2011 11:00:00 AM
Matrix:	AQUEOUS	Received Date: 9/21/2011 6:13:57 PM

Analyses	Result	QL	Q	Units	DF	Date Analyzed
INORGANIC NON-METALS						
Acidity to pH 8.2	-24	0		mg/L CaCO ₃	1	9/27/2011 4:35:00 PM
PHYSICAL TESTS						
Specific Conductance	603	1		µmhos/cm	1	9/27/2011 1:29:00 PM
PH BY SM 4500 H+B						
Lab pH	6.74	0	H	su	1	9/27/2011 1:29:00 PM
INORGANIC NON-METALS						
Total dissolved solids	496	20		mg/L	1	9/22/2011 10:56:00 AM
PHYSICAL TESTS						
Total suspended solids	6	5		mg/L	1	9/22/2011 8:53:31 AM
INORGANIC NON-METALS						
Alkalinity to pH 4.5	46	5		mg/L CaCO ₃	1	9/27/2011 1:29:00 PM
INORGANIC NON-METALS						
Nitrate - Nitrite	0.27	0.05		mg/L as N	1	9/21/2011 7:59:00 PM
INORGANIC NON-METALS						
Bromide	1.1	0.2		mg/L	1	9/21/2011 7:59:00 PM
Chloride	155	1		mg/L	1	9/21/2011 7:59:00 PM
Sulfate	14	2		mg/L	1	9/21/2011 7:59:00 PM
INORGANIC METALS						
Aluminum	< 0.1	0.1		mg/L	1	9/27/2011 1:07:00 AM
Barium	0.12	0.01		mg/L	1	9/27/2011 1:07:00 AM
Calcium	42.3	0.1		mg/L	1	9/27/2011 1:07:00 AM
Iron	0.14	0.05		mg/L	1	9/27/2011 1:07:00 AM
Magnesium	9.9	0.1		mg/L	1	9/27/2011 1:07:00 AM
Manganese	0.06	0.01		mg/L	1	9/27/2011 1:07:00 AM
Potassium	5.2	0.5		mg/L	1	9/27/2011 1:07:00 AM
Sodium	64.0	0.2		mg/L	1	9/27/2011 1:07:00 AM
Strontium	1.19	0.01		mg/L	1	9/27/2011 1:07:00 AM
Hardness (SM 2340B)	146	1.0		mg/L CaCO ₃	1	9/27/2011 1:07:00 AM

Laboratory Results

Geochemical Testing

Date: 29-Sep-11

CLIENT:	RESOURCE MANAGEMENT SERVICES	Client Sample ID: RMS 3/9/20
Lab Order:	G1109782	
Project:	BS-P	Sampled By: Client
Lab ID:	G1109782-003	Collection Date: 9/20/2011 11:20:00 AM
Matrix:	AQUEOUS	Received Date: 9/21/2011 6:13:57 PM

Analyses	Result	QL	Q	Units	DF	Date Analyzed
INORGANIC NON-METALS						
Acidity to pH 8.2	-41	0		mg/L CaCO ₃	1	9/27/2011 4:34:00 PM
PHYSICAL TESTS						
Specific Conductance	137	1		µmhos/cm	1	9/27/2011 1:26:00 PM
PH BY SM 4500 H+B						
Lab pH	7.37	0	H	su	1	9/27/2011 1:26:00 PM
INORGANIC NON-METALS						
Total dissolved solids	90	20		mg/L	1	9/22/2011 10:56:00 AM
PHYSICAL TESTS						
Total suspended solids	< 5	5		mg/L	1	9/22/2011 8:53:39 AM
INORGANIC NON-METALS						
Alkalinity to pH 4.5	61	5		mg/L CaCO ₃	1	9/27/2011 1:26:00 PM
INORGANIC NON-METALS						
Nitrate - Nitrite	0.60	0.05		mg/L as N	1	9/21/2011 8:16:00 PM
INORGANIC NON-METALS						
Bromide	< 0.2	0.2		mg/L	1	9/21/2011 8:16:00 PM
Chloride	4	1		mg/L	1	9/21/2011 8:16:00 PM
Sulfate	10	2		mg/L	1	9/21/2011 8:16:00 PM
INORGANIC METALS						
Aluminum	< 0.1	0.1		mg/L	1	9/27/2011 1:44:00 AM
Barium	0.02	0.01		mg/L	1	9/27/2011 1:44:00 AM
Calcium	18.8	0.1		mg/L	1	9/27/2011 1:44:00 AM
Iron	< 0.05	0.05		mg/L	1	9/27/2011 1:44:00 AM
Magnesium	4.4	0.1		mg/L	1	9/27/2011 1:44:00 AM
Manganese	< 0.01	0.01		mg/L	1	9/27/2011 1:44:00 AM
Potassium	1.4	0.5		mg/L	1	9/27/2011 1:44:00 AM
Sodium	3.8	0.2		mg/L	1	9/27/2011 1:44:00 AM
Strontium	0.09	0.01		mg/L	1	9/27/2011 1:44:00 AM
Hardness (SM 2340B)	64.9	1.0		mg/L CaCO ₃	1	9/27/2011 1:44:00 AM

Laboratory Results

Geochemical Testing

Date: 29-Sep-11

CLIENT:	RESOURCE MANAGEMENT SERVICES	Client Sample ID:	RMS 4/9/20
Lab Order:	G1109782	Sampled By:	Client
Project:	BS-P	Collection Date:	9/20/2011 11:35:00 AM
Lab ID:	G1109782-004	Received Date:	9/21/2011 6:13:57 PM
Matrix:	AQUEOUS		

Analyses	Result	QL	Q	Units	DF	Date Analyzed
INORGANIC NON-METALS						
Acidity to pH 8.2	-136	0		mg/L CaCO3	1	9/27/2011 4:39:00 PM
		SM 2310B(4A)		Analyst: LNW		
PHYSICAL TESTS						
Specific Conductance	360	1		µmhos/cm	1	9/27/2011 1:36:00 PM
		EPA 120.1		Analyst: LNW		
PH BY SM 4500 H+B						
Lab pH	8.12	0	H	su	1	9/27/2011 1:36:00 PM
		SM4500-H+B		Analyst: LNW		
INORGANIC NON-METALS						
Total dissolved solids	210	20		mg/L	1	9/22/2011 10:56:00 AM
		SM 2540 C		Analyst: KLS		
PHYSICAL TESTS						
Total suspended solids	11	5		mg/L	1	9/22/2011 8:53:42 AM
		SM 2540D		Analyst: KLS		
INORGANIC NON-METALS						
Alkalinity to pH 4.5	150	5		mg/L CaCO3	1	9/27/2011 1:36:00 PM
		ASTM D1067-02		Analyst: LNW		
INORGANIC NON-METALS						
Nitrate - Nitrite	1.22	0.05		mg/L as N	1	9/21/2011 8:33:00 PM
		EPA 300.0		Analyst: CAS		
INORGANIC NON-METALS						
Bromide	< 0.2	0.2		mg/L	1	9/21/2011 8:33:00 PM
Chloride	18	1		mg/L	1	9/21/2011 8:33:00 PM
Sulfate	17	2		mg/L	1	9/21/2011 8:33:00 PM
		EPA 300.0		Analyst: CAS		
INORGANIC METALS						
Aluminum	< 0.1	0.1		mg/L	1	9/27/2011 1:51:00 AM
Barium	0.03	0.01		mg/L	1	9/27/2011 1:51:00 AM
Calcium	47.0	0.1		mg/L	1	9/27/2011 1:51:00 AM
Iron	< 0.05	0.05		mg/L	1	9/27/2011 1:51:00 AM
Magnesium	5.6	0.1		mg/L	1	9/27/2011 1:51:00 AM
Manganese	< 0.01	0.01		mg/L	1	9/27/2011 1:51:00 AM
Potassium	3.2	0.5		mg/L	1	9/27/2011 1:51:00 AM
Sodium	31.4	0.2		mg/L	1	9/27/2011 1:51:00 AM
Strontium	0.42	0.01		mg/L	1	9/27/2011 1:51:00 AM
Hardness (SM 2340B)	140	1.0		mg/L CaCO3	1	9/27/2011 1:51:00 AM
		EPA 200.7		Analyst: JAS		

Shuttle/Cooler ID#:

CHAIN OF CUSTODY

Geochemical Testing

Form F-5002, 01.04

Geochemical Testing • 2005 North Center Avenue • Somerset PA 15501 • (814) 443-1671 • Fax (814) 445-6729

Billing Client: RMS Contact (Company): RMS Phone: ()
 Address: e-mail: Fax: ()
 City: State: Zip: Preservatives by Sampler GT
 WO#: (LAB USE ONLY) C1169782 Project: PO/Quote#:

Sample Matrix:	GW Ground Water	SW Surface Water	PW Potable Water	WW Wastewater	SO Soil	SL Sludge	nHZ Not Hazardous / HZ Hazardous	PCBs
Sample Type:	G Grab	C Composite	D Distribution/DW	R Raw/DW	S Special/DW	O Other	Containers Supplied by:	Client <input type="checkbox"/> <input checked="" type="checkbox"/> GT Lab

Sample Location/Description	Lab Number (LAB USE ONLY)	Sample Matrix	Date	Time (Military)	Sample Type	**Analyses Requested	Remarks/Preservatives, etc	Number of Containers
RMS 1/9/2003	001	nHZ / HZ PW	9-20-11	Various 10:30	G	BS-P + O + G + A1 + K	Field Filtered: Y / N	4
RMS 2/9/2007	002	nHZ / HZ SW		11:00		BS-P + A1 + K	Field Filtered: Y / N	3
RMS 3/9/2007	003	nHZ / HZ SW		11:20		"	Field Filtered: Y / N	3
RMS 4/9/2005	004	nHZ / HZ SW		11:35		"	Field Filtered: Y / N	3
RMS 6/9/2001	005	nHZ / HZ SW		18:45	✓	BS-P Group	Field Filtered: Y / N	3
		nHZ / HZ					Field Filtered: Y / N	
		nHZ / HZ					Field Filtered: Y / N	
		nHZ / HZ					Field Filtered: Y / N	

**NOTE: IF multiple analytes from one bottle, OR if multiple bottles for one analyte, THEN list separately on one line UNLESS LISTED ON ATTACHED FIELD LOG

Waiver of Responsibility: Although samples were delivered without ice and at a temperature greater than 6° C, the samples are to be analyzed.

Name: _____ Date: _____

Relinquished by (Company & Signature)	Date	Time (Military)	Received by (Company & Signature)	Date	Time (Military)
<u>[Signature]</u>	9-21-11	1005	<u>[Signature]</u>	9-21-11	1430
<u>[Signature]</u>	9-21-11	1700	<u>[Signature]</u>	9-21-11	18:18

Note other preservation issues:

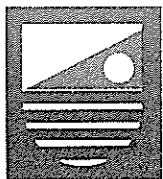

GEOCHEMICAL TESTING

Environmental and Energy Analysis

2005 N. Center Ave.
Somerset, PA 15501

814/443-1671
814/445-6666
FAX: 814/445-6729

Thursday, September 29, 2011

RICK BONAZZA
RESOURCE MANAGEMENT SERVICES
65 FENTON ROAD
INDIANA, PA 15701

Order No.: G1109711

Dear RICK BONAZZA:

Geochemical Testing received 3 sample(s) on 9/20/2011 for the analyses presented in the following report.

There were no problems with the analyses and all QC data met NELAC, EPA, and laboratory specifications except where noted in the Case Narrative or Laboratory Results.

If you have any questions regarding these tests results, please feel free to call.

Sincerely,

Timothy W. Bergstresser
Director of Technical Services

Geochemical Testing

Date: 29-Sep-11

CLIENT: RESOURCE MANAGEMENT SERVICES

Project:

Lab Order: G1109711

CASE NARRATIVE

No problems were encountered during analysis of this workorder, except if noted in this report.

Legend:

ND - Not Detected at the Quantitation Limit

J - Indicates an estimated value.

U - The analyte was not detected at or above the listed concentration, which is below the laboratory quantitation limit.

B - Analyte detected in the associated Method Blank

Q - Qualifier QL -Quantitation Limit DF - Dilution Factor

S - Spike Recovery outside accepted recovery limits

R - RPD outside accepted recovery limits

E - Value above quantitation range

** - Value exceeds Action Limit

H - Method Hold Time Exceeded

MCL - Contaminant Limit



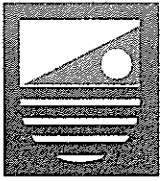

GEOCHEMICAL TESTING

Environmental and Energy Analysis

2005 N. Center Ave.
Somerset, PA 15501

814/443-1671
814/445-6666
FAX: 814/445-6729

Friday, October 07, 2011

RICK BONAZZA
RESOURCE MANAGEMENT SERVICES
65 FENTON ROAD
INDIANA, PA 15701

RE: BS-P

Order No.: G1109712

Dear RICK BONAZZA:

Geochemical Testing received 8 sample(s) on 9/20/2011 for the analyses presented in the following report.

There were no problems with the analyses and all QC data met NELAC, EPA, and laboratory specifications except where noted in the Case Narrative or Laboratory Results.

If you have any questions regarding these tests results, please feel free to call.

Sincerely,

Timothy W. Bergstresser
Director of Technical Services

Geochemical Testing

Date: 07-Oct-11

CLIENT: RESOURCE MANAGEMENT SERVICES
Project: BS-P
Lab Order: G1109712

CASE NARRATIVE

No problems were encountered during analysis of this workorder, except if noted in this report.

Legend: ND - Not Detected at the Quantitation Limit
J - Indicates an estimated value.
U - The analyte was not detected at or above the listed concentration, which is below the laboratory quantitation limit.
B - Analyte detected in the associated Method Blank
Q - Qualifier QL - Quantitation Limit DF - Dilution Factor
S - Spike Recovery outside accepted recovery limits
R - RPD outside accepted recovery limits
E - Value above quantitation range
** - Value exceeds Action Limit
H - Method Hold Time Exceeded
MCL - Contaminant Limit



Laboratory Results

Date: 29-Sep-11

Geochemical Testing

CLIENT:	RESOURCE MANAGEMENT SERVICES	Client Sample ID:	1/9/19
Lab Order:	G1109711		
Project:		Sampled By:	Client
Lab ID:	G1109711-001	Collection Date:	9/20/2011 10:00:00 AM
Matrix:	AQUEOUS	Received Date:	9/20/2011 6:22:21 PM

Analyses	Result	QL	Q	Units	DF	Date Analyzed
PH BY SM 4500 H+B						Analyst: LNW
Lab pH	6.10	0		su	1	9/26/2011 11:59:00 AM
INORGANIC NON-METALS						Analyst: KLS
Total dissolved solids	68	20		mg/L	1	9/21/2011 8:59:00 AM

Laboratory Results

Geochemical Testing

Date: 29-Sep-11

CLIENT:	RESOURCE MANAGEMENT SERVICES	Client Sample ID:	2/9/19
Lab Order:	G1109711		
Project:		Sampled By:	Client
Lab ID:	G1109711-002	Collection Date:	9/20/2011 10:30:00 AM
Matrix:	AQUEOUS	Received Date:	9/20/2011 6:22:21 PM

Analyses	Result	QL	Q	Units	DF	Date Analyzed
PH BY SM 4500 H+B						Analyst: LNW
Lab pH	6.49	0		su	1	9/26/2011 12:00:00 PM
INORGANIC NON-METALS						Analyst: KLS
Total dissolved solids	68	20		mg/L	1	9/21/2011 8:59:00 AM

Laboratory Results

Geochemical Testing

Date: 29-Sep-11

CLIENT: RESOURCE MANAGEMENT SERVICES **Client Sample ID:** 3/9/19
Lab Order: G1109711
Project: **Sampled By:** Client
Lab ID: G1109711-003 **Collection Date:** 9/20/2011 10:40:00 AM
Matrix: AQUEOUS **Received Date:** 9/20/2011 6:22:21 PM

Analyses	Result	QL	Q	Units	DF	Date Analyzed
PH BY SM 4500 H+B						Analyst: LNW
Lab pH	6.74	0		su	1	9/26/2011 12:02:00 PM
INORGANIC NON-METALS						Analyst: KLS
Total dissolved solids	112	20		mg/L	1	9/21/2011 9:28:00 AM

Laboratory Results

Geochemical Testing

Date: 07-Oct-11

CLIENT:	RESOURCE MANAGEMENT SERVICES	Client Sample ID: 4/9/19
Lab Order:	G1109712	
Project:	BS-P	Sampled By: Client
Lab ID:	G1109712-001	Collection Date: 9/20/2011 11:00:00 AM
Matrix:	AQUEOUS	Received Date: 9/20/2011 6:26:09 PM

Analyses	Result	QL	Q	Units	DF	Date Analyzed
INORGANIC NON-METALS						
Acidity to pH 8.2	-45	0		mg/L CaCO ₃	1	9/27/2011 9:05:00 AM
PHYSICAL TESTS						
Specific Conductance	165	1		µmhos/cm	1	9/26/2011 11:48:00 AM
PH BY SM 4500 H+B						
Lab pH	8.05	0		su	1	9/26/2011 11:48:00 AM
INORGANIC NON-METALS						
Total dissolved solids	120	20		mg/L	1	9/21/2011 8:59:00 AM
PHYSICAL TESTS						
Total suspended solids	< 5	5		mg/L	1	9/21/2011 7:09:01 AM
INORGANIC NON-METALS						
Alkalinity to pH 4.5	74	5		mg/L CaCO ₃	1	9/26/2011 11:48:00 AM
INORGANIC NON-METALS						
Nitrate - Nitrite	0.66	0.05		mg/L as N	1	9/20/2011 7:07:00 PM
INORGANIC NON-METALS						
Bromide	< 0.2	0.2		mg/L	1	9/20/2011 7:07:00 PM
Chloride	4	1		mg/L	1	9/20/2011 7:07:00 PM
Sulfate	15	2		mg/L	1	9/20/2011 7:07:00 PM
INORGANIC METALS						
Aluminum	< 0.1	0.1		mg/L	1	9/22/2011 11:56:00 PM
Barium	0.04	0.01		mg/L	1	9/22/2011 11:56:00 PM
Calcium	22.7	0.1		mg/L	1	9/22/2011 11:56:00 PM
Iron	< 0.05	0.05		mg/L	1	9/22/2011 11:56:00 PM
Magnesium	4.5	0.1		mg/L	1	9/22/2011 11:56:00 PM
Manganese	< 0.01	0.01		mg/L	1	9/22/2011 11:56:00 PM
Potassium	1.5	0.5		mg/L	1	9/22/2011 11:56:00 PM
Sodium	5.8	0.2		mg/L	1	9/22/2011 11:56:00 PM
Strontium	0.16	0.01		mg/L	1	9/22/2011 11:56:00 PM
Hardness (SM 2340B)	74.9	1.0		mg/L CaCO ₃	1	9/22/2011 11:56:00 PM



Laboratory Results

Geochemical Testing

Date: 07-Oct-11

CLIENT:	RESOURCE MANAGEMENT SERVICES	Client Sample ID:	5/9/19
Lab Order:	G1109712	Sampled By:	Client
Project:	BS-P	Collection Date:	9/20/2011 11:45:00 AM
Lab ID:	G1109712-002	Received Date:	9/20/2011 6:26:09 PM
Matrix:	AQUEOUS		

Analyses	Result	QL	Q	Units	DF	Date Analyzed
INORGANIC NON-METALS						
Acidity to pH 8.2	-83	0		mg/L CaCO3	1	9/27/2011 9:09:00 AM
PHYSICAL TESTS						
Specific Conductance	301	1		µmhos/cm	1	9/26/2011 12:35:00 PM
PH BY SM 4500 H+B						
Lab pH	7.61	0		su	1	9/26/2011 12:35:00 PM
INORGANIC NON-METALS						
Total dissolved solids	202	20		mg/L	1	9/21/2011 9:00:00 AM
PHYSICAL TESTS						
Total suspended solids	< 5	5		mg/L	1	9/21/2011 7:09:03 AM
INORGANIC NON-METALS						
Alkalinity to pH 4.5	99	5		mg/L CaCO3	1	9/26/2011 12:35:00 PM
INORGANIC NON-METALS						
Nitrate - Nitrite	0.06	0.05		mg/L as N	1	9/20/2011 7:23:00 PM
INORGANIC NON-METALS						
Bromide	< 0.2	0.2		mg/L	1	9/20/2011 7:23:00 PM
Chloride	35	1		mg/L	1	9/20/2011 7:23:00 PM
Sulfate	12	2		mg/L	1	9/20/2011 7:23:00 PM
INORGANIC METALS						
Aluminum	< 0.1	0.1		mg/L	1	9/23/2011 2:40:00 AM
Barium	0.24	0.01		mg/L	1	9/23/2011 2:40:00 AM
Calcium	32.0	0.1		mg/L	1	9/23/2011 2:40:00 AM
Iron	0.12	0.05		mg/L	1	9/23/2011 2:40:00 AM
Magnesium	9.9	0.1		mg/L	1	9/23/2011 2:40:00 AM
Manganese	0.11	0.01		mg/L	1	9/23/2011 2:40:00 AM
Potassium	1.0	0.5		mg/L	1	9/23/2011 2:40:00 AM
Sodium	16.4	0.2		mg/L	1	9/23/2011 2:40:00 AM
Strontium	1.02	0.01		mg/L	1	9/23/2011 2:40:00 AM
Hardness (SM 2340B)	121	1.0		mg/L CaCO3	1	9/23/2011 2:40:00 AM
INDICATOR ORGANIC PARAMETERS						
Oil & Grease	< 5	5		mg/L	1	9/23/2011 10:57:00 AM



Laboratory Results

Geochemical Testing

Date: 07-Oct-11

CLIENT:	RESOURCE MANAGEMENT SERVICES	Client Sample ID: 6/9/19
Lab Order:	G1109712	
Project:	BS-P	Sampled By: Client
Lab ID:	G1109712-003	Collection Date: 9/20/2011 12:15:00 PM
Matrix:	AQUEOUS	Received Date: 9/20/2011 6:26:09 PM

Analyses	Result	QL	Q	Units	DF	Date Analyzed
INORGANIC NON-METALS						
Acidity to pH 8.2	-92	0		mg/L CaCO ₃	1	9/27/2011 9:13:00 AM
PHYSICAL TESTS						
Specific Conductance	357	1		µmhos/cm	1	9/26/2011 12:41:00 PM
PH BY SM 4500 H+B						
Lab pH	7.39	0		su	1	9/26/2011 12:41:00 PM
INORGANIC NON-METALS						
Total dissolved solids	226	20		mg/L	1	9/21/2011 9:00:00 AM
PHYSICAL TESTS						
Total suspended solids	< 5	5		mg/L	1	9/21/2011 7:09:04 AM
INORGANIC NON-METALS						
Alkalinity to pH 4.5	107	5		mg/L CaCO ₃	1	9/26/2011 12:41:00 PM
INORGANIC NON-METALS						
Nitrate - Nitrite	0.05	0.05		mg/L as N	1	9/20/2011 7:40:00 PM
INORGANIC NON-METALS						
Bromide	0.3	0.2		mg/L	1	9/20/2011 7:40:00 PM
Chloride	39	1		mg/L	1	9/20/2011 7:40:00 PM
Sulfate	19	2		mg/L	1	9/20/2011 7:40:00 PM
INORGANIC METALS						
Barium	0.09	0.01		mg/L	1	9/23/2011 5:02:00 AM
Calcium	43.0	0.1		mg/L	1	9/23/2011 5:02:00 AM
Iron	< 0.05	0.05		mg/L	1	9/23/2011 5:02:00 AM
Magnesium	9.0	0.1		mg/L	1	9/23/2011 5:02:00 AM
Manganese	0.12	0.01		mg/L	1	9/23/2011 5:02:00 AM
Sodium	19.0	0.2		mg/L	1	9/23/2011 5:02:00 AM
Strontium	1.09	0.01		mg/L	1	9/23/2011 5:02:00 AM
Hardness (SM 2340B)	145	1.0		mg/L CaCO ₃	1	9/23/2011 5:02:00 AM
INDICATOR ORGANIC PARAMETERS						
Oil & Grease	< 5	5		mg/L	1.08	9/23/2011 10:58:00 AM



Laboratory Results

Geochemical Testing

Date: 07-Oct-11

CLIENT:	RESOURCE MANAGEMENT SERVICES	Client Sample ID:	7/9/19
Lab Order:	G1109712	Sampled By:	Client
Project:	BS-P	Collection Date:	9/20/2011 12:25:00 PM
Lab ID:	G1109712-004	Received Date:	9/20/2011 6:26:09 PM
Matrix:	AQUEOUS		

Analyses	Result	QL	Q	Units	DF	Date Analyzed
INORGANIC NON-METALS						
Acidity to pH 8.2	-65	0		mg/L CaCO3	1	9/27/2011 9:15:00 AM
PHYSICAL TESTS						
Specific Conductance	222	1		µmhos/cm	1	9/26/2011 12:45:00 PM
PH BY SM 4500 H+B						
Lab pH	7.29	0		su	1	9/26/2011 12:45:00 PM
INORGANIC NON-METALS						
Total dissolved solids	156	20		mg/L	1	9/21/2011 9:01:00 AM
PHYSICAL TESTS						
Total suspended solids	< 5	5		mg/L	1	9/21/2011 7:10:20 AM
INORGANIC NON-METALS						
Alkalinity to pH 4.5	80	5		mg/L CaCO3	1	9/26/2011 12:45:00 PM
INORGANIC NON-METALS						
Nitrate - Nitrite	0.30	0.05		mg/L as N	1	9/20/2011 7:57:00 PM
INORGANIC NON-METALS						
Bromide	< 0.2	0.2		mg/L	1	9/20/2011 7:57:00 PM
Chloride	9	1		mg/L	1	9/20/2011 7:57:00 PM
Sulfate	21	2		mg/L	1	9/20/2011 7:57:00 PM
INORGANIC METALS						
Barium	0.08	0.01		mg/L	1	9/23/2011 7:16:00 AM
Calcium	24.9	0.1		mg/L	1	9/23/2011 7:16:00 AM
Iron	0.43	0.05		mg/L	1	9/23/2011 7:16:00 AM
Magnesium	6.5	0.1		mg/L	1	9/23/2011 7:16:00 AM
Manganese	0.01	0.01		mg/L	1	9/23/2011 7:16:00 AM
Sodium	13.5	0.2		mg/L	1	9/23/2011 7:16:00 AM
Strontium	1.23	0.01		mg/L	1	9/23/2011 7:16:00 AM
Hardness (SM 2340B)	89.2	1.0		mg/L CaCO3	1	9/23/2011 7:16:00 AM
INDICATOR ORGANIC PARAMETERS						
Oil & Grease	< 5	5		mg/L	1	9/23/2011 10:59:00 AM

Laboratory Results

Geochemical Testing

Date: 07-Oct-11

CLIENT:	RESOURCE MANAGEMENT SERVICES	Client Sample ID:	8/9/19
Lab Order:	G1109712		
Project:	BS-P	Sampled By:	Client
Lab ID:	G1109712-005	Collection Date:	9/20/2011 1:50:00 PM
Matrix:	AQUEOUS	Received Date:	9/20/2011 6:26:09 PM

Analyses	Result	QL	Q	Units	DF	Date Analyzed
INORGANIC NON-METALS						
Acidity to pH 8.2	-191	0		mg/L CaCO ₃	1	9/27/2011 9:16:00 AM
PHYSICAL TESTS						
Specific Conductance	391	1		µmhos/cm	1	9/26/2011 12:49:00 PM
PH BY SM 4500 H+B						
Lab pH	7.82	0		su	1	9/26/2011 12:49:00 PM
INORGANIC NON-METALS						
Total dissolved solids	246	20		mg/L	1	9/21/2011 9:01:00 AM
PHYSICAL TESTS						
Total suspended solids	< 5	5		mg/L	1	9/21/2011 7:10:21 AM
INORGANIC NON-METALS						
Alkalinity to pH 4.5	200	5		mg/L CaCO ₃	1	9/26/2011 12:49:00 PM
INORGANIC NON-METALS						
Nitrate - Nitrite	0.07	0.05		mg/L as N	1	9/20/2011 8:14:00 PM
INORGANIC NON-METALS						
Bromide	< 0.2	0.2		mg/L	1	9/20/2011 8:14:00 PM
Chloride	5	1		mg/L	1	9/20/2011 8:14:00 PM
Sulfate	11	2		mg/L	1	9/20/2011 8:14:00 PM
INORGANIC METALS						
Barium	0.22	0.01		mg/L	1	9/23/2011 4:20:00 PM
Calcium	48.2	0.1		mg/L	1	9/23/2011 4:20:00 PM
Iron	0.07	0.05		mg/L	1	9/23/2011 4:20:00 PM
Magnesium	16.6	0.1		mg/L	1	9/23/2011 4:20:00 PM
Manganese	0.05	0.01		mg/L	1	9/23/2011 4:20:00 PM
Sodium	23.1	0.2		mg/L	1	9/23/2011 4:20:00 PM
Strontium	0.89	0.01		mg/L	1	9/23/2011 4:20:00 PM
Hardness (SM 2340B)	188	1.0		mg/L CaCO ₃	1	9/23/2011 4:20:00 PM
INDICATOR ORGANIC PARAMETERS						
Oil & Grease	< 6	6		mg/L	1.28	9/23/2011 10:59:00 AM

Laboratory Results

Geochemical Testing

Date: 07-Oct-11

CLIENT:	RESOURCE MANAGEMENT SERVICES	Client Sample ID:	9/9/19
Lab Order:	G1109712	Sampled By:	Client
Project:	BS-P	Collection Date:	9/20/2011 2:30:00 PM
Lab ID:	G1109712-006	Received Date:	9/20/2011 6:26:09 PM
Matrix:	AQUEOUS		

Analyses	Result	QL	Q	Units	DF	Date Analyzed
INORGANIC NON-METALS						Analyst: LNW
Acidity to pH 8.2	-38	0		mg/L CaCO3	1	9/27/2011 9:18:00 AM
PHYSICAL TESTS						Analyst: LNW
Specific Conductance	152	1		µmhos/cm	1	9/26/2011 12:52:00 PM
PH BY SM 4500 H+B						Analyst: LNW
Lab pH	7.02	0		su	1	9/26/2011 12:52:00 PM
INORGANIC NON-METALS						Analyst: KLS
Total dissolved solids	130	20		mg/L	1	9/21/2011 9:01:00 AM
PHYSICAL TESTS						Analyst: KLS
Total suspended solids	13	5		mg/L	1	9/21/2011 7:10:23 AM
INORGANIC NON-METALS						Analyst: LNW
Alkalinity to pH 4.5	48	5		mg/L CaCO3	1	9/26/2011 12:52:00 PM
INORGANIC NON-METALS						Analyst: CAS
Nitrate - Nitrite	0.33	0.05		mg/L as N	1	9/20/2011 8:31:00 PM
INORGANIC NON-METALS						Analyst: CAS
Bromide	< 0.2	0.2		mg/L	1	9/20/2011 8:31:00 PM
Chloride	8	1		mg/L	1	9/20/2011 8:31:00 PM
Sulfate	9	2		mg/L	1	9/20/2011 8:31:00 PM
INORGANIC METALS						Analyst: JAS
Aluminum	0.1	0.1		mg/L	1	9/23/2011 4:35:00 PM
Barium	0.05	0.01		mg/L	1	9/23/2011 4:35:00 PM
Calcium	18.9	0.1		mg/L	1	9/23/2011 4:35:00 PM
Iron	0.14	0.05		mg/L	1	9/23/2011 4:35:00 PM
Magnesium	5.7	0.1		mg/L	1	9/23/2011 4:35:00 PM
Manganese	0.02	0.01		mg/L	1	9/23/2011 4:35:00 PM
Potassium	2.0	0.5		mg/L	1	9/23/2011 4:35:00 PM
Sodium	4.6	0.2		mg/L	1	9/23/2011 4:35:00 PM
Strontium	0.11	0.01		mg/L	1	9/23/2011 4:35:00 PM
Hardness (SM 2340B)	70.6	1.0		mg/L CaCO3	1	9/23/2011 4:35:00 PM

Laboratory Results

Geochemical Testing

Date: 07-Oct-11

CLIENT:	RESOURCE MANAGEMENT SERVICES	Client Sample ID:	10/9/19
Lab Order:	G1109712	Sampled By:	Client
Project:	BS-P	Collection Date:	9/20/2011 3:10:00 PM
Lab ID:	G1109712-007	Received Date:	9/20/2011 6:26:09 PM
Matrix:	AQUEOUS		

Analyses	Result	QL	Q	Units	DF	Date Analyzed
INORGANIC NON-METALS						Analyst: LNW
Acidity to pH 8.2	-7	0		mg/L CaCO ₃	1	9/27/2011 9:29:00 AM
PHYSICAL TESTS						Analyst: LNW
Specific Conductance	70	1		µmhos/cm	1	9/26/2011 12:55:00 PM
PH BY SM 4500 H+B						Analyst: LNW
Lab pH	7.08	0		su	1	9/26/2011 12:55:00 PM
INORGANIC NON-METALS						Analyst: KLS
Total dissolved solids	72	20		mg/L	1	9/21/2011 9:01:00 AM
PHYSICAL TESTS						Analyst: KLS
Total suspended solids	< 5	5		mg/L	1	9/21/2011 7:10:24 AM
INORGANIC NON-METALS						Analyst: LNW
Alkalinity to pH 4.5	34	5		mg/L CaCO ₃	1	9/26/2011 12:55:00 PM
INORGANIC NON-METALS						Analyst: CAS
Nitrate - Nitrite	0.63	0.05		mg/L as N	1	9/20/2011 8:48:00 PM
INORGANIC NON-METALS						Analyst: CAS
Bromide	< 0.2	0.2		mg/L	1	9/20/2011 8:48:00 PM
Chloride	1	1		mg/L	1	9/20/2011 8:48:00 PM
Sulfate	8	2		mg/L	1	9/20/2011 8:48:00 PM
INORGANIC METALS						Analyst: JAS
Aluminum	< 0.1	0.1		mg/L	1	9/23/2011 4:40:00 PM
Barium	0.01	0.01		mg/L	1	9/23/2011 4:40:00 PM
Calcium	7.4	0.1		mg/L	1	9/23/2011 4:40:00 PM
Iron	< 0.05	0.05		mg/L	1	9/23/2011 4:40:00 PM
Magnesium	2.7	0.1		mg/L	1	9/23/2011 4:40:00 PM
Manganese	0.01	0.01		mg/L	1	9/23/2011 4:40:00 PM
Potassium	1.5	0.5		mg/L	1	9/23/2011 4:40:00 PM
Sodium	2.2	0.2		mg/L	1	9/23/2011 4:40:00 PM
Strontium	0.03	0.01		mg/L	1	9/23/2011 4:40:00 PM
Hardness (SM 2340B)	29.5	1.0		mg/L CaCO ₃	1	9/23/2011 4:40:00 PM



Laboratory Results

Geochemical Testing

Date: 07-Oct-11

CLIENT:	RESOURCE MANAGEMENT SERVICES	Client Sample ID: 11/9/19
Lab Order:	G1109712	
Project:	BS-P	Sampled By: Client
Lab ID:	G1109712-008	Collection Date: 9/20/2011 3:45:00 PM
Matrix:	AQUEOUS	Received Date: 9/20/2011 6:26:09 PM

Analyses	Result	QL	Q	Units	DF	Date Analyzed
INORGANIC NON-METALS						
Acidity to pH 8.2	-70	0		mg/L CaCO3	1	9/27/2011 9:30:00 AM
PHYSICAL TESTS						
Specific Conductance	296	1		µmhos/cm	1	9/26/2011 12:59:00 PM
PH BY SM 4500 H+B						
Lab pH	7.53	0		su	1	9/26/2011 12:59:00 PM
INORGANIC NON-METALS						
Total dissolved solids	204	20		mg/L	1	9/21/2011 9:01:00 AM
PHYSICAL TESTS						
Total suspended solids	< 5	5		mg/L	1	9/21/2011 7:10:26 AM
INORGANIC NON-METALS						
Alkalinity to pH 4.5	92	5		mg/L CaCO3	1	9/26/2011 12:59:00 PM
INORGANIC NON-METALS						
Nitrate - Nitrite	< 0.05	0.05		mg/L as N	1	9/20/2011 9:05:00 PM
INORGANIC NON-METALS						
Bromide	< 0.2	0.2		mg/L	1	9/20/2011 9:05:00 PM
Chloride	36	1		mg/L	1	9/20/2011 9:05:00 PM
Sulfate	14	2		mg/L	1	9/20/2011 9:05:00 PM
INORGANIC METALS						
Aluminum	< 0.1	0.1		mg/L	1	9/23/2011 4:49:00 PM
Barium	0.21	0.01		mg/L	1	9/23/2011 4:49:00 PM
Calcium	35.4	0.1		mg/L	1	9/23/2011 4:49:00 PM
Iron	0.10	0.05		mg/L	1	9/23/2011 4:49:00 PM
Magnesium	9.8	0.1		mg/L	1	9/23/2011 4:49:00 PM
Manganese	0.33	0.01		mg/L	1	9/23/2011 4:49:00 PM
Potassium	1.2	0.5		mg/L	1	9/23/2011 4:49:00 PM
Sodium	12.9	0.2		mg/L	1	9/23/2011 4:49:00 PM
Strontium	0.92	0.01		mg/L	1	9/23/2011 4:49:00 PM
Hardness (SM 2340B)	129	1.0		mg/L CaCO3	1	9/23/2011 4:49:00 PM
INDICATOR ORGANIC PARAMETERS						
Oil & Grease	< 5	5		mg/L	1.01	9/23/2011 11:00:00 AM

Shuttle/Cooler ID#:

CHAIN OF CUSTODY

Geochemical Testing

Form F-5002, 06.08

Geochemical Testing • 2005 North Center Avenue • Somerset PA 15501 • (814) 443-1671 • Fax (814) 445-6729

Billing Client: RWS Contact (Company): RWS Phone: ()

Address: e-mail: Fax: ()

City: State: Zip: Sampled by: RB Preservatives by: Sampler GT

WO#: Project: PO/Quote#:

Sample Matrix: GW Ground Water SW Surface Water PW Potable Water WW Wastewater SO Soil SL Sludge nHZ Not Hazardous / HZ Hazardous PCBs

Sample Type: G Grab C Composite D Distribution/DW R Raw/DW S Special/DW O Other Containers Supplied by: Client GT Lab

Sample Location/Description	Lab Number	Sample Matrix	Date	Time (Military)	Sample Type	**Analyses Requested	Remarks/Preservatives, etc	Number of Containers
RWJ 1/9/19	61109711	nHZ / HZ SW	9-20-11	various	G	pH + TDS only	Field Filtered: Y / <input checked="" type="checkbox"/> N	1
RWJ 2/9/19	602	nHZ / HZ SW				"	Field Filtered: Y / <input checked="" type="checkbox"/> N	1
RWJ 3/9/19	603	nHZ / HZ SW				"	Field Filtered: Y / <input checked="" type="checkbox"/> N	1
RWJ 4/9/19	61109712	nHZ / HZ SW				BS-P Group + Al+K	Field Filtered: Y / <input checked="" type="checkbox"/> N	3
RWJ 5/9/19	602	nHZ / HZ PW				BS-P + O+G + Al+K	Field Filtered: Y / <input checked="" type="checkbox"/> N	4
RWJ 6/9/19	603	nHZ / HZ PW				"	Field Filtered: Y / <input checked="" type="checkbox"/> N	4
RWJ 7/9/19	604	nHZ / HZ PW				"	Field Filtered: Y / <input checked="" type="checkbox"/> N	4
RWJ 8/9/19	605	nHZ / HZ PW				"	Field Filtered: Y / <input checked="" type="checkbox"/> N	4

Note Deficiencies Here:

Relinquished by (Company & Signature)	Date	Time (Military)	Received by (Company & Signature)	Date	Time (Military)
<u>[Signature]</u>	9-20-11	1310	<u>[Signature]</u>	9-20-11	18:50
<u>[Signature]</u>	9-20-11	1700	<u>[Signature]</u>	9/20/11	18:26

SAMPLES MUST BE PRESERVED ON ICE.

Ice present on receipt: Yes or No Cooler Temp (°C) on receipt: 6

Geochemical Testing

Form F-5002, 06.08

CHAIN OF CUSTODY

Shuttle/Cooler ID#: _____

Geochemical Testing • 2005 North Center Avenue • Somerset PA 15501 • (814) 443-1671 • Fax (814) 445-6729

Billing Client: PKS **Contact (Company):** RMJ **Phone:** () _____
Address: _____ **e-mail:** _____ **Fax:** () _____
City: _____ **State:** _____ **Zip:** _____ **Preservatives by:** GT
WO#: 116 9712 **Project:** _____ **PO/Quote#:** _____

Sample Matrix: GW Ground Water SW Surface Water PW Potable Water WW Wastewater SO Soil SL Sludge nHZ Not Hazardous / HZ Hazardous PCBs
Sample Type: G Grab C Composite D Distribution/DW R Raw/DW S Special/DW O Other Client GT Lab

Sample Location/Description	Lab Number	Sample Matrix	Date	Time (Military)	Sample Type	**Analyses Requested	Remarks/Preservatives, etc	Number of Containers
RMJ 9/9/19	006	nHZ / SW		various	G	BS-P + A1 + K	Field Filtered: Y / X	3
RMJ 10/9/19	007	nHZ / SW		↓	↓	BS-P + A1 + K	Field Filtered: Y / X	3
RMJ 11/9/19	008	nHZ / PW		↓	↓	BS-P + O + G + A1 + K	Field Filtered: Y / X	4
		nHZ / HZ					Field Filtered: Y / N	
		nHZ / HZ					Field Filtered: Y / N	
		nHZ / HZ					Field Filtered: Y / N	
		nHZ / HZ					Field Filtered: Y / N	
		nHZ / HZ					Field Filtered: Y / N	
		nHZ / HZ					Field Filtered: Y / N	

Note Deficiencies Here: _____

Relinquished by (Company & Signature): [Signature] **Date:** 9-20-11 1315 **Time (Military):** 1315 **Received by (Company & Signature):** [Signature] **Date:** 9-20-11 1450 **Time (Military):** 1450
Relinquished by (Company & Signature): [Signature] **Date:** 9-20-11 1700 **Time (Military):** 1700 **Received by (Company & Signature):** [Signature] **Date:** 9/20/11 1906 **Time (Military):** 1906

SAMPLES MUST BE PRESERVED ON ICE. Ice present on receipt: Yes or No Cooler Temp (°C) on receipt: 6

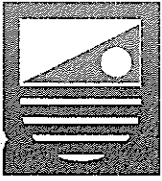

GEOCHEMICAL TESTING

Environmental and Energy Analysis

2005 N. Center Ave.
Somerset, PA 15501

814/443-1671
814/445-6666
FAX: 814/445-6729

Monday, September 26, 2011

RICK BONAZZA
RESOURCE MANAGEMENT SERVICES
65 FENTON ROAD
INDIANA, PA 15701

RE: BS-P

Dear RICK BONAZZA:

Order No.: G1109596

Geochemical Testing received 7 sample(s) on 9/16/2011 for the analyses presented in the following report.

There were no problems with the analyses and all QC data met NELAC, EPA, and laboratory specifications except where noted in the Case Narrative or Laboratory Results.

If you have any questions regarding these tests results, please feel free to call.

Sincerely,

Timothy W. Bergstresser
Director of Technical Services

Geochemical Testing

Date: 26-Sep-11

CLIENT: RESOURCE MANAGEMENT SERVICES
Project: BS-P
Lab Order: G1109596

CASE NARRATIVE

No problems were encountered during analysis of this workorder, except if noted in this report.

Legend:

ND - Not Detected at the Quantitation Limit	S - Spike Recovery outside accepted recovery limits
J - Indicates an estimated value.	R - RPD outside accepted recovery limits
U - The analyte was not detected at or above the listed concentration, which is below the laboratory quantitation limit.	E - Value above quantitation range
B - Analyte detected in the associated Method Blank	** - Value exceeds Action Limit
Q - Qualifier	H - Method Hold Time Exceeded
QL - Quantitation Limit	MCL - Contaminant Limit
DF - Dilution Factor	



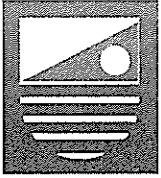

GEOCHEMICAL TESTING

Environmental and Energy Analysis

2005 N. Center Ave.
Somerset, PA 15501

814/443-1671
814/445-6666
FAX: 814/445-6729

Monday, September 26, 2011

RICK BONAZZA
RESOURCE MANAGEMENT SERVICES
65 FENTON ROAD
INDIANA, PA 15701

Order No.: G1109597

Dear RICK BONAZZA:

Geochemical Testing received 4 sample(s) on 9/16/2011 for the analyses presented in the following report.

There were no problems with the analyses and all QC data met NELAC, EPA, and laboratory specifications except where noted in the Case Narrative or Laboratory Results.

If you have any questions regarding these tests results, please feel free to call.

Sincerely,

Timothy W. Bergstresser
Director of Technical Services

Geochemical Testing

Date: 26-Sep-11

CLIENT: RESOURCE MANAGEMENT SERVICES

Project:

CASE NARRATIVE

Lab Order: G1109597

No problems were encountered during analysis of this workorder, except if noted in this report.

Legend: ND - Not Detected at the Quantitation Limit
J - Indicates an estimated value.
U - The analyte was not detected at or above the listed concentration, which is below the laboratory quantitation limit.
B - Analyte detected in the associated Method Blank
Q - Qualifier QL - Quantitation Limit DF - Dilution Factor
S - Spike Recovery outside accepted recovery limits
R - RPD outside accepted recovery limits
E - Value above quantitation range
** - Value exceeds Action Limit
H - Method Hold Time Exceeded
MCL - Contaminant Limit



Laboratory Results

Geochemical Testing

Date: 26-Sep-11

CLIENT:	RESOURCE MANAGEMENT SERVICES	Client Sample ID:	RMS 1/9/14
Lab Order:	G1109597		
Project:		Sampled By:	Client
Lab ID:	G1109597-001	Collection Date:	9/14/2011 11:20:00 AM
Matrix:	AQUEOUS	Received Date:	9/16/2011 5:33:41 AM

Analyses	Result	QL	Q	Units	DF	Date Analyzed
PH BY SM 4500 H+B						Analyst: LNW
Lab pH	5.64	0		su	1	9/22/2011 12:35:00 PM
INORGANIC NON-METALS						Analyst: KLS
Total dissolved solids	42	20		mg/L	1	9/16/2011 8:17:00 AM

Laboratory Results

Geochemical Testing

Date: 26-Sep-11

CLIENT:	RESOURCE MANAGEMENT SERVICES	Client Sample ID:	RMS 2/9/14
Lab Order:	G1109596	Sampled By:	Client
Project:	BS-P	Collection Date:	9/14/2011 11:35:00 AM
Lab ID:	G1109596-001	Received Date:	9/16/2011 5:08:05 AM
Matrix:	AQUEOUS		

Analyses	Result	QL	Q	Units	DF	Date Analyzed
INORGANIC NON-METALS						
Acidity to pH 8.2	-1	0		mg/L CaCO3	1	9/23/2011 9:10:00 AM
PHYSICAL TESTS						
Specific Conductance	54	1		µmhos/cm	1	9/22/2011 11:56:00 AM
PH BY SM 4500 H+B						
Lab pH	6.61	0		su	1	9/22/2011 11:56:00 AM
INORGANIC NON-METALS						
Total dissolved solids	46	20		mg/L	1	9/16/2011 8:14:00 AM
PHYSICAL TESTS						
Total suspended solids	< 5	5		mg/L	1	9/16/2011 6:44:28 AM
INORGANIC NON-METALS						
Alkalinity to pH 4.5	23	5		mg/L CaCO3	1	9/22/2011 11:56:00 AM
INORGANIC NON-METALS						
Nitrate - Nitrite	0.11	0.05		mg/L as N	1	9/16/2011 9:47:00 AM
INORGANIC NON-METALS						
Bromide	< 0.2	0.2		mg/L	1	9/16/2011 9:47:00 AM
Chloride	< 1	1		mg/L	1	9/16/2011 9:47:00 AM
Sulfate	9	2		mg/L	1	9/16/2011 9:47:00 AM
INORGANIC METALS						
Aluminum	< 0.1	0.1		mg/L	1	9/21/2011 9:12:00 PM
Barium	0.02	0.01		mg/L	1	9/21/2011 9:12:00 PM
Calcium	4.2	0.1		mg/L	1	9/21/2011 9:12:00 PM
Iron	0.17	0.05		mg/L	1	9/21/2011 9:12:00 PM
Magnesium	2.1	0.1		mg/L	1	9/21/2011 9:12:00 PM
Manganese	0.01	0.01		mg/L	1	9/21/2011 9:12:00 PM
Potassium	0.8	0.5		mg/L	1	9/21/2011 9:12:00 PM
Sodium	1.5	0.2		mg/L	1	9/21/2011 9:12:00 PM
Strontium	0.03	0.01		mg/L	1	9/21/2011 9:12:00 PM
Hardness (SM 2340B)	18.8	1.0		mg/L CaCO3	1	9/21/2011 9:12:00 PM



Laboratory Results

Geochemical Testing

Date: 26-Sep-11

CLIENT:	RESOURCE MANAGEMENT SERVICES	Client Sample ID:	RMS 3/9/14
Lab Order:	G1109596	Sampled By:	Client
Project:	BS-P	Collection Date:	9/14/2011 11:50:00 AM
Lab ID:	G1109596-002	Received Date:	9/16/2011 5:08:05 AM
Matrix:	AQUEOUS		

Analyses	Result	QL	Q	Units	DF	Date Analyzed
INORGANIC NON-METALS						
Acidity to pH 8.2	4	0		mg/L CaCO ₃	1	9/23/2011 9:14:00 AM
PHYSICAL TESTS						
Specific Conductance	47	1		µmhos/cm	1	9/22/2011 12:18:00 PM
PH BY SM 4500 H+B						
Lab pH	6.10	0		su	1	9/22/2011 12:18:00 PM
INORGANIC NON-METALS						
Total dissolved solids	44	20		mg/L	1	9/16/2011 8:14:00 AM
PHYSICAL TESTS						
Total suspended solids	7	5		mg/L	1	9/16/2011 6:44:29 AM
INORGANIC NON-METALS						
Alkalinity to pH 4.5	18	5		mg/L CaCO ₃	1	9/22/2011 12:18:00 PM
INORGANIC NON-METALS						
Nitrate - Nitrite	< 0.05	0.05		mg/L as N	1	9/16/2011 10:04:00 AM
INORGANIC NON-METALS						
Bromide	< 0.2	0.2		mg/L	1	9/16/2011 10:04:00 AM
Chloride	< 1	1		mg/L	1	9/16/2011 10:04:00 AM
Sulfate	8	2		mg/L	1	9/16/2011 10:04:00 AM
INORGANIC METALS						
Aluminum	0.4	0.1		mg/L	1	9/21/2011 9:17:00 PM
Barium	0.05	0.01		mg/L	1	9/21/2011 9:17:00 PM
Calcium	3.6	0.1		mg/L	1	9/21/2011 9:17:00 PM
Iron	0.43	0.05		mg/L	1	9/21/2011 9:17:00 PM
Magnesium	1.4	0.1		mg/L	1	9/21/2011 9:17:00 PM
Manganese	0.06	0.01		mg/L	1	9/21/2011 9:17:00 PM
Potassium	0.8	0.5		mg/L	1	9/21/2011 9:17:00 PM
Sodium	1.7	0.2		mg/L	1	9/21/2011 9:17:00 PM
Strontium	0.03	0.01		mg/L	1	9/21/2011 9:17:00 PM
Hardness (SM 2340B)	14.7	1.0		mg/L CaCO ₃	1	9/21/2011 9:17:00 PM



Laboratory Results

Geochemical Testing

Date: 26-Sep-11

CLIENT:	RESOURCE MANAGEMENT SERVICES	Client Sample ID:	RMS 4/9/14
Lab Order:	G1109596	Sampled By:	Client
Project:	BS-P	Collection Date:	9/14/2011 12:00:00 PM
Lab ID:	G1109596-003	Received Date:	9/16/2011 5:08:05 AM
Matrix:	AQUEOUS		

Analyses	Result	QL	Q	Units	DF	Date Analyzed
INORGANIC NON-METALS						Analyst: LNW
Acidity to pH 8.2	-7	0		mg/L CaCO ₃	1	9/23/2011 9:16:00 AM
PHYSICAL TESTS						Analyst: LNW
Specific Conductance	88	1		µmhos/cm	1	9/22/2011 12:21:00 PM
PH BY SM 4500 H+B						Analyst: LNW
Lab pH	6.90	0		su	1	9/22/2011 12:21:00 PM
INORGANIC NON-METALS						Analyst: KLS
Total dissolved solids	72	20		mg/L	1	9/16/2011 8:15:00 AM
PHYSICAL TESTS						Analyst: KLS
Total suspended solids	6	5		mg/L	1	9/16/2011 6:44:30 AM
INORGANIC NON-METALS						Analyst: LNW
Alkalinity to pH 4.5	34	5		mg/L CaCO ₃	1	9/22/2011 12:21:00 PM
INORGANIC NON-METALS						Analyst: CAS
Nitrate - Nitrite	0.19	0.05		mg/L as N	1	9/16/2011 10:21:00 AM
INORGANIC NON-METALS						Analyst: CAS
Bromide	< 0.2	0.2		mg/L	1	9/16/2011 10:21:00 AM
Chloride	2	1		mg/L	1	9/16/2011 10:21:00 AM
Sulfate	13	2		mg/L	1	9/16/2011 10:21:00 AM
INORGANIC METALS						Analyst: JAS
Aluminum	0.2	0.1		mg/L	1	9/22/2011 2:53:00 PM
Barium	0.06	0.01		mg/L	1	9/21/2011 9:36:00 PM
Calcium	8.7	0.1		mg/L	1	9/21/2011 9:36:00 PM
Iron	0.22	0.05		mg/L	1	9/21/2011 9:36:00 PM
Magnesium	2.4	0.1		mg/L	1	9/21/2011 9:36:00 PM
Manganese	0.02	0.01		mg/L	1	9/21/2011 9:36:00 PM
Potassium	0.9	0.5		mg/L	1	9/21/2011 9:36:00 PM
Sodium	2.5	0.2		mg/L	1	9/21/2011 9:36:00 PM
Strontium	0.06	0.01		mg/L	1	9/21/2011 9:36:00 PM
Hardness (SM 2340B)	31.6	1.0		mg/L CaCO ₃	1	9/21/2011 9:36:00 PM

Laboratory Results

Geochemical Testing

Date: 26-Sep-11

CLIENT:	RESOURCE MANAGEMENT SERVICES	Client Sample ID:	RMS 5/9/14
Lab Order:	G1109597		
Project:		Sampled By:	Client
Lab ID:	G1109597-002	Collection Date:	9/14/2011 12:15:00 PM
Matrix:	AQUEOUS	Received Date:	9/16/2011 5:33:41 AM

Analyses	Result	QL	Q	Units	DF	Date Analyzed
PH BY SM 4500 H+B						Analyst: LNW
Lab pH	5.89	0		su	1	9/22/2011 1:39:00 PM
INORGANIC NON-METALS						Analyst: KLS
Total dissolved solids	62	20		mg/L	1	9/16/2011 8:17:00 AM

Laboratory Results

Geochemical Testing

Date: 26-Sep-11

CLIENT:	RESOURCE MANAGEMENT SERVICES	Client Sample ID:	RMS 6/9/14
Lab Order:	G1109596	Sampled By:	Client
Project:	BS-P	Collection Date:	9/14/2011 1:20:00 PM
Lab ID:	G1109596-004	Received Date:	9/16/2011 5:08:05 AM
Matrix:	AQUEOUS		

Analyses	Result	QL	Q	Units	DF	Date Analyzed
INORGANIC NON-METALS						
Acidity to pH 8.2	-7	0		mg/L CaCO ₃	1	9/23/2011 9:18:00 AM
PHYSICAL TESTS						
Specific Conductance	85	1		µmhos/cm	1	9/22/2011 12:24:00 PM
PH BY SM 4500 H+B						
Lab pH	6.57	0		su	1	9/22/2011 12:24:00 PM
INORGANIC NON-METALS						
Total dissolved solids	64	20		mg/L	1	9/16/2011 8:15:00 AM
PHYSICAL TESTS						
Total suspended solids	5	5		mg/L	1	9/16/2011 6:44:32 AM
INORGANIC NON-METALS						
Alkalinity to pH 4.5	31	5		mg/L CaCO ₃	1	9/22/2011 12:24:00 PM
INORGANIC NON-METALS						
Nitrate - Nitrite	0.33	0.05		mg/L as N	1	9/16/2011 10:38:00 AM
INORGANIC NON-METALS						
Bromide	< 0.2	0.2		mg/L	1	9/16/2011 10:38:00 AM
Chloride	2	1		mg/L	1	9/16/2011 10:38:00 AM
Sulfate	12	2		mg/L	1	9/16/2011 10:38:00 AM
INORGANIC METALS						
Aluminum	0.2	0.1		mg/L	1	9/22/2011 2:57:00 PM
Barium	0.12	0.01		mg/L	1	9/21/2011 9:41:00 PM
Calcium	8.2	0.1		mg/L	1	9/21/2011 9:41:00 PM
Iron	0.11	0.05		mg/L	1	9/21/2011 9:41:00 PM
Magnesium	2.3	0.1		mg/L	1	9/21/2011 9:41:00 PM
Manganese	< 0.01	0.01		mg/L	1	9/21/2011 9:41:00 PM
Potassium	0.9	0.5		mg/L	1	9/21/2011 9:41:00 PM
Sodium	2.5	0.2		mg/L	1	9/21/2011 9:41:00 PM
Strontium	0.05	0.01		mg/L	1	9/21/2011 9:41:00 PM
Hardness (SM 2340B)	30.1	1.0		mg/L CaCO ₃	1	9/21/2011 9:41:00 PM

Laboratory Results

Date: 26-Sep-11

Geochemical Testing

CLIENT:	RESOURCE MANAGEMENT SERVICES	Client Sample ID:	RMS 7/9/14
Lab Order:	G1109597		
Project:		Sampled By:	Client
Lab ID:	G1109597-003	Collection Date:	9/14/2011 2:45:00 PM
Matrix:	AQUEOUS	Received Date:	9/16/2011 5:33:41 AM

Analyses	Result	QL	Q	Units	DF	Date Analyzed
PH BY SM 4500 H+B						Analyst: LNW
Lab pH	7.55	0		su	1	9/22/2011 1:41:00 PM
INORGANIC NON-METALS						Analyst: KLS
Total dissolved solids	108	20		mg/L	1	9/16/2011 8:17:00 AM

Laboratory Results

Geochemical Testing

Date: 26-Sep-11

CLIENT:	RESOURCE MANAGEMENT SERVICES	Client Sample ID:	RMS 8/9/14
Lab Order:	G1109596	Sampled By:	Client
Project:	BS-P	Collection Date:	9/14/2011 3:00:00 PM
Lab ID:	G1109596-005	Received Date:	9/16/2011 5:08:05 AM
Matrix:	AQUEOUS		

Analyses	Result	QL	Q	Units	DF	Date Analyzed
INORGANIC NON-METALS						
Acidity to pH 8.2	-18	0		mg/L CaCO3	1	9/23/2011 9:19:00 AM
PHYSICAL TESTS						
Specific Conductance	89	1		µmhos/cm	1	9/22/2011 12:27:00 PM
PH BY SM 4500 H+B						
Lab pH	7.41	0		su	1	9/22/2011 12:27:00 PM
INORGANIC NON-METALS						
Total dissolved solids	66	20		mg/L	1	9/16/2011 8:16:00 AM
PHYSICAL TESTS						
Total suspended solids	6	5		mg/L	1	9/16/2011 6:44:34 AM
INORGANIC NON-METALS						
Alkalinity to pH 4.5	44	5		mg/L CaCO3	1	9/22/2011 12:27:00 PM
INORGANIC NON-METALS						
Nitrate - Nitrite	< 0.05	0.05		mg/L as N	1	9/16/2011 10:55:00 AM
INORGANIC NON-METALS						
Bromide	< 0.2	0.2		mg/L	1	9/16/2011 10:55:00 AM
Chloride	< 1	1		mg/L	1	9/16/2011 10:55:00 AM
Sulfate	11	2		mg/L	1	9/16/2011 10:55:00 AM
INORGANIC METALS						
Aluminum	< 0.1	0.1		mg/L	1	9/22/2011 3:01:00 PM
Barium	0.02	0.01		mg/L	1	9/21/2011 9:46:00 PM
Calcium	9.9	0.1		mg/L	1	9/21/2011 9:46:00 PM
Iron	< 0.05	0.05		mg/L	1	9/21/2011 9:46:00 PM
Magnesium	3.1	0.1		mg/L	1	9/21/2011 9:46:00 PM
Manganese	< 0.01	0.01		mg/L	1	9/21/2011 9:46:00 PM
Potassium	0.8	0.5		mg/L	1	9/21/2011 9:46:00 PM
Sodium	1.6	0.2		mg/L	1	9/21/2011 9:46:00 PM
Strontium	0.05	0.01		mg/L	1	9/21/2011 9:46:00 PM
Hardness (SM 2340B)	37.3	1.0		mg/L CaCO3	1	9/21/2011 9:46:00 PM



Laboratory Results

Geochemical Testing

Date: 26-Sep-11

CLIENT:	RESOURCE MANAGEMENT SERVICES	Client Sample ID:	RMS 9/9/14
Lab Order:	G1109597		
Project:		Sampled By:	Client
Lab ID:	G1109597-004	Collection Date:	9/14/2011 3:35:00 PM
Matrix:	AQUEOUS	Received Date:	9/16/2011 5:33:41 AM

Analyses	Result	QL	Q	Units	DF	Date Analyzed
PH BY SM 4500 H+B						Analyst: LNW
Lab pH	7.19	0		su	1	9/22/2011 1:42:00 PM
INORGANIC NON-METALS						Analyst: KLS
Total dissolved solids	90	20		mg/L	1	9/16/2011 8:17:00 AM

Laboratory Results

Geochemical Testing

Date: 26-Sep-11

CLIENT:	RESOURCE MANAGEMENT SERVICES	Client Sample ID:	RMS 10/9/14
Lab Order:	G1109596		
Project:	BS-P	Sampled By:	Client
Lab ID:	G1109596-006	Collection Date:	9/14/2011 4:00:00 PM
Matrix:	AQUEOUS	Received Date:	9/16/2011 5:08:05 AM

Analyses	Result	QL	Q	Units	DF	Date Analyzed
INORGANIC NON-METALS						
Acidity to pH 8.2	-19	0		mg/L CaCO ₃	1	9/23/2011 9:21:00 AM
PHYSICAL TESTS						
Specific Conductance	142	1		µmhos/cm	1	9/22/2011 12:30:00 PM
PH BY SM 4500 H+B						
Lab pH	6.71	0		su	1	9/22/2011 12:30:00 PM
INORGANIC NON-METALS						
Total dissolved solids	92	20		mg/L	1	9/16/2011 8:16:00 AM
PHYSICAL TESTS						
Total suspended solids	< 5	5		mg/L	1	9/16/2011 6:44:35 AM
INORGANIC NON-METALS						
Alkalinity to pH 4.5	42	5		mg/L CaCO ₃	1	9/22/2011 12:30:00 PM
INORGANIC NON-METALS						
Nitrate - Nitrite	1.95	0.05		mg/L as N	1	9/16/2011 11:12:00 AM
INORGANIC NON-METALS						
Bromide	< 0.2	0.2		mg/L	1	9/16/2011 11:12:00 AM
Chloride	5	1		mg/L	1	9/16/2011 11:12:00 AM
Sulfate	14	2		mg/L	1	9/16/2011 11:12:00 AM
INORGANIC METALS						
Aluminum	< 0.1	0.1		mg/L	1	9/22/2011 3:13:00 PM
Barium	0.03	0.01		mg/L	1	9/21/2011 10:00:00 PM
Calcium	11.1	0.1		mg/L	1	9/21/2011 10:00:00 PM
Iron	< 0.05	0.05		mg/L	1	9/21/2011 10:00:00 PM
Magnesium	5.0	0.1		mg/L	1	9/21/2011 10:00:00 PM
Manganese	< 0.01	0.01		mg/L	1	9/21/2011 10:00:00 PM
Potassium	1.6	0.5		mg/L	1	9/21/2011 10:00:00 PM
Sodium	6.3	0.2		mg/L	1	9/21/2011 10:00:00 PM
Strontium	0.08	0.01		mg/L	1	9/21/2011 10:00:00 PM
Hardness (SM 2340B)	48.2	1.0		mg/L CaCO ₃	1	9/21/2011 10:00:00 PM
INDICATOR ORGANIC PARAMETERS						
Oil & Grease	< 5	5		mg/L	1.02	9/22/2011 12:47:00 PM



Laboratory Results

Geochemical Testing

Date: 26-Sep-11

CLIENT:	RESOURCE MANAGEMENT SERVICES	Client Sample ID:	RMS 11/9/14
Lab Order:	G1109596	Sampled By:	Client
Project:	BS-P	Collection Date:	9/14/2011 4:15:00 PM
Lab ID:	G1109596-007	Received Date:	9/16/2011 5:08:05 AM
Matrix:	AQUEOUS		

Analyses	Result	QL	Q	Units	DF	Date Analyzed
INORGANIC NON-METALS						
Acidity to pH 8.2	-11	0		mg/L CaCO3	1	9/23/2011 9:23:00 AM
PHYSICAL TESTS						
Specific Conductance	152	1		µmhos/cm	1	9/22/2011 12:33:00 PM
PH BY SM 4500 H+B						
Lab pH	6.54	0		su	1	9/22/2011 12:33:00 PM
INORGANIC NON-METALS						
Total dissolved solids	94	20		mg/L	1	9/16/2011 8:17:00 AM
PHYSICAL TESTS						
Total suspended solids	< 5	5		mg/L	1	9/16/2011 6:44:37 AM
INORGANIC NON-METALS						
Alkalinity to pH 4.5	33	5		mg/L CaCO3	1	9/22/2011 12:33:00 PM
INORGANIC NON-METALS						
Nitrate - Nitrite	0.99	0.05		mg/L as N	1	9/16/2011 12:36:00 PM
INORGANIC NON-METALS						
Bromide	< 0.2	0.2		mg/L	1	9/16/2011 12:36:00 PM
Chloride	15	1		mg/L	1	9/16/2011 12:36:00 PM
Sulfate	13	2		mg/L	1	9/16/2011 12:36:00 PM
INORGANIC METALS						
Aluminum	< 0.1	0.1		mg/L	1	9/22/2011 3:49:00 PM
Barium	0.01	0.01		mg/L	1	9/21/2011 10:04:00 PM
Calcium	8.3	0.1		mg/L	1	9/21/2011 10:04:00 PM
Iron	< 0.05	0.05		mg/L	1	9/21/2011 10:04:00 PM
Magnesium	3.2	0.1		mg/L	1	9/21/2011 10:04:00 PM
Manganese	< 0.01	0.01		mg/L	1	9/21/2011 10:04:00 PM
Potassium	1.1	0.5		mg/L	1	9/21/2011 10:04:00 PM
Sodium	13.3	0.2		mg/L	1	9/21/2011 10:04:00 PM
Strontium	0.04	0.01		mg/L	1	9/21/2011 10:04:00 PM
Hardness (SM 2340B)	34.1	1.0		mg/L CaCO3	1	9/21/2011 10:04:00 PM
INDICATOR ORGANIC PARAMETERS						
Oil & Grease	< 5	5		mg/L	1.03	9/22/2011 12:47:00 PM



Shuttle/Cooler ID#:

CHAIN OF CUSTODY

Geochemical Testing

Form F-5002, 08.10

Geochemical Testing • 2005 North Center Avenue • Somerset PA 15501 • (814) 443-1671 • Fax (814) 445-6729

Billing Client: RWS Contact (Company): RWS Phone: ()

Address: e-mail: Fax: ()

City: State: Zip: PA Preservatives by GT Sampler GT

WO#: Project: PO/Quote#:

Sample Matrix:	CW Ground Water	SW Surface Water	PW Potable Water	WW Wastewater	SO Soil	SL Sludge	nHZ Not Hazardous / HZ Hazardous	PCBs
Sample Type:	G Grab	C Composite	D Distribution/DW	R Raw/DW	S Special/DW	O Other	Containers Supplied by:	Client <input type="checkbox"/> Lab <input checked="" type="checkbox"/>

Sample Location/Description	Lab Number	Sample Matrix	Date	Time (Military)	Sample Type	**Analyses Requested	Remarks/Preservatives, etc	Number of Containers
RWS 1/9/14	01107592 001	nHZ / HZ	9-14-11	various	G	PH + TDS	Field Filtered: Y <input checked="" type="checkbox"/>	1
RWS 2/9/14	G1109596 001	nHZ / HZ				BS-P + A1 + K	Field Filtered: Y <input checked="" type="checkbox"/>	3
RWS 3/9/14	002	nHZ / HZ				BS-P + A1 + K	Field Filtered: Y <input checked="" type="checkbox"/>	3
RWS 4/9/14	003	nHZ / HZ				BS-P + A1 + K	Field Filtered: Y <input checked="" type="checkbox"/>	3
RWS 5/9/14	* 9597 002	nHZ / HZ				PH + TDS	Field Filtered: Y <input checked="" type="checkbox"/>	1
RWS 6/9/14	004	nHZ / HZ				BS-P + A1 + K	Field Filtered: Y <input checked="" type="checkbox"/>	3
RWS 7/9/14	9597 003	nHZ / HZ				PH + TDS	Field Filtered: Y <input checked="" type="checkbox"/>	1
RWS 8/9/14	005	nHZ / HZ				BS-P + A1 + K	Field Filtered: Y <input checked="" type="checkbox"/>	3

Note Deficiencies Here:

Relinquished by (Company & Signature)	Date	Time (Military)	Received by (Company & Signature)	Date	Time (Military)
<u>[Signature]</u>	9-15-11	1000	<u>[Signature]</u>	9-15-11	1355
<u>[Signature]</u>	9-15-11	1535	<u>[Signature]</u>	9-16-11	808

SAMPLES MUST BE PRESERVED ON ICE.

Ice present on receipt: Y Yes or No No Cooler Temp (°C) on receipt: C

Shuttle/Cooler ID#:

CHAIN OF CUSTODY

Geochemical Testing

Form F-5002, 08.10

Geochemical Testing • 2005 North Center Avenue • Somerset PA 15501 • (814) 443-1671 • Fax (814) 445-6729

Billing Client: AKG Contact (Company): Road Phone: ()

Address: e-mail: Fax: ()

City: State: Zip: PA Preservatives by Sampler GT

WO#: Project: PO/Quote#:

Sample Matrix: GW Ground Water SW Surface Water PW Potable Water WW Wastewater SO Soil SL Sludge nHZ Not Hazardous / HZ Hazardous PCBS

Sample Type: G Grab C Composite D Distribution/DW R Raw/DW S Special/DW O Other Containers Supplied by: Client GT Lab

Sample Location/Description	Lab Number	Sample Matrix	Date	Time (Military)	Sample Type	**Analyses Requested	Remarks/Preservatives, etc	Number of Containers
RMS 9/9/14	49587 004	nHZ / HZ SW	9-14-11	varied	G	PH + TAS	Field Filtered: Y <input checked="" type="checkbox"/>	1
RMS 10/9/14	4590 006	nHZ / HZ PW	↓	↓	↓	BSP + Al + K + O + G	Field Filtered: Y <input checked="" type="checkbox"/>	4
RMS 11/9/14	007	nHZ / HZ PW	↓	↓	↓	BSP + Al + K + O + G	Field Filtered: Y <input checked="" type="checkbox"/>	4
		nHZ / HZ					Field Filtered: Y / N	
		nHZ / HZ					Field Filtered: Y / N	
		nHZ / HZ					Field Filtered: Y / N	
		nHZ / HZ					Field Filtered: Y / N	
		nHZ / HZ					Field Filtered: Y / N	

Note Deficiencies Here:

Relinquished by (Company & Signature)	Date	Time (Military)	Received by (Company & Signature)	Date	Time (Military)
<u>[Signature]</u>	9-15-11	1005	<u>[Signature]</u>	9-15-11	1355
<u>[Signature]</u>	9-15-11	1530	<u>[Signature]</u>	9-16-11	5:08

SAMPLES MUST BE PRESERVED ON ICE.

Ice present on receipt: Yes or No Cooler Temp (°C) on receipt: 4



GEOCHEMICAL TESTING

Environmental and Energy Analysis

2005 N. Center Ave.
Somerset, PA 15501

814/443-1671
814/445-6666
FAX: 814/445-6729

Friday, September 23, 2011

RICK BONAZZA
RESOURCE MANAGEMENT SERVICES
65 FENTON ROAD
INDIANA, PA 15701

Order No.: G1109521

Dear RICK BONAZZA:

Geochemical Testing received 5 sample(s) on 9/15/2011 for the analyses presented in the following report.

There were no problems with the analyses and all QC data met NELAC, EPA, and laboratory specifications except where noted in the Case Narrative or Laboratory Results.

If you have any questions regarding these tests results, please feel free to call.

Sincerely,

Timothy W. Bergstresser
Director of Technical Services

Geochemical Testing

Date: 23-Sep-11

CLIENT: RESOURCE MANAGEMENT SERVICES
Project:
Lab Order: G1109521

CASE NARRATIVE

No problems were encountered during analysis of this workorder, except if noted in this report.

Legend: ND - Not Detected at the Quantitation Limit S - Spike Recovery outside accepted recovery limits
J - Indicates an estimated value. R - RPD outside accepted recovery limits
U - The analyte was not detected at or above the listed concentration, which is below the laboratory quantitation limit. E - Value above quantitation range
B - Analyte detected in the associated Method Blank ** - Value exceeds Action Limit
Q - Qualifier QL - Quantitation Limit DF - Dilution Factor H - Method Hold Time Exceeded
MCL - Contaminant Limit



Laboratory Results

Geochemical Testing

Date: 23-Sep-11

CLIENT:	RESOURCE MANAGEMENT SERVICES	Client Sample ID:	RMS 1/9/13
Lab Order:	G1109521		
Project:		Sampled By:	Client
Lab ID:	G1109521-001	Collection Date:	9/13/2011 11:30:00 AM
Matrix:	AQUEOUS	Received Date:	9/15/2011 6:23:42 AM

Analyses	Result	QL	Q	Units	DF	Date Analyzed
PH BY SM 4500 H+B						Analyst: LNW
Lab pH	5.90	0		su	1	9/20/2011 9:35:00 AM
INORGANIC NON-METALS						Analyst: KLS
Total dissolved solids	62	20		mg/L	1	9/15/2011 10:41:00 AM



Laboratory Results

Date: 23-Sep-11

Geochemical Testing

CLIENT:	RESOURCE MANAGEMENT SERVICES	Client Sample ID:	RMS 2/9/13
Lab Order:	G1109521		
Project:		Sampled By:	Client
Lab ID:	G1109521-002	Collection Date:	9/13/2011 11:55:00 AM
Matrix:	AQUEOUS	Received Date:	9/15/2011 6:23:42 AM

Analyses	Result	QL	Q	Units	DF	Date Analyzed
PH BY SM 4500 H+B						Analyst: LNW
Lab pH	5.95	0		su	1	9/20/2011 10:06:00 AM
INORGANIC NON-METALS						Analyst: KLS
Total dissolved solids	36	20		mg/L	1	9/15/2011 10:42:00 AM

Laboratory Results

Date: 23-Sep-11

Geochemical Testing

CLIENT:	RESOURCE MANAGEMENT SERVICES	Client Sample ID:	RMS 3/9/13
Lab Order:	G1109521		
Project:		Sampled By:	Client
Lab ID:	G1109521-003	Collection Date:	9/13/2011 12:10:00 PM
Matrix:	AQUEOUS	Received Date:	9/15/2011 6:23:42 AM

Analyses	Result	QL	Q	Units	DF	Date Analyzed
PH BY SM 4500 H+B						Analyst: LNW
Lab pH	6.06	0		su	1	9/20/2011 10:11:00 AM
INORGANIC NON-METALS						Analyst: KLS
Total dissolved solids	38	20		mg/L	1	9/15/2011 10:42:00 AM

Laboratory Results

Date: 23-Sep-11

Geochemical Testing

CLIENT:	RESOURCE MANAGEMENT SERVICES	Client Sample ID:	RMS 5/9/13
Lab Order:	G1109521		
Project:		Sampled By:	Client
Lab ID:	G1109521-005	Collection Date:	9/13/2011 12:45:00 PM
Matrix:	AQUEOUS	Received Date:	9/15/2011 6:23:42 AM

Analyses	Result	QL	Q	Units	DF	Date Analyzed
PH BY SM 4500 H+B						Analyst: LNW
Lab pH	6.00	0		su	1	9/20/2011 10:14:00 AM
INORGANIC NON-METALS						Analyst: KLS
Total dissolved solids	40	20		mg/L	1	9/15/2011 10:43:00 AM

Shuttle/Cooler ID#:

CHAIN OF CUSTODY

Geochemical Testing

Form F-5002, 06/08

Geochemical Testing • 2005 North Center Avenue • Somerset PA 15501 • (814) 443-1671 • Fax (814) 445-6729

Billing Client: RMS Contact (Company): RMS Phone: () ()

Address: RMS e-mail: _____ Fax: () ()

City: _____ State: _____ Zip: _____ Sampled by: _____ Preservatives by: Sampler GT

WO#: _____ Project: _____ PO/Quote#: _____

Sample Matrix: GW Ground Water SW Surface Water PW Potable Water WW Wastewater SO Soil SL Sludge nHZ Not Hazardous / HZ Hazardous PCBs

Sample Type: G Grab C Composite D Distribution/DW R Raw/DW S Special/DW O Other Containers Supplied by: Client GT Lab

Sample Location/Description	Lab Number	Sample Matrix	Date	Time (Military)	Sample Type	**Analyses Requested	Remarks/Preservatives, etc.	Number of Containers
RMS 1/9/13	001 001	nHZ / HZ SW	9/13/11	1130	G	pH, TDS only	Field Filtered: Y / N	3
RMS 2/9/13	002	nHZ / HZ SW		1155		"	Field Filtered: Y / N	3
RMS 3/9/13	003	nHZ / HZ SW		1210		"	Field Filtered: Y / N	3
RMS 4/9/13	004	nHZ / HZ SW		1220		"	Field Filtered: Y / N	3
RMS 5/9/13	005	nHZ / HZ SW		1245		"	Field Filtered: Y / N	3
RMS 6/9/13	001 001	nHZ / HZ PW		1320		BS-P + O+G + Al + K	Field Filtered: Y / N	4
RMS 7/9/13	002	nHZ / HZ PW		1345		"	Field Filtered: Y / N	4
RMS 8/9/13	003	nHZ / HZ PW		1420		"	Field Filtered: Y / N	4

Note Deficiencies Here: RMS 4/9/13 Bad fixed bottles only + could not be analyzed.

Relinquished by (Company & Signature)	Date	Time (Military)	Received by (Company & Signature)	Date	Time (Military)
<u>RMS</u>	9/13/11	2000	<u>[Signature]</u>	9-14-11	1430
<u>[Signature]</u>	9/14/11	1057	<u>[Signature]</u>	9-15-11	6:01
<u>[Signature]</u>	9-14-11	1625			

SAMPLES MUST BE PRESERVED ON ICE.

Ice present on receipt: Yes or No Cooler Temp (°C) on receipt: 6

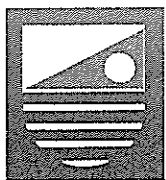

GEOCHEMICAL TESTING

Environmental and Energy Analysis

2005 N. Center Ave.
Somerset, PA 15501

814/443-1671
814/445-6666
FAX: 814/445-6729

Friday, September 23, 2011

RICK BONAZZA
RESOURCE MANAGEMENT SERVICES
65 FENTON ROAD
INDIANA, PA 15701

RE: BS-P

Order No.: G1109520

Dear RICK BONAZZA:

Geochemical Testing received 8 sample(s) on 9/15/2011 for the analyses presented in the following report.

There were no problems with the analyses and all QC data met NELAC, EPA, and laboratory specifications except where noted in the Case Narrative or Laboratory Results.

If you have any questions regarding these tests results, please feel free to call.

Sincerely,

Timothy W. Bergstresser
Director of Technical Services

Geochemical Testing

Date: 23-Sep-11

CLIENT: RESOURCE MANAGEMENT SERVICES
Project: BS-P
Lab Order: G1109520

CASE NARRATIVE

No problems were encountered during analysis of this workorder, except if noted in this report.

Legend: ND - Not Detected at the Quantitation Limit S - Spike Recovery outside accepted recovery limits
J - Indicates an estimated value. R - RPD outside accepted recovery limits
U - The analyte was not detected at or above the listed concentration, which is below the laboratory quantitation limit. E - Value above quantitation range
B - Analyte detected in the associated Method Blank ** - Value exceeds Action Limit
Q - Qualifier QL - Quantitation Limit DF - Dilution Factor H - Method Hold Time Exceeded
MCL - Contaminant Limit



Laboratory Results

Geochemical Testing

Date: 23-Sep-11

CLIENT:	RESOURCE MANAGEMENT SERVICES	Client Sample ID:	RMS 6/9/13
Lab Order:	G1109520	Sampled By:	Client
Project:	BS-P	Collection Date:	9/13/2011 1:20:00 PM
Lab ID:	G1109520-001	Received Date:	9/15/2011 6:01:26 AM
Matrix:	AQUEOUS		

Analyses	Result	QL	Q	Units	DF	Date Analyzed
INORGANIC NON-METALS						
Acidity to pH 8.2	-11	0		mg/L CaCO3	1	9/20/2011 2:04:00 PM
PHYSICAL TESTS						
Specific Conductance	90	1		µmhos/cm	1	9/20/2011 8:55:00 AM
PH BY SM 4500 H+B						
Lab pH	6.50	0		su	1	9/20/2011 8:55:00 AM
INORGANIC NON-METALS						
Total dissolved solids	58	20		mg/L	1	9/15/2011 10:39:00 AM
PHYSICAL TESTS						
Total suspended solids	< 5	5		mg/L	1	9/15/2011 9:36:39 AM
INORGANIC NON-METALS						
Alkalinity to pH 4.5	33	5		mg/L CaCO3	1	9/20/2011 8:55:00 AM
INORGANIC NON-METALS						
Nitrate - Nitrite	1.02	0.05		mg/L as N	1	9/15/2011 9:25:00 AM
INORGANIC NON-METALS						
Bromide	< 0.2	0.2		mg/L	1	9/15/2011 9:25:00 AM
Chloride	2	1		mg/L	1	9/15/2011 9:25:00 AM
Sulfate	10	2		mg/L	1	9/15/2011 9:25:00 AM
INORGANIC METALS						
Aluminum	0.1	0.1		mg/L	1	9/19/2011 8:51:00 PM
Barium	0.07	0.01		mg/L	1	9/19/2011 8:51:00 PM
Calcium	8.8	0.1		mg/L	1	9/19/2011 8:51:00 PM
Iron	0.11	0.05		mg/L	1	9/19/2011 8:51:00 PM
Magnesium	3.1	0.1		mg/L	1	9/19/2011 8:51:00 PM
Manganese	< 0.01	0.01		mg/L	1	9/19/2011 8:51:00 PM
Potassium	1.0	0.5		mg/L	1	9/19/2011 8:51:00 PM
Sodium	2.1	0.2		mg/L	1	9/19/2011 8:51:00 PM
Strontium	0.10	0.01		mg/L	1	9/19/2011 8:51:00 PM
Hardness (SM 2340B)	34.8	1.0		mg/L CaCO3	1	9/19/2011 8:51:00 PM
INDICATOR ORGANIC PARAMETERS						
Oil & Grease	< 5	5		mg/L	1.01	9/20/2011 12:45:00 PM



Laboratory Results

Geochemical Testing

Date: 23-Sep-11

CLIENT:	RESOURCE MANAGEMENT SERVICES	Client Sample ID:	RMS 7/9/13
Lab Order:	G1109520	Sampled By:	Client
Project:	BS-P	Collection Date:	9/13/2011 1:45:00 PM
Lab ID:	G1109520-002	Received Date:	9/15/2011 6:01:26 AM
Matrix:	AQUEOUS		

Analyses	Result	QL	Q	Units	DF	Date Analyzed
INORGANIC NON-METALS						
Acidity to pH 8.2	-161	0		mg/L CaCO3	1	9/20/2011 2:08:00 PM
		SM 2310B(4A)		Analyst: LNW		
PHYSICAL TESTS						
Specific Conductance	356	1		µmhos/cm	1	9/20/2011 9:08:00 AM
		EPA 120.1		Analyst: LNW		
PH BY SM 4500 H+B						
Lab pH	7.90	0		su	1	9/20/2011 9:08:00 AM
		SM4500-H+B		Analyst: LNW		
INORGANIC NON-METALS						
Total dissolved solids	182	20		mg/L	1	9/15/2011 10:39:00 AM
		SM 2540 C		Analyst: KLS		
PHYSICAL TESTS						
Total suspended solids	< 5	5		mg/L	1	9/15/2011 9:36:41 AM
		SM 2540D		Analyst: KLS		
INORGANIC NON-METALS						
Alkalinity to pH 4.5	172	5		mg/L CaCO3	1	9/20/2011 9:08:00 AM
		ASTM D1067-02		Analyst: LNW		
INORGANIC NON-METALS						
Nitrate - Nitrite	0.09	0.05		mg/L as N	1	9/15/2011 10:16:00 AM
		EPA 300.0		Analyst: CAS		
INORGANIC NON-METALS						
Bromide	< 0.2	0.2		mg/L	1	9/15/2011 10:16:00 AM
Chloride	5	1		mg/L	1	9/15/2011 10:16:00 AM
Sulfate	16	2		mg/L	1	9/15/2011 10:16:00 AM
		EPA 300.0		Analyst: CAS		
INORGANIC METALS						
Aluminum	< 0.1	0.1		mg/L	1	9/19/2011 9:12:00 PM
Barium	0.11	0.01		mg/L	1	9/19/2011 9:12:00 PM
Calcium	47.3	0.1		mg/L	1	9/19/2011 9:12:00 PM
Iron	0.39	0.05		mg/L	1	9/19/2011 9:12:00 PM
Magnesium	13.6	0.1		mg/L	1	9/19/2011 9:12:00 PM
Manganese	0.05	0.01		mg/L	1	9/19/2011 9:12:00 PM
Potassium	1.8	0.5		mg/L	1	9/19/2011 9:12:00 PM
Sodium	6.4	0.2		mg/L	1	9/19/2011 9:12:00 PM
Strontium	3.17	0.01		mg/L	1	9/19/2011 9:12:00 PM
Hardness (SM 2340B)	174	1.0		mg/L CaCO3	1	9/19/2011 9:12:00 PM
		EPA 200.7		Analyst: JAS		
INDICATOR ORGANIC PARAMETERS						
Oil & Grease	< 5	5		mg/L	1.04	9/20/2011 12:45:00 PM
		EPA 1664		Analyst: ACG		

Laboratory Results

Geochemical Testing

Date: 23-Sep-11

CLIENT:	RESOURCE MANAGEMENT SERVICES	Client Sample ID: RMS 8/9/13
Lab Order:	G1109520	
Project:	BS-P	Sampled By: Client
Lab ID:	G1109520-003	Collection Date: 9/13/2011 2:20:00 PM
Matrix:	AQUEOUS	Received Date: 9/15/2011 6:01:26 AM

Analyses	Result	QL	Q	Units	DF	Date Analyzed
INORGANIC NON-METALS						
Acidity to pH 8.2	-134	0		mg/L CaCO3	1	9/20/2011 2:09:00 PM
PHYSICAL TESTS						
Specific Conductance	413	1		µmhos/cm	1	9/20/2011 9:12:00 AM
PH BY SM 4500 H+B						
Lab pH	7.79	0		su	1	9/20/2011 9:12:00 AM
INORGANIC NON-METALS						
Total dissolved solids	212	20		mg/L	1	9/15/2011 10:39:00 AM
PHYSICAL TESTS						
Total suspended solids	< 5	5		mg/L	1	9/15/2011 9:36:42 AM
INORGANIC NON-METALS						
Alkalinity to pH 4.5	146	5		mg/L CaCO3	1	9/20/2011 9:12:00 AM
INORGANIC NON-METALS						
Nitrate - Nitrite	0.08	0.05		mg/L as N	1	9/15/2011 10:33:00 AM
INORGANIC NON-METALS						
Bromide	< 0.2	0.2		mg/L	1	9/15/2011 10:33:00 AM
Chloride	25	1		mg/L	1	9/15/2011 10:33:00 AM
Sulfate	19	2		mg/L	1	9/15/2011 10:33:00 AM
INORGANIC METALS						
Aluminum	< 0.1	0.1		mg/L	1	9/19/2011 9:17:00 PM
Barium	0.18	0.01		mg/L	1	9/19/2011 9:17:00 PM
Calcium	25.4	0.1		mg/L	1	9/19/2011 9:17:00 PM
Iron	< 0.05	0.05		mg/L	1	9/19/2011 9:17:00 PM
Magnesium	6.5	0.1		mg/L	1	9/19/2011 9:17:00 PM
Manganese	< 0.01	0.01		mg/L	1	9/19/2011 9:17:00 PM
Potassium	1.4	0.5		mg/L	1	9/19/2011 9:17:00 PM
Sodium	54.5	0.2		mg/L	1	9/19/2011 9:17:00 PM
Strontium	1.40	0.01		mg/L	1	9/19/2011 9:17:00 PM
Hardness (SM 2340B)	90.4	1.0		mg/L CaCO3	1	9/19/2011 9:17:00 PM
INDICATOR ORGANIC PARAMETERS						
Oil & Grease	< 5	5		mg/L	0.99	9/20/2011 12:45:00 PM

NOTES:

The pH of the sample was >2.



Laboratory Results

Geochemical Testing

Date: 23-Sep-11

CLIENT:	RESOURCE MANAGEMENT SERVICES	Client Sample ID:	RMS 9/9/13
Lab Order:	G1109520	Sampled By:	Client
Project:	BS-P	Collection Date:	9/13/2011 2:45:00 PM
Lab ID:	G1109520-004	Received Date:	9/15/2011 6:01:26 AM
Matrix:	AQUEOUS		

Analyses	Result	QL	Q	Units	DF	Date Analyzed
INORGANIC NON-METALS						
Acidity to pH 8.2	-161	0		mg/L CaCO3	1	9/20/2011 2:11:00 PM
PHYSICAL TESTS						
Specific Conductance	396	1		µmhos/cm	1	9/20/2011 9:16:00 AM
PH BY SM 4500 H+B						
Lab pH	8.00	0		su	1	9/20/2011 9:16:00 AM
INORGANIC NON-METALS						
Total dissolved solids	222	20		mg/L	1	9/15/2011 10:40:00 AM
PHYSICAL TESTS						
Total suspended solids	< 5	5		mg/L	1	9/15/2011 9:36:44 AM
INORGANIC NON-METALS						
Alkalinity to pH 4.5	173	5		mg/L CaCO3	1	9/20/2011 9:16:00 AM
INORGANIC NON-METALS						
Nitrate - Nitrite	0.18	0.05		mg/L as N	1	9/15/2011 10:49:00 AM
INORGANIC NON-METALS						
Bromide	< 0.2	0.2		mg/L	1	9/15/2011 10:49:00 AM
Chloride	3	1		mg/L	1	9/15/2011 10:49:00 AM
Sulfate	27	2		mg/L	1	9/15/2011 10:49:00 AM
INORGANIC METALS						
Aluminum	< 0.1	0.1		mg/L	1	9/19/2011 9:22:00 PM
Barium	0.12	0.01		mg/L	1	9/19/2011 9:22:00 PM
Calcium	20.8	0.1		mg/L	1	9/19/2011 9:22:00 PM
Iron	< 0.05	0.05		mg/L	1	9/19/2011 9:22:00 PM
Magnesium	5.4	0.1		mg/L	1	9/19/2011 9:22:00 PM
Manganese	< 0.01	0.01		mg/L	1	9/19/2011 9:22:00 PM
Potassium	1.3	0.5		mg/L	1	9/19/2011 9:22:00 PM
Sodium	63.2	0.2		mg/L	1	9/19/2011 9:22:00 PM
Strontium	1.07	0.01		mg/L	1	9/19/2011 9:22:00 PM
Hardness (SM 2340B)	74.1	1.0		mg/L CaCO3	1	9/19/2011 9:22:00 PM
INDICATOR ORGANIC PARAMETERS						
Oil & Grease	< 5	5		mg/L	1.01	9/20/2011 12:45:00 PM



Laboratory Results

Date: 23-Sep-11

Geochemical Testing

CLIENT:	RESOURCE MANAGEMENT SERVICES	Client Sample ID:	RMS 10/9/13
Lab Order:	G1109520	Sampled By:	Client
Project:	BS-P	Collection Date:	9/13/2011 3:15:00 PM
Lab ID:	G1109520-005	Received Date:	9/15/2011 6:01:26 AM
Matrix:	AQUEOUS		

Analyses	Result	QL	Q	Units	DF	Date Analyzed
INORGANIC NON-METALS						
Acidity to pH 8.2	-84	0		mg/L CaCO3	1	9/20/2011 2:13:00 PM
PHYSICAL TESTS						
Specific Conductance	260	1		µmhos/cm	1	9/20/2011 9:19:00 AM
PH BY SM 4500 H+B						
Lab pH	7.51	0		su	1	9/20/2011 9:19:00 AM
INORGANIC NON-METALS						
Total dissolved solids	142	20		mg/L	1	9/15/2011 10:40:00 AM
PHYSICAL TESTS						
Total suspended solids	< 5	5		mg/L	1	9/15/2011 9:36:46 AM
INORGANIC NON-METALS						
Alkalinity to pH 4.5	99	5		mg/L CaCO3	1	9/20/2011 9:19:00 AM
INORGANIC NON-METALS						
Nitrate - Nitrite	0.06	0.05		mg/L as N	1	9/15/2011 11:06:00 AM
INORGANIC NON-METALS						
Bromide	< 0.2	0.2		mg/L	1	9/15/2011 11:06:00 AM
Chloride	12	1		mg/L	1	9/15/2011 11:06:00 AM
Sulfate	12	2		mg/L	1	9/15/2011 11:06:00 AM
INORGANIC METALS						
Aluminum	< 0.1	0.1		mg/L	1	9/19/2011 9:26:00 PM
Barium	0.23	0.01		mg/L	1	9/19/2011 9:26:00 PM
Calcium	14.9	0.1		mg/L	1	9/19/2011 9:26:00 PM
Iron	0.43	0.05		mg/L	1	9/19/2011 9:26:00 PM
Magnesium	4.7	0.1		mg/L	1	9/19/2011 9:26:00 PM
Manganese	0.13	0.01		mg/L	1	9/19/2011 9:26:00 PM
Potassium	1.0	0.5		mg/L	1	9/19/2011 9:26:00 PM
Sodium	32.0	0.2		mg/L	1	9/19/2011 9:26:00 PM
Strontium	0.70	0.01		mg/L	1	9/19/2011 9:26:00 PM
Hardness (SM 2340B)	56.5	1.0		mg/L CaCO3	1	9/19/2011 9:26:00 PM
INDICATOR ORGANIC PARAMETERS						
Oil & Grease	< 5	5		mg/L	1.03	9/20/2011 12:45:00 PM

Laboratory Results

Geochemical Testing

Date: 23-Sep-11

CLIENT:	RESOURCE MANAGEMENT SERVICES	Client Sample ID:	RMS 11/9/13
Lab Order:	G1109520	Sampled By:	Client
Project:	BS-P	Collection Date:	9/13/2011 3:25:00 PM
Lab ID:	G1109520-006	Received Date:	9/15/2011 6:01:26 AM
Matrix:	AQUEOUS		

Analyses	Result	QL	Q	Units	DF	Date Analyzed
INORGANIC NON-METALS						
Acidity to pH 8.2	-138	0		mg/L CaCO3	1	9/20/2011 2:14:00 PM
		SM 2310B(4A)		Analyst: LNW		
PHYSICAL TESTS						
Specific Conductance	344	1		µmhos/cm	1	9/20/2011 9:23:00 AM
		EPA 120.1		Analyst: LNW		
PH BY SM 4500 H+B						
Lab pH	7.89	0		su	1	9/20/2011 9:23:00 AM
		SM4500-H+B		Analyst: LNW		
INORGANIC NON-METALS						
Total dissolved solids	196	20		mg/L	1	9/15/2011 10:40:00 AM
		SM 2540 C		Analyst: KLS		
PHYSICAL TESTS						
Total suspended solids	6	5		mg/L	1	9/15/2011 9:36:52 AM
		SM 2540D		Analyst: KLS		
INORGANIC NON-METALS						
Alkalinity to pH 4.5	151	5		mg/L CaCO3	1	9/20/2011 9:23:00 AM
		ASTM D1067-02		Analyst: LNW		
INORGANIC NON-METALS						
Nitrate - Nitrite	< 0.05	0.05		mg/L as N	1	9/15/2011 11:23:00 AM
		EPA 300.0		Analyst: CAS		
INORGANIC NON-METALS						
Bromide	< 0.2	0.2		mg/L	1	9/15/2011 11:23:00 AM
Chloride	10	1		mg/L	1	9/15/2011 11:23:00 AM
Sulfate	10	2		mg/L	1	9/15/2011 11:23:00 AM
		EPA 300.0		Analyst: CAS		
INORGANIC METALS						
Aluminum	< 0.1	0.1		mg/L	1	9/19/2011 9:31:00 PM
Barium	0.15	0.01		mg/L	1	9/19/2011 9:31:00 PM
Calcium	32.1	0.1		mg/L	1	9/19/2011 9:31:00 PM
Iron	0.97	0.05		mg/L	1	9/19/2011 9:31:00 PM
Magnesium	9.2	0.1		mg/L	1	9/19/2011 9:31:00 PM
Manganese	0.36	0.01		mg/L	1	9/19/2011 9:31:00 PM
Potassium	1.5	0.5		mg/L	1	9/19/2011 9:31:00 PM
Sodium	26.1	0.2		mg/L	1	9/19/2011 9:31:00 PM
Strontium	1.78	0.01		mg/L	1	9/19/2011 9:31:00 PM
Hardness (SM 2340B)	118	1.0		mg/L CaCO3	1	9/19/2011 9:31:00 PM
		EPA 200.7		Analyst: JAS		
INDICATOR ORGANIC PARAMETERS						
Oil & Grease	< 5	5		mg/L	1.02	9/20/2011 12:46:00 PM
		EPA 1664		Analyst: ACG		

Laboratory Results

Geochemical Testing

Date: 23-Sep-11

CLIENT:	RESOURCE MANAGEMENT SERVICES	Client Sample ID:	RMS 12/9/13
Lab Order:	G1109520	Sampled By:	Client
Project:	BS-P	Collection Date:	9/13/2011 3:55:00 PM
Lab ID:	G1109520-007	Received Date:	9/15/2011 6:01:26 AM
Matrix:	AQUEOUS		

Analyses	Result	QL	Q	Units	DF	Date Analyzed
INORGANIC NON-METALS						
Acidity to pH 8.2	-58	SM 2310B(4A)		0	mg/L CaCO3	Analyst: LNW 9/20/2011 2:16:00 PM
PHYSICAL TESTS						
Specific Conductance	165	EPA 120.1		1	µmhos/cm	Analyst: LNW 9/20/2011 9:26:00 AM
PH BY SM 4500 H+B						
Lab pH	7.34	SM4500-H+B		0	su	Analyst: LNW 9/20/2011 9:26:00 AM
INORGANIC NON-METALS						
Total dissolved solids	100	SM 2540 C		20	mg/L	Analyst: KLS 9/15/2011 10:40:00 AM
PHYSICAL TESTS						
Total suspended solids	< 5	SM 2540D		5	mg/L	Analyst: KLS 9/15/2011 9:36:56 AM
INORGANIC NON-METALS						
Alkalinity to pH 4.5	76	ASTM D1067-02		5	mg/L CaCO3	Analyst: LNW 9/20/2011 9:26:00 AM
INORGANIC NON-METALS						
Nitrate - Nitrite	0.33	EPA 300.0		0.05	mg/L as N	Analyst: CAS 9/15/2011 11:40:00 AM
INORGANIC NON-METALS						
Bromide	< 0.2	EPA 300.0		0.2	mg/L	Analyst: CAS 9/15/2011 11:40:00 AM
Chloride	< 1	EPA 300.0		1	mg/L	Analyst: CAS 9/15/2011 11:40:00 AM
Sulfate	10	EPA 300.0		2	mg/L	Analyst: CAS 9/15/2011 11:40:00 AM
INORGANIC METALS						
Aluminum	< 0.1	EPA 200.7		0.1	mg/L	Analyst: JAS 9/19/2011 9:36:00 PM
Barium	0.04	EPA 200.7		0.01	mg/L	Analyst: JAS 9/19/2011 9:36:00 PM
Calcium	18.9	EPA 200.7		0.1	mg/L	Analyst: JAS 9/19/2011 9:36:00 PM
Iron	0.06	EPA 200.7		0.05	mg/L	Analyst: JAS 9/19/2011 9:36:00 PM
Magnesium	6.7	EPA 200.7		0.1	mg/L	Analyst: JAS 9/19/2011 9:36:00 PM
Manganese	< 0.01	EPA 200.7		0.01	mg/L	Analyst: JAS 9/19/2011 9:36:00 PM
Potassium	0.9	EPA 200.7		0.5	mg/L	Analyst: JAS 9/19/2011 9:36:00 PM
Sodium	4.3	EPA 200.7		0.2	mg/L	Analyst: JAS 9/19/2011 9:36:00 PM
Strontium	0.25	EPA 200.7		0.01	mg/L	Analyst: JAS 9/19/2011 9:36:00 PM
Hardness (SM 2340B)	74.8	EPA 200.7		1.0	mg/L CaCO3	Analyst: JAS 9/19/2011 9:36:00 PM
INDICATOR ORGANIC PARAMETERS						
Oil & Grease	< 5	EPA 1664		5	mg/L	Analyst: ACG 9/20/2011 12:46:00 PM



Laboratory Results

Geochemical Testing

Date: 23-Sep-11

CLIENT:	RESOURCE MANAGEMENT SERVICES	Client Sample ID:	RMS 13/9/13
Lab Order:	G1109520		
Project:	BS-P	Sampled By:	Client
Lab ID:	G1109520-008	Collection Date:	9/13/2011 4:15:00 PM
Matrix:	AQUEOUS	Received Date:	9/15/2011 6:01:26 AM

Analyses	Result	QL	Q	Units	DF	Date Analyzed
INORGANIC NON-METALS						
Acidity to pH 8.2	-115	SM 2310B(4A)		mg/L CaCO3	1	Analyst: LNW 9/20/2011 2:23:00 PM
PHYSICAL TESTS						
Specific Conductance	382	EPA 120.1		µmhos/cm	1	Analyst: LNW 9/20/2011 9:30:00 AM
PH BY SM 4500 H+B						
Lab pH	7.50	SM4500-H+B		su	1	Analyst: LNW 9/20/2011 9:30:00 AM
INORGANIC NON-METALS						
Total dissolved solids	184	SM 2540 C		mg/L	1	Analyst: KLS 9/15/2011 10:40:00 AM
PHYSICAL TESTS						
Total suspended solids	< 5	SM 2540D		mg/L	1	Analyst: KLS 9/15/2011 9:36:58 AM
INORGANIC NON-METALS						
Alkalinity to pH 4.5	127	ASTM D1067-02		mg/L CaCO3	1	Analyst: LNW 9/20/2011 9:30:00 AM
INORGANIC NON-METALS						
Nitrate - Nitrite	0.06	EPA 300.0		mg/L as N	1	Analyst: CAS 9/15/2011 11:57:00 AM
INORGANIC NON-METALS						
Bromide	< 0.2	EPA 300.0		mg/L	1	Analyst: CAS 9/15/2011 11:57:00 AM
Chloride	20	EPA 300.0		mg/L	1	Analyst: CAS 9/15/2011 11:57:00 AM
Sulfate	11	EPA 300.0		mg/L	1	Analyst: CAS 9/15/2011 11:57:00 AM
INORGANIC METALS						
Aluminum	< 0.1	EPA 200.7		mg/L	1	Analyst: JAS 9/19/2011 9:40:00 PM
Barium	0.39	EPA 200.7		mg/L	1	Analyst: JAS 9/19/2011 9:40:00 PM
Calcium	34.8	EPA 200.7		mg/L	1	Analyst: JAS 9/19/2011 9:40:00 PM
Iron	0.55	EPA 200.7		mg/L	1	Analyst: JAS 9/19/2011 9:40:00 PM
Magnesium	8.1	EPA 200.7		mg/L	1	Analyst: JAS 9/19/2011 9:40:00 PM
Manganese	0.12	EPA 200.7		mg/L	1	Analyst: JAS 9/19/2011 9:40:00 PM
Potassium	1.3	EPA 200.7		mg/L	1	Analyst: JAS 9/19/2011 9:40:00 PM
Sodium	26.1	EPA 200.7		mg/L	1	Analyst: JAS 9/19/2011 9:40:00 PM
Strontium	1.03	EPA 200.7		mg/L	1	Analyst: JAS 9/19/2011 9:40:00 PM
Hardness (SM 2340B)	120	EPA 200.7		mg/L CaCO3	1	Analyst: JAS 9/19/2011 9:40:00 PM
INDICATOR ORGANIC PARAMETERS						
Oil & Grease	< 5	EPA 1664		mg/L	1.01	Analyst: ACG 9/20/2011 12:46:00 PM



Shuttle/Cooler ID#: _____

CHAIN OF CUSTODY

Geochemical Testing

Form F-5002, 06.08

Geochemical Testing • 2005 North Center Avenue • Somerset PA 15501 • (814) 443-1671 • Fax (814) 445-6729

Billing Client: RMS **Contact (Company):** RMS **Phone:** ()

Address: _____ **e-mail:** _____ **Fax:** ()

City: _____ **State:** _____ **Zip:** _____ **Preservatives by:** Sampler **GT**

WO#: _____ **Project:** _____ **PO/Quote#:** _____

Sample Matrix:	GW Ground Water	SW Surface Water	PW Potable Water	WW Wastewater	SO Soil	SL Sludge	nHZ Not Hazardous / HZ Hazardous	PCBs
Sample Type:	G Grab	C Composite	D Distribution/DW	R Raw/DW	S Special/DW	O Other	Containers Supplied by:	Client <input type="checkbox"/> <input checked="" type="checkbox"/> GT Lab

Sample Location/Description	Lab Number	Sample Matrix	Date	Time (Military)	Sample Type	**Analyses Requested		Remarks/Preservatives, etc	Number of Containers
						nHZ / HZ	Field Filtered: Y/N		
RMS 9/9/13	004 004	PW	9/13/11	1445	G	BS-P + O+6 + Al+K	Field Filtered: Y/N		4
RMS 10/9/13	005	PW	9/13/11	1515		"	Field Filtered: Y/N		4
RMS 11/9/13	006	PW		1525		"	Field Filtered: Y/N		4
RMS 12/9/13	007	PW		1555		"	Field Filtered: Y/N		4
RMS 13/9/13	008	PW	↙	1615	↙	"	Field Filtered: Y/N		4
		nHZ / HZ					Field Filtered: Y/N		
		nHZ / HZ					Field Filtered: Y/N		
		nHZ / HZ					Field Filtered: Y/N		

Note Deficiencies Here:

Relinquished by (Company & Signature)	Date	Time (Military)	Received by (Company & Signature)	Date	Time (Military)
<u>[Signature]</u> RMS	9/13/11	2000	<u>[Signature]</u>	9-14-11	1430
<u>[Signature]</u> RMS	9/14/11	1057	<u>[Signature]</u>	9-15-11	6-01
<u>[Signature]</u>	9-14-11	1625			

SAMPLES MUST BE PRESERVED ON ICE.

Ice present on receipt: Yes or No Cooler Temp (°C) on receipt: 6

APPENDIX C – DCNR WATER WELL INVENTORY LOGS

PA Topographic & Geologic Survey

PaGWIS

IMAGE FOR PA WELL ID: 355638

Email comments to Topo.Geo.

Return to Summary List

Topographic and Geologic Survey
 Water Well Drillers Licensing
 PO Box 8453
 Harrisburg, PA 17105-8453
 717-787-5828

WATER WELL COMPLETION REPORT
 Use Ball Point Pen, Print Firmly and Print Clearly
 (DO NOT WRITE IN GRAY COLORED BLOCK)

(See Rules for Expiration)
 Department of Conservation and Natural Resources

ST 42 Co. _____ Lat. _____ Long. _____ Sect. _____ Acc. _____ Topo Sealing _____ Aquifer _____ Rock Type _____ State Hydrologic Unit _____ Well # _____ Map _____ Township/Barony _____ County _____ Address _____ Owner _____ Driller _____ Date Drilled _____ Well _____	(Select Appropriate Answer) Water supply: (check) _____ () Public, () Private, () Other _____ Water Use: _____ Well Finish: _____ Depth of screen or perforated casing _____ Drilling method: _____ Yield Method: _____ Landform at site: _____ Development: _____ Local Well No. _____ Pairing No. _____ Distances to _____	Well Log (Materials in parentheses) FROM _____ TO _____ 8 - 2 2 - 12 13 - 25 25 - 160 160 - 200 200 - 210
(See Rules for Expiration) Department of Conservation and Natural Resources ST 42 Co. _____ Lat. _____ Long. _____ Sect. _____ Acc. _____ Topo Sealing _____ Aquifer _____ Rock Type _____ State Hydrologic Unit _____ Well # _____ Map _____ Township/Barony _____ County _____ Address _____ Owner _____ Driller _____ Date Drilled _____ Well _____	(Select Appropriate Answer) Water supply: (check) _____ () Public, () Private, () Other _____ Water Use: _____ Well Finish: _____ Depth of screen or perforated casing _____ Drilling method: _____ Yield Method: _____ Landform at site: _____ Development: _____ Local Well No. _____ Pairing No. _____ Distances to _____	Well Log (Materials in parentheses) FROM _____ TO _____ 8 - 2 2 - 12 13 - 25 25 - 160 160 - 200 200 - 210

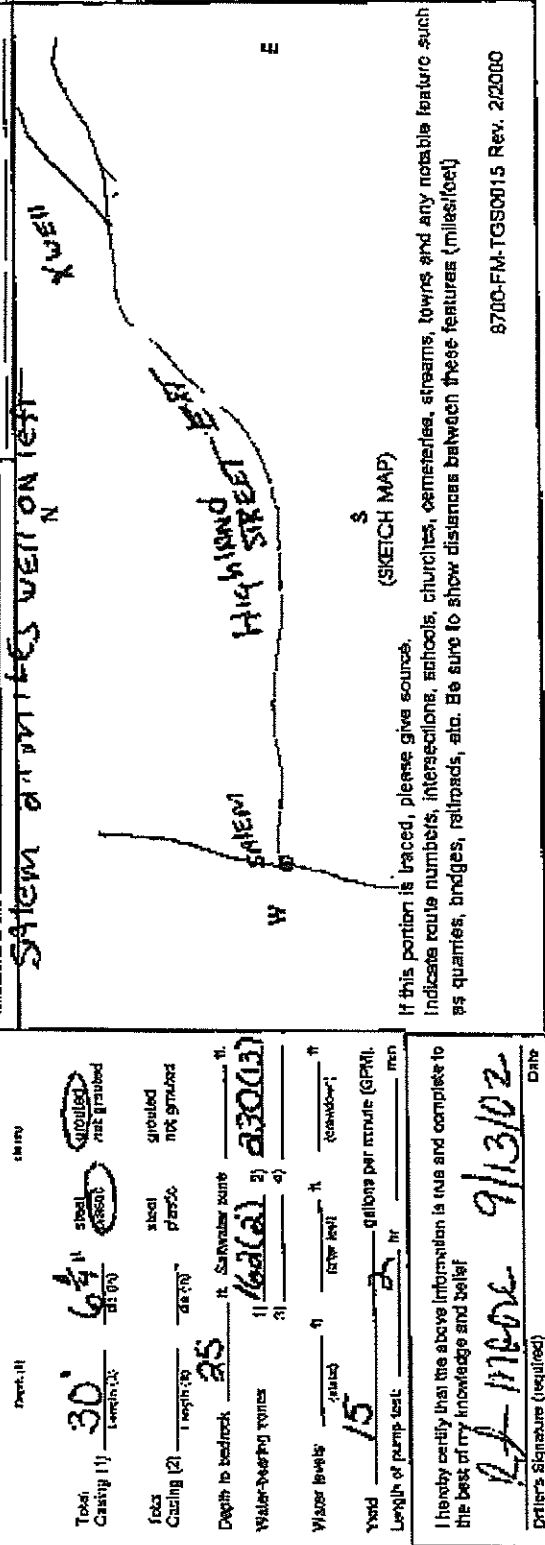

If this position is traced, please give source. Indicate route numbers, intersections, schools, churches, cemeteries, streams, towns and any notable feature such as quarries, bridges, railroads, etc. Be sure to show distances between these features (miles/feet)

8700-FM-TGS0015 Rev. 2/2000

MAIL ORIGINAL COPY TO THE PENNSYLVANIA GEOLOGICAL SURVEY (REQUIRED)

I hereby certify that the above information is true and complete to the best of my knowledge and belief

R. Moore 9/13/02
 Driller's Signature (required) Date

PA Topographic & Geologic Survey

PaGWIS

IMAGE FOR PA WELL ID: 355639

Email comments to [Topo Geo.](#)

[Return to Summary List](#)

Topographic and Geologic Survey
Water Well Drillers Licensing
PO Box 8453
Harrisburg, PA 17105-8453
717-787-8828

WATER WELL COMPLETION REPORT
Use Ball Point Pen, Press Firmly and Print Clearly
(DO NOT WRITE IN GRAY COLORED BLOCK)

1500 S. STATE ST. DEPT. 1200
HARRISBURG, PA 17105-0000

ST. 42 Co. _____ Lat. _____ Long. _____ Seq. _____ Ac. _____

Topo Setting _____ Aquifer _____ Rock Type _____

State Hydrologic Unit _____ Well # _____

MSD _____

Transmittance _____

County _____

Address _____

Owner _____

Driller _____

Date Drilled _____

Well: _____

Drill No. _____

Permit No. _____

Local Well No. _____

Directions to the Well _____

Well Type: _____

Water Use: _____

Well Finish: _____

Drilling Method: _____

Yield Method: _____

Location of site: _____

Development: _____

Local Well No. _____

Permit No. _____

Directions to the Well _____

Well Log (materials penetrated)	FROM	TO
Beaufort Shale	0	17
Gay Sand Shale	12	18
Gay Sandstone	18	43
Gay Shale	43	50
Gay Clay	50	53
Gay Sand Shale	53	84
Limestone	84	90

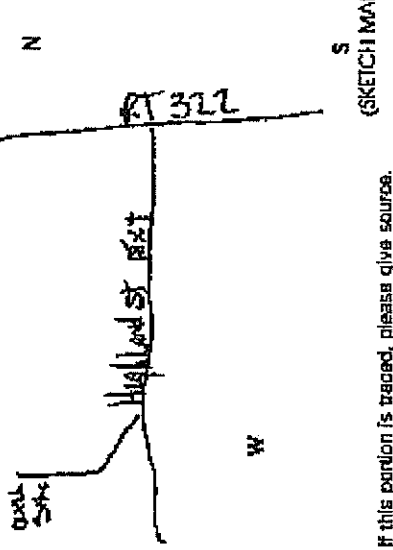

Well Log (materials penetrated)	FROM	TO
Gay Shale	90	115
Coal	115	116
Gay Sand Shale	116	170
Limestone	170	175
Gay Sandstone	175	190

Depth to bedrock _____ ft. Schamber zone _____ ft.

Water-bearing zones _____ ft. _____ ft. _____ ft.

Water levels (static) _____ ft. (after pump) _____ ft. (in casing) _____ ft.

Yield _____ gpm. _____ gpm. per minute (GPM).

Length at pump test: _____ hr

I hereby certify that the above information is true and complete to the best of my knowledge and belief.

Signature _____ Date 9/12/02

If this portion is traced, please give source. Indicate route numbers, interchanges, schools, churches, cemeteries, streams, towns and any notable feature such as quarries, bridges, railroads, etc. Be sure to show distances between these features (miles/feet)

8700-FM-TGS0015 Rev. 2/2000

MAIL ORIGINAL COPY TO THE PENNSYLVANIA GEOLOGICAL SURVEY (REQUIRED)