

- REFERENCES:
- EXISTING TOPOGRAPHY OF BIG SEWICKLEY CREEK, IN THE VICINITY OF THE WITHDRAWAL LOCATION, OBTAINED FROM FIELD SURVEY PERFORMED BY CIVIL & ENVIRONMENTAL CONSULTANTS, INC. (CEC) IN JULY 2024. FORMER TOPOGRAPHY OF THE SAME AREA WAS OBTAINED FROM FIELD SURVEY PERFORMED BY CIVIL & ENVIRONMENTAL CONSULTANTS, INC. (CEC) IN JANUARY 2023. EXISTING CONTOURS OUTSIDE OF THESE AREAS DERIVED FROM THE PAMAP PROGRAM 3.2 FT DIGITAL ELEVATION MODEL OF PENNSYLVANIA; DEVELOPED BY PAMAP PROGRAM, PA DEPARTMENT OF CONSERVATION AND NATURAL RESOURCES, BUREAU OF TOPOGRAPHIC AND GEOLOGIC SURVEY; DATED MAY 2006.
 - STREAM AND WETLAND DELINEATION COMPLETED BY CEC, INC. IN AUGUST 2020 AND MAY/JUNE 2021.
 - PROPERTY LINES DERIVED FROM BEAVER COUNTY TAX PARCEL DATA AND SUPPLEMENTED BY FIELD SURVEY PERFORMED BY CEC, INC. IN NOVEMBER & DECEMBER 2020 AND JUNE 2021.
 - SOURCES, INCLUDING THE PENNSYLVANIA DEPARTMENT OF TRANSPORTATION TYPE 5B MAPS FOR ECONOMY BOROUGH AND BELL ACRES BOROUGH, INDICATE THAT THE MUNICIPAL BOUNDARY FOLLOWS THE CENTERLINE OF BIG SEWICKLEY CREEK. THE MUNICIPAL BOUNDARY SHOWN ON THE PLANS WAS DIGITIZED BASED ON THE EXISTING STREAM LOCATION.

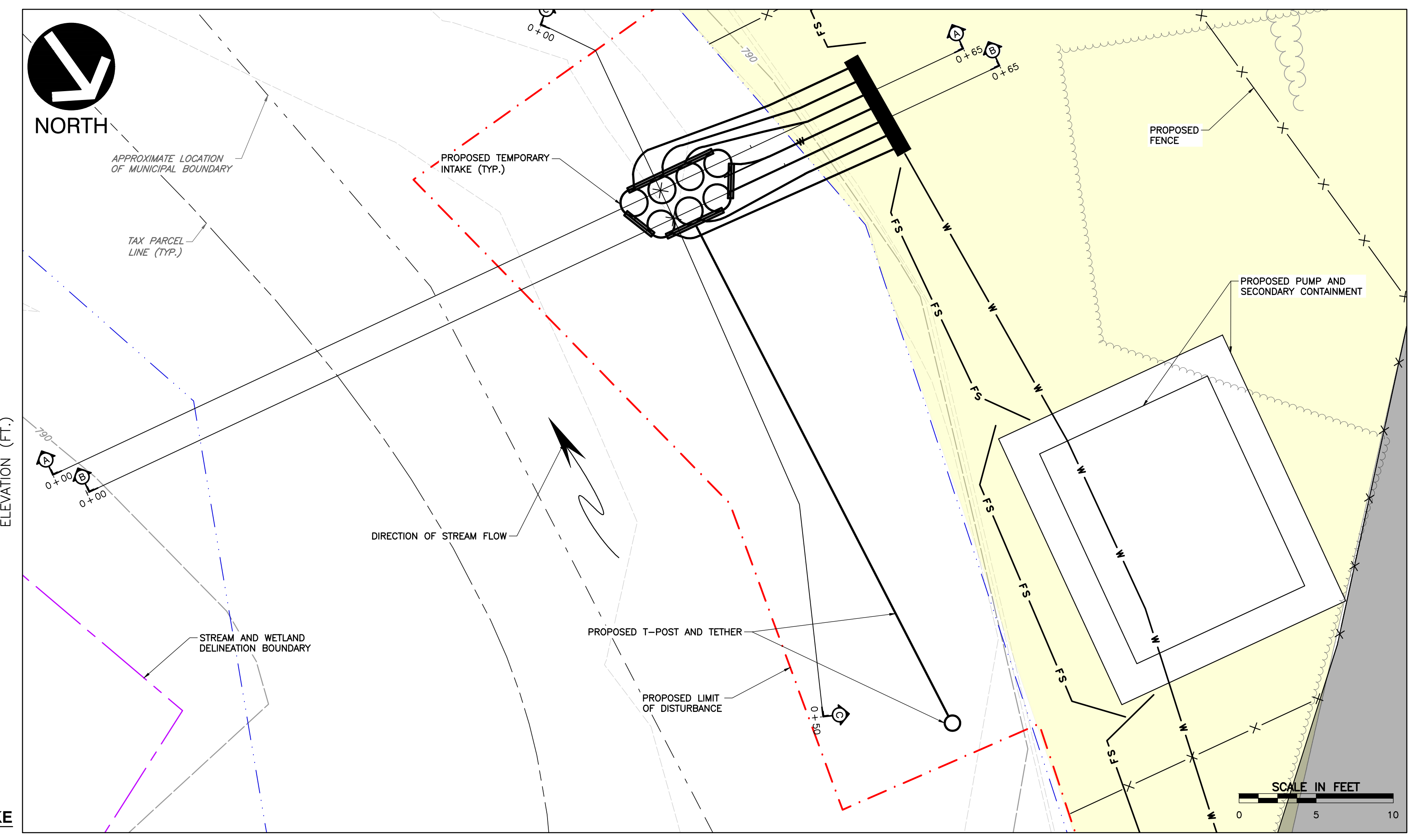
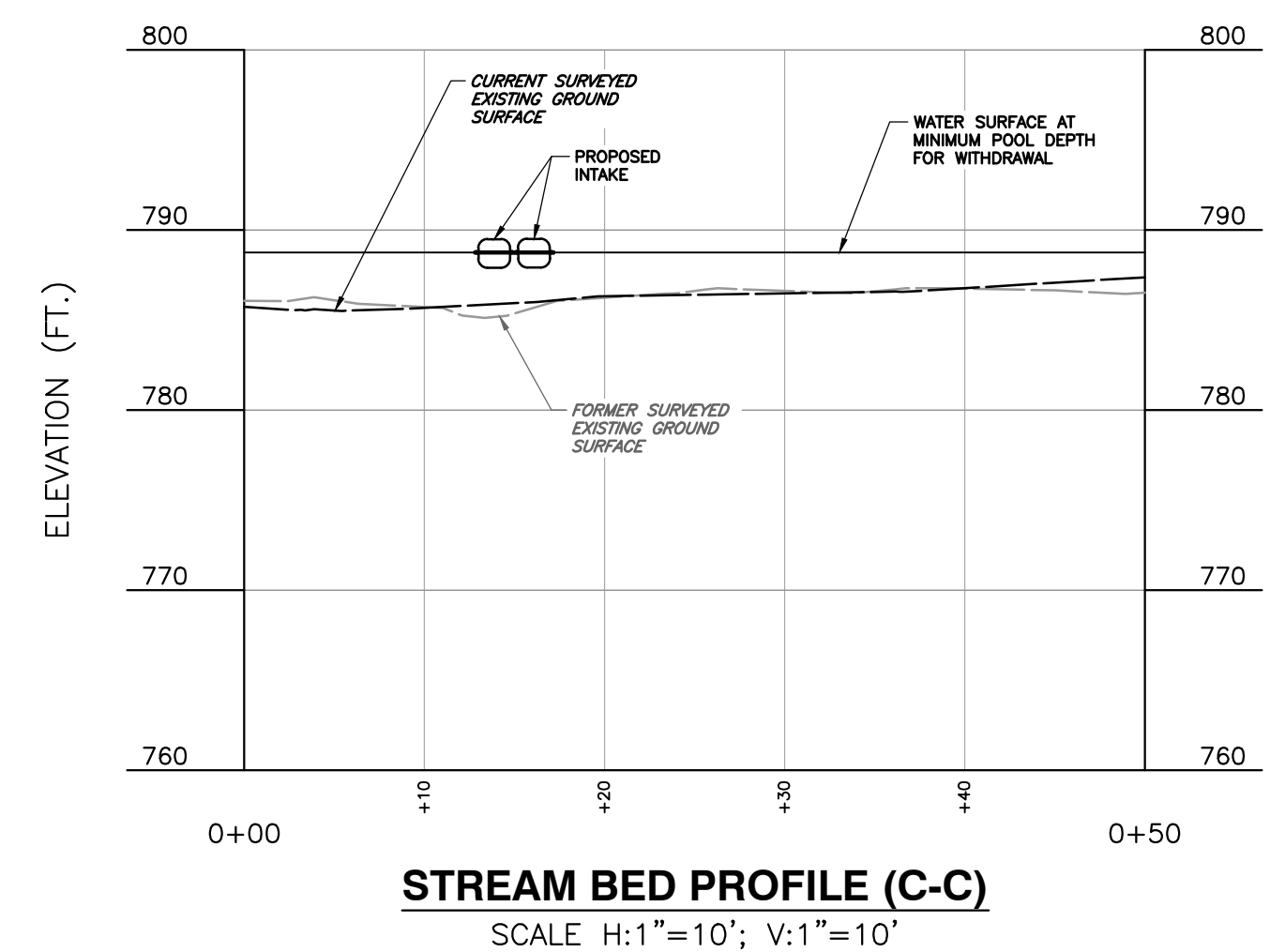

DETAIL 1
PROPOSED TEMPORARY INTAKE
(BIG SEWICKLEY CREEK)

LEGEND

1200	EXISTING INDEX CONTOUR	EXISTING GAS PIPELINE/MARKER	PROPOSED ORANGE CONSTRUCTION FENCE
---	EXISTING INTERMEDIATE CONTOUR	EXISTING TREELINE	PROPOSED TIMBER MAT
---	EXISTING PAVED ROAD	EXISTING SANITARY SEWER/MANHOLE	PROPOSED ROCK CONSTRUCTION ENTRANCE
---	EXISTING UNPAVED ROAD	EXISTING SIGN	PROPOSED ROCK STOCKPILE
---	TAX PARCEL LINE	EXISTING WATERLINE	PROPOSED PERMANENT WATERBAR
---	PROPERTY LINE BASED ON FIELD EVIDENCE	EXISTING CHANNEL	PROPOSED TEMPORARY WATERBAR
---	STREAM/WETLAND DELINEATION BOUNDARY	EXISTING CULVERT/STORM PIPE/INLET	PROPOSED RIPRAP APRON
---	EXISTING WETLAND	EXISTING RIPRAP	PROPOSED SLOPE STABILIZATION
---	ASSUMED 50' FLOODWAY	EXISTING TEMPORARY ABOVE GROUND WATERLINE	
---	FEMA FLOODWAY	AREA NOT TO BE DISTURBED	
---	EXISTING OVERHEAD WIRE/UTILITY POLE	PROPOSED LIMIT OF DISTURBANCE	
---	EXISTING FENCE	PROPOSED FILTER SOCK	

REVISION RECORD

NO	DATE	DESCRIPTION

PENNENERGY RESOURCES

Civil & Environmental Consultants, Inc.

700 Cherrington Parkway · Moon Township, PA 15108
412-429-2324 · 800-365-2324
www.cecinc.com

PENNENERGY RESOURCES, LLC

B50 TEMPORARY ABOVE-GROUND WATERLINE

ECONOMY BOROUGH

BEAVER COUNTY, PA

REGISTERED PROFESSIONAL ENGINEER
JUSTIN CHRISTOPHER WAGNER
No. PE000462

STREAM SURVEY EXHIBIT

DATE: AUGUST 2024 DRAWN BY: JTD
DWG SCALE: AS SHOWN CHECKED BY: PAK
PROJECT NO: 317-457
APPROVED BY: JCW

DRAWING NO.: **JP03**

P:\310-000\317-457-CADD\DWG\CIVIL\01\317-457-CR01-CP-FIGURES_UPDATED.dwg [P03] LS(8/15/2024 - 10:05) - LP: 9/11/2024 4:28 PM