

Dip 1.6%
Dip 1.2%
Dip 1.2%
Dip 1.2%
Dip 1.2%

ENDANGERED PLANT 50' BUFFER ZONE WITH ORANGE CONSTRUCTION FENCE AROUND THE PERIMETER

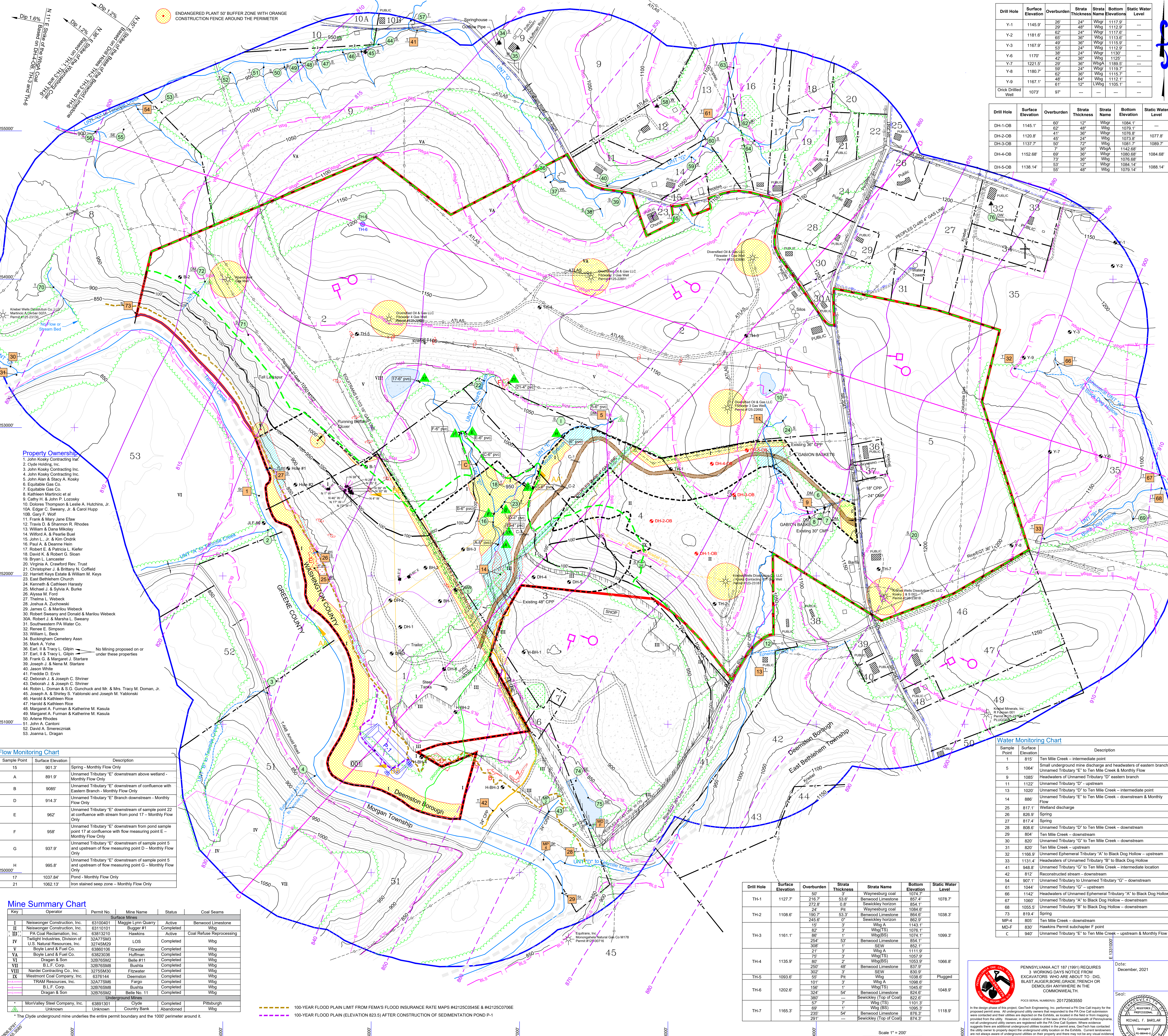

Drill Hole	Surface Elevation	Overburden	Strata Thickness	Strata Name	Bottom Elevation	Static Water Level
Y-1	1145.9'	20'	24"	Wbg	1112.9'	---
Y-2	1181.6'	62'	24"	Wbg	1119.6'	---
Y-3	1167.9'	49'	24"	Wbg	1113.9'	---
Y-6	1170'	42'	36"	Wbg	1125'	---
Y-7	1221.5'	29'	24"	Wbg	1192.5'	---
Y-8	1180.7'	59'	24"	Wbg	1121.7'	---
Y-9	1167.1'	48'	84"	Wbg	1119.1'	---
CHICK DRILLED WELL	1073'	97'	---	---	---	---

Drill Hole	Surface Elevation	Overburden	Strata Thickness	Strata Name	Bottom Elevation	Static Water Level
DH-1-OB	1145.1'	60'	12"	Wbg	1084.1'	---
DH-2-OB	1120.8'	41'	36"	Wbg	1079.8'	1077.8'
DH-3-OB	1137.7'	50'	72"	Wbg	1087.7'	1089.7'
DH-4-OB	1152.68'	69'	36"	Wbg	1083.68'	1084.68'
DH-5-OB	1138.14'	55'	48"	Wbg	1083.14'	1088.14'

- Legend**
- Permit Boundary - 336.7 acres
 - Surface Site Boundary - 87.5 acres
 - Underground Mining Boundary - 252.1 acres
 - 1000' Perimeter
 - Property Ownership (keyed to table and module 5)
 - Property Line
 - Municipal Boundary
 - Structure Contour Line - Base of the Benwood Limestone
 - Structure Contour Line - Base of the Benwood Limestone
 - E-Electric (West Penn Power)
 - T-Telephone (Marionna-Scenery Hill Telephone Co.)
 - C-Cable (As Noted) - Water (Southwestern Pennsylvania Water Authority)
 - Utility (overhead)
 - Utility (underground)
 - Buildings (occupied/unoccupied)
 - Existing Gas Well
 - Test Hole
 - Overburden Analysis Test Hole
 - Restricted Mining Zone
 - Wetlands - Delineated, Flagged and Surveyed
 - Wetlands - Field Identified and Mapped
 - Woods
 - Benwood Limestone Cropline
 - Waynesburg A Coal Cropline
 - Waynesburg A Coal Cropline
 - Deep Mined Areas and Portal
 - Previously Surface Mined Areas
 - Existing Culverts - size and type or Key to Module 12 page 12-1
 - RC-Reinforced Concrete Pipe
 - CP-Corrugated Plastic Pipe
 - CM-Corrugated Metal Pipe
 - CS-Steel Pipe
 - Cemetery
 - Ground Slope
 - Geologic Cross Section
 - Strike and Dip
 - Geologic Faults - N/A
 - Joint Measurement
 - Ground Water Flow (Local)
 - Ground Water Flow (Regional)
 - Spring
 - Private Water Supply
 - Water Sampling Point (Background)
 - Water Sampling Point (Monitoring)
 - S-Spring P-Pond T-Tributary S-Stream SE-SEEP W-Well DM-Deep Mine Discharge WL-Wetland I-Impoundment C-Culvert
 - Flow Measurement Station - Flow Measurement Only
 - Perennial Stream
 - Intermittent Stream
 - Ephemeral Stream
 - Existing Pond / Impoundment
 - Monitoring Well (Background Sample)
 - 100' Cover Line Above Top of Benwood Limestone
 - Geologic Cross Section Location From SMP No. 63100401
 - NPDES Point
 - Indicates dwelling is served by public water
 - Haul Road

- Property Ownership**
- John Kosky Contracting Inc.
 - Cycle Holding, Inc.
 - John Kosky Contracting Inc.
 - John Kosky Contracting Inc.
 - John Alan & Stacy A. Kosky
 - Equitable Gas Co.
 - Equitable Gas Co.
 - Equitable Gas Co.
 - Kathleen Martinic et al
 - Carly H. & John P. Lennox
 - Dolores Thompson & Leslie A. Hutchins, Jr.
 - Edgar C. Sweeney, Jr. & Carol Hupp
 - Cary F. Wolf
 - Frank & Mary Jane Elav
 - Travis D. & Shannon R. Rhodes
 - William & Dana Miskley
 - Willard A. & Pearlise Buel
 - John L., Jr. & Kim Chick
 - Paul A. & Deanne Hein
 - Robert E. & Patricia L. Kiefer
 - David K. & Robert G. Sloan
 - Bryan L. Lancaster
 - Viginta A. Crawford Rev. Trust
 - Christopher J. & Brittany N. Coffield
 - Hannett Keys Estate & William M. Keys
 - East Bethlehem Church
 - Kenneth & Kathleen Harasty
 - Michael J. & Sylvia A. Burke
 - Alyssa M. Ford
 - Thelma L. Webeck
 - Joshua A. Zuzowski
 - James C. & Marilu Webeck
 - Robert Sweeney and Donald & Marilu Webeck
 - Robert J. & Marilu L. Sweeney
 - Southwestern PA Water Co
 - Renee E. Simpson
 - William L. Beck
 - Buckingham Cemetery Assn
 - Mark A. Yohe
 - Earl, II & Tracy L. Gilpin
 - Earl, II & Tracy L. Gilpin
 - Frank G. & Margaret J. Sartare
 - Joseph J. & Nena M. Sartare
 - Jason White
 - Freddie D. Ervin
 - Deborah J. & Joseph C. Shriner
 - Deborah J. & Joseph C. Shriner
 - Robin L. Doman & S.G. Gurchuck and Mr. & Mrs. Tracy M. Doman, Jr.
 - Joseph A. & Shirley S. Yabonski and Joseph M. Yabonski
 - Harold & Kathleen Rice
 - Harold & Kathleen Rice
 - Margaret A. Furnan & Katherine M. Kasula
 - Margaret A. Furnan & Katherine M. Kasula
 - Alrene Rhodes
 - John A. Gambler
 - David A. Smerczak
 - Joanna L. Dragan

Flow Monitoring Chart

Sample Point	Surface Elevation	Description
15	901.3'	Spring - Monthly Flow Only
A	891.9'	Unnamed Tributary "E" downstream above wetland - Monthly Flow Only
B	908.5'	Unnamed Tributary "E" downstream of confluence with Eastern Branch - Monthly Flow Only
D	914.3'	Unnamed Tributary "E" Branch downstream - Monthly Flow Only
E	962'	Unnamed Tributary "E" downstream of sample point 22 at confluence with stream from pond 17 - Monthly Flow Only
F	958'	Unnamed Tributary "E" downstream from pond sample point 17 at confluence with flow measuring point E - Monthly Flow Only
G	937.9'	Unnamed Tributary "E" downstream of sample point 5 and upstream of flow measuring point D - Monthly Flow Only
H	995.6'	Unnamed Tributary "E" downstream of sample point 5 and upstream of flow measuring point G - Monthly Flow Only
17	1037.84'	Pond - Monthly Flow Only
21	1062.13'	Iron stoned seep zone - Monthly Flow Only

Mine Summary Chart

Key	Operator	Permit No.	Mine Name	Status	Coal Seams
I	Neiswonger Construction, Inc.	63100401	Maggie Lynn Quarry	Completed	Benwood Limestone
II	Neiswonger Construction, Inc.	63110101	Sugger #1	Wbg	
III	PA Coal Reclamation, Inc.	63813210	Hawkins	Active	Coal Refuse Reprocessing
IV	Tenight Industries, Division of U.S. Natural Resources, Inc.	32475843	LOS	Completed	Wbg
V	Boyle Land & Fuel Co.	6386108	Fitzwater	Completed	Wbg
VI	Boyle Land & Fuel Co.	6382936	Huffman	Completed	Wbg
VII	Dragan & Son	32876532	Belle #11	Completed	Wbg
VIII	B.L.F. Corp.	32876538	Bushata	Completed	Wbg
IX	Narden Contracting Co., Inc.	32755430	Fitzwater	Completed	Wbg
X	Westmont Coal Company, Inc.	6376144	Overston	Completed	Wbg
XI	TRAM Resources, Inc.	32477536	Fargo	Completed	Wbg
XII	B.L.F. Corp.	32876538	Bushata	Completed	Wbg
XIII	Dragan & Son	32876532	Belle No. 11	Completed	Wbg
XIV	MonValley Steel Company, Inc.	63891301	Cycle	Abandoned	Pittsburgh
XV	Unknown	Unknown	County Bank	Abandoned	Wbg

The Cycle underground mine underlies the entire permit boundary and the 1000' perimeter around it.

Water Monitoring Chart

Sample Point	Surface Elevation	Description
1	815'	Ten Mile Creek - intermediate point
5	1054'	Small underground mine discharge and headwaters of eastern branch Unnamed Tributary "E" to Ten Mile Creek & Monthly Flow
9	1085'	Headwaters of Unnamed Tributary "D" eastern branch
11	1122'	Unnamed Tributary "D" - upstream
13	1020'	Unnamed Tributary "D" to Ten Mile Creek - intermediate point
14	886'	Unnamed Tributary "E" to Ten Mile Creek - downstream & Monthly Flow
25	817.1'	Wetland discharge
26	828.9'	Spring
27	817.4'	Spring
28	808.6'	Unnamed Tributary "D" to Ten Mile Creek - downstream
29	804'	Ten Mile Creek - downstream
30	820'	Unnamed Tributary "G" to Ten Mile Creek - downstream
31	820'	Ten Mile Creek - upstream
32	1166.9'	Headwaters of Unnamed Tributary "A" to Black Dog Hollow - upstream
33	1131.4'	Headwaters of Unnamed Tributary "B" to Black Dog Hollow
41	948.5'	Unnamed Tributary "G" to Ten Mile Creek - intermediate location
42	812'	Reconstructed stream - downstream
54	907.1'	Unnamed Tributary "E" to Ten Mile Creek - downstream
61	1044'	Unnamed Tributary "G" - upstream
66	1142'	Headwaters of Unnamed Ephemeral Tributary "A" to Black Dog Hollow
67	1060'	Unnamed Tributary "A" to Black Dog Hollow - downstream
68	1055.5'	Unnamed Tributary "B" to Black Dog Hollow - downstream
73	819.4'	Spring
MP-A	805'	Ten Mile Creek - downstream
MD-F	830'	Hawkins Permit subcatcher F point
C	940'	Unnamed Tributary "E" to Ten Mile Creek - upstream & Monthly Flow

- Notes:**
- The base map is comprised of topography (S.C.I.) developed from LIDAR 2' contour data obtained from the PASDA website. The locations of roads, buildings and other features were obtained from the Elsworth & Mather, PA 7.5' USGS Quadrangle maps and supplemented/corrected by field survey and available aerial photography.
 - The property lines and property ownership shown on this map were obtained from Washington County tax assessment maps and records. This map does not represent an actual field survey of the properties shown and should not be used as such. All surface and mineral ownership information should be verified by the permittee.
 - All overburden and test hole elevations and locations were determined by field survey.
 - The location and extent of abandoned surface and deep mine workings depicted on this map are based upon available data without the benefit of a final certified mine map. Accordingly, neither GeoTech Engineering, Inc. nor the professional engineer or professional geologist signing this map certifies, warrants or guarantees the precise location or extent of abandoned, reclaimed or active workings depicted herein. Unknown or unmappped mines may extend beyond the depicted boundaries and may contain abandoned mine pools as well as other safety hazards.
 - This map is georeferenced to the Pennsylvania State Plane South, North American Datum 1983 (NAD 83) coordinate system.
 - All units are in feet.

Drill Hole	Surface Elevation	Overburden	Strata Thickness	Strata Name	Bottom Elevation	Static Water Level
TH-1	1127.7'	50'	53.6"	Benwood Limestone	1074.1'	1078.7'
TH-2	1108.6'	216.7'	0.8"	Sewickley horizon	891.9'	1038.3'
TH-3	1161.1'	24'	53.3"	Benwood Limestone	1084.6'	---
TH-4	1135.9'	190.7'	53.3"	Benwood Limestone	945.2'	1066.6'
TH-5	1093.6'	245.6'	53.3"	Benwood Limestone	848.0'	---
TH-6	1202.6'	151'	3"	Wbg (TS)	1051.6'	1048.9'
TH-7	1165.3'	307'	7"	Wbg (TS)	858.6'	1118.9'

Neiswonger Construction, Inc.
17592 Route 322, Strattanville, PA 16258
Phone: (814) 764-3455

Maggie Lynn Underground Mine
Permit No. 63192001
Exhibit 6.2: Environmental Resources Map

Date: December, 2021

Seal: [Professional Engineer Seal]

Prepared By: [Professional Engineer Name]

Geotechnical Engineering, Inc. ENGINEERS SURVEYORS GEOLGISTS

Washington County
Deemston Borough

MANUFACTURING
4231 Airport Circle
Morgantown, PA 16808
Phone: (814) 342-7000
Fax: (814) 342-7009

BRANCH OFFICE
3000 State Street, Suite 125-D
Dubois, PA 15801
Phone: (814) 371-1400
Fax: (814) 371-1400