

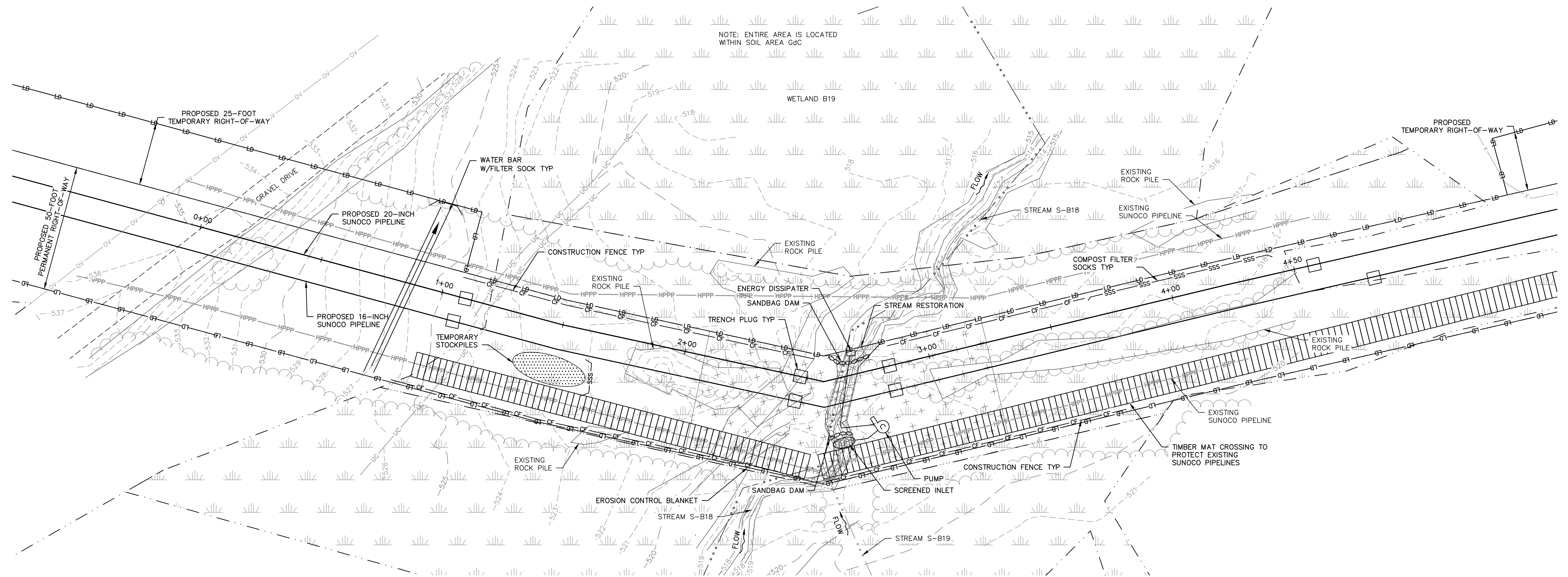

NOTE: ENTIRE AREA IS LOCATED WITHIN SOIL AREA GdC

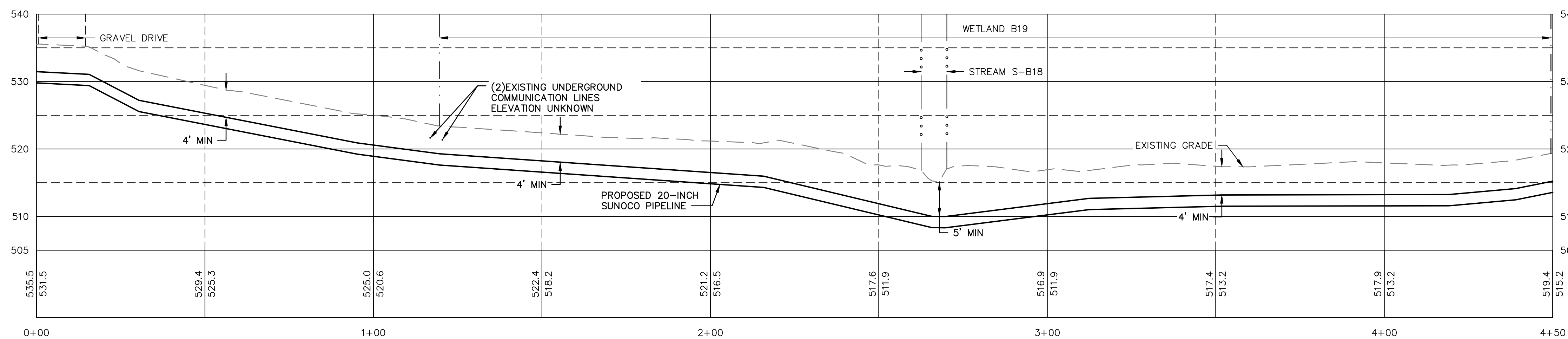

PLAN  
SCALE: 1"=20'



PLAN  
HORZ SCALE: 1"=20'  
VERT SCALE: 1"=10'

GRAPHIC SCALE

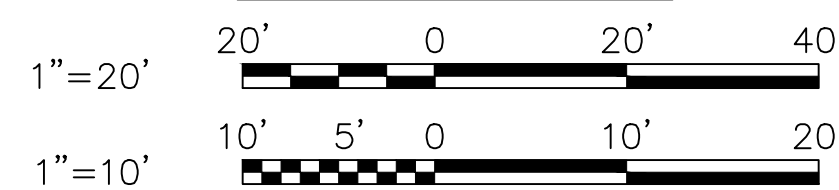

**STV**  
Baltimore, MD Bismarck, ND Denver, CO Douglassville, PA Houston, TX  
Pittsburgh, PA Williamsport, PA

THE LOCATION OF THE PIPELINE FACILITIES AS SHOWN HEREON MUST BE CONSIDERED AS APPROXIMATE ONLY. BEFORE DIGGING OR FOR AN EXACT LOCATION PLEASE CONTACT YOUR STATES UNDERGROUND UTILITY LOCATION SERVICE.

STV PROJECT No.: 38-17335

REV.	DATE	APP#	DESCRIPTION	APPROVAL
ENGINEERING RECORD				
			DRAWN BY: CNN	
			CHECKED BY: RJC	
			APPROVED BY: CDA	
			DATE: 03/17/16	
			SCALE: AS NOTED	
OLD DRAWING NO.			DWG. NO.	REV. NO.
			S-B18-19-C-101	0



PENNSYLVANIA PIPELINE PROJECT  
STREAM S-B18-19  
EROSION & SEDIMENTATION  
CONTROL PLAN AND PROFILE

CHESTER COUNTY, PA