

PLAN
SCALE: 1"=20'

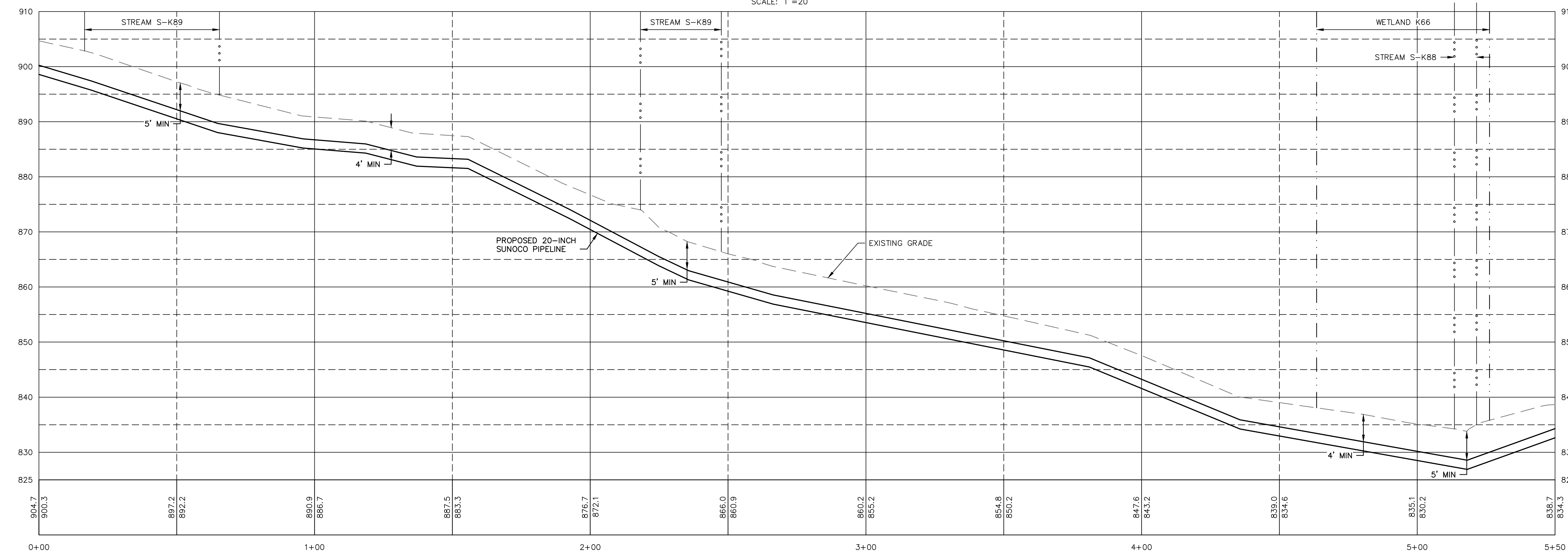

PLAN
HORZ SCALE: 1"=20'
VERT SCALE: 1"=10'

PROFILE LEGEND:
 — PROPOSED PIPELINE
 - - - EXISTING GRADE
 — EXISTING GRADE ELEV.
 — PROPOSED TOP OF PIPE ELEV.

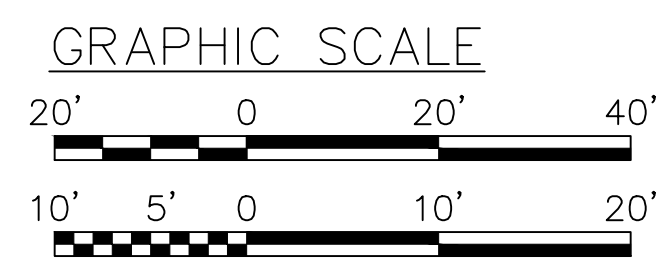

STV
 Baltimore, MD Bismarck, ND Denver, CO Douglassville, PA Houston, TX
 Pittsburgh, PA Williamsport, PA
 THE LOCATION OF THE PIPELINE FACILITIES AS SHOWN HEREON MUST BE
 CONSIDERED AS APPROXIMATE ONLY. BEFORE DIGGING OR FOR AN EXACT
 LOCATION PLEASE CONTACT YOUR STATES UNDERGROUND UTILITY LOCATION
 SERVICE.
 STV PROJECT No.: 38-17335

REV.	DATE	APP#	DESCRIPTION	APPROVAL
ENGINEERING RECORD				
	DRAWN BY	CNN		
	CHECKED BY	RJC		
	APPROVED BY	CGA		
	DATE	03/17/16		
	SCALE	AS NOTED		
OLD DRAWING NO.			DWG. NO.	REV. NO.
			S-K89-C-101	0

Sunoco Logistics Partners L.P.

PENNSYLVANIA PIPELINE PROJECT
STREAM S-K89
EROSION & SEDIMENTATION
CONTROL PLAN AND PROFILE

HUNTINGDON COUNTY, PA