

REQUIREMENT K
COLOR PHOTOGRAPHS

Please refer to Figure 4 in Enclosure A under Requirement L for the locations of photos A-H in the beginning of this section.



A. LOOKING ACROSS FIRST SCHUYLKILL CROSSING FROM SOUTHERN BANK



B. LOOKING ACROSS FIRST SCHUYLKILL CROSSING FROM NORTHERN BANK



CROSSING PHOTOGRAPHS
BIRDSBORO POWER, LLC
BOROUGH OF BIRDSBORO; ROBESON, UNION AND EXETER TOWNSHIP
BERKS COUNTY, PENNSYLVANIA

Job No. 216040.01



C. LOOKING WEST-NORTHWEST AT WETLAND ARK4 CROSSING



D. LOOKING EAST-SOUTHEAST AT WETLAND ARK4 CROSSING



CROSSING PHOTOGRAPHS
BIRDSBORO POWER, LLC
BOROUGH OF BIRDSBORO; ROBESON, UNION AND EXETER TOWNSHIP
BERKS COUNTY, PENNSYLVANIA

Job No. 216040.01



E. LOOKING SOUTHWEST AT WETLAND-STREAM COMPLEX ME1/ME2 CROSSING



F. LOOKING NORTH AT WETLAND-STREAM COMPLEX ME1/ME2 CROSSING



CROSSING PHOTOGRAPHS
BIRDSBORO POWER, LLC
BOROUGH OF BIRDSBORO; ROBESON, UNION AND EXETER TOWNSHIP
BERKS COUNTY, PENNSYLVANIA

Job No. 216040.01



G. LOOKING ACROSS SECOND SCHUYLKILL CROSSING FROM NORTHERN BANK



H. LOOKING ACROSS SECOND SCHUYLKILL CROSSING FROM SOUTHERN BANK



CROSSING PHOTOGRAPHS
BIRDSBORO POWER, LLC
BOROUGH OF BIRDSBORO; ROBESON, UNION AND EXETER TOWNSHIP
BERKS COUNTY, PENNSYLVANIA

Job No. 216040.01

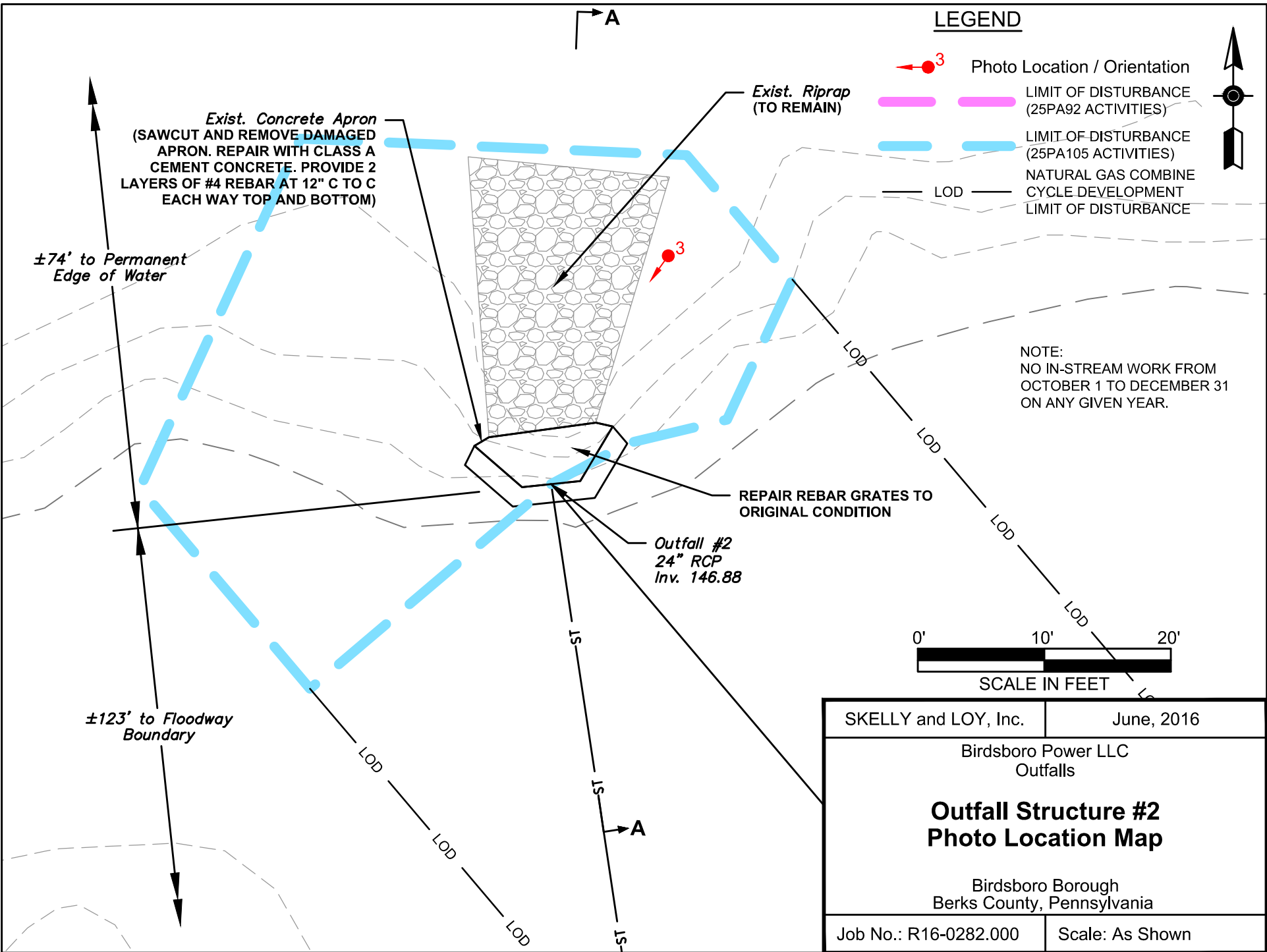

Exist. Concrete Apron
(SAWCUT AND REMOVE DAMAGED APRON. REPAIR WITH CLASS A CEMENT CONCRETE. PROVIDE 2 LAYERS OF #4 REBAR AT 12" C TO C EACH WAY TOP AND BOTTOM)

±74' to Permanent Edge of Water

Exist. Riprap
(TO REMAIN)

REPAIR REBAR GRATES TO ORIGINAL CONDITION

Outfall #2
24" RCP
Inv. 146.88

±123' to Floodway Boundary

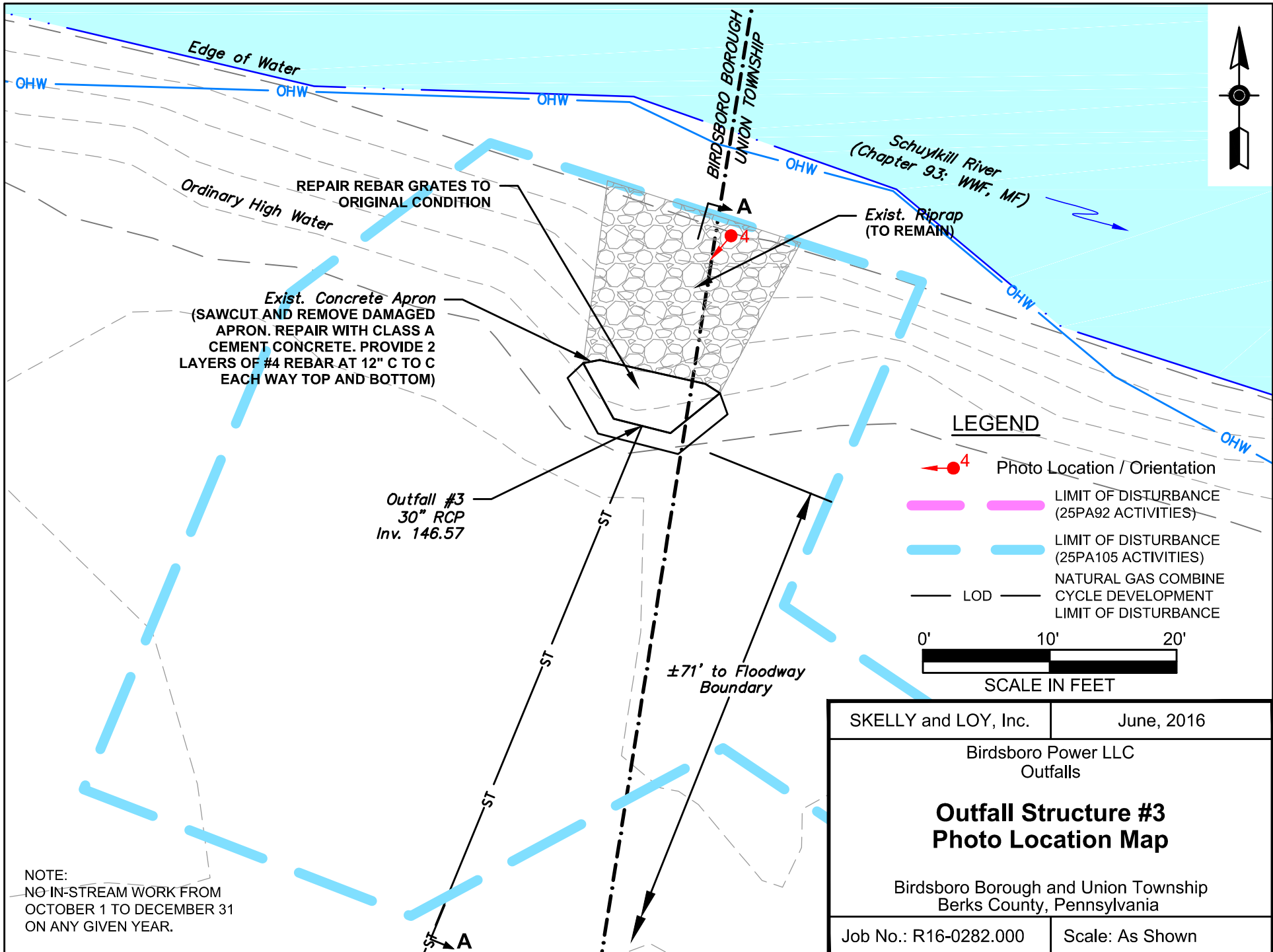

NOTE:
NO IN-STREAM WORK FROM
OCTOBER 1 TO DECEMBER 31
ON ANY GIVEN YEAR.

SKELLY and LOY, Inc.	June, 2016
Birdsboro Power LLC Outfalls	
Outfall Structure #3 Photo Location Map	
Birdsboro Borough and Union Township Berks County, Pennsylvania	
Job No.: R16-0282.000	Scale: As Shown

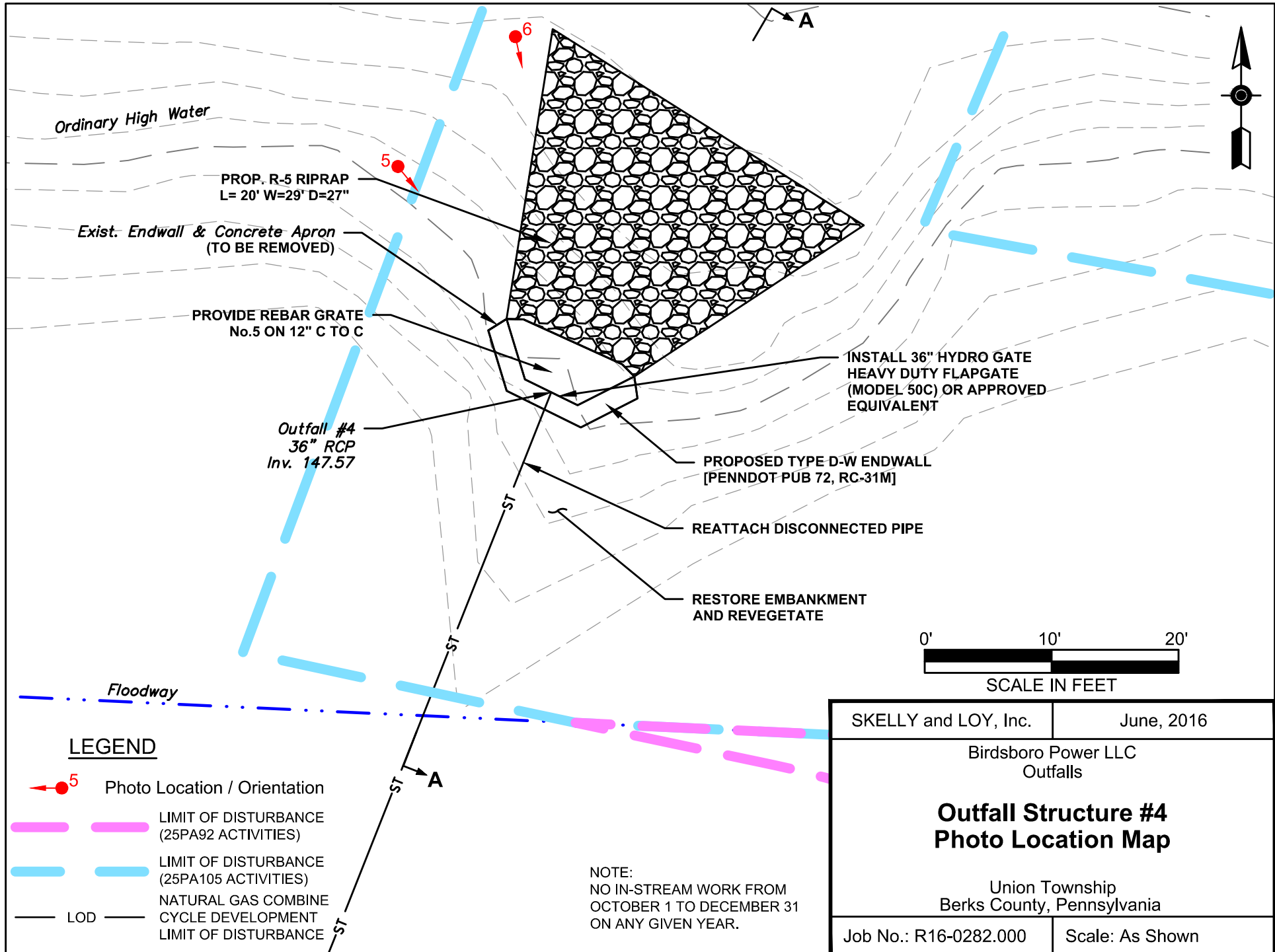



Photograph No. 3

Facing south/southwest
at Outfall #2



Photograph No. 4
Facing south/southwest
at Outfall #3



Photograph No. 5
Facing south/southeast
at Outfall #4



Photograph No. 6
Facing south at Outfall
#4