

DURHAM TOWNSHIP, BUCKS COUNTY, PENNSYLVANIA

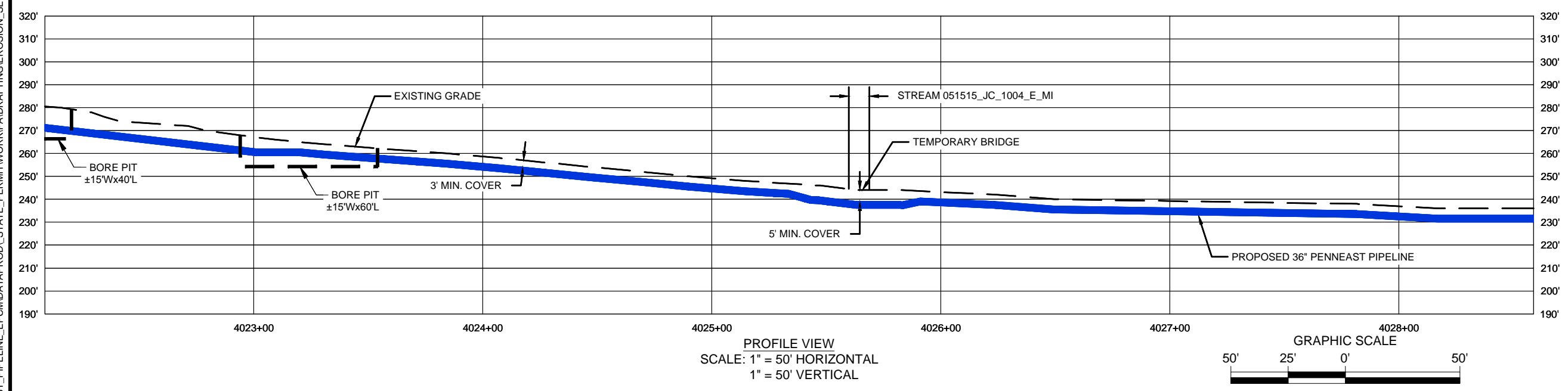
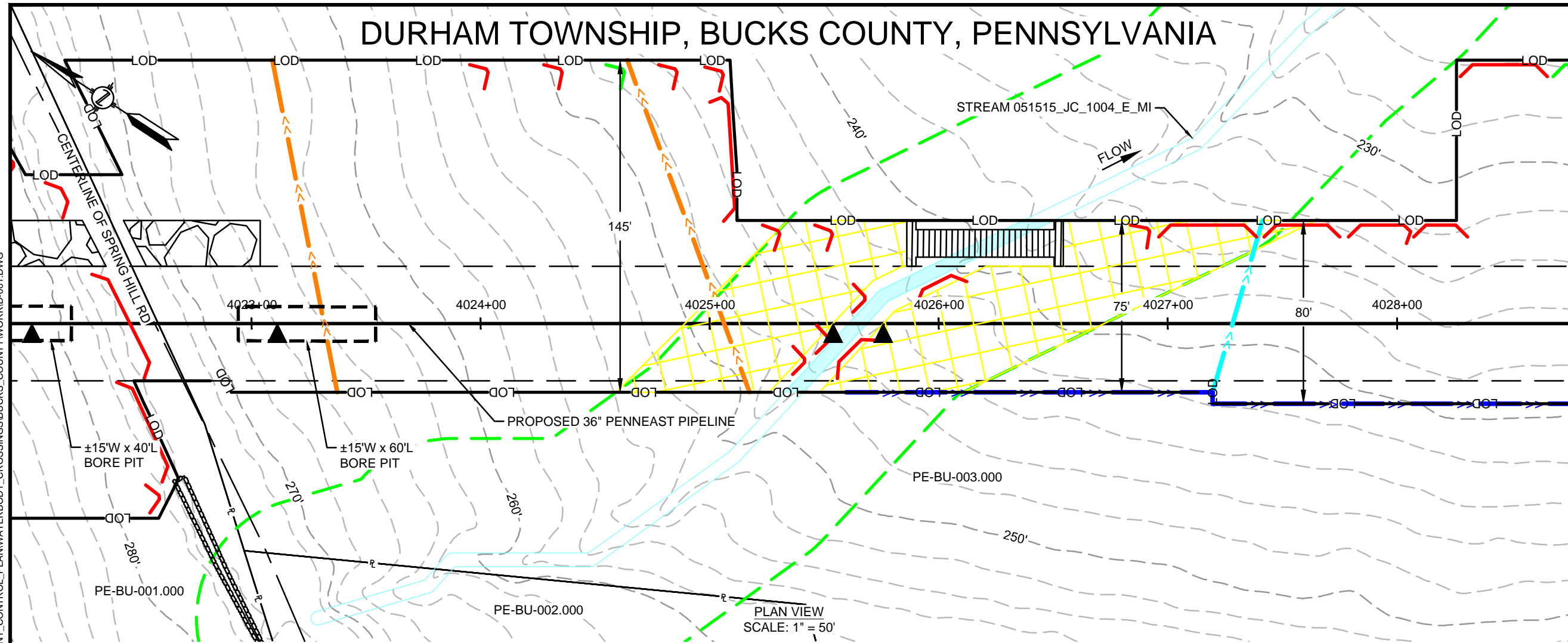

FEATURE ID	RESOURCE TYPE	REGULATORY IMPACT	TEMPORARY DISTURBANCE (ACRES)		PERMANENT DISTURBANCE (ACRES)		STREAM IMPACT (FT)	CROSSING METHOD			EQUIPMENT CROSSING	
			WETLAND	WATERCOURSE CHANNEL	WETLAND	WATERCOURSE CHANNEL		PRIMARY	SECONDARY	TERTIARY		MAT BRIDGE OR EQUIVALENT
051515_JC_1004_E_MI	WATERBODY	PADEP USACE	-	0.012	-	0.006	89	DPX	FX	FX	DX-NF	DX-NF

10/24/2019 11:24 PM, MORALES, HECTOR
G:\PENNEAST\353754_PENNEAST_PIPELINE_EPC\DATA\PROD\STATE_PERMIT\WORK\PA\DRAWING\EROSION_SEDIMENT_CONTROL_PLAN\WATERBODY_CROSSINGS\BUCKS_COUNTY\WORK\001.DWG

REVISIONS					
NO.	DATE	DESCRIPTION	DRAWN	CHECK	APPROVAL
0	10/2018	ISSUED FOR PADEP 105 PERMIT	HM	JB/KEK	MJD
1	04/2019	REVISED FOR USACE	HM	JB/KEK	MJD
2	10/2019	REVISED FOR USACE	HM	JB/KEK	MJD

APPROVALS	
DRAWN BY	DATE
HM (MM)	10/2018
CHECKED BY	DATE
JB/KEK (MM)	10/2018
ENG. APPROVAL	DATE
MJD (MM)	10/2018
P.M. APPROVAL	DATE

PREPARED FOR:



PREPARED BY:

PENNEAST PIPELINE PROJECT
WETLAND & STREAM CROSSING PLAN
PROPOSED 36" PENNEAST PIPELINE
 DURHAM TOWNSHIP, BUCKS COUNTY, PENNSYLVANIA
 M.P. 76.2

SCALE	DRAWING NO.	REVISION
1"=50'	WSS-BU-ML-001	2

DURHAM TOWNSHIP, BUCKS COUNTY, PENNSYLVANIA

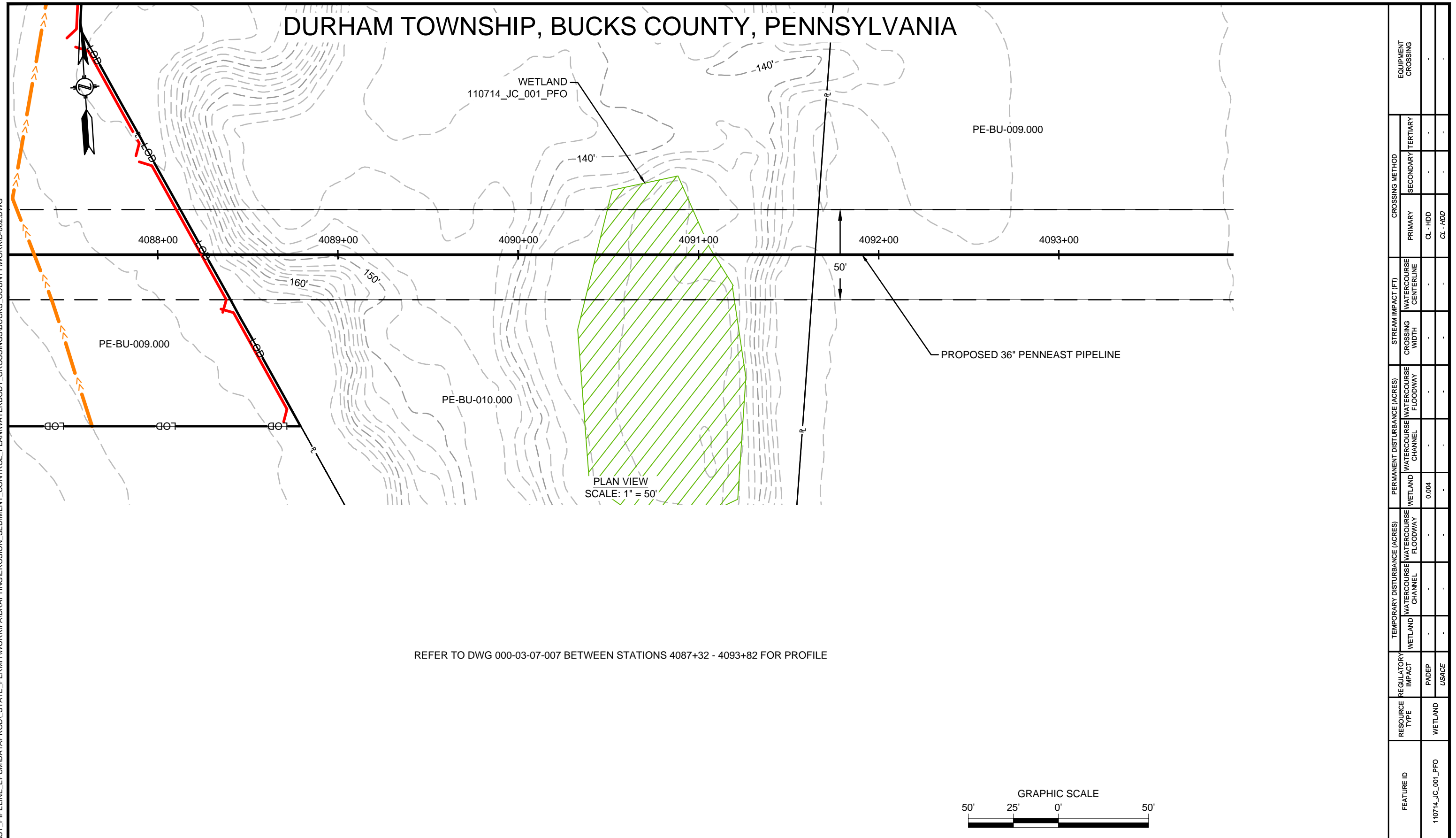

REFER TO DWG 000-03-07-007 BETWEEN STATIONS 4087+32 - 4093+82 FOR PROFILE

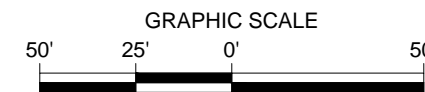

EQUIPMENT CROSSING	CROSSING METHOD		STREAM IMPACT (FT)	PERMANENT DISTURBANCE (ACRES)	TEMPORARY DISTURBANCE (ACRES)		REGULATORY IMPACT	RESOURCE TYPE	FEATURE ID
	PRIMARY	SECONDARY			TERTIARY	WATERCOURSE CHANNEL			
	CL - HDD						PADEP	WETLAND	110714_JC_001_PFO
	CL - HDD				0.004		USACE		

10/28/2019 5:01 PM, MORALES, HECTOR
G:\PENNEAST\353754_PENNEAST_PIPELINE_EPC\DATA\PROD\STATE_PERMIT\WORK\PA\DRAWING\EROSION_CONTROL_PLAN\WATERBODY_CROSSINGS\BUCKS_COUNTY\WORK\002.DWG

REVISIONS					
NO.	DATE	DESCRIPTION	DRAWN	CHECK	APPROVAL
0	10/2018	ISSUED FOR PADEP 105 PERMIT	HM	JB/KEK	MJD
1	04/2019	REVISED FOR USACE	HM	JB/KEK	MJD
2	10/2019	REVISED FOR USACE	HM	JB/KEK	MJD

APPROVALS	
DRAWN BY	DATE
HM (MM)	10/2018
CHECKED BY	DATE
JB/KEK (MM)	10/2018
ENG. APPROVAL	DATE
MJD (MM)	10/2018
P.M. APPROVAL	DATE

PREPARED FOR:

PREPARED BY:

PENNEAST PIPELINE PROJECT		
WETLAND & STREAM CROSSING PLAN PROPOSED 36" PENNEAST PIPELINE DURHAM TOWNSHIP, BUCKS COUNTY, PENNSYLVANIA M.P. 77.5		
SCALE	DRAWING NO.	REVISION
1"=50'	WSS-BU-ML-002	2

DURHAM TOWNSHIP, BUCKS COUNTY, PENNSYLVANIA & HOLLAND TOWNSHIP, HUNTERDON COUNTY, NEW JERSEY

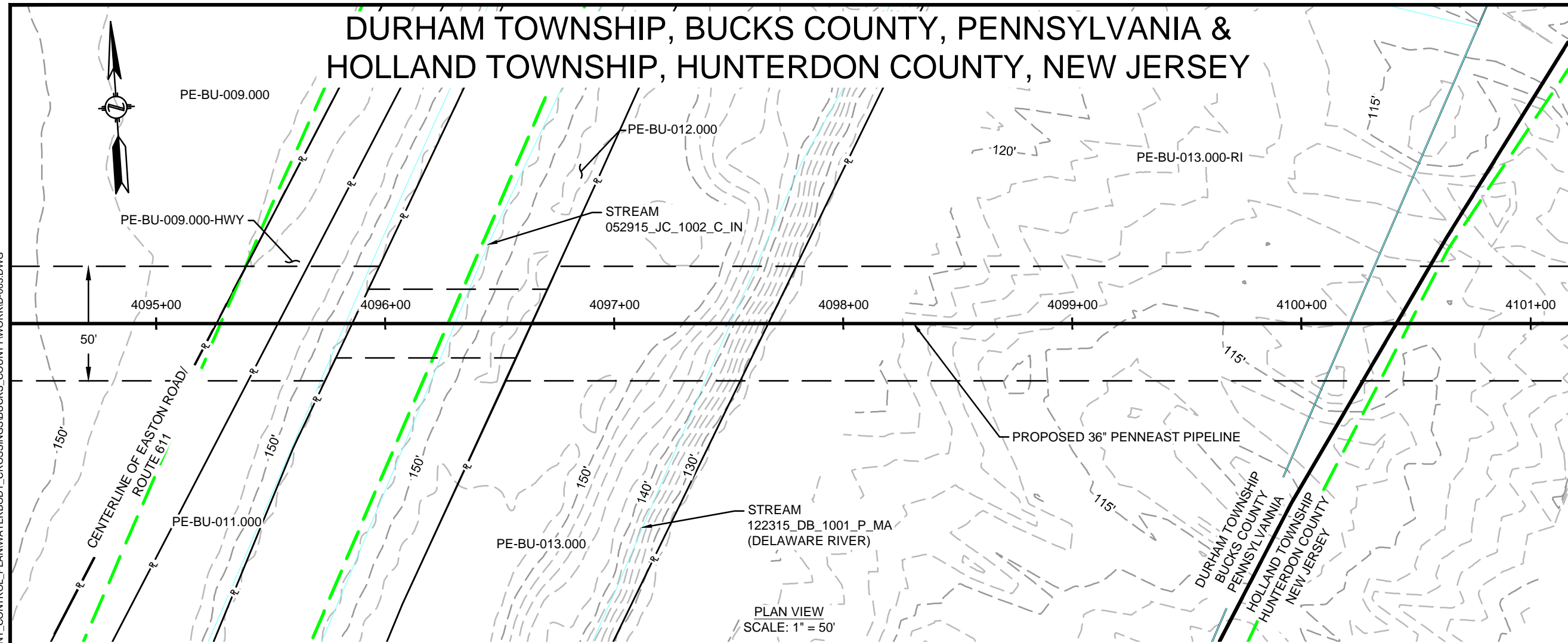

PLAN VIEW
SCALE: 1" = 50'

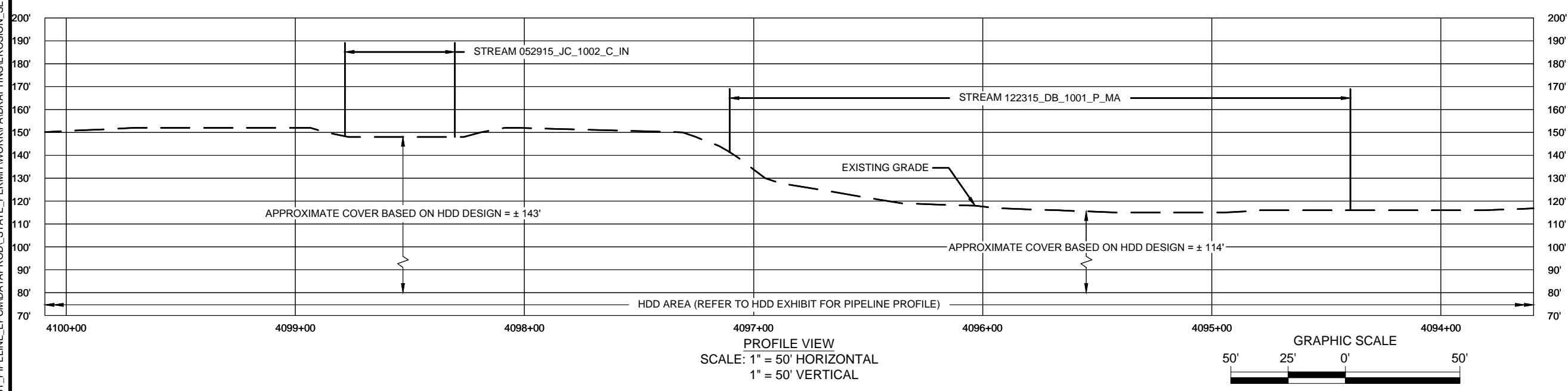

PROFILE VIEW
SCALE: 1" = 50' HORIZONTAL
1" = 50' VERTICAL

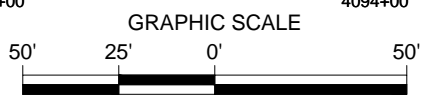

FEATURE ID	RESOURCE TYPE	REGULATORY IMPACT	TEMPORARY DISTURBANCE (ACRES)		PERMANENT DISTURBANCE (ACRES)		STREAM IMPACT (FT)			CROSSING METHOD			EQUIPMENT CROSSING
			WETLAND	WATERCOURSE CHANNEL	WETLAND	WATERCOURSE CHANNEL	WATERCOURSE CENTERLINE	PRIMARY	SECONDARY	TERTIARY			
052915_JC_1002_C_IN	WATERBODY	PADEP	-	0.003	-	0.004	-	3	HDD	HDD	HDD	N/A	
122315_DB_1001_P_MA	WATERBODY	USACE	-	0.021	-	0.008	-	3	HDD	HDD	HDD	N/A	

10/24/2019 11:23 PM, MORALES, HECTOR
G:\PENNEAST\353754_PENNEAST_PIPELINE_EPC\DATA\PROD\STATE_PERMIT\WORK\PA\DRAWING\EROSION_SEDIMENT_CONTROL_PLAN\WATERBODY_CROSSINGS\BUCKS_COUNTY\WORK\003.DWG

REVISIONS					
NO.	DATE	DESCRIPTION	DRAWN	CHECK	APPROVAL
0	10/2018	ISSUED FOR PADEP 105 PERMIT	HM	JB/KEK	MJD
2	04/2019	REVISED FOR USACE	HM	JB/KEK	MJD
2	10/2019	REVISED FOR USACE	HM	JB/KEK	MJD

APPROVALS	
DRAWN BY	DATE
HM (MM)	10/2018
CHECKED BY	DATE
JB/KEK (MM)	10/2018
ENG. APPROVAL	DATE
MJD (MM)	10/2018
P.M. APPROVAL	DATE

PREPARED FOR:

PREPARED BY:

PENNEAST PIPELINE PROJECT
WETLAND & STREAM CROSSING PLAN
PROPOSED 36" PENNEAST PIPELINE
 DURHAM TOWNSHIP, BUCKS COUNTY, PENNSYLVANIA & HOLLAND TOWNSHIP, HUNTERDON COUNTY, NEW JERSEY
 M.P. 77.6

SCALE	DRAWING NO.	REVISION
1"=50'	WSS-BU-ML-003	2