

DURHAM TOWNSHIP, BUCKS COUNTY, PENNSYLVANIA

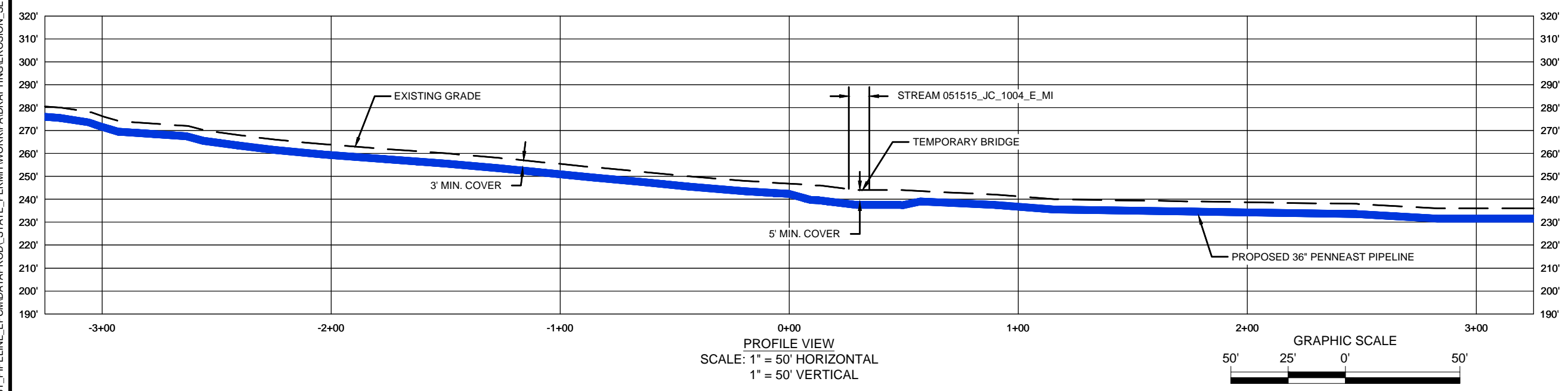
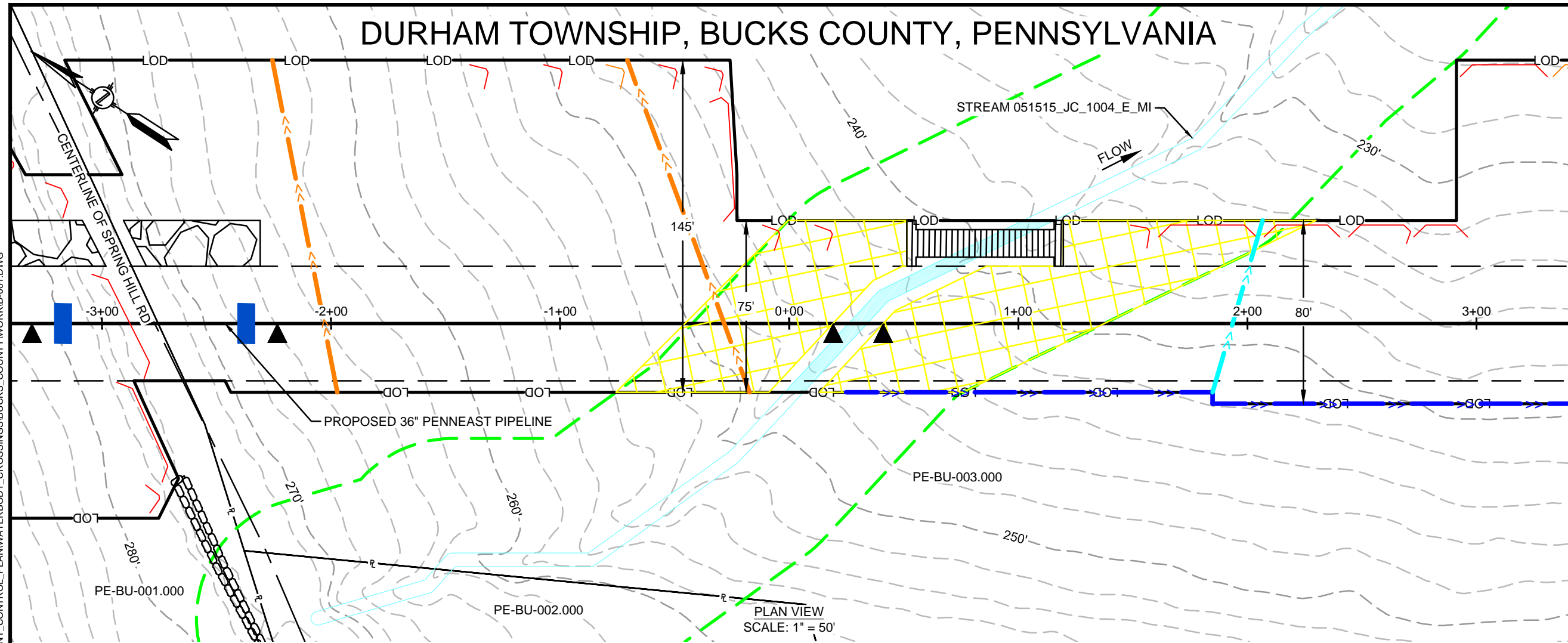

EQUIPMENT CROSSING	CROSSING METHOD		PERMANENT DISTURBANCE (ACRES)		TEMPORARY DISTURBANCE (ACRES)		RESOURCE TYPE	FEATURE ID
	PRIMARY	SECONDARY	WATERCOURSE CHANNEL	WATERCOURSE FLOODWAY	WATERCOURSE CHANNEL	WATERCOURSE FLOODWAY		
MAT BRIDGE OR EQUIVALENT	DPX	FX	0.01	0.20	0.01	0.11	WATERBODY	051515_JC_1004_E_MI

11/16/2018 1:02 AM, RODRIGUEZ, ROBERTO J
G:\PENNEAST\353754_PENNEAST_PIPELINE_EPCMDATA\PROD\STATE_PERMIT\WORK\PAIDRAFTING\EROSION_SEDIMENT_CONTROL_PLAN\WATERBODY_CROSSINGS\BUCKS_COUNTY\WORK\001.DWG

REVISIONS			DRAWN	CHECK	APPROVAL
NO.	DATE	DESCRIPTION			
0	10/2018	ISSUED FOR PADEP 105 PERMIT	HM	JB/KEK	MJD

APPROVALS	
DRAWN BY	DATE
HM (MM)	10/2018
CHECKED BY	DATE
JB/KEK (MM)	10/2018
ENG. APPROVAL	DATE
MJD (MM)	10/2018
P.M. APPROVAL	DATE

PREPARED FOR:

PREPARED BY:

PENNEAST PIPELINE PROJECT		
WETLAND & STREAM CROSSING PLAN PROPOSED 36" PENNEAST PIPELINE DURHAM TOWNSHIP, BUCKS COUNTY, PENNSYLVANIA M.P. 76.2		
SCALE	DRAWING NO.	REVISION
1"=50'	WSS-BU-ML-001	0

11/16/2018 1:03 AM, RODRIGUEZ, ROBERTO J
 G:\PENNEAST\353754_PENNEAST_PIPELINE_EPC\MIDATA\PROD\STATE_PERMIT\WORK\PAIDRAFTING\EROSION_SEDIMENT_CONTROL_PLAN\WATERBODY_CROSSINGS\BUCKS_COUNTY\WORK\002.DWG

DURHAM TOWNSHIP, BUCKS COUNTY, PENNSYLVANIA

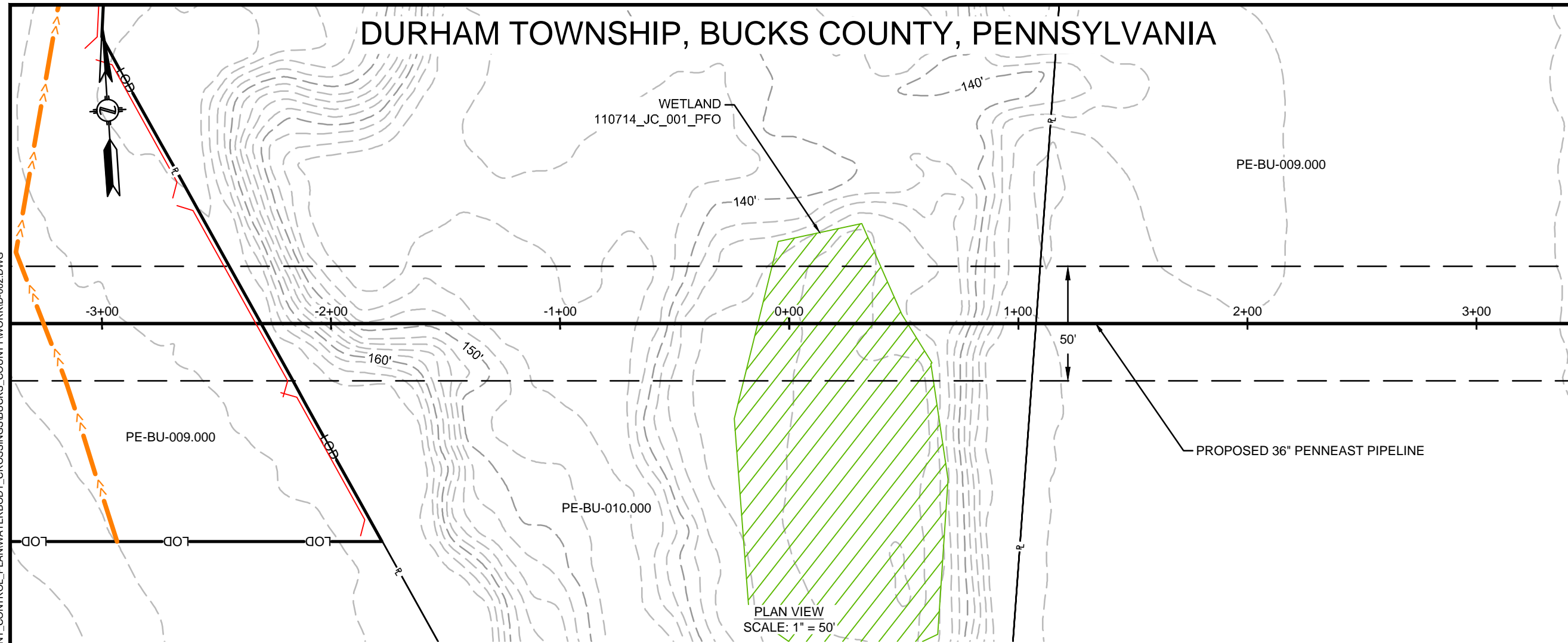

PLAN VIEW
 SCALE: 1" = 50'

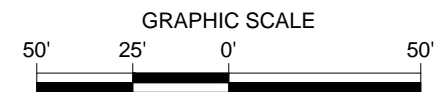

FEATURE ID	110714_JC_001_PFO	
	RESOURCE TYPE	WETLAND
PERMANENT DISTURBANCE (ACRES)	WETLAND	0.00
	WATERCOURSE CHANNEL	.
	WATERCOURSE FLOODWAY	.
	WATERCOURSE FLOODWAY	.
TEMPORARY DISTURBANCE (ACRES)	WETLAND	.
	WATERCOURSE CHANNEL	.
	WATERCOURSE FLOODWAY	.
	WATERCOURSE FLOODWAY	.
CROSSING METHOD	PRIMARY	CL - HDD
	SECONDARY	.
	TERTIARY	.
EQUIPMENT CROSSING	.	

REVISIONS					
NO.	DATE	DESCRIPTION	DRAWN	CHECK	APPROVAL
0	10/2018	ISSUED FOR PADEP 105 PERMIT	HM	JB/KEK	MJD

APPROVALS	
DRAWN BY	DATE
HM (MM)	10/2018
CHECKED BY	DATE
JB/KEK (MM)	10/2018
ENG. APPROVAL	DATE
MJD (MM)	10/2018
P.M. APPROVAL	DATE

PREPARED FOR:

PREPARED BY:

PENNEAST PIPELINE PROJECT		
WETLAND & STREAM CROSSING PLAN PROPOSED 36" PENNEAST PIPELINE DURHAM TOWNSHIP, BUCKS COUNTY, PENNSYLVANIA M.P. 77.5		
SCALE	DRAWING NO.	REVISION
1"=50'	WSS-BU-ML-002	0

DURHAM TOWNSHIP, BUCKS COUNTY, PENNSYLVANIA & HOLLAND TOWNSHIP, HUNTERDON COUNTY, NEW JERSEY

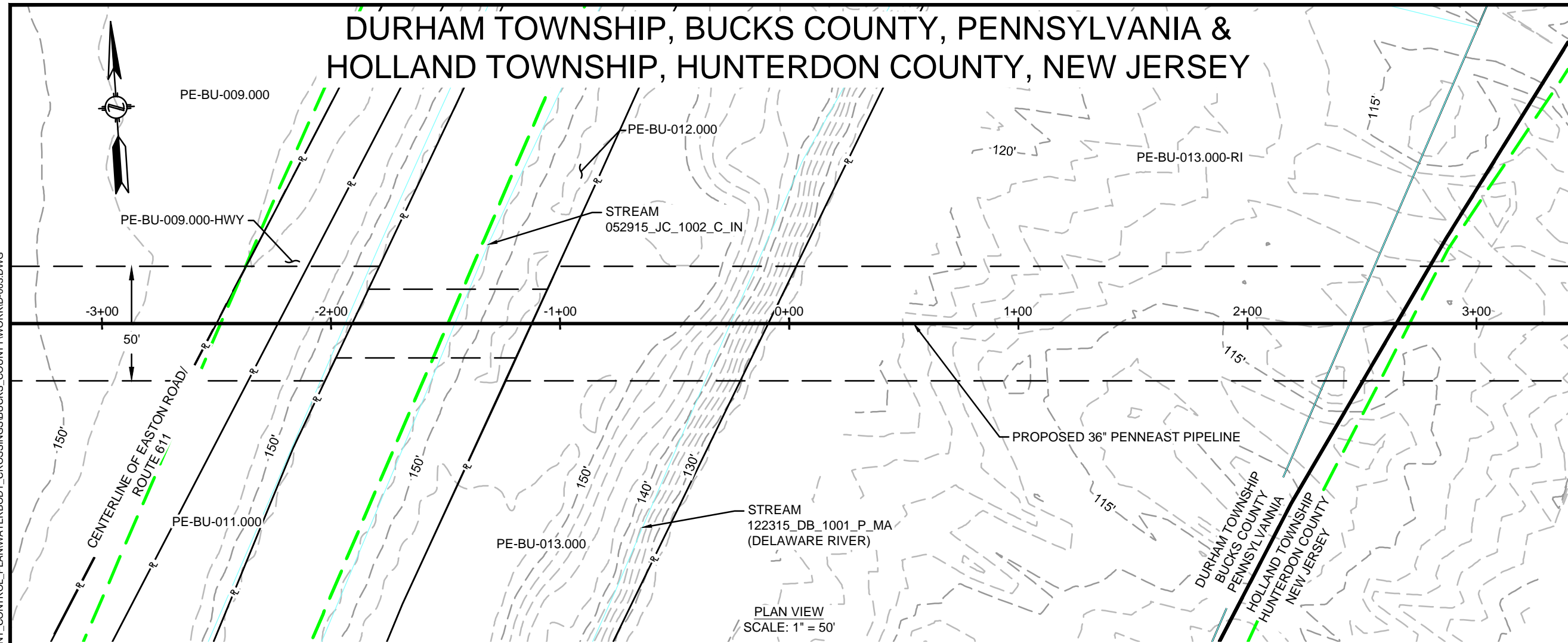

PLAN VIEW
SCALE: 1" = 50'

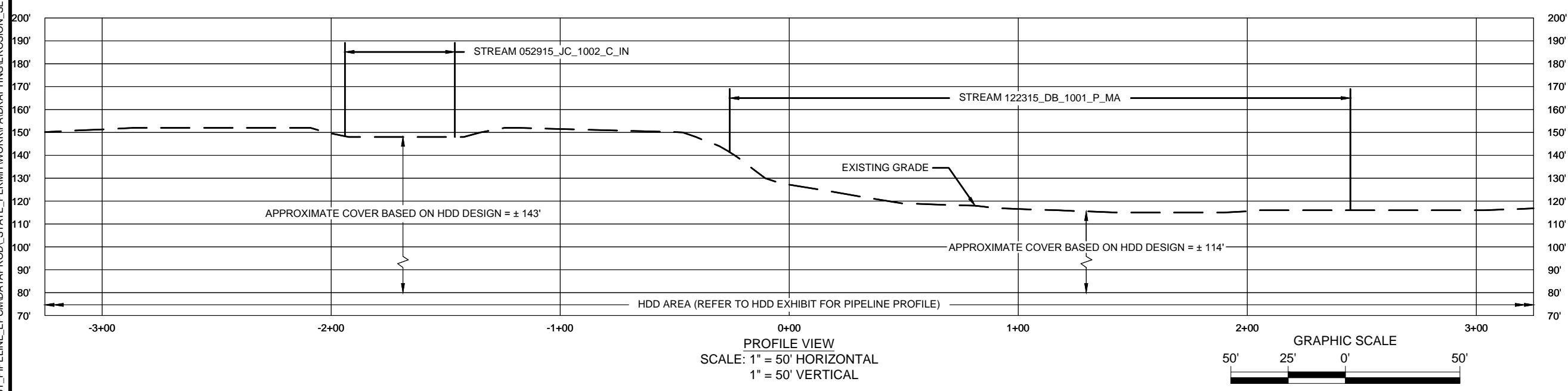

PROFILE VIEW
SCALE: 1" = 50' HORIZONTAL
1" = 50' VERTICAL

FEATURE ID	RESOURCE TYPE	TEMPORARY DISTURBANCE (ACRES)			PERMANENT DISTURBANCE (ACRES)			CROSSING METHOD			EQUIPMENT CROSSING
		WETLAND	WATERCOURSE CHANNEL	WATERCOURSE FLOODWAY	WETLAND	WATERCOURSE CHANNEL	WATERCOURSE FLOODWAY	PRIMARY	SECONDARY	TERTIARY	
052915_JC_1002_C_IN	WATERBODY	-	-	-	-	0.00	0.00	HDD	HDD	HDD	N/A
122315_DB_1001_P_MA	WATERBODY	-	-	-	-	0.02	0.00	HDD	HDD	HDD	N/A

12/19/2018 4:07 PM, MORALES, HECTOR
G:\PENNEAST\353754_PENNEAST_PIPELINE_EPC\DATA\PROD\STATE_PERMIT\WORK\PA\DRAWING\EROSION_SEDIMENT_CONTROL_PLAN\WATERBODY_CROSSINGS\BUCKS_COUNTY\WORK\003.DWG

REVISIONS					
NO.	DATE	DESCRIPTION	DRAWN	CHECK	APPROVAL
0	10/2018	ISSUED FOR PADEP 105 PERMIT	HM	JB/KEK	MJD

APPROVALS	
DRAWN BY	DATE
HM (MM)	10/2018
CHECKED BY	DATE
JB/KEK (MM)	10/2018
ENG. APPROVAL	DATE
MJD (MM)	10/2018
P.M. APPROVAL	DATE

PREPARED FOR:



PREPARED BY:

PENNEAST PIPELINE PROJECT
WETLAND & STREAM CROSSING PLAN
PROPOSED 36" PENNEAST PIPELINE
DURHAM TOWNSHIP, BUCKS COUNTY, PENNSYLVANIA & HOLLAND TOWNSHIP, HUNTERDON COUNTY, NEW JERSEY
M.P. 77.6

SCALE	DRAWING NO.	REVISION
1"=50'	WSS-BU-ML-003	0