

DERRY TOWNSHIP, WESTMORELAND COUNTY, PENNSYLVANIA

STREAM - P18

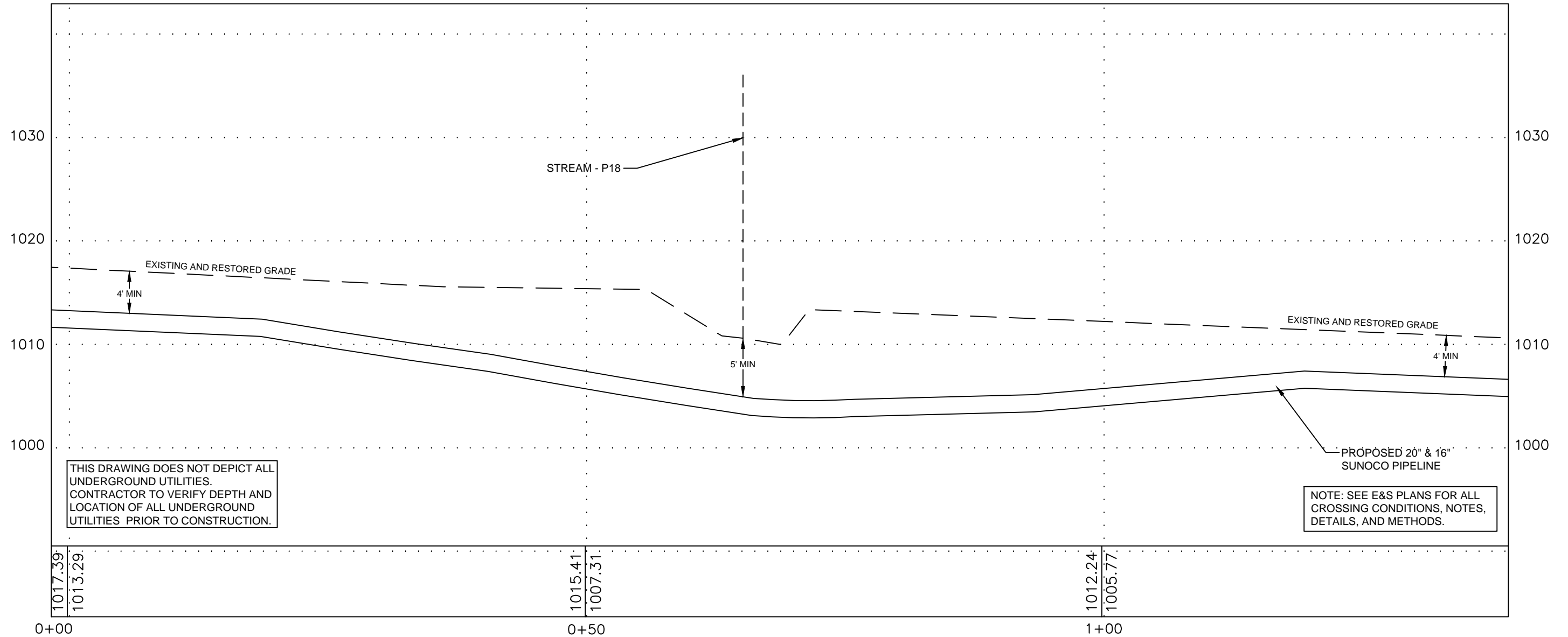

THIS DRAWING DOES NOT DEPICT ALL UNDERGROUND UTILITIES. CONTRACTOR TO VERIFY DEPTH AND LOCATION OF ALL UNDERGROUND UTILITIES PRIOR TO CONSTRUCTION.

NOTE: SEE E&S PLANS FOR ALL CROSSING CONDITIONS, NOTES, DETAILS, AND METHODS.

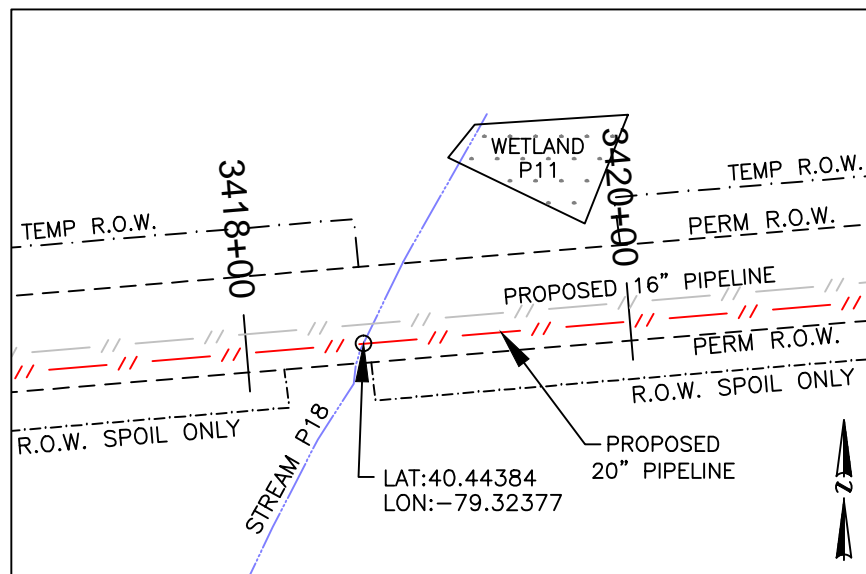

PLAN LEGEND

- PERMANENT R.O.W.
- TEMPORARY WORKSPACE
- ATWS
- R.O.W. SPOIL ONLY
- PROPERTY LINE

PLAN

HORIZ. SCALE : 1" = 100'

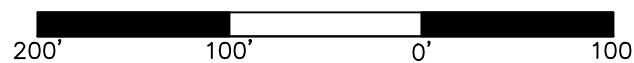

PROFILE LEGEND

- PROPOSED PIPELINE
- EXISTING AND RESTORED GRADE
- EXISTING GRADE ELEV.
- PROPOSED TOP OF PIPE ELEV.

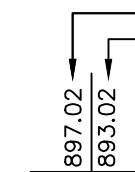

PROFILE

HORIZ. SCALE : 1" = 10'
VERT. SCALE : 1" = 10'

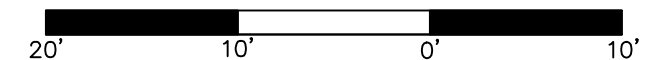

COORDINATE SYSTEM
PENNSYLVANIA STATE
PLANE SOUTH
NAD 83 US FEET

GRADE SOURCE:
SURVEYING DATA

24/7 CONTACT INFO & PIPE MARKER INFO:

SUNOCO PIPELINE L.P.
525 FRITZTOWN ROAD
SINKING SPRING, PA 19608
PHONE NUMBER: 800-786-7440
NATURAL GAS PIPELINE

CENTERLINE REV DATE: 11-11-2016

SUNOCO
STREAM - P18

DERRY TOWNSHIP, WESTMORELAND COUNTY, PA

10/25/16	SCALE	
REVISED 11/22/16	AS NOTED	DWG: PA-WM2-0097.0000-S-P18

Prepared by  **TRICO SURVEYING AND MAPPING**
BLOOMINGTON, INDIANA
WWW.TRICOSURVEYING.COM