

Graham, Rita

From: Terence Stemmler <terencestemmler@yahoo.com>
Sent: Friday, August 26, 2016 3:43 PM
To: Graham, Rita
Subject: Fw: Mariner East 2, Stemmler Property, Westmoreland Co.
Attachments: Stemmler property.pdf; Stemmler E&S Sheets 34 and 35.pdf

Rita: Here is an e-mail (with attachments) from Steve Kunz in regards to the Sunoco pipeline project on my property. Tetra Tech mislabeled my home as being in Loyalhanna Township when it is in Derry Township. Anyways, it appears that the two streams on my property may have HQ values.
Terry Stemmler

On Friday, August 26, 2016 1:02 PM, Steve Kunz <spkunz@aol.com> wrote:

Hi Terry,

This is what I can say regarding your situation. It is possible that one or both streams on your property could be attaining HQ existing uses, and that *should* be investigated by the applicant or PADEP. Also, use of boring methods (instead of the proposed open cut trenches) for a relatively short distance (about 1,400 feet) would avoid significant adverse impacts to your property, structures, streams, and a wetland.

Attached are two things that illustrate these things: 1) some drawings I put together for your property and 2) Tetra Tech E&S sheets 34 and 35 (your property is shown on Sheet 35).

One other issue that your situation raises: although property *lines* are shown on both the aerial site plans and the E&S drawings, there is no way to identify the property *owners*, because neither the owners' name or the property parcel number is shown on either set of drawings.

Steve Kunz

Stephen P. Kunz
Senior Ecologist
Schmid & Company, Inc.
1201 Cedar Grove Road
Media, PA 19063-1044
spkunz@aol.com
610-356-1416
fax: 610-356-3629
www.schmidco.com

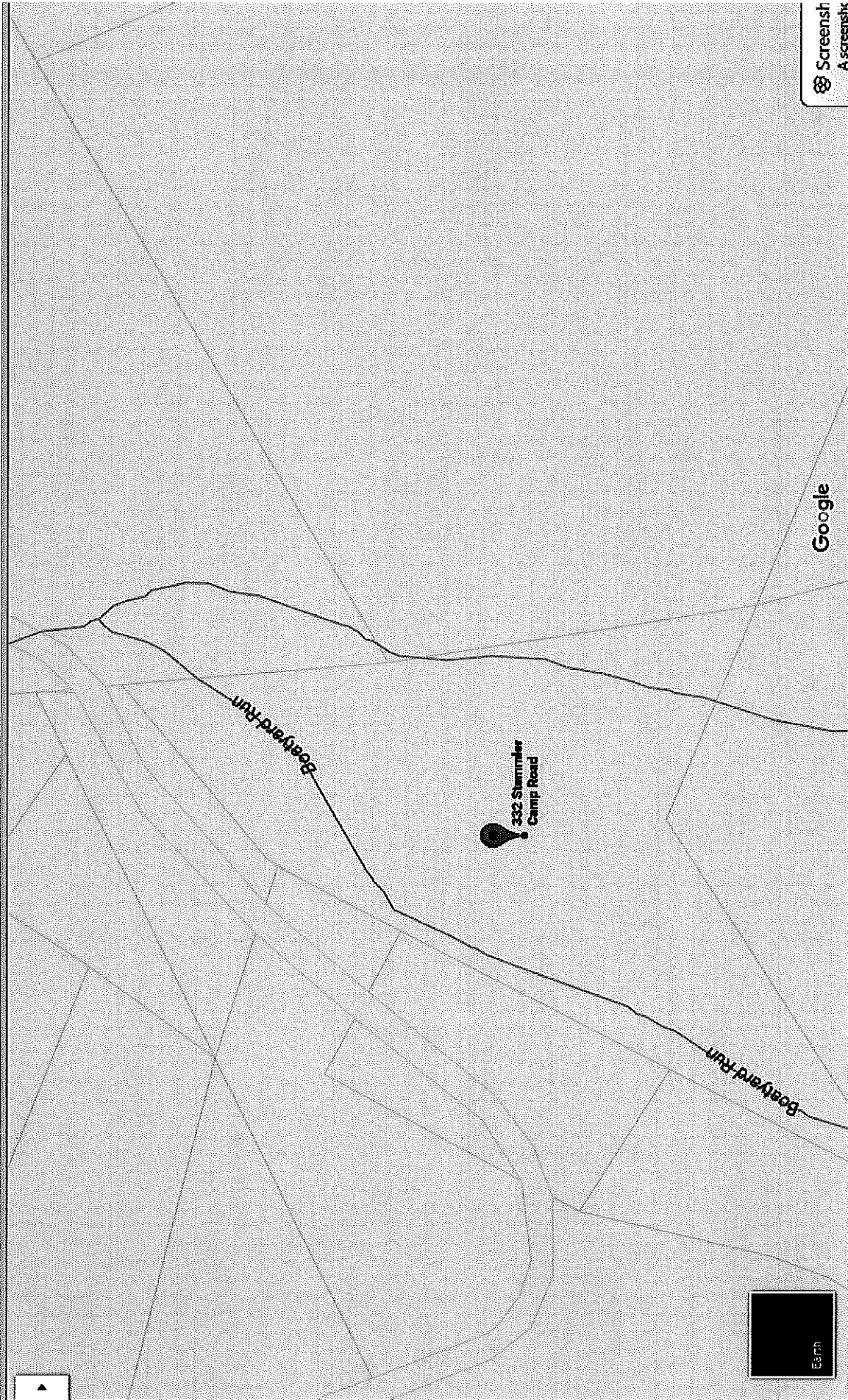

Terry Stemmler property at 332 Stemmler Camp Road, New Alexandria, PA (Westmoreland County)

Boatyard Run (#43860), and UNT to Boatyard Run (Trib 43863) cross his property, flowing south to north.

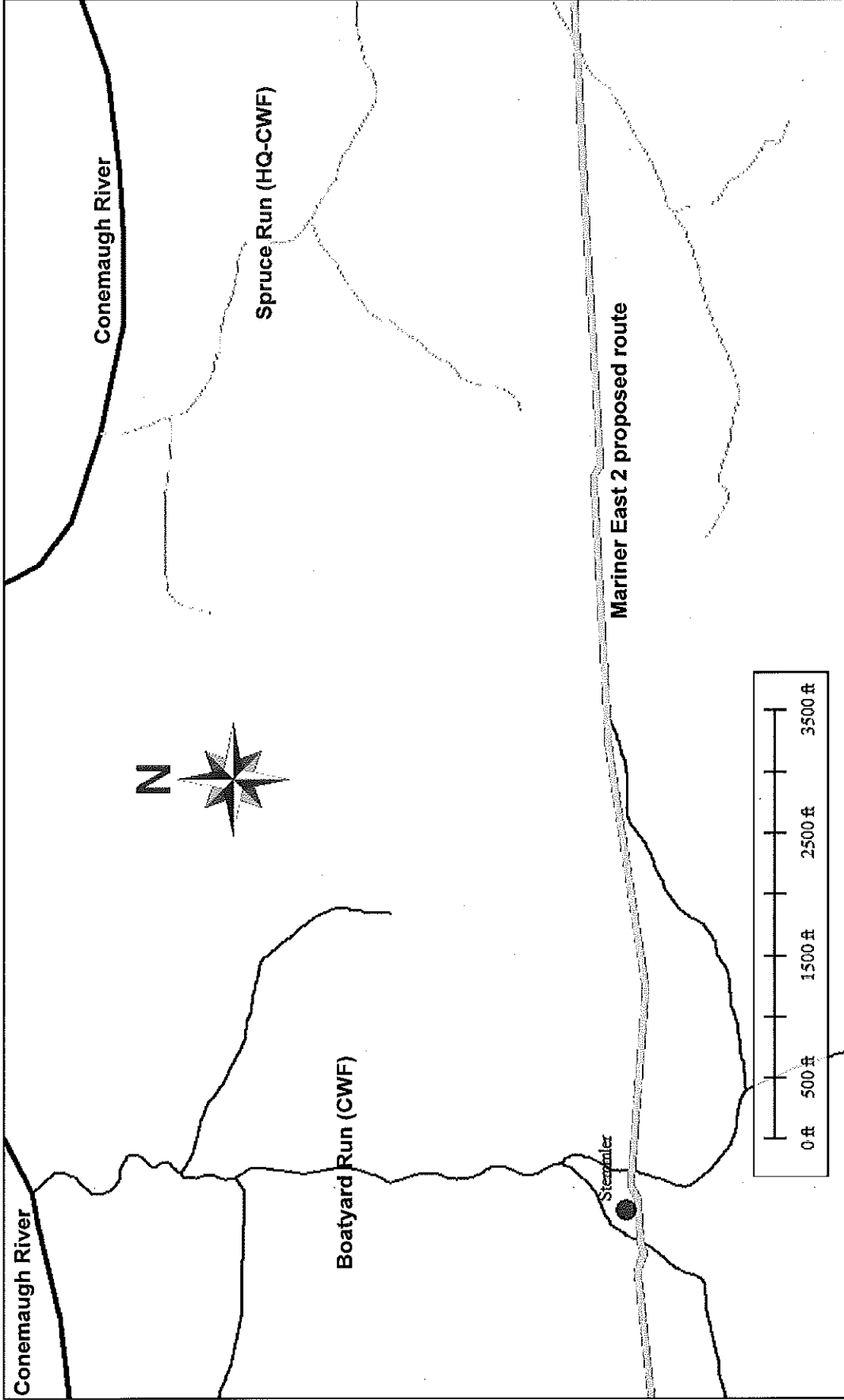

Location of Stemmler property (red dot) on Boatyard Run (designated CWF). Streams in the next watershed just to the east (Spruce Run watershed, green lines) are designated HQ-CWF. It is likely that streams crossed by the Mariner East 2 route (light blue) in the Boatyard Run watershed also are *attaining* HQ existing uses, but those uses have not been investigated in the field by the applicant or PADEP.

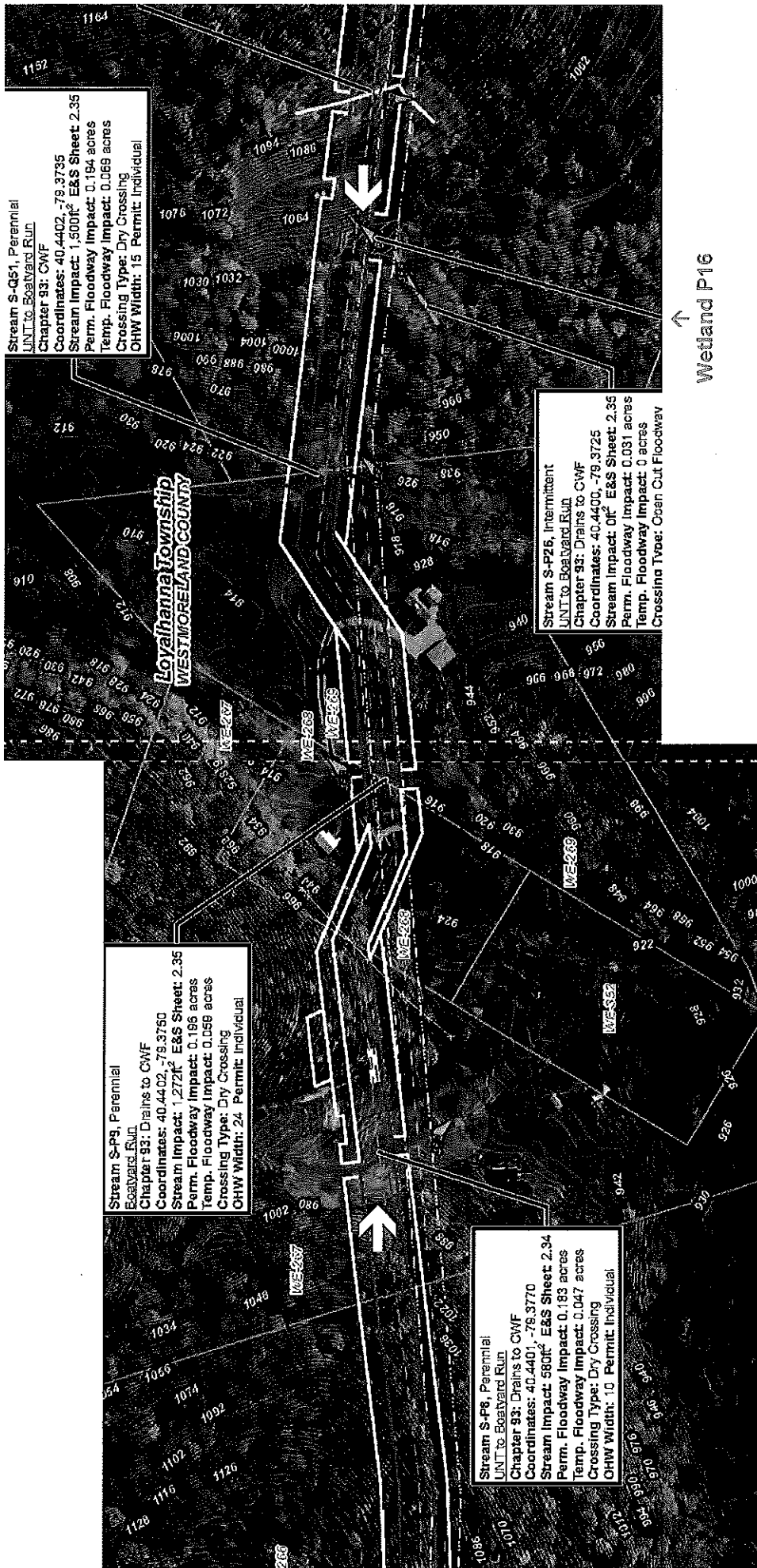

Aerial Site Plans (Sheets 73 and 74, of 82; dated May 2016) prepared by Tetra Tech for Sunoco for the section of proposed Mariner East 2 pipeline that crosses the Stemmler property and vicinity. Pipeline construction here currently is proposed to be done by open cut trenches. However, use of boring methods in the 1,400-foot section between the two yellow arrows would avoid direct impacts to one wetland (P16), three perennial streams (P8, P9, Q51), and one intermittent stream (P26), as well as two sections of a driveway and a nearby home and outbuildings.

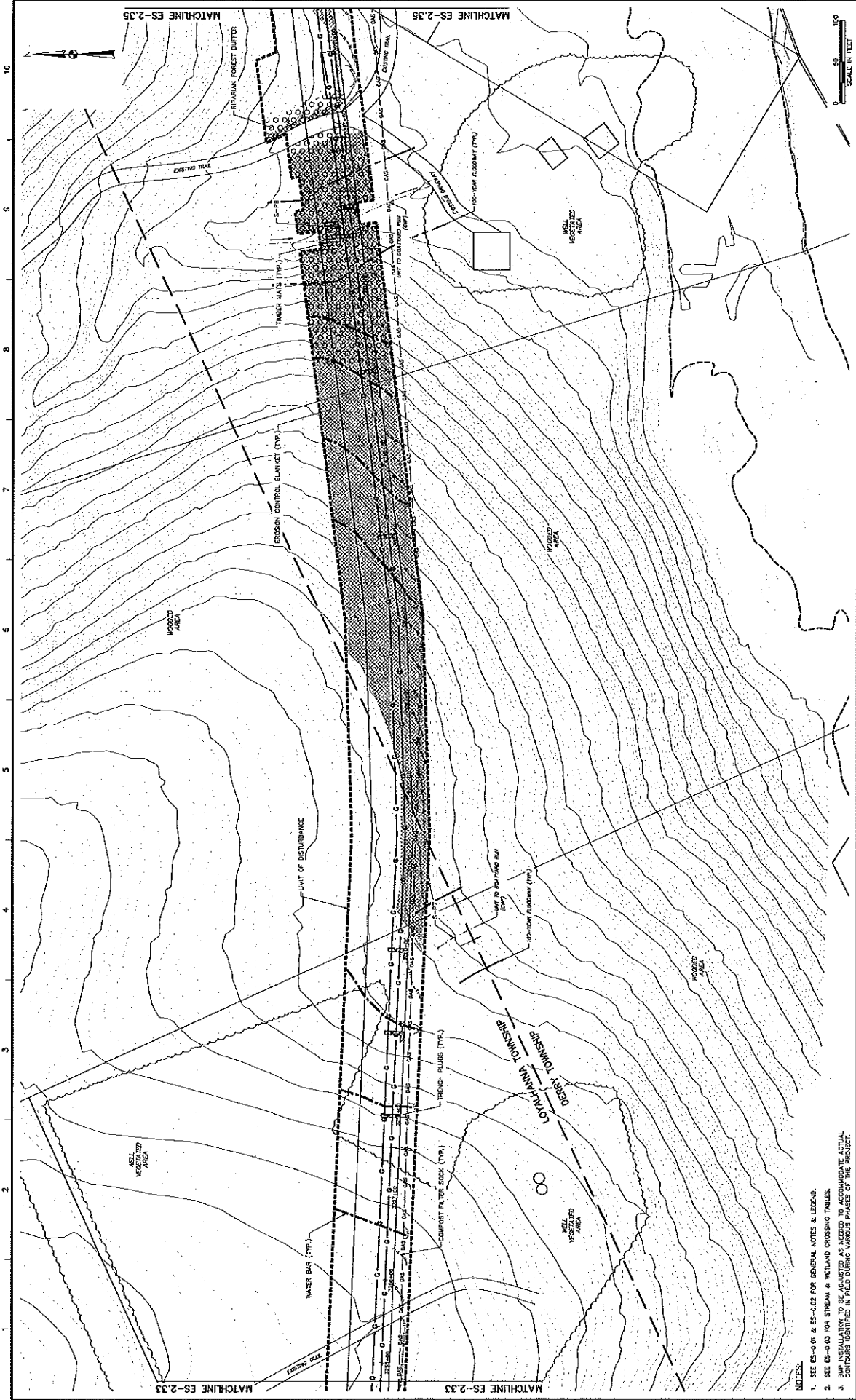

DATE: 5/17/11
 PROJECT NO.: 11020550
 DESIGNED BY: JH
 DRAWN BY: JH
 CHECKED BY: JH
 SCALE: AS SHOWN
 SHEET: 34 OF 47

SUNOCO PIPELINE L.P.
 SINKING SPRING, PENNSYLVANIA
 PENNSYLVANIA PIPELINE PROJECT
 CONSTRUCTION SPREAD 2

1-20" & 1-16" PROPOSED WELDED STEEL NATURAL GAS LIQUID PIPELINE
 WESTMORELAND COUNTY CONSERVATION DISTRICT
 EROSION & SEDIMENT CONTROL &
 SITE RESTORATION PLAN
 SHEET 34 OF 47

NO.	BY	DATE	REVISIONS	REMARKS

TETRA TECH
 www.tetrattech.com
 881 ANDERSON DRIVE - FOSTER, PA 15232
 T: (412) 821-7893 | F: (412) 821-4242

- NOTES:
1. SEE ES-0.01 & ES-0.02 FOR GENERAL NOTES & LEGEND.
 2. SEE ES-0.03 FOR STREAM & WETLAND CROSSING TABLES.
 3. BMP INSTALLATION TO BE ADJUSTED AS NEEDED TO ACCOMMODATE ACTUAL CONTOURS IDENTIFIED IN FIELD DURING VARIOUS PHASES OF THE PROJECT.

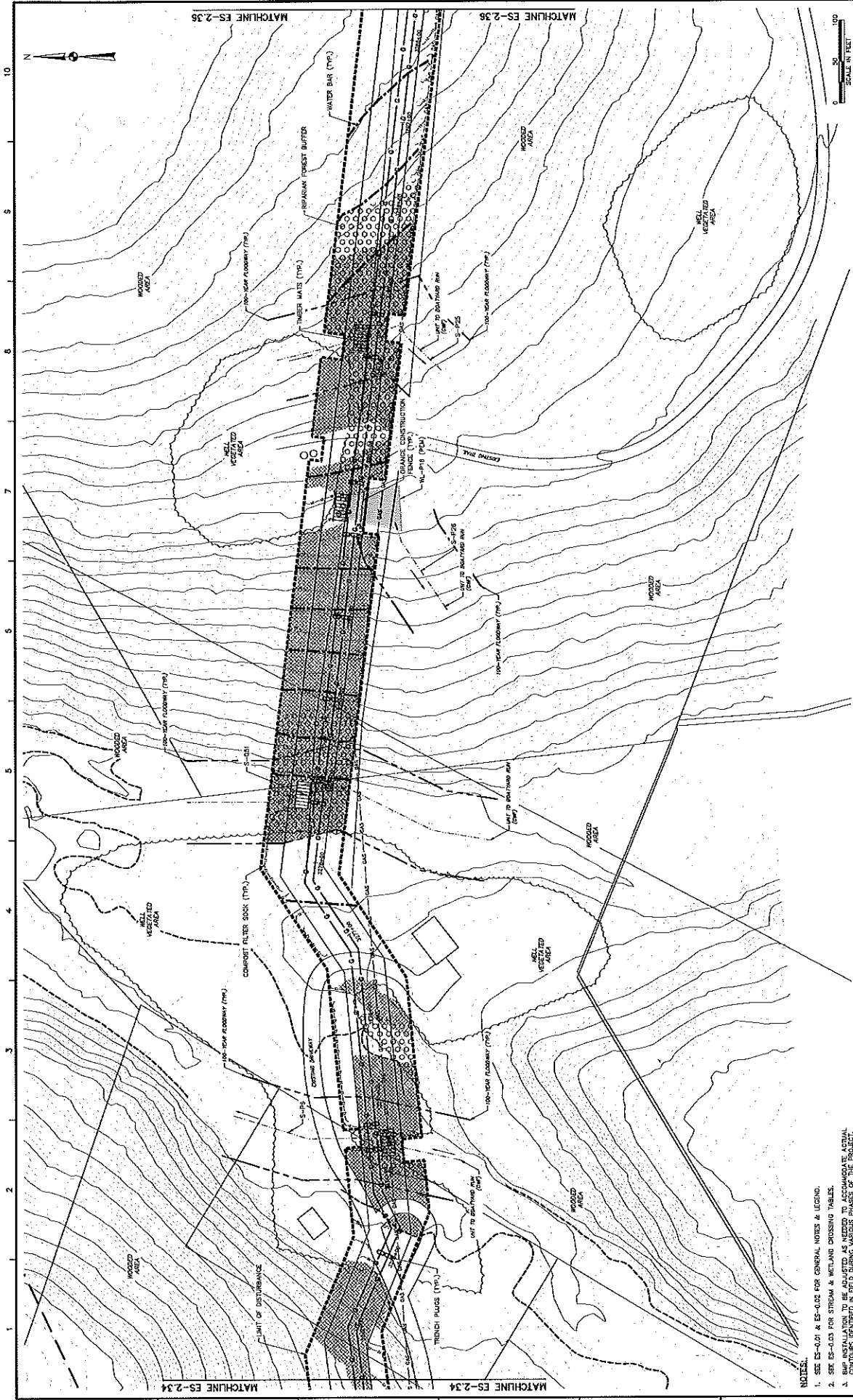

TETRA TECH
 85 ANDRESS DRIVE - FOSTER PLAZA 7
 PITTSBURGH, PA 15205
 P: 412.321.1000 F: 412.321.1040
 www.tetra-tech.com

NO.	BY	DATE	REVISIONS

SUNOCO PIPELINE L.P.
 SINKING SPRING, PENNSYLVANIA
PENNSYLVANIA PIPELINE PROJECT
 CONSTRUCTION SPREAD 2

1-20" & 1-16" PROPOSED WELDED STEEL NATURAL GAS LIQUID PIPELINE
 WESTMORELAND COUNTY CONSERVATION DISTRICT
 EROSION & SEDIMENT CONTROL &
 SITE RESTORATION PLAN
ES-2.35
 SHEET 2.35 OF 35

DATE: 3/10/19
 PROJECT NO.: 12000533
 DESIGNED BY: B1
 DRAWN BY: B1
 CHECKED BY: B1
 DATE: 3/10/19

MATCHLINE ES-2.34
 MATCHLINE ES-2.36

SCALE: 1" = 50'

- NOTES:
1. SEE ES-0.01 & ES-0.02 FOR GENERAL NOTES & LEGEND.
 2. SEE ES-0.03 FOR STREAM & WETLAND CROSSING TABLES.
 3. THIS PLAN SHALL BE AS SHOWN, TO BE ADJUSTED AS NECESSARY TO ACCOMMODATE THE ACTUAL CONDITIONS IDENTIFIED IN THE FIELD DURING VARIOUS PHASES OF THE PROJECT.