

August 18, 2017

VIA ELECTRONIC MAIL

Mr. Ronald C. Eberts
Compliance Specialist
Pennsylvania Department of Environmental Protection
reberts@pa.gov

Mr. Karl Kerchner
Lebanon County Conservation District
karl.kerchner@lccd.org

Re: Violations of the Clean Streams Law
Pennsylvania Pipeline/Mariner East II Project
DEP Permit Nos. ESG03000115002 and E38-194
DEP File No NOV 38 17 102
South Annville Township, Lebanon County
Non-compliance Report

Dear Mr. Eberts and Mr. Kerchner

On August 16, 2017, Sunoco Pipeline, L.P. ("SPLP") received a Notice of Violation ("NOV") from Ms. Andrea Blosser of the Pennsylvania Department of Environmental Protection (the "Department") concerning a release of sediment into Bachman Run (Stream S-A15) as a result of pipeline construction activities near Mount Wilson Road in South Annville Township, Lebanon County (the "Site"). As requested by the Department in the NOV, and in accordance with the requirements at Part A.III.E. of SPLP's Erosion and Sedimentation ("E&S") permit (Permit ESG0300015002), SPLP hereby provides the following Non-compliance Report related to activities at the Site between August 14, 2017, and August 16, 2017.

The NOV and the E&S Permit require the Non-compliance Report to include four categories of information. The four categories are provided in italics below, followed by the information related to each category.

- 1. The identification of any condition on the project site which may endanger public health, safety or the environment, or involve incidents which cause or threaten pollution.*

SPLP's contractor, Welded Construction, L.P. ("Welded") commenced construction activities at Bachman Run (Stream S-A15) at approximately 10:00 on August 14, 2017. The Department previously approved the use of open-cut methodology for the stream crossing at this location (Chapter 105 Permit No. E38-194).

During construction of the trench, Welded encountered groundwater seeping into the trench. Starting at approximately 10:30, this groundwater was pumped to a filter bag at a dewatering location set back

approximately 10 feet from the stream bank. At approximately 13:00, SPLP's Environmental Inspector, Bill Horton, observed that the use of the bag and the location of the bag allowed some water containing sediment to enter Bachman Run. In an attempt to correct this condition, pumping was stopped and Mr. Horton directed Welded to construct a dewatering structure, using hay bales, geotech liner, and heavy plastic sheeting, within the limit of disturbance approximately 100 feet east of the stream bank. Following construction of this dewatering location, sediment bags were placed within the structure and at approximately 14:00, groundwater was pumped via hoses to the sediment bags before being discharged from the structure to the surrounding vegetation. Work within the trench stopped on August 14 at approximately 19:30. Pumping of water from the trench into the dewatering structure continued overnight, however, and two Welded employees remained on Site to observe the pumping operations.

Additional Welded personnel arrived at the Site on August 15, 2017, and resumed construction at approximately 8:00. At approximately 9:00, the landowner approached the Welded crew and informed them that he had observed impacts at a trout hatchery down slope from the dewatering structure that he believed were a result of activities at the Site. Pumping of water to the dewatering structure was stopped and the water from the dewatering structure was redirected using silt fence over unstabilized soil piles to the original discharge location near the stream bank. After pumping resumed at approximately 10:45, the dewatering structure was improved with additional hay bales to aid with filtration before the water exited the dewatering structure.

At approximately 14:00 on August 15, 2017, a filter bag at the dewatering structure ruptured and water containing sediment was discharged to Bachman Run as a result. Following the filter bag rupture, pumping was stopped and a new filter bag was installed. Pumping resumed after installation of the new filter bag was complete.

The volume of water pumped from the trench continued to increase during construction activities, however, and the discharge location eventually flooded, which resulted in flooding of the work area. To prevent additional flooding of the work area, a corner of the silt fence directing water to the discharge location was removed at approximately 14:15. Following removal of the silt fence, additional water runoff that had flowed from the dewatering structure over unstabilized soil piles was discharged to Bachman Run.

Ron Eberts from the Department arrived at the Site at approximately 15:15 to perform an earth disturbance inspection. During the inspection, Mr. Eberts observed the runoff over the unstabilized soil piles and directed SPLP to undertake corrective actions to address that condition. Under the observation of Mr. Eberts, SPLP subsequently placed additional plastic sheeting over the soil piles and installed additional coconut fiber logs at the discharge point. Mr. Eberts indicated that he was satisfied with the corrective actions up to that point, but after additional discussions, on-site personnel and Mr. Eberts agreed that the dewatering structure should be relocated to its original location near the stream bank. Mr. Eberts left the Site at approximately 17:30, and David Hrobuchak from the Department observed activity at the Site from 17:40 until approximately 19:30. No water was pumped to the dewatering structure overnight.

By approximately 10:00 on August 16, a new 24 ft. x 24 ft. dewatering structure was constructed near the bank of Bachman Run, downstream of the trench. Two 15 ft. x 15 ft. filter bags and logs were placed in the structure. Pumping resumed when construction of the new structure was completed, with trench water directed via hoses to the new dewatering structure.

Vehicular traffic associated with the operations on August 14 and August 15 as described above deteriorated the rock construction entrance to the Site. Welded attempted to scrape the rock construction entrances, but the scraping did not sufficiently repair the entrances. Accordingly, additional rock for the entrances was ordered for delivery to the Site and the entrance was repaired on August 17, 2016.

A diagram of the Site depicting the approximate location of the two dewatering locations and the discharge point to Bachman run is included with this Non-compliance Report at Attachment A.

2. *The period of noncompliance, including exact dates and times, and the anticipated time when the activity will return to compliance.*

Conditions of noncompliance, specifically the discharge of sediment laden water to Bachman Run, occurred at the Site at various times between August 14, 2017, and August 15, 2017, as noted above. In addition, the vehicular traffic associated with the operations on August 14 and August 15 at some point before the condition was observed by Mr. Eberts on August 15. On August 16, 2017, Mr. Karl Krechner of the Lebanon County Conservation District inspected the Site and indicated that all activities were in compliance with SPLP's E&S Permit.

3. *Steps taken, and to be taken, to reduce, eliminate and prevent recurrence of the noncompliance.*

As noted above, the immediate steps taken to reduce, eliminate and prevent recurrence of the discharge of sediment laden water to Bachman Run included relocation of the dewatering structure, placement of additional plastic sheeting over soil piles and installation of additional coconut fiber logs at the discharge point to Bachman Run. SPLP also ordered additional rock for the rock construction entrance and repaired the entrance on August 17, 2017. In addition, SPLP is exploring the feasibility of alternative dewatering locations and coconut fiber logs containing flocculants to further reduce the risk of water containing sediment entering Bachman Run.

4. *The remedies to be used to correct the noncompliance conditions—including any necessary remediation to the impacted reach of Bachman Run, with a schedule for implementation of those remedies.*

The remedies used to stop the discharge of sediment laden water to Bachman Run and repair the rock construction entrance are described above. Current observations of the area immediately downstream of the crossing indicate that the remedies have been effective. In addition, recent rainfall events have resulted in increased flow through Bachman Run, including the areas depicted in the photographic logs included with Mr. Ebert's inspection report. Accordingly, additional remedies along the reach of Bachman Run are not feasible or necessary.

If you have any questions about this Non-compliance Report, please contact me at (610) 670-3237.

Sincerely,

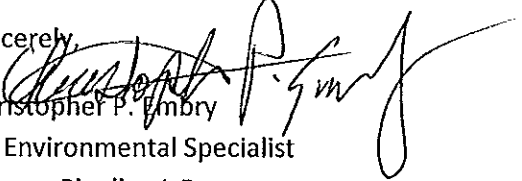
Christopher P. Embry

Sr. Environmental Specialist

Sunoco Pipeline L.P.

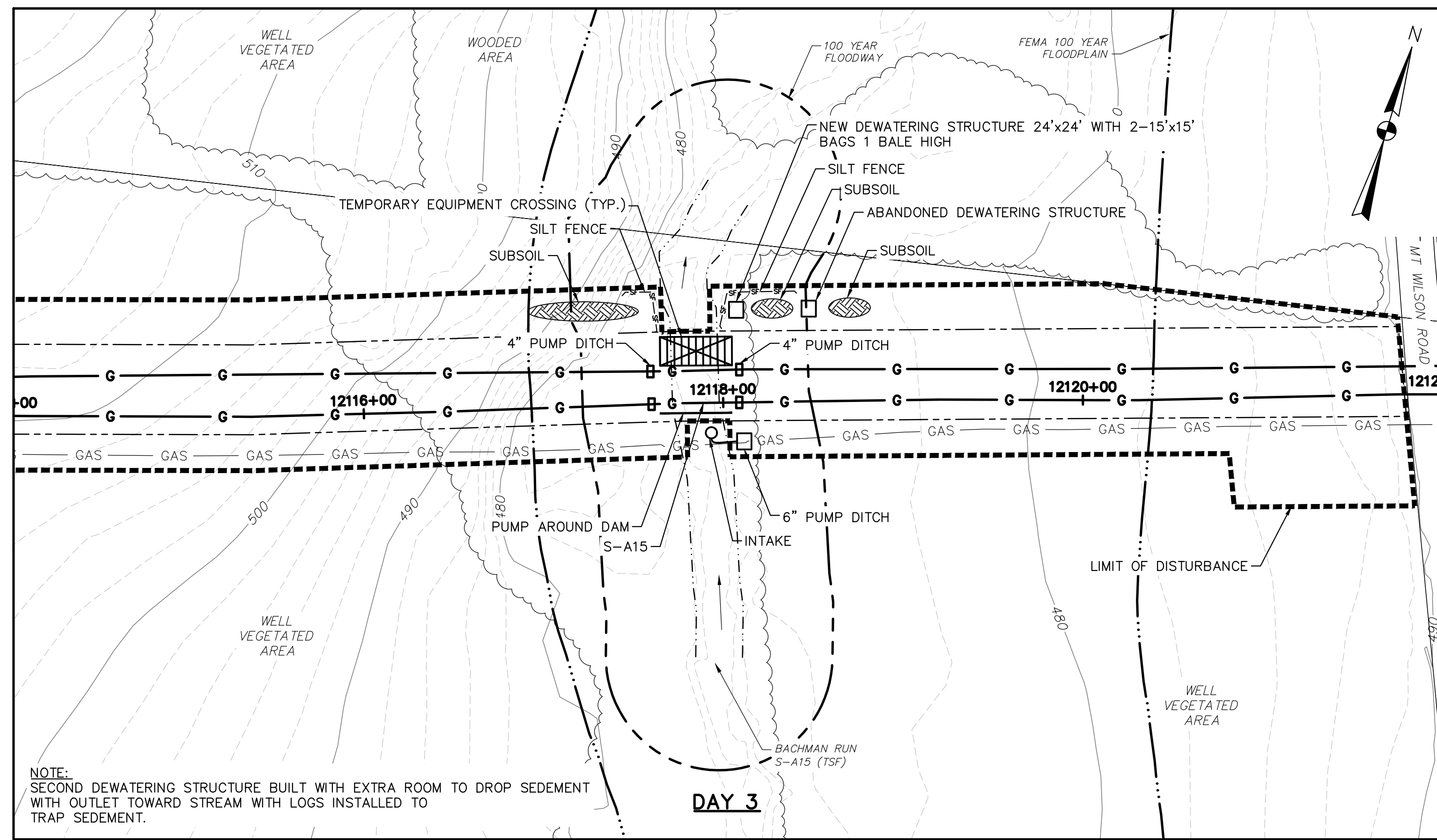
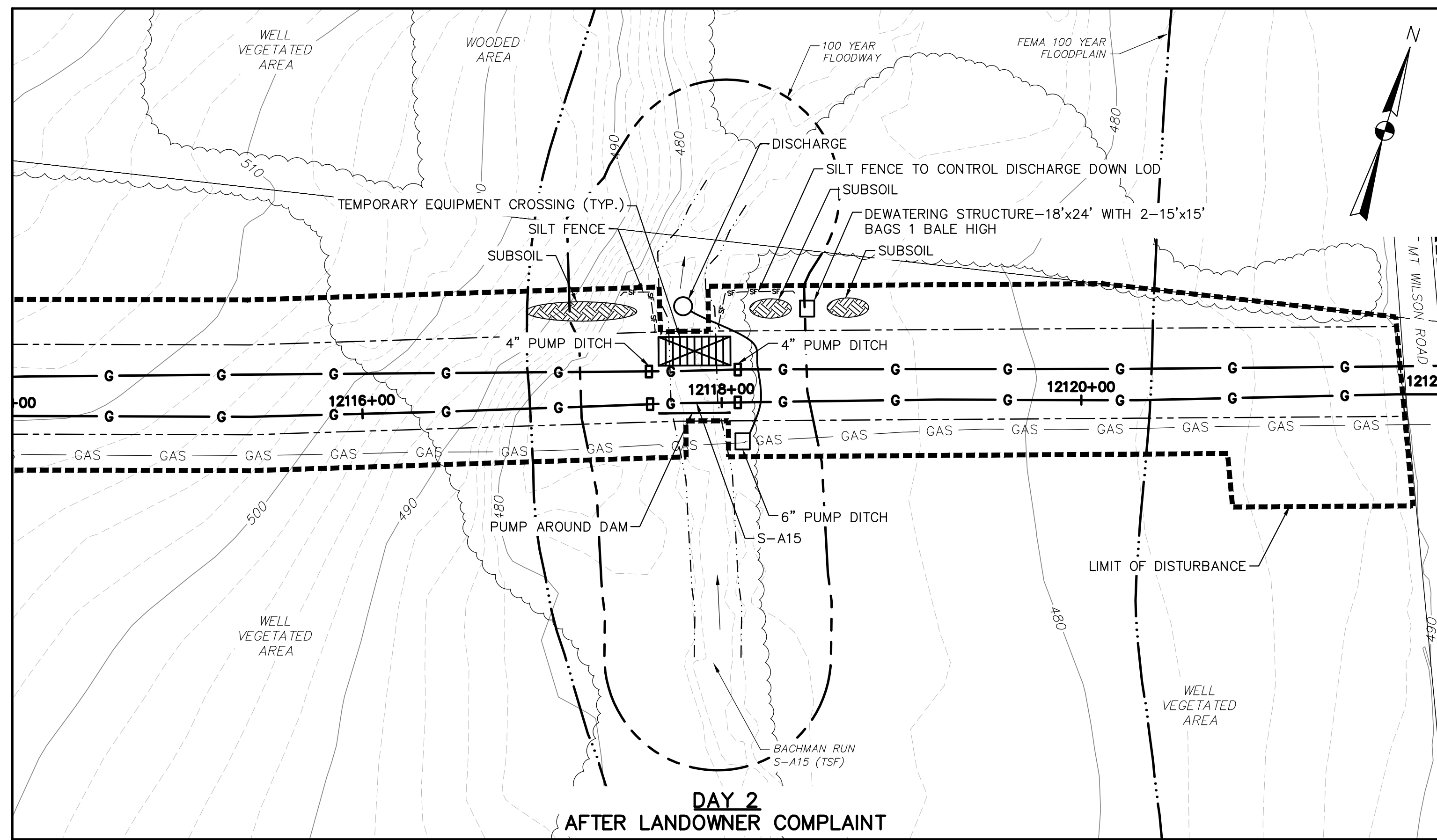
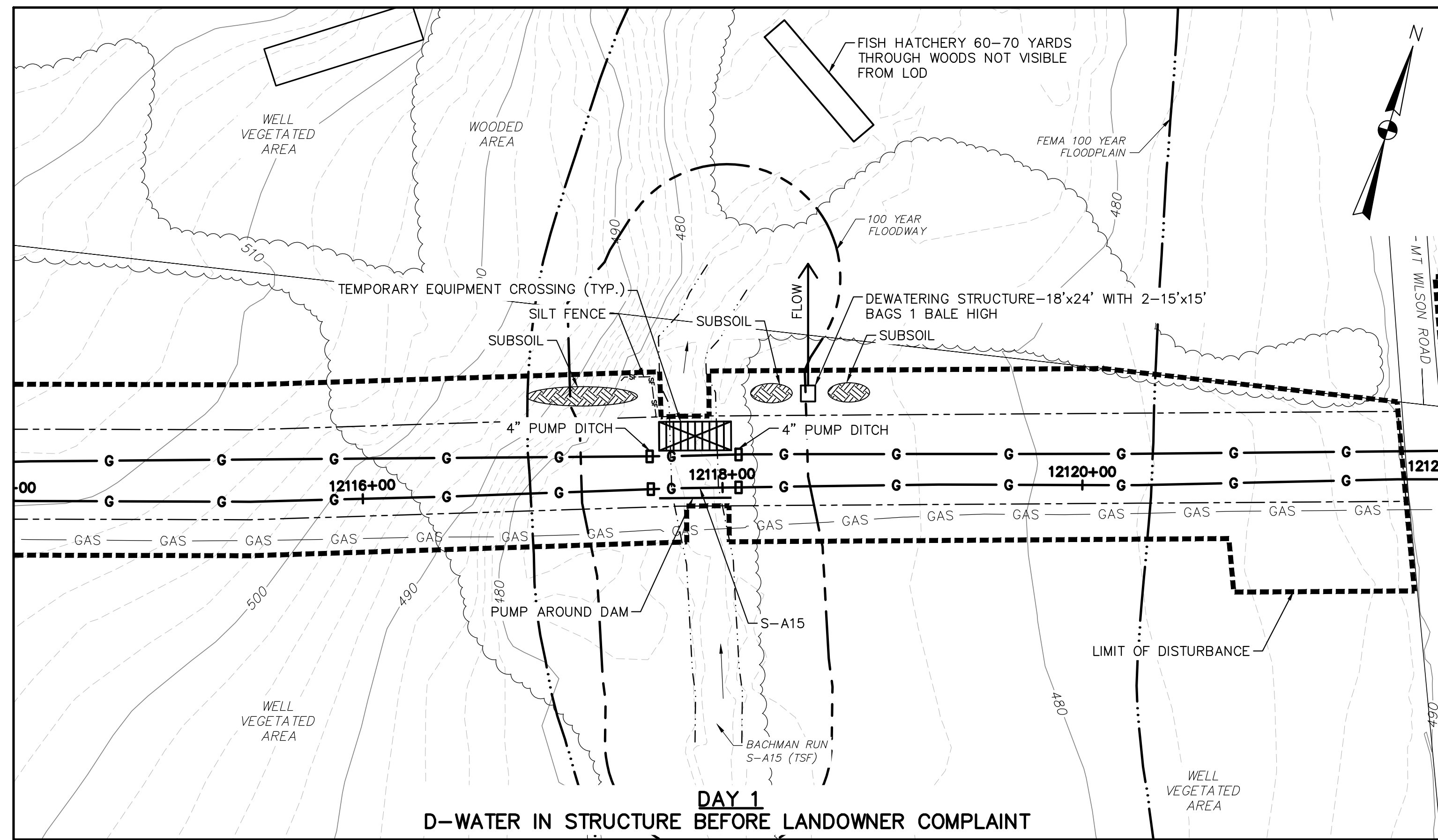
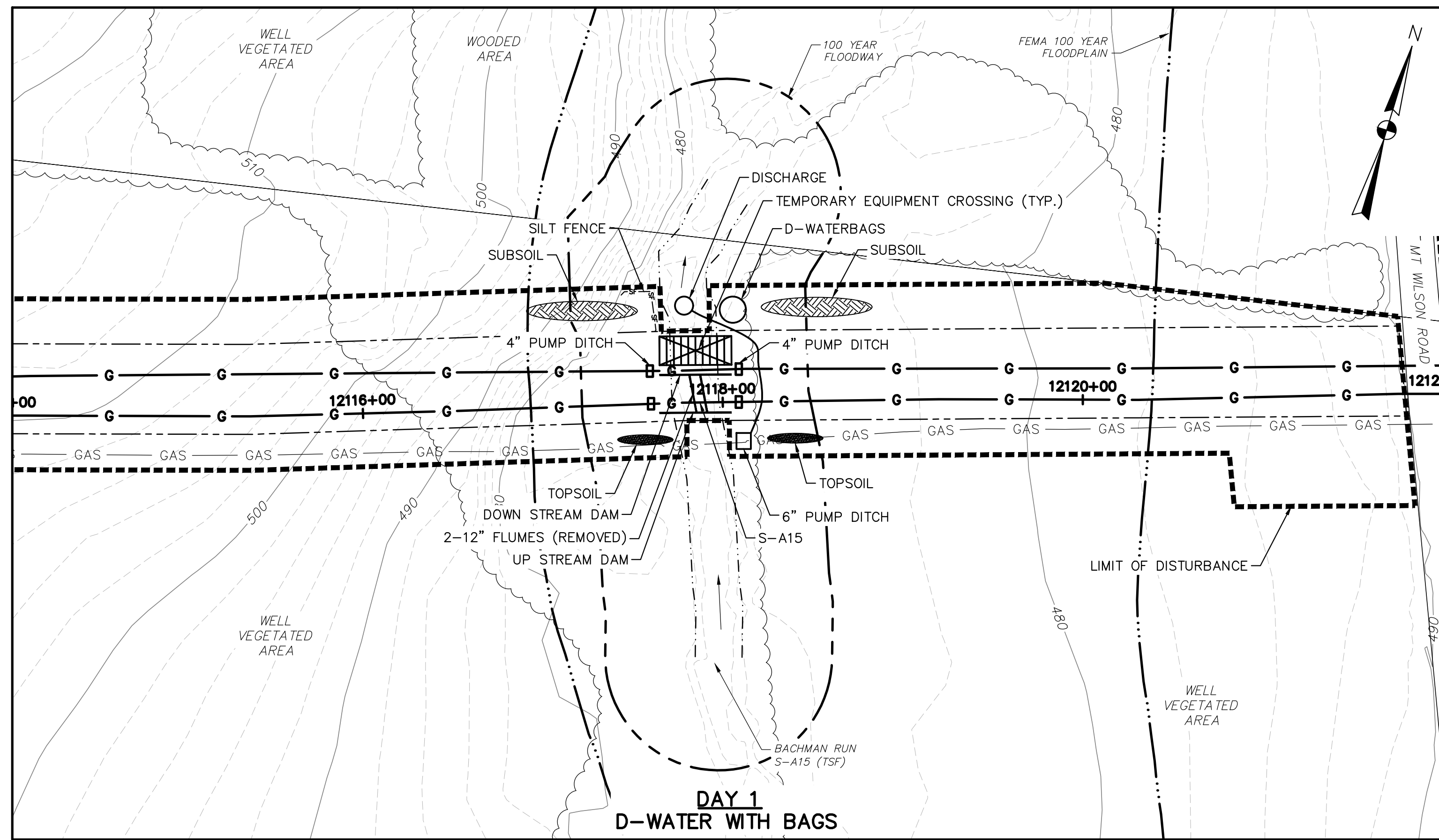

NOT TO SCALE



661 ANDERSEN DRIVE - FOSTER PLAZA 7
DEWATERING STRUCTURESBURGH, PA 15220
T: (412) 921-7090 | F: (412) 921-4040

REVISIONS			
NO.	BY	DATE	REMARKS

SUNOCO PIPELINE L.P.
PHILADELPHIA, PENNSYLVANIA
**PENNSYLVANIA PIPELINE PROJECT
CONSTRUCTION SPREAD 5**

1-20" & 1-16" PROPOSED WELDED STEEL NATURAL GAS LIQUIDS PIPELINES
LEBANON COUNTY CONSERVATION DISTRICT
BAUCHMAN RUN S-A15 DETAIL

DATE:	8/18/17
PROJECT NO.:	112C05958
DESIGNED BY:	CC
DRAWN BY:	NN
CHECKED BY:	CC
COPYRIGHT TETRA TECH INC.	
FIGURE 1	
SHEET 1 OF 1	