

**EAST WHEATFIELD TOWNSHIP, INDIANA COUNTY, PA**

**STREAM - 091**

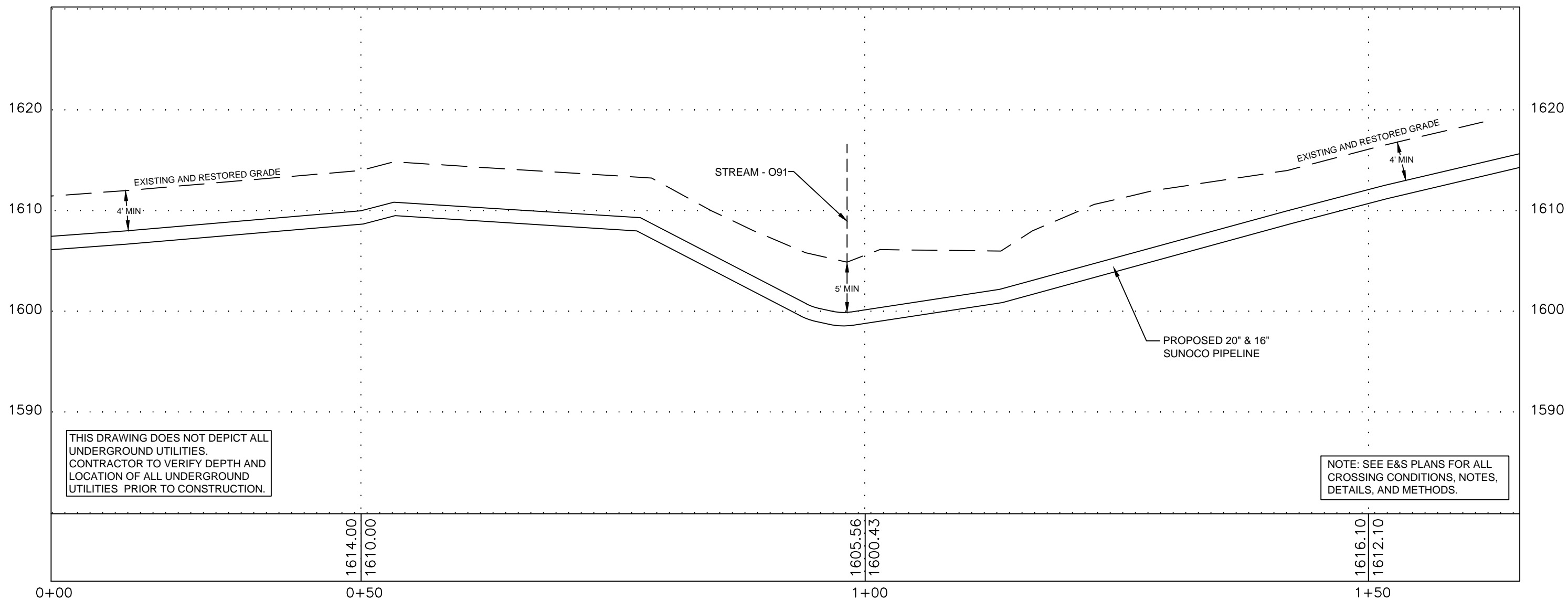

THIS DRAWING DOES NOT DEPICT ALL UNDERGROUND UTILITIES. CONTRACTOR TO VERIFY DEPTH AND LOCATION OF ALL UNDERGROUND UTILITIES PRIOR TO CONSTRUCTION.

NOTE: SEE E&S PLANS FOR ALL CROSSING CONDITIONS, NOTES, DETAILS, AND METHODS.

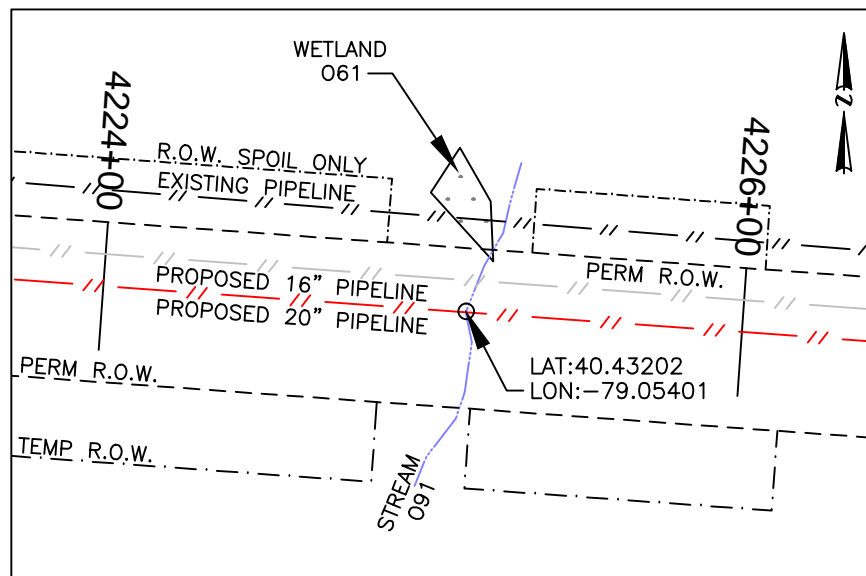

**PLAN LEGEND**

- PERMANENT R.O.W.
- TEMPORARY WORKSPACE
- ATWS
- R.O.W. SPOIL ONLY
- PROPERTY LINE

**PLAN**

HORIZ. SCALE : 1" = 60'

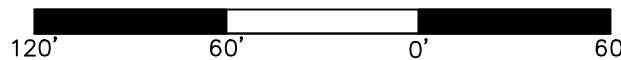

**PROFILE LEGEND**

- PROPOSED PIPELINE
- EXISTING AND RESTORED GRADE
- EXISTING GRADE ELEV.
- PROPOSED TOP OF PIPE ELEV.

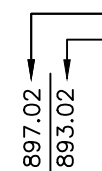

**PROFILE**

HORIZ. SCALE : 1" = 10'  
VERT. SCALE : 1" = 10'

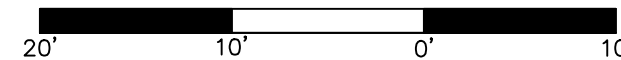

**COORDINATE SYSTEM**

PENNSYLVANIA STATE PLANE SOUTH NAD 83 US FEET

GRADE SOURCE: SURVEYING DATA

**24/7 CONTACT INFO & PIPE MARKER INFO:**

**SUNOCO PIPELINE L.P.**  
525 FRITZTOWN ROAD  
SINKING SPRING, PA 19608  
PHONE NUMBER: 800-786-7440  
NATURAL GAS PIPELINE

CENTERLINE REV DATE: 11-11-2016

**SUNOCO**  
**STREAM - 091**

EAST WHEATFIELD TOWNSHIP, INDIANA COUNTY, PA

11/08/16 SCALE  
REVISED 11/22/16 AS NOTED DWG: PA-IN-0070.0000-S-091

Prepared by  TRICO SURVEYING AND MAPPING  
BLOOMINGTON, INDIANA  
WWW.TRICOSURVEYING.COM