

SHIRLEY TOWNSHIP, HUNTINGDON COUNTY, PA
STREAM - L31

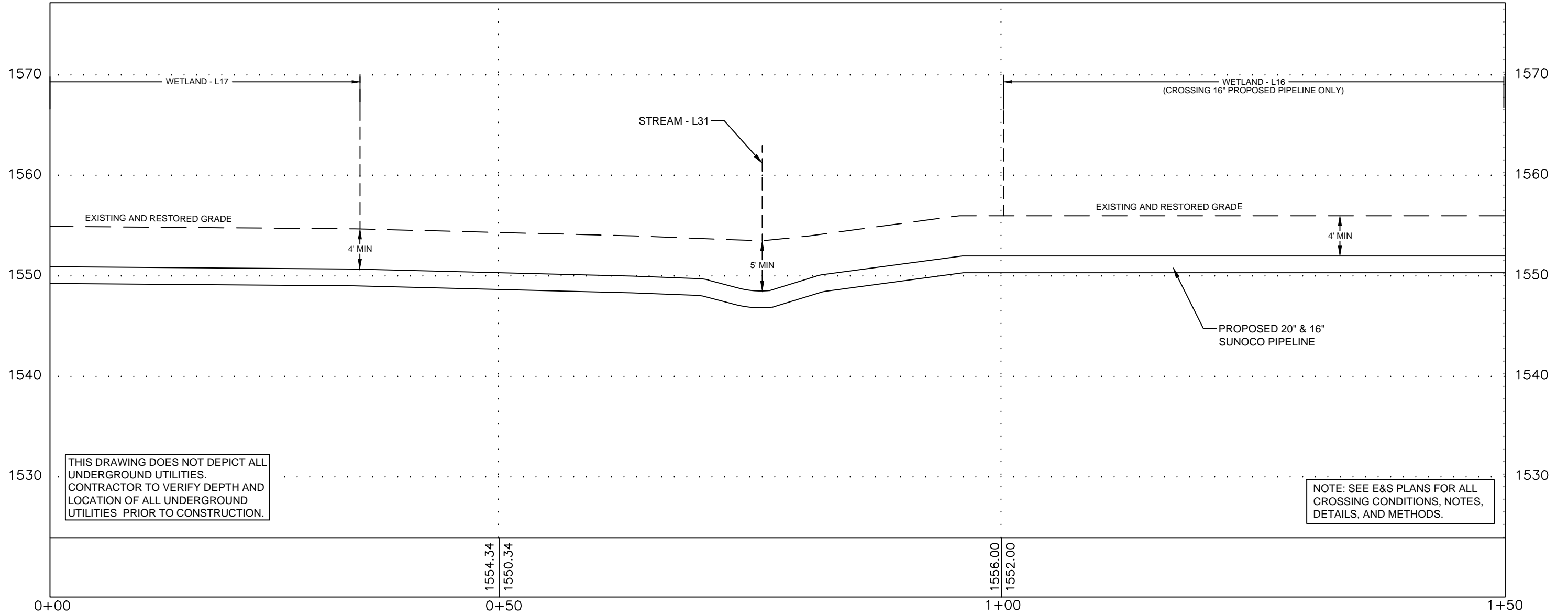

THIS DRAWING DOES NOT DEPICT ALL UNDERGROUND UTILITIES. CONTRACTOR TO VERIFY DEPTH AND LOCATION OF ALL UNDERGROUND UTILITIES PRIOR TO CONSTRUCTION.

NOTE: SEE E&S PLANS FOR ALL CROSSING CONDITIONS, NOTES, DETAILS, AND METHODS.

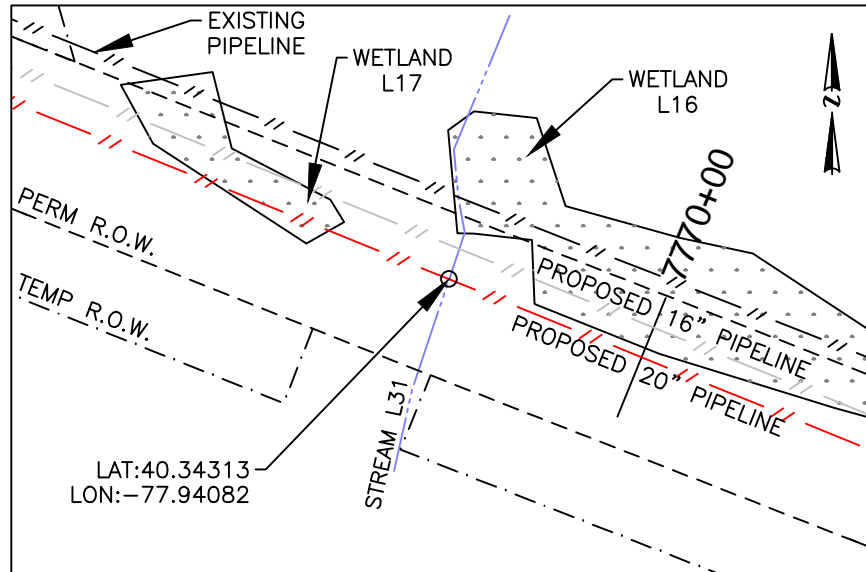

PLAN LEGEND

- PERMANENT R.O.W.
- TEMPORARY WORKSPACE
- ATWS
- R.O.W. SPOIL ONLY
- PROPERTY LINE

PLAN

HORIZ. SCALE : 1" = 60'

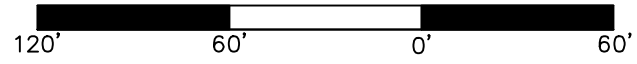

PROFILE LEGEND

- PROPOSED PIPELINE
- EXISTING AND RESTORED GRADE
- EXISTING GRADE ELEV.
- PROPOSED TOP OF PIPE ELEV.

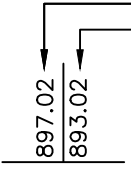

COORDINATE SYSTEM
 PENNSYLVANIA STATE PLANE SOUTH
 NAD 83 US FEET

GRADE SOURCE: SURVEYING DATA AND PASDA CONTOURS

24/7 CONTACT INFO & PIPE MARKER INFO:

SUNOCO PIPELINE L.P.
 525 FRITZTOWN ROAD
 SINKING SPRING, PA 19608
 PHONE NUMBER: 800-786-7440
 NATURAL GAS PIPELINE

CENTERLINE REV DATE: 11-11-2016

PROFILE

HORIZ. SCALE : 1" = 10'
 VERT. SCALE : 1" = 10'

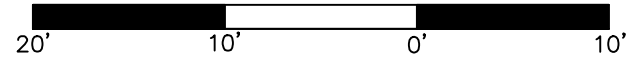

SUNOCO
STREAM - L31

SHIRLEY TOWNSHIP, HUNTINGDON COUNTY, PA

11/15/16 SCALE
 REVISED 11/28/16 AS NOTED DWG: PA-HU-0058.0000-S-L31

Prepared by TRICO SURVEYING AND MAPPING
 BLOOMINGTON, INDIANA
 WWW.TRICOSURVEYING.COM