

LOWER MIFFLIN TOWNSHIP, CUMBERLAND COUNTY, PA

STREAM - K16

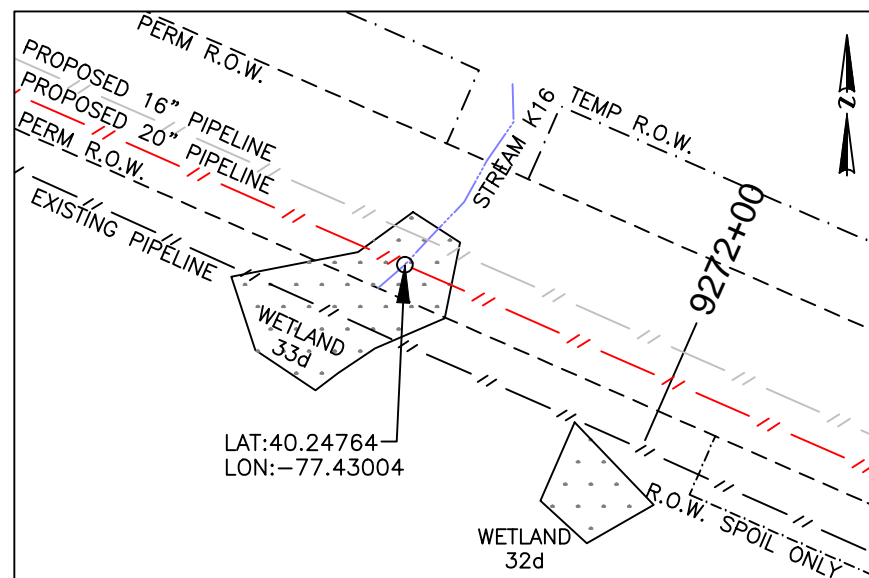
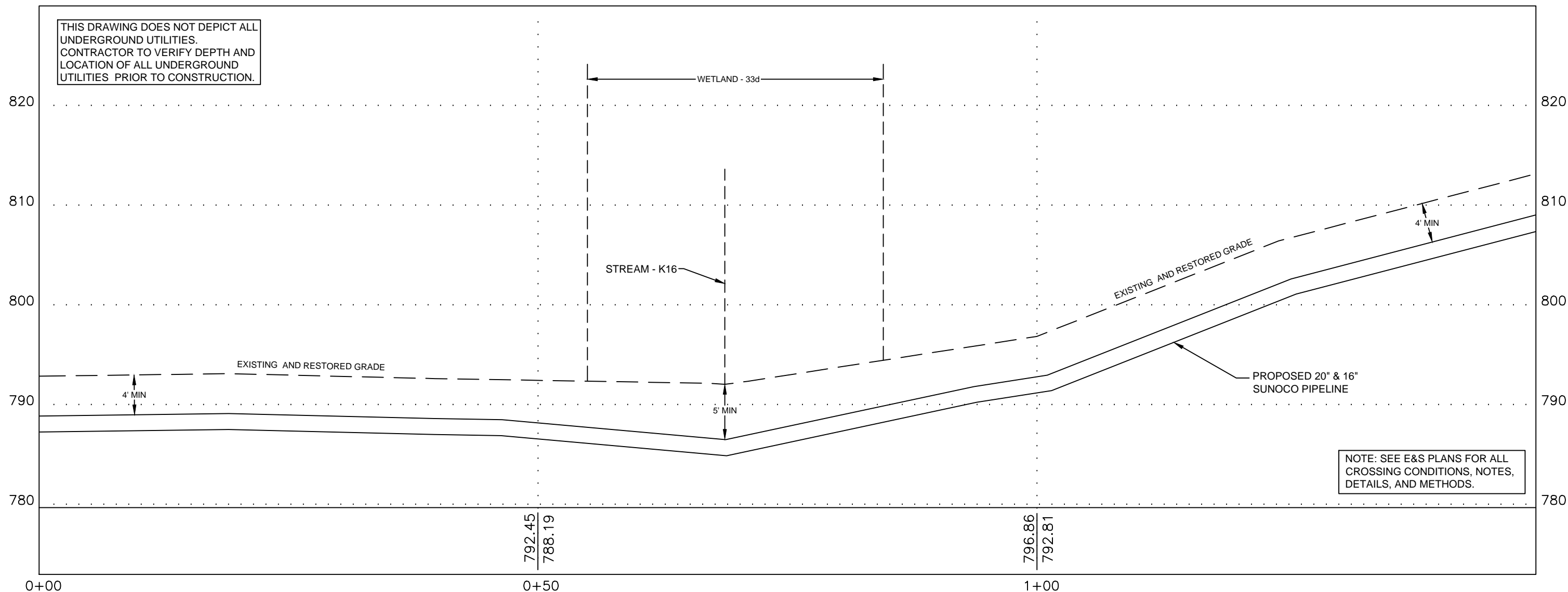

PLAN LEGEND

- PERMANENT R.O.W.
- TEMPORARY WORKSPACE
- ATWS
- R.O.W. SPOIL ONLY
- PROPERTY LINE

PLAN

HORIZ. SCALE : 1" = 60'

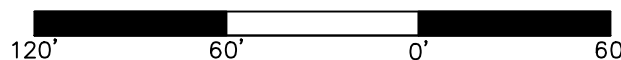

PROFILE LEGEND

- PROPOSED PIPELINE
- EXISTING AND RESTORED GRADE
- EXISTING GRADE ELEV.
- PROPOSED TOP OF PIPE ELEV.

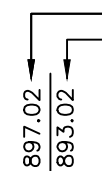

COORDINATE SYSTEM

PENNSYLVANIA STATE PLANE SOUTH  
NAD 83 US FEET

GRADE SOURCE:  
SURVEYING DATA

24/7 CONTACT INFO & PIPE MARKER INFO:

**SUNOCO PIPELINE L.P.**  
525 FRITZTOWN ROAD  
SINKING SPRING, PA 19608  
PHONE NUMBER: 800-786-7440  
NATURAL GAS PIPELINE

CENTERLINE REV DATE: 11-11-2016

PROFILE

HORIZ. SCALE : 1" = 10'  
VERT. SCALE : 1" = 10'

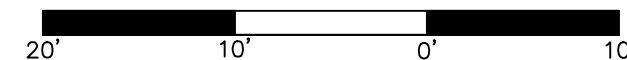

SUNOCO  
STREAM - K16

LOWER MIFFLIN TOWNSHIP, CUMBERLAND COUNTY, PA

11/08/16	SCALE	
REVISED 11/29/16	AS NOTED	DWG: PA-CU-0020.0000-S-K16

Prepared by TRICO SURVEYING AND MAPPING  
BLOOMINGTON, INDIANA  
WWW.TRICOSURVEYING.COM