

ROBESON TOWNSHIP, BERKS COUNTY, PENNSYLVANIA

PLAN VIEW SCALE : 1" = 60'

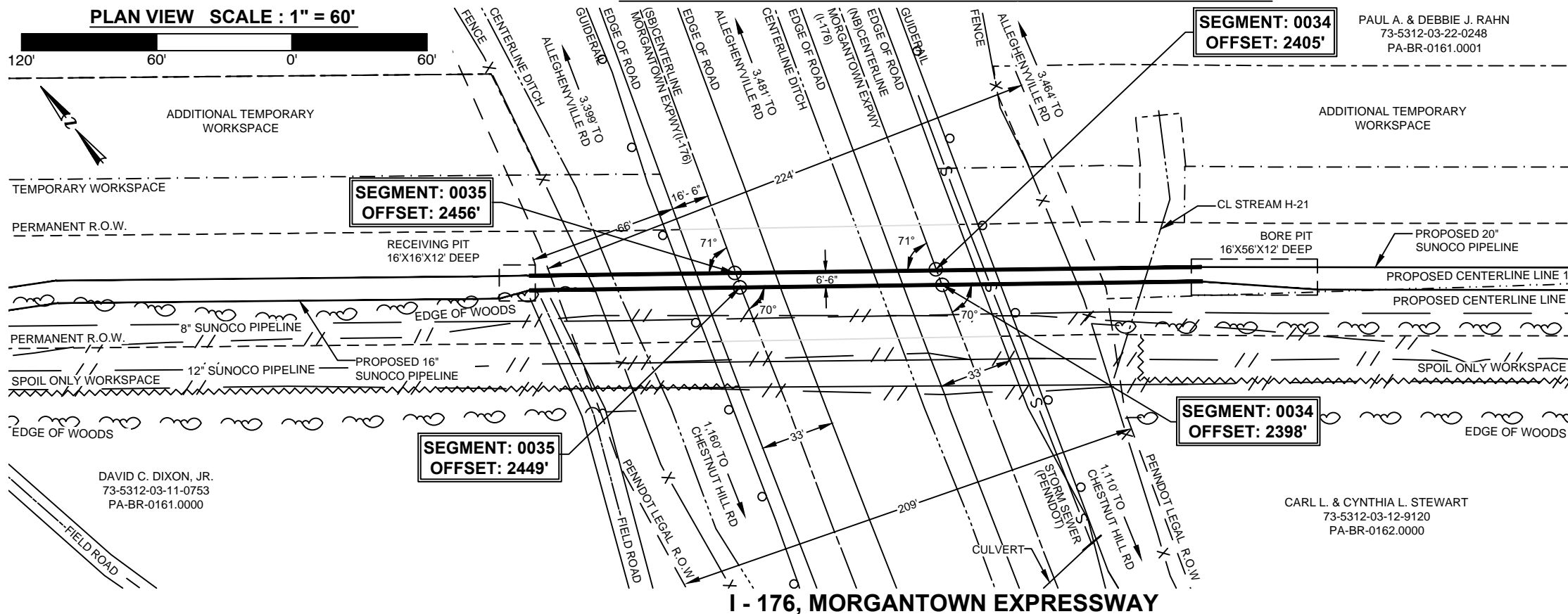

PAUL A. & DEBBIE J. RAHN
73-5312-03-22-0248
PA-BR-0161.0001

DAVID C. DIXON, JR.
73-5312-03-11-0753
PA-BR-0161.0000

CARL L. & CYNTHIA L. STEWART
73-5312-03-12-9120
PA-BR-0162.0000

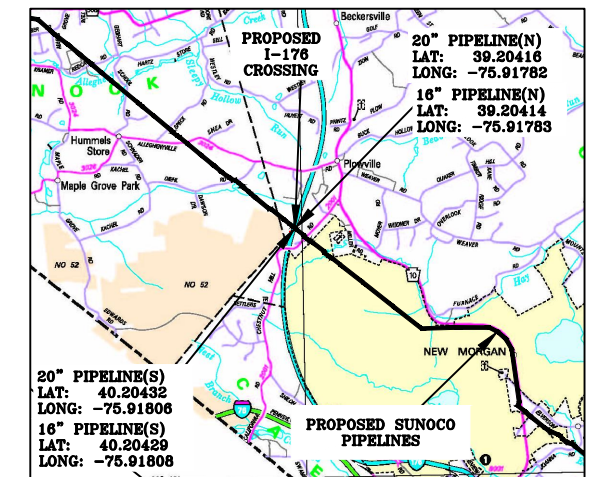

AERIAL VIEW SCALE : 1" = 2MI

DRAWING LEGEND

- - - - - PERMANENT R.O.W.
- - - - - TEMPORARY WORKSPACE
- - - - - CENTERLINE WATERWAY
- - - - - GUIDERAIL
- ~ ~ ~ ~ ~ EDGE OF WOODS
- - - - - PROPERTY LINE
- X X X X X FENCE
- - - - - ADDITIONAL TEMPORARY WORKSPACE
- - - - - STORM SEWER
- - - - - EXISTING PIPELINE
- - - - - ROAD R.O.W.
- ~ ~ ~ ~ ~ ROW - SPOIL ONLY

I - 176, MORGANTOWN EXPRESSWAY

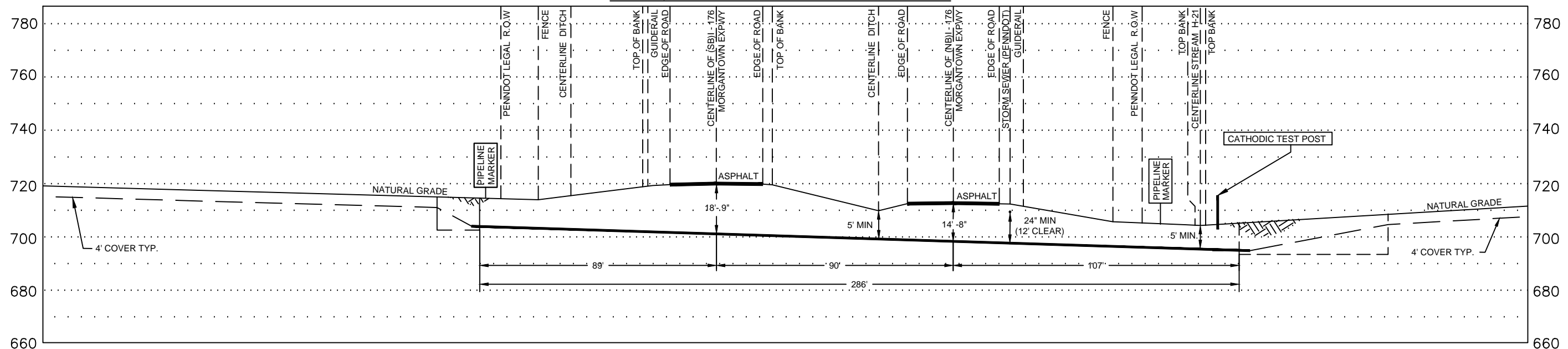

PROFILE

HORIZ. SCALE : 1" = 40'
VERT. SCALE : 1" = 40'

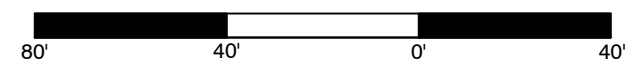

CONSTRUCTION NOTES
(APPLIES TO BOTH 16" & 20" PIPELINES)

1. 20" WELDED STEEL PIPE 20" OD x .456 WT., X-65, API 5L, PSL2, ERW, BFW, DRL
2. 16" WELDED STEEL PIPE 16" OD x .438 WT., X-70, API 5L, PSL2, ERW, BFW
3. COATING: 14-16 MILS OF 3M SCOTCHKOTE TM 6233 FBE WITH 40 MILS MIN. DFT POWERCRETE R95
4. DESIGN FACTOR: 0.50 (HOOP STRESS)
5. DESIGN PSI: 1480 PSIG TEST PSI: 1850 PSIG
6. THE COATING ON THE CARRIER PIPE SHALL BE INSPECTED IMMEDIATELY PRIOR TO ITS INSTALLATION AND ALL DAMAGED COATING SHALL BE REPAIRED IN ACCORDANCE WITH SUNOCO PIPELINE SPECIFICATIONS
7. INSTALL CATHODIC PROTECTION TEST LEADS AS SPECIFIED ON THE ALIGNMENT SHEETS OR SUNOCO CORROSION TECHNICIAN
8. WELDED JOINTS INSIDE R.O.W. SHALL BE 100% X-RAYED
9. CONTRACTOR WILL MAINTAIN A MINIMUM 4' OF COVER TO THE TOP OF PIPE USING FIELD BENDS
10. CONTRACTOR WILL MAINTAIN A MINIMUM 24" OF COVER FROM ALL EXISTING UTILITIES.
11. IN ADDITION TO THE SITE SPECIFIC INFORMATION PROVIDED IN THIS DRAWING, GENERAL REQUIREMENTS INCLUDED IN ALIGNMENT SHEETS, PERMITS AND APPROVAL FROM FEDERAL, STATE, AND LOCAL AGENCIES ALSO APPLY.
12. CONTRACTOR SHALL USE THE "ONE CALL" SYSTEM PRIOR TO BEGINNING WORK. CONTRACTOR SHALL BE RESPONSIBLE TO LOCATE AND VERIFY ALL PARALLEL AND CROSSED UTILITIES PRIOR TO EXCAVATION OR CONSTRUCTION (AND MONITOR DURING EXCAVATION OR CONSTRUCTION). THIS DRAWING SHALL NOT CONSTITUTE VERIFICATION OF LOCATION, QUANTITY, SIZE, DEPTH, OR TYPES OF EXISTING UTILITIES.
13. EMERGENCY CONTACT INFORMATION: SEE INCLUDED COMPANY INFORMATION
14. SUNOCO PIPELINE, L.P. WILL BE AVAILABLE 24/7 FOR EMERGENCY AT 800-786-7440 IF SUCH A PROBLEM SHOULD ARISE.

COORDINATE SYSTEM

PENNSYLVANIA STATE PLANE SOUTH
NAD 83 US FEET

R.O.W. INGRESS
X = 2480102.46
Y = 322635.33

R.O.W. EGRESS
X = 2480274.50
Y = 322501.69

24/7 CONTACT INFO & PIPE MARKER INFO:

SUNOCO PIPELINE L.P.
JAMES FRANCISCUS
525 FRITZTOWN ROAD
SINKING SPRING, PA 19608
EFRANCISCUS@SUNOCOLOGISTICS.COM
PHONE NUMBER: 800-786-7440
NATURAL GAS PIPELINE

CENTERLINE REV DATE: 11-10-2016

SUNOCO

I-176, MORGANTOWN EXPRESSWAY

ROBESON TOWNSHIP, BERKS COUNTY, PA

11/16/16	SCALE	EPS APP# 100949
REVISED	AS NOTED	DWG #: PPP-PA-BR-0161.0000-RD

Prepared by TRICO SURVEYING AND MAPPING
BLOOMINGTON, INDIANA
WWW.TRICOSURVEYING.COM