

PLAN VIEW
PROFILE VIEW

ALLEGHENY COUNTY, PENNSYLVANIA - FORWARD/ELIZABETH TOWNSHIPS
S1B-0160

GEOTECH HDD-11

- NG EL. 1176'
- CL (0.0' - 6.5')
- CL/SC (6.5' - 9.0')
- SILT STONE (9.0' - 9.5')

COMPLETION
DEPTH EL. 1167'

NOTE: REFER TO TEST BORING LOG HDD-11 FOR COMPLETE SOIL MATERIAL DESCRIPTION

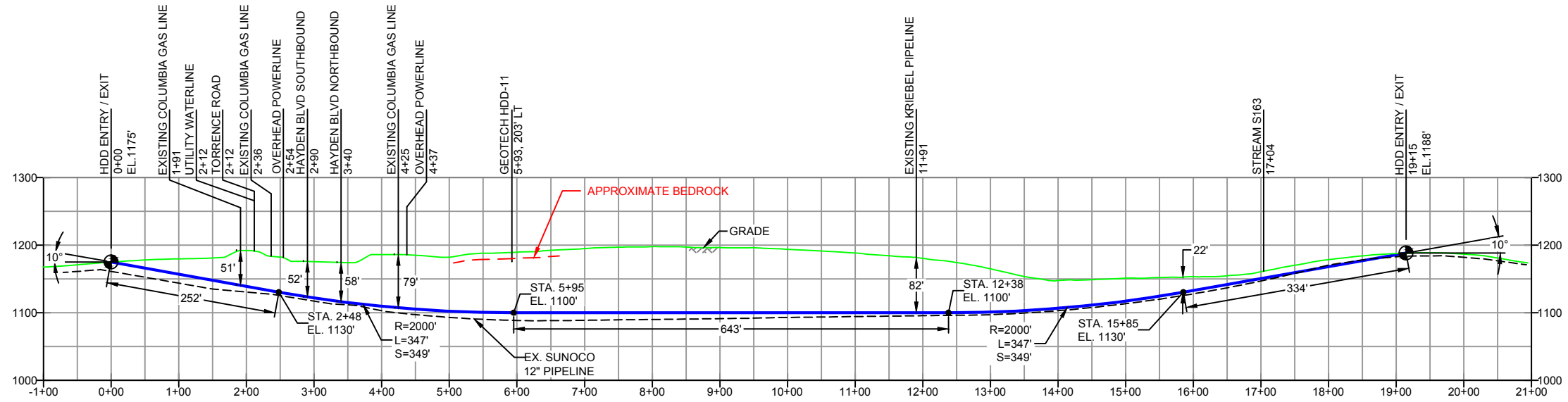

- DESIGN AND CONSTRUCTION:**
- CONTRACTOR SHALL FIELD VERIFY DEPTH OF ALL EXISTING UTILITIES SHOWN OR NOT SHOWN ON THIS DRAWING.
 - THE MINIMUM SEPARATION DISTANCE FROM EXISTING SUBSURFACE UTILITIES SHALL NOT BE LESS THAN 10 FEET AS MEASURED FROM THE OUTSIDE EDGE OF THE UTILITY TO OUTSIDE OF PROPOSED PIPELINE.
 - DESIGNED IN ACCORDANCE WITH CFR 49 195 & ASME B31.4
 - CROSSING PIPE SPECIFICATION:
HDD HORZ LENGTH (L)=1915'
HDD PIPE LENGTH (S)=1927'
20" x 0.456" W.T., X-65, API-5L, PSL2, ERW, BFW, DRL
COATING: 14-16 MILS OF 3M SCOTCHKOTE TM 6233 FBE WITH 40 MILS MIN. DFT POWERCRETE R95
 - SEAM FACTOR 1.0, DESIGN FACTOR 0.50 (HOOP STRESS).
 - DESIGN PRESSURE: 1480 PSIG, TEST PRESSURE: 1850 PSIG
 - INSTALLATION METHOD: HORIZONTAL DIRECTIONAL DRILL (HDD).
 - PIPELINE WARNING MARKERS SHALL BE INSTALLED ON BOTH SIDES OF ALL ROAD, RAILWAY, AND STREAM CROSSINGS.
 - CARRIER PIPE NOT ENCASED.
 - PIPE / AMBIENT TEMPERATURE MUST BE NO LESS THAN 30°F DURING PULLBACK WITHOUT PRIOR WRITTEN APPROVAL FROM THE ENGINEER.
 - CONDUCT 4-HOUR PRE-INSTALLATION HYDROTEST OF HDD PIPE STRING TO MINIMUM 1850 PSIG.

- NOTES**
- ALL COORDINATES SHOWN ARE IN LATITUDE AND LONGITUDE. ALL MSL ELEVATIONS ARE NAD83
 - STATIONING IS BASED ON HORIZONTAL DISTANCES.
 - ROONEY ENGINEERING, INC. AND SUNOCO PIPELINE, LP ARE NOT RESPONSIBLE FOR LOCATION OF FOREIGN UTILITIES SHOWN IN PLOT PLAN OR PROFILE. THE INFORMATION SHOWN HEREON IS FURNISHED WITHOUT LIABILITY ON THE PART OF ROONEY ENGINEERING, INC. AND SUNOCO PIPELINE, LP, FOR ANY DAMAGES RESULTING FROM ERRORS OR OMISSIONS THEREIN.
 - CONTRACTOR IS RESPONSIBLE FOR LOCATING ALL UTILITIES. CONTACT ONE CALL AT 811 PRIOR TO DIGGING.
 - SUNOCO EMERGENCY HOTLINE NUMBER IS #1-800-786-7440.

REVISIONS		BY	DATE	CHK	DATE	APP	DATE
3	REVISED PER ENGINEERING COMMENTS	MRS	08/19/16	RMB	08/19/16	AAW	08/19/16
2	ADDED CLEARING ROW ONLY NOTE	MRS	03/22/16	RMB	03/22/16	AAW	03/22/16
1	REVISED PER COMMENTS FROM REI REVIEW 12-18-15	MRS	12/18/15	RMB	12/18/15	AAW	12/18/15
0	ISSUED FOR CONSTRUCTION	RTT	11/30/15	RMB	11/30/15	AAW	11/30/15
NO.	DESCRIPTION						

Sunoco Logistics Partners L.P.

TETRA TECH ROONEY
(303) 792-5911

SUNOCO PIPELINE, L.P.

HORIZONTAL DIRECTIONAL DRILL
HAYDEN BOULEVARD
PENNSYLVANIA PIPELINE PROJECT

SCALE: 1"=200' DWG. NUMBER: PA-AL-0033.0000-RD