

- NOTES:**
- SEE ES-0.01 & ES-0.02 FOR GENERAL NOTES & LEGEND.
 - SEE ES-0.03 FOR STREAM & WETLAND CROSSING TABLES.
 - EROSION & SEDIMENT CONTROL BMP INSTALLATION TO BE ADJUSTED AS NEEDED TO ACCOMMODATE ACTUAL CONTOURS IDENTIFIED IN FIELD DURING VARIOUS PHASES OF THE PROJECT.
 - STRAY LIGHT WILL BE MINIMIZED DURING NON-DAYLIGHT OPERATIONS BY USING DIRECTIONAL LIGHTING ANGLED AWAY FROM HOMES AND TRAFFIC TO THE EXTENT PRACTICABLE. SOUND BARRIERS AND/OR SOUND CURTAINS WILL BE PROVIDED DURING DRILLING.
 - UNT TO RIDLEY CREEK IS LOCATED TO THE NORTH AND UNT TO CHESTER CREEK IS LOCATED TO THE SOUTH OF THE MAJOR AMENDMENT PROJECT AREA
 - INSTALLATION OF THE PCSM BMPS WERE CONSTRUCTED IN ACCORDANCE WITH THE CONSTRUCTION SEQUENCE PROVIDED ON SHEET PCS-0.03 OF THE THORNBURY TOWNSHIP POST CONSTRUCTION STORMWATER MANAGEMENT PLAN, JUNE 2017.

TETRA TECH
 www.tetrattech.com
 661 ANDERSEN DRIVE - FOSTER PLAZA 7
 PITTSBURGH, PA 15220
 T: (412) 921-7090 | F: (412) 921-4040

REVISIONS			
NO.	BY	DATE	REMARKS
1	RS	3/28/17	INCORPORATED THE SPECIAL CONDITIONS SET FORTH IN DEP'S CHAPTER 102 AND CHAPTER 105 PERMITS
2	RS	5/25/17	DRAWINGS PROVIDED TO FIELD
3	BS	6/15/17	REVISIONS TO ADDRESS TOWNSHIP COMMENTS
4	BS	4/12/21	UPDATED E&S WITH PCSM BMP CONTROLS & GRADING
5	BS	10/15/21	REVISED PER COMMENTS FROM DCCD

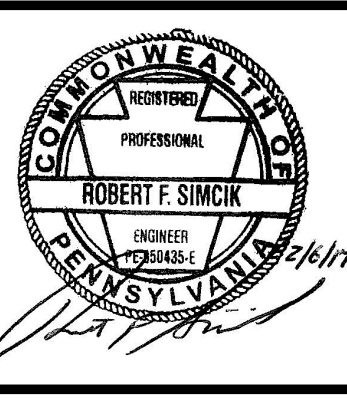

SUNOCO PIPELINE LP
 SINKING SPRING, PENNSYLVANIA
**PENNSYLVANIA PIPELINE PROJECT
 CONSTRUCTION SPREAD 6**

1-20" & 1-16" WELDED STEEL NATURAL GAS PIPELINES
 DELAWARE COUNTY CONSERVATION DISTRICT
**EROSION & SEDIMENT CONTROL &
 SITE RESTORATION PLAN
 SHEET 1 OF 35**

DATE:	2/6/17
PROJECT NO.:	112C05958
DESIGNED BY:	JB
DRAWN BY:	BH
CHECKED BY:	RS
COPYRIGHT TETRA TECH INC.	
ES-6.01	
SHEET 6.01 OF 60	

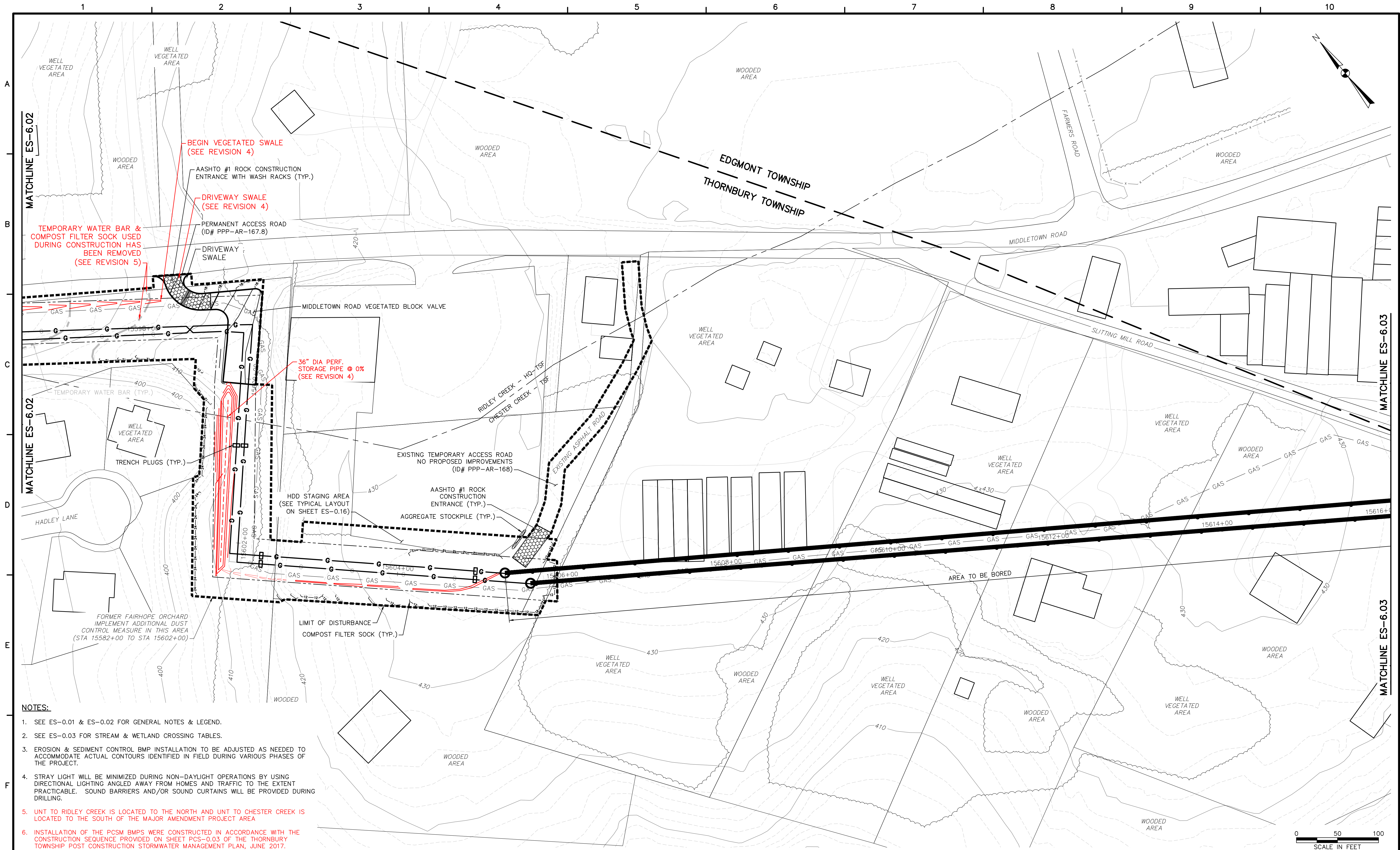

- NOTES:**
- SEE ES-0.01 & ES-0.02 FOR GENERAL NOTES & LEGEND.
 - SEE ES-0.03 FOR STREAM & WETLAND CROSSING TABLES.
 - EROSION & SEDIMENT CONTROL BMP INSTALLATION TO BE ADJUSTED AS NEEDED TO ACCOMMODATE ACTUAL CONTOURS IDENTIFIED IN FIELD DURING VARIOUS PHASES OF THE PROJECT.
 - STRAY LIGHT WILL BE MINIMIZED DURING NON-DAYLIGHT OPERATIONS BY USING DIRECTIONAL LIGHTING ANGLED AWAY FROM HOMES AND TRAFFIC TO THE EXTENT PRACTICABLE. SOUND BARRIERS AND/OR SOUND CURTAINS WILL BE PROVIDED DURING DRILLING.
 - UNT TO RIDLEY CREEK IS LOCATED TO THE NORTH AND UNT TO CHESTER CREEK IS LOCATED TO THE SOUTH OF THE MAJOR AMENDMENT PROJECT AREA
 - INSTALLATION OF THE PCSM BMPs WERE CONSTRUCTED IN ACCORDANCE WITH THE CONSTRUCTION SEQUENCE PROVIDED ON SHEET PCS-0.03 OF THE THORNBURY TOWNSHIP POST CONSTRUCTION STORMWATER MANAGEMENT PLAN, JUNE 2017.

TETRA TECH
www.tetrattech.com
661 ANDERSEN DRIVE - FOSTER PLAZA 7
PITTSBURGH, PA 15220
T: (412) 921-7090 | F: (412) 921-4040

REVISIONS			
NO.	BY	DATE	REMARKS
1	RS	3/28/17	INCORPORATED THE SPECIAL CONDITIONS SET FORTH IN DEP'S CHAPTER 102 AND CHAPTER 105 PERMITS
2	RS	5/25/17	DRAWINGS PROVIDED TO FIELD
3	BS	6/15/17	REVISIONS TO ADDRESS TOWNSHIP COMMENTS
4	RS	4/12/21	UPDATED E&S WITH PCSM BMP CONTROLS & GRADING
5	BS	10/15/21	REVISED PER COMMENTS FROM DCCD

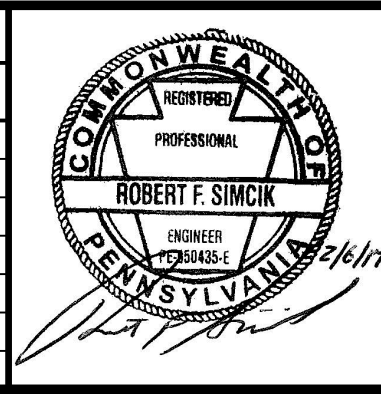

SUNOCO PIPELINE LP
SINKING SPRING, PENNSYLVANIA
**PENNSYLVANIA PIPELINE PROJECT
CONSTRUCTION SPREAD 6**

1-20" & 1-16" WELDED STEEL NATURAL GAS PIPELINES
DELAWARE COUNTY CONSERVATION DISTRICT
EROSION & SEDIMENT CONTROL &
SITE RESTORATION PLAN
SHEET 2 OF 35

DATE:	2/6/17
PROJECT NO.:	112C05958
DESIGNED BY:	JB
DRAWN BY:	BH
CHECKED BY:	RS
COPYRIGHT TETRA TECH INC.	
ES-6.02	
SHEET 6.02 OF 60	