

*Atlantic Sunrise Project – PA DEP Chapter 105 Joint Permit Application
Transcontinental Gas Pipe Line Company, LLC
Susquehanna County*

ATTACHMENT I -3
SUSQUEHANNA COUNTY PROJECT LOCATION MAP

Revised November 18, 2016

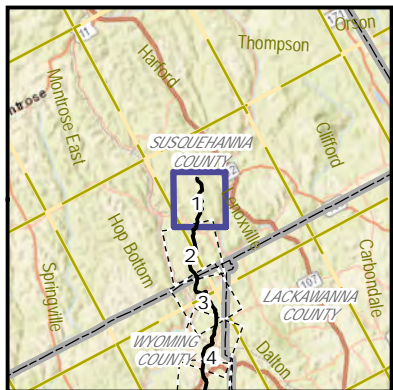
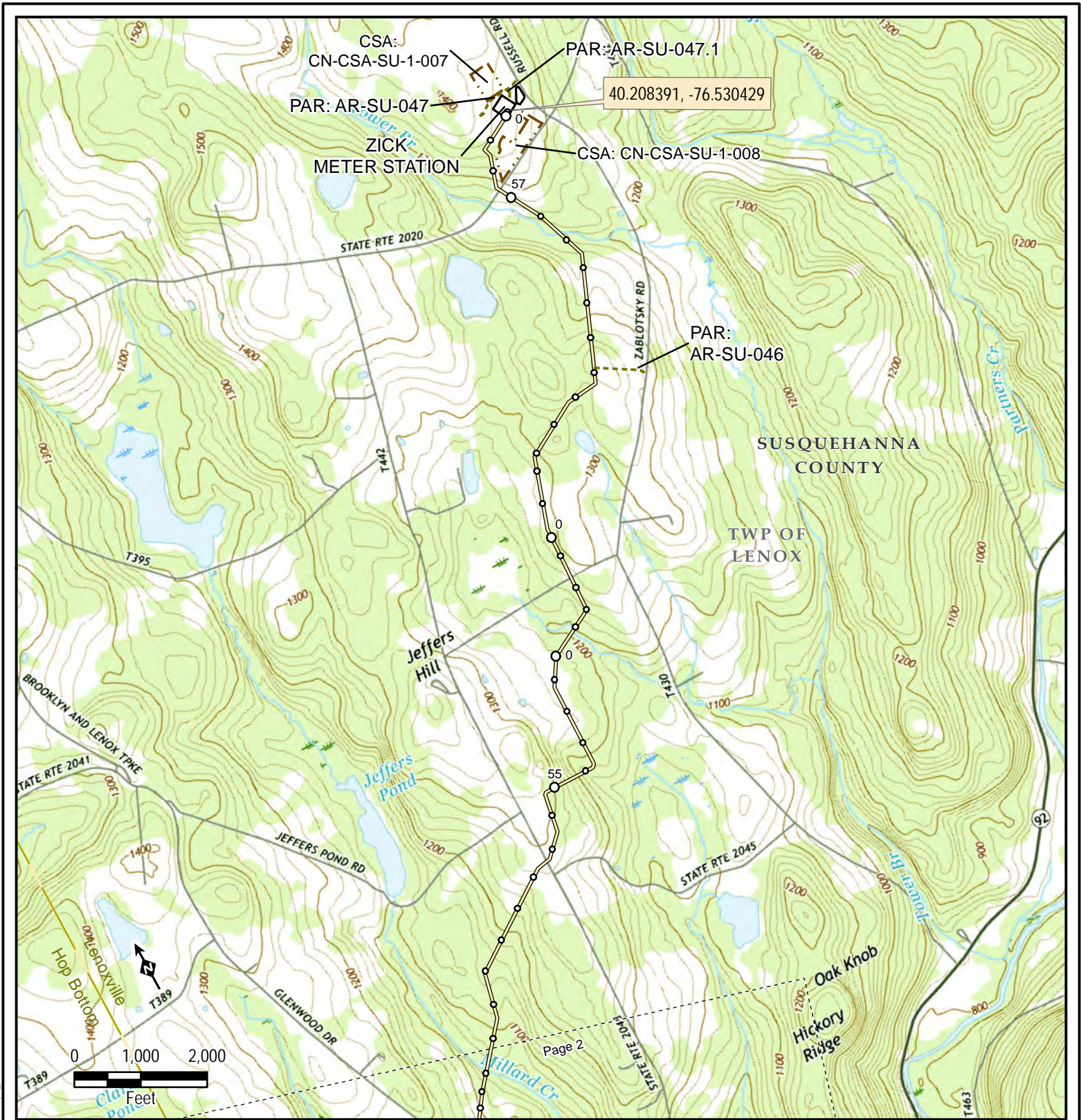

○ Milepost (1)	— Chapman Loop	▭ Contractor/Pipe Yard & Staging Area
○ Milepost (0.1)	— Unity Loop	▭ County
⊕ Public Surface Water Intake	— Permanent Access Road	▭ Municipality
⊙ Water Withdrawal Location	— Temporary Access Road	▭ USGS Quad Boundary
— CPLN	▭ Project Facility (fence line)	▭ Adjacent Page
— CPLS		

Sources: USGS/The National Map 2016, Williams, TRC, Mustang, and ESRI

Williams

**Atlantic Sunrise
Project Location Maps**

USGS Pennsylvania 7.5 Minute Quad
Susquehanna County
Sheet 1 of 70

Created: 11/8/2016

V:\PROJECTS\AUGUST\WilliamsAtlanticSunrise\MDA\USun_PA_LIS\Topo_8x11P.mxd

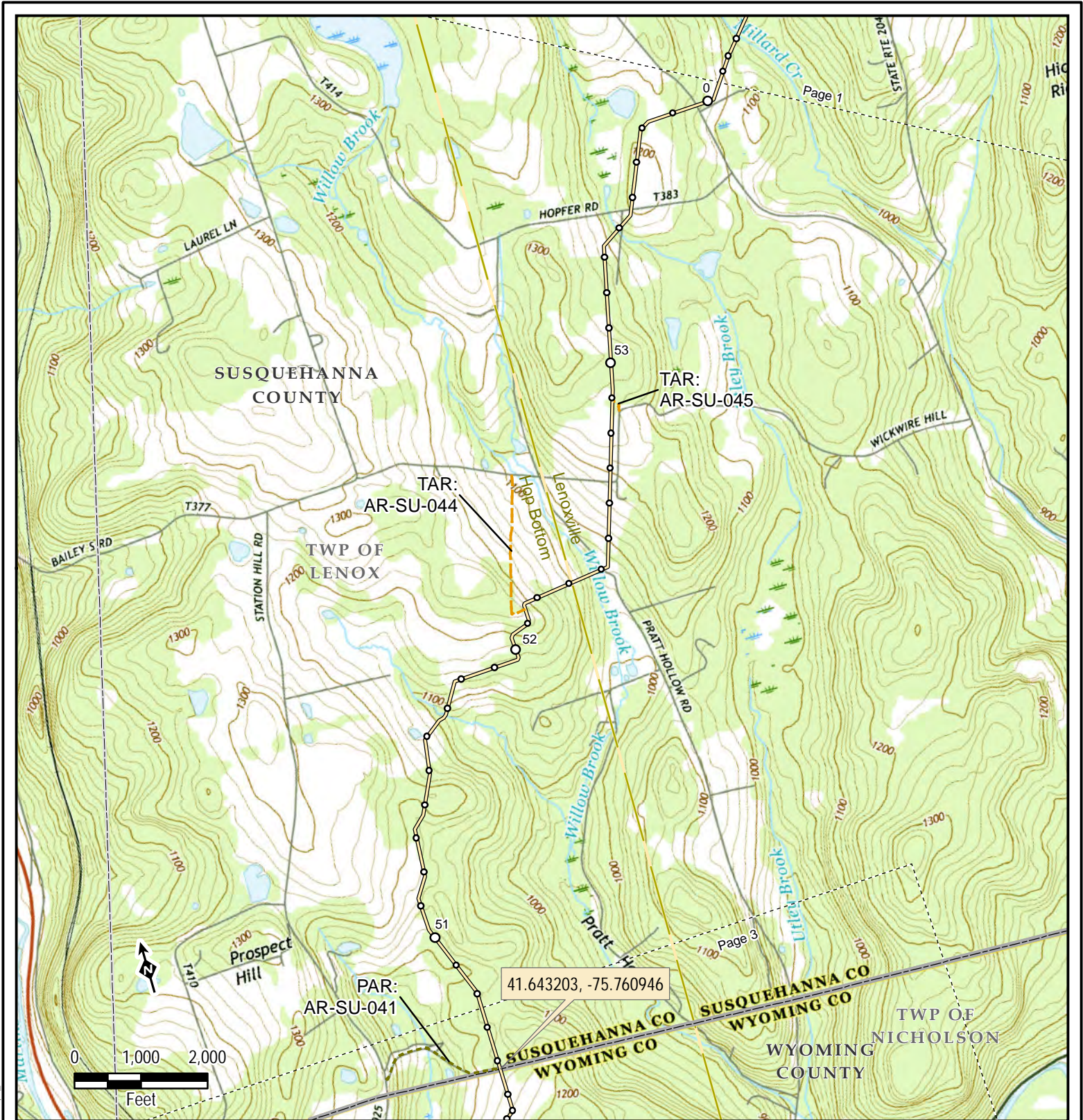

○ Milepost (1)	— Chapman Loop	▭ Contractor/Pipe Yard & Staging Area
○ Milepost (0.1)	— Unity Loop	▭ County
⊕ Public Surface Water Intake	— Permanent Access Road	▭ Municipality
⊙ Water Withdrawal Location	— Temporary Access Road	▭ USGS Quad Boundary
— CPLN	▭ Project Facility (fence line)	▭ Adjacent Page
— CPLS		

Sources: USGS/The National Map 2016, Williams, TRC, Mustang, and ESRI



Atlantic Sunrise
Project Location Maps
 USGS Pennsylvania 7.5 Minute Quad
 Susquehanna County
 Sheet 2 of 70

Created: 11/8/2016 

V:\PROJECTS\AUGUST\WilliamsAtlanticSunrise\MD\AUSun_PA_US10pp_8x11P.mxd