

AR-LA-030						
No.	Northing	Easting	Bearing	Delta(Δ)	Length	Tangent Radius
C1	PC 316089.68 PI 316077.98 PT 316077.24	PC 2310897.83 PI 2310886.29 PT 2310832.66		19'05'39"	66.65'	33.64' 200.0'
L1	B 316077.24 E 316073.12	B 2310832.66 E 2310845.43	S88°44'26.69"W		187.28'	
C2	PC 316073.12 PI 316071.97 PT 316032.36	PC 2310845.43 PI 2310592.72 PT 2310557.92		47°26'10"	99.35'	52.72' 120.0'
L2	B 316032.36 E 316011.20	B 2310557.92 E 2310539.33	S41°18'16.56"W		28.17'	
C3	PC 316011.20 PI 315995.56 PT 315995.56	PC 2310539.33 PI 2310506.74 PT 2310462.27		74°26'25"	84.45'	49.37' 65.0'
L3	B 315995.56 E 316060.77	B 2310462.27 E 2310327.04	N64°15'18.83"W		150.13'	
C4	PC 316060.77 PI 316071.15 PT 316067.16	PC 2310327.04 PI 2310305.51 PT 2310281.94		35°21'16"	46.28'	23.90' 75.0'
L4	B 316067.16 E 316065.53	B 2310281.94 E 2310272.29	S80°23'25.07"W		9.79'	
C5	PC 316065.53 PI 316063.71 PT 316065.02	PC 2310272.29 PI 2310261.54 PT 2310250.71		16°33'00"	21.66'	10.91' 75.0'
L5	B 316065.02 E 316071.63	B 2310250.71 E 2310196.41	N83°03'35.20"W		54.70'	
C6	PC 316071.63 PI 316073.43 PT 316070.85	PC 2310196.41 PI 2310181.64 PT 2310166.99		16°55'25"	29.54'	14.88' 100.0'
L6	B 316070.85 E 316065.19	B 2310166.99 E 2310134.83	S80°00'59.45"W		32.66'	
C7	PC 316065.19 PI 316048.42 PT 316068.40	PC 2310134.83 PI 2310039.53 PT 2309944.86		21°54'17"	191.16'	96.76' 500.0'
L7	B 316068.40 E 316078.47	B 2309944.86 E 2309897.16	N78°04'43.35"W		48.73'	

ACCESS ROAD LAYOUT

NOTE:
EXISTING ROAD IS TO BE USED DURING CONSTRUCTION; THEREFORE, NO PROPOSED ROADWAY SECTION IS PROVIDED. MAINTAIN EXISTING ASPHALT ACCESS ROAD AND ADD AASHTO #57 STONE TO ROADWAY SURFACE AS NECESSARY IN AREAS SHOWING SIGNS OF EROSION (I.E. THINNING OF GRAVEL, GRAVEL WASHOUT, DEPRESSIONS, ETC.) IN ORDER TO RE-ESTABLISH STABLE ROADWAY SURFACE.

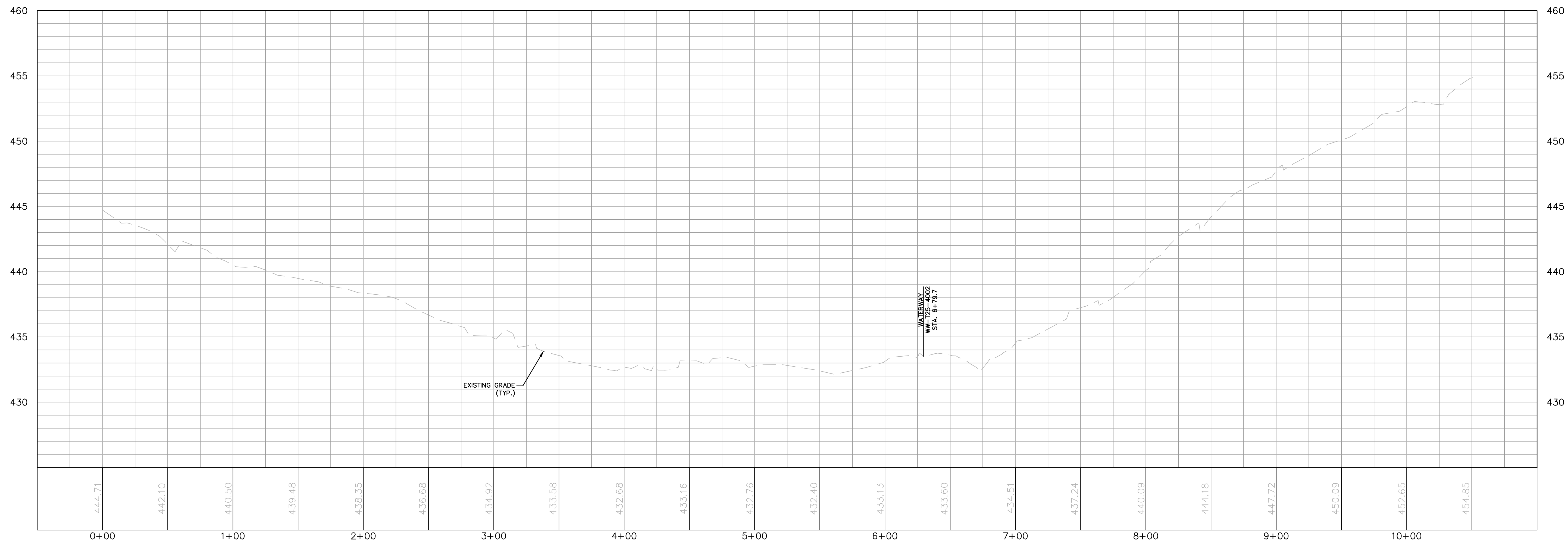

ACCESS ROAD PROFILE

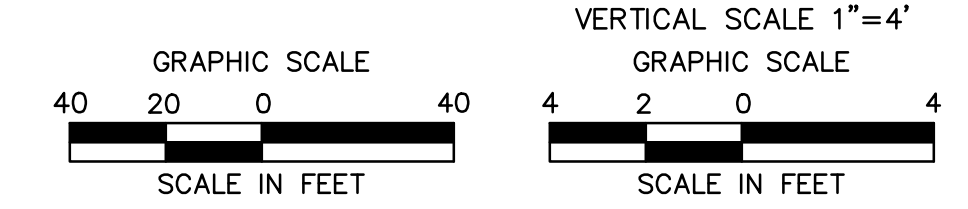

Drawn By & Date/Time: sking Jul 26, 2017 - 3:44pm
 Drawing Location & Name: G:\0851\14\140499\DWG\020-CPLS\AR_P140499(205)-AR-LA-030.dwg

NOTE:
SEE TYPICAL SECTIONS SHEET 3 OF 4 (GENERAL OVERALL SECTION) FOR EXISTING AND PROPOSED FEATURES LEGEND.

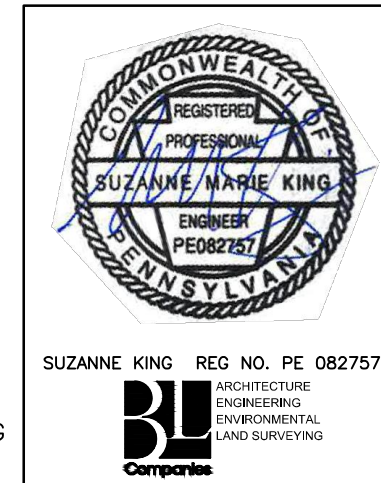

REVISIONS						
NO.	DATE	BY	DESCRIPTION	W.O. NO.	CHK.	APP.
0	07/17/2015	BL	ISSUED FOR PADEP SUBMITTAL	1161503	DAK	SMK
1	12/02/2015	BL	ISSUED FOR PADEP RESUBMITTAL	1161503	DAK	SMK
2	OCT. 2016	BL	PADEP TECHNICAL DEFICIENCY RESPONSE #1	1161503	DAK	SMK
3	APRIL 2017	BL	PADEP TECHNICAL DEFICIENCY RESPONSE #2	1161503	DAK	SMK
4	AUG. 2017	BL	PADEP TECHNICAL DEFICIENCY RESPONSE #3	1161503	DAK	SMK

TRANSCONTINENTAL GAS PIPE LINE COMPANY, LLC
 ATLANTIC SUNRISE PROJECT - PROPOSED 42" CENTRAL PENN LINE SOUTH

ACCESS ROADS - ROADWAY LAYOUT AND PROFILE
 PROPOSED TEMPORARY ACCESS ROAD AR-LA-030
 MOUNT JOY TOWNSHIP, LANCASTER COUNTY, PENNSYLVANIA

DRAWN BY: OLC/MS DATE: 4/2015 ISSUED FOR BID: SCALE: AS NOTED
 CHECKED BY: DAK DATE: 06/12/15 ISSUED FOR CONSTRUCTION: REVISION: 4
 APPROVED BY: SMK DATE: 07/07/15 DRAWING NUMBER: 24-1600-70-28-A/LL113_9-AR-LA-030 SHEET 1 OF 3