

## SITE RESTORATION

- RESTORATION OF THE ACCESS ROAD ROW WILL INCLUDE, BUT IS NOT LIMITED TO, RESTORATION OF EXISTING CONTOURS, RESTORATION OF EXISTING ROADS, DECOMPACTION, AND SEEDING.
- RESTORATION STEPS ARE DESCRIBED IN THE SEQUENCE OF CONSTRUCTION PROVIDED ON THE SOIL EROSION CONTROL PLAN AND IN THE ROAD-SPECIFIC APPENDIX OF THE COUNTY NARRATIVE.
- ONCE THE TEMPORARY ACCESS ROAD IS NO LONGER NECESSARY, THE GRAVEL AND GEOTEXTILE FABRIC FROM THE TEMPORARILY IMPROVED SECTIONS WILL BE REMOVED AND DISPOSED OF AT A SUITABLE DISPOSAL OR RECYCLING SITE IN COMPLIANCE WITH LOCAL, STATE, AND FEDERAL REGULATIONS. STONE ADDED TO EXISTING GRAVEL ROADS WILL REMAIN IN PLACE.
- DISTURBED AREAS OUTSIDE EXISTING ROAD AREAS WILL BE RESTORED TO PRE-CONSTRUCTION CONTOURS. THE SUBSOIL WILL BE DE-COMPACTED AND TOPSOIL WILL BE SPREAD OVER THE DISTURBED AREA. DISTURBED AREAS WILL BE SEEDED AND STABILIZED WITH MULCH OR EROSION CONTROL BLANKETS AS APPLICABLE.
- EROSION CONTROL BLANKETS (ECB) SHALL BE INSTALLED IN THE FOLLOWING AREAS OF DISTURBANCE:
  - AREAS WITHIN 50 FEET OF A STREAM OR WETLAND (DS75 NORTH AMERICAN GREEN OR APPROVED EQUAL).
  - AREAS WITHIN 100 FEET OF HQ OR EV STREAMS AND WETLANDS (DS75 NORTH AMERICAN GREEN OR APPROVED EQUAL).
  - SLOPES EQUAL TO 3:1 OR GREATER (SC150 NORTH AMERICAN GREEN OR APPROVED EQUAL).
- E&SC BMPs, SUCH AS COMPOST FILTER SOCK AND FILTER SOCK DIVERSIONS, SHALL REMAIN IN PLACE UNTIL THE SITE WORK IS COMPLETE AND FINAL STABILIZATION IS ACHIEVED. AN AREA SHALL BE CONSIDERED TO HAVE ACHIEVED FINAL STABILIZATION WHEN A UNIFORM 70% PERENNIAL VEGETATIVE COVER IS ESTABLISHED OVER NON-EXISTING ROADWAY DISTURBED AREAS. IN AGRICULTURAL USE AREAS, AN AREA SHALL BE CONSIDERED TO HAVE ACHIEVED FINAL STABILIZATION IF THE AREA HAS A MINIMUM UNIFORM 70% PERENNIAL VEGETATIVE COVER, THE AREA HAS A PERMANENT NON-VEGETATIVE COVER WITH A DENSITY SUFFICIENT TO RESIST ACCELERATED SURFACE EROSION AND SUBSURFACE CHARACTERISTICS SUFFICIENT TO RESIST SLIDING AND OTHER MOVEMENTS, OR IF AN AREA EXHIBITS ANY GROUND COVER CONDITIONS NORMALLY ASSOCIATED WITH ACTIVE AGRICULTURAL PRACTICES, INCLUDING BUT NOT LIMITED TO BARE EARTH ON CULTIVATED LAND, TEMPORARY VEGETATIVE COVER ON CULTIVATED LAND, OR PASTURE NOT MEETING A MINIMUM UNIFORM 70% PERENNIAL VEGETATIVE COVER.
- RESTORATION WILL PREDOMINATELY OCCUR WITHIN THE AREA LABELED "AREA TO BE RESTORED TO PRE-CONSTRUCTION CONDITIONS." DISTURBED AREAS WILL BE RESTORED TO PRE-CONSTRUCTION CONTOURS (AS SHOWN ON THIS PLAN AND THE ROADWAY LAYOUT AND PROFILE PLAN), EXISTING ROADWAY SURFACES AND WIDTHS WILL BE RESTORED AND NON-EXISTING ROADWAY AREAS WILL BE SEEDED TO REESTABLISH VEGETATIVE COVER.
- THE "AREA OF MINIMUM DISTURBANCE/REDUCED GRADING" IS THE AREA WITHIN THE LOD AREA THAT IS OUTSIDE THE PROPOSED GRADING AREA. DISTURBANCES WITHIN THE AREA OF MINIMUM DISTURBANCE/REDUCED GRADING WILL BE MINIMAL. THEREFORE, THE SITE RESTORATION IN THE AREA OF MINIMUM DISTURBANCE/REDUCED GRADING MAY NOT REQUIRE RESTORATION OR MAY BE LIMITED TO SEEDING STOCKPILE AREAS, IF APPLICABLE, TO RESTORE VEGETATION THAT MAY HAVE BEEN IMPACTED BY THE STOCKPILE.

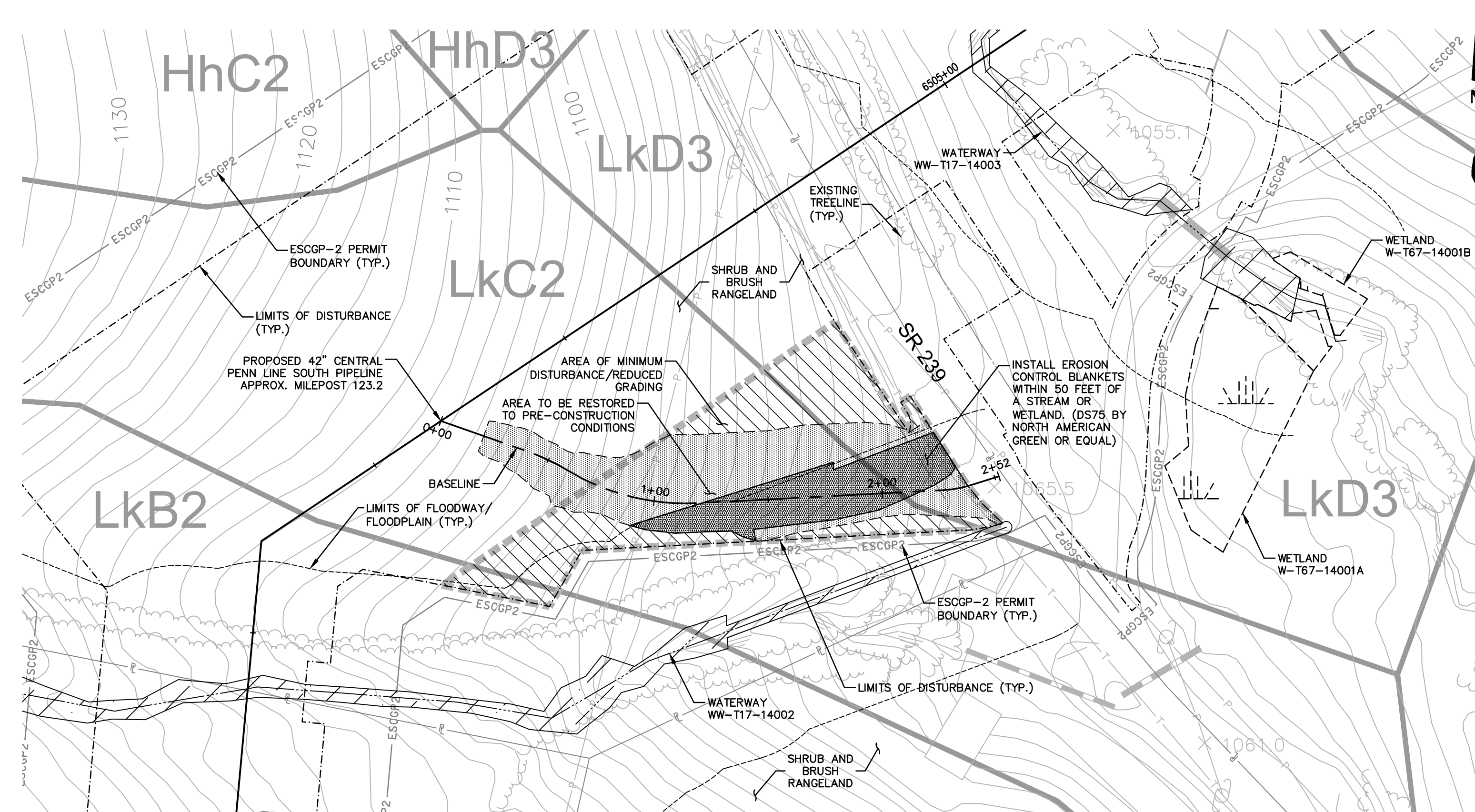

### ESCGP-2 PERMIT TABLE

LIMIT OF DISTURBANCE	0.26 AC.
LOD AREA WITHIN FLOODWAY/FLOODPLAIN	0.04 AC.
AREA OF RIPARIAN FOREST BUFFER	0.00 AC.
AREA OF MINIMUM DISTURBANCE/REDUCED GRADING	0.11 AC.
STORMWATER MANAGEMENT AREA	N/A**
AREA CONTROLLED BY PERMANENT BMPs	N/A**

\*\* NOT APPLICABLE FOR TEMPORARY ROADS. AREA WILL BE RESTORED TO PRE DEVELOPMENT CONDITIONS.

### SITE SOIL TYPES

SEE COVER SHEET FOR SOIL TYPE LIMITATIONS

### RECEIVING WATERS

UNT TO YORK HOLLOW, CWF, MF  
CHAPTER 303(D) IMPAIRMENT: NONE

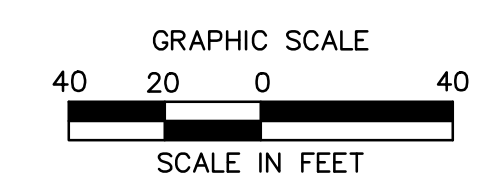

REVISIONS						
NO.	DATE	BY	DESCRIPTION	W.O. NO.	CHK.	APP.
0	OCT. 2016	BL	PADEP TECHNICAL DEFICIENCY RESPONSE #1	1161503	DAK	SMK
1	APRIL 2017	BL	PADEP TECHNICAL DEFICIENCY RESPONSE #2	1161503	DAK	SMK
2	AUG. 2017	BL	PADEP TECHNICAL DEFICIENCY RESPONSE #3	1161503	DAK	SMK

TRANSCONTINENTAL GAS PIPE LINE COMPANY, LLC  
ATLANTIC SUNRISE PROJECT - PROPOSED 42" CENTRAL PENN LINE SOUTH

ACCESS ROADS - SITE RESTORATION PLAN  
PROPOSED TEMPORARY ACCESS ROAD AR-CO-106.3  
JACKSON TOWNSHIP, COLUMBIA COUNTY, PENNSYLVANIA

**Williams**  
GAS PIPELINE

DRAWN BY: OLC/MS	DATE: 4/2015	ISSUED FOR BID:	SCALE: 1"=40'
CHECKED BY: DAK	DATE: 06/12/15	ISSUED FOR CONSTRUCTION:	REVISION: 2
APPROVED BY: SMK	DATE: 07/07/15	DRAWING NUMBER: 24-1600-70-28-A/ LL113_9-AR-CO-106.3	SHEET 3 OF 3

NOTE:  
SEE TYPICAL SECTIONS SHEET 3 OF 4  
(GENERAL OVERALL SECTION) FOR EXISTING  
AND PROPOSED FEATURES LEGEND.