



# pennsylvania

DEPARTMENT OF ENVIRONMENTAL PROTECTION

Office of Active and Abandoned Mine Operations

**BOSWELL NORTH**  
Abandoned Mine Reclamation Project  
Contract No. OSM 56(1489)102.1

Bureau of Abandoned Mine Reclamation  
286 Industrial Park Road  
Ebensburg, PA 15931-4119



Historic Park. The abandoned features were a direct result of M.F. Fetterolf Coal Company who ceased their mining operations in the 1950s. Any and all unforeseen PA Code, Title 25, Chapter 105 Stream Encroachment and Chapter 102 Erosion and Sediment Control issues were addressed by the BAMR Design Unit, and any necessary permit authorizations were obtained.

**Funding:**

Pennsylvania’s Abandoned Mine Land Grant

**Project Management:**

Bureau of Abandoned Mine Reclamation  
Cambria District Office  
814.472.1800

**Accomplishments:**

PRIORITY	AMLF #	AMLF KEYWORD	MEASUREMENTS						QUANTITY	UNIT
			ACRES	HEIGHT	LENGTH	COUNT	VOL.	FLOW		
2	1489-07	DH	-	-	350	-	-	-	350	L.F.
2	1489-08	DH	-	-	900	-	-	-	900	L.F.
2	1489-08	HWB	-	-	-	1	-	-	1	COUNT
2	1489-09	DH	-	-	550	-	-	-	550	L.F.
2	1489-10	DH	-	-	250	-	-	-	250	L.F.
3	1489-11	SA	8	-	-	-	-	-	8	ACRES

AMLF = Abandoned Mine Land Feature  
 DH = Dangerous Highwall  
 HWB = Hazardous Water Body  
 SA = Spoil Area  
 L.F. = Linear Feet

BOSWELL NORTH  
Contract No. OSM 56(1489)102.1

Project Location Map

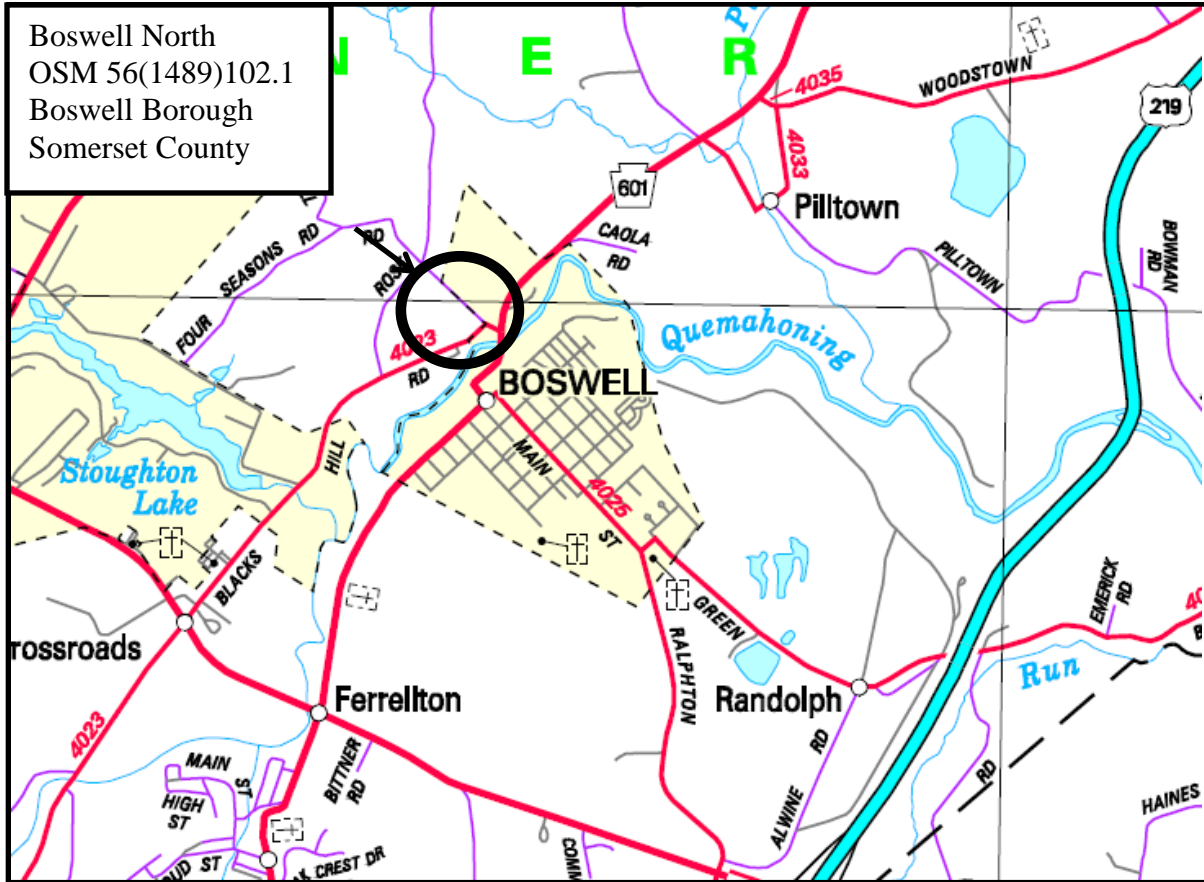

BOSWELL NORTH  
Contract No. OSM 56(1489)102.1

Pre-Construction



BOSWELL NORTH  
CONTRACT NO. OSM 56(1489)102.1

During Construction



Installing block erosion control matting through the park.

Looking from Cessna Hill Road across the site.



Installing the three 36-inch pipes under the utilities.

Looking off to the side of Cessna Hill Road.

BOSWELL NORTH  
CONTRACT NO. OSM 56(1489)102.1

Post-Construction



Looking up the R-6 rip-rap channel.

Looking down from the top of site.



Plunge pool.

Block erosion block channel.