



pennsylvania

DEPARTMENT OF ENVIRONMENTAL PROTECTION



Active and Abandoned Mine Operations

New Hope Crushed Stone

Monthly Update

Solebury Communications Group

November 2017

Tom Wolf, Governor

Patrick McDonnell, Secretary

November 2017 Project Status

STATUS AS OF:	December 4, 2017	
PROJECT	New Hope Crushed Stone (NHCS) Quarry Reclamation and Stream Restoration	
START DATE	Reclamation: January 29, 2016 Stream Restoration: January 29, 2016	
ANTICIPATED COMPLETION DATE	Reclamation: March 2019 Stream Restoration: March 2019	
CURRENT STATUS	Quarry Reclamation	On Schedule
	Stream Restoration	On Schedule

Key Ongoing Factors

- Provisions of the January 29, 2016, letter from DEP to NHCS continue to be in effect.
 - Reclamation and stream restoration are required to be completed by March 2019.
- Reclamation and stream restoration progress reporting to DEP by the 5th of each month remains.
- Environmental Hearing Board Appeals by NHCS
 - January 29, 2016, DEP letter: Hearing held March 20, 2017. Decision anticipated later this year.
 - The EHB dismissed the NHCS appeal on September 7, 2017
 - August 26, 2016, Compliance Order: Withdrawn on August 15, 2017.
- Commonwealth Court Appeals by NHCS
 - January 29, 2016, DEP letter: EHB September 7, 2017, dismissal appeal filed on September 29, 2017.
- The July 17, 2017, drone survey of the quarry resulted in a reduced reclamation volume being moved. DEP concludes the reclamation progress is on track for completion by March 2019. This is due to:
 - NHCS has demonstrated the ability to move the necessary volumes of reclamation fill in June and July.
 - NHCS has a clear understanding of the performance expectations moving forward.
 - With the completion of the survey and staking of areas with mapping showing reclamation progress and future placement needs, reclamation work moving forward can be done more accurately and efficiently.
 - DEP will require a survey in early 2018 to serve as a benchmark for the March 2019 completion.
- The last NHCS related sinkhole was repaired on April 28, 2017.

November 2017 Highlights

- General
 - Settlement talks between DEP and NHCS have continued.
- An inspection occurred on November 29.
 - Statutorily required inspection frequency is once per quarter. Future inspections will be done on this basis and increased if needed.
 - Site visits outside the inspection process will be made to the quarry as they have been done in the past. These visits did occur in November.
 - 500,000 GPD maximum pumping continues.
 - The water level is estimated to be -43 MSL.
 - The blasting complaint received on September 26 was investigated in October. DEP found that NHCS was not in violation.
- Reclamation and Stream Restoration Progress
 - November Work Days
 - 7 on reclamation; 6 on stream; 1 lost to inclement weather and conditions; 4 on MSHA inspection. Two work days were lost due to higher than usual employee vacation and sick leave.

November 2017 Highlights - Continued

- Reclamation and Stream Restoration Progress - Continued
 - No truck trips were made in November due to concentrating on the work described below and days lost to the MSHA inspection, weather, and higher than normal employee leave.
 - As of the end of November 36.8% of the total reclamation material has been moved.
 - Reclamation work included the continuation of relocating the Hazemag foundation and coffin blocks.
 - Preparation work was done to move the transformer due to the rising water level.
 - Stream work was done on 6 days.
 - Stream channel work continued along the length of the stream.
 - Inlet work continued.
 - On December 4, DEP sent a letter to NHCS detailing 4th quarter reporting requirements.
 - This includes requesting additional information on upcoming reclamation and restoration work and milestones.
 - The letter is posted to the DEP Southeast Regional Office community information web page for NHCS (see last page).

Monthly Progress Data

Month	Cubic Yards Placed Overburden	Cubic Yards Placed Overburden, Cumulative	Truck Loads	Reclamation Work Days	Stream Restoration Work Days	Inclement Weather Work Days Lost
Prior to Sept. 2016	40,764	40,764	237			
Sep-16	32,535	73,299	940			
Oct-16	25,535	98,834	531	15.0	6.0	0.0
Nov-16	19,582	118,416	367	5.0	13.0	2.0
Dec-16	5,475	123,891	128	2.5	0.0	15.5
Jan-17	24,007	147,898	588	16.0	0.0	1.0
Feb-17	7,043	154,941	186	8.0	0.0	4.0
Mar-17	0	154,941	0	0.0	0.0	11.0
Apr-17	13,114	168,055	365	13.0	0.0	3.0
May-17	11,799	179,854	301	9.0	1.0	4.0
Jun-17	39,177	219,031	126	0.0	6.0	2.0
Jul-17	54,527	273,558	1,103	9.0	1.0	3.0
Drone Survey		220,128				
Aug-17	2,556	222,684	45	10.5	22.5	4.0
Sep-17	3,429	226,113	61	10.0	14.0	2.0
Oct-17	2,750	228,863	50	6.0	17.0	4.0
Nov-17	0	228,863	0	7.0	6.0	1.0
Dec-17						
Jan-18						
Feb-18						
Mar-18						
Total Reclamation Fill to Place	621,392					
Percentage of total placed to date	36.8%					

Reclamation Fill Progress

Reclamation Fill Tracking

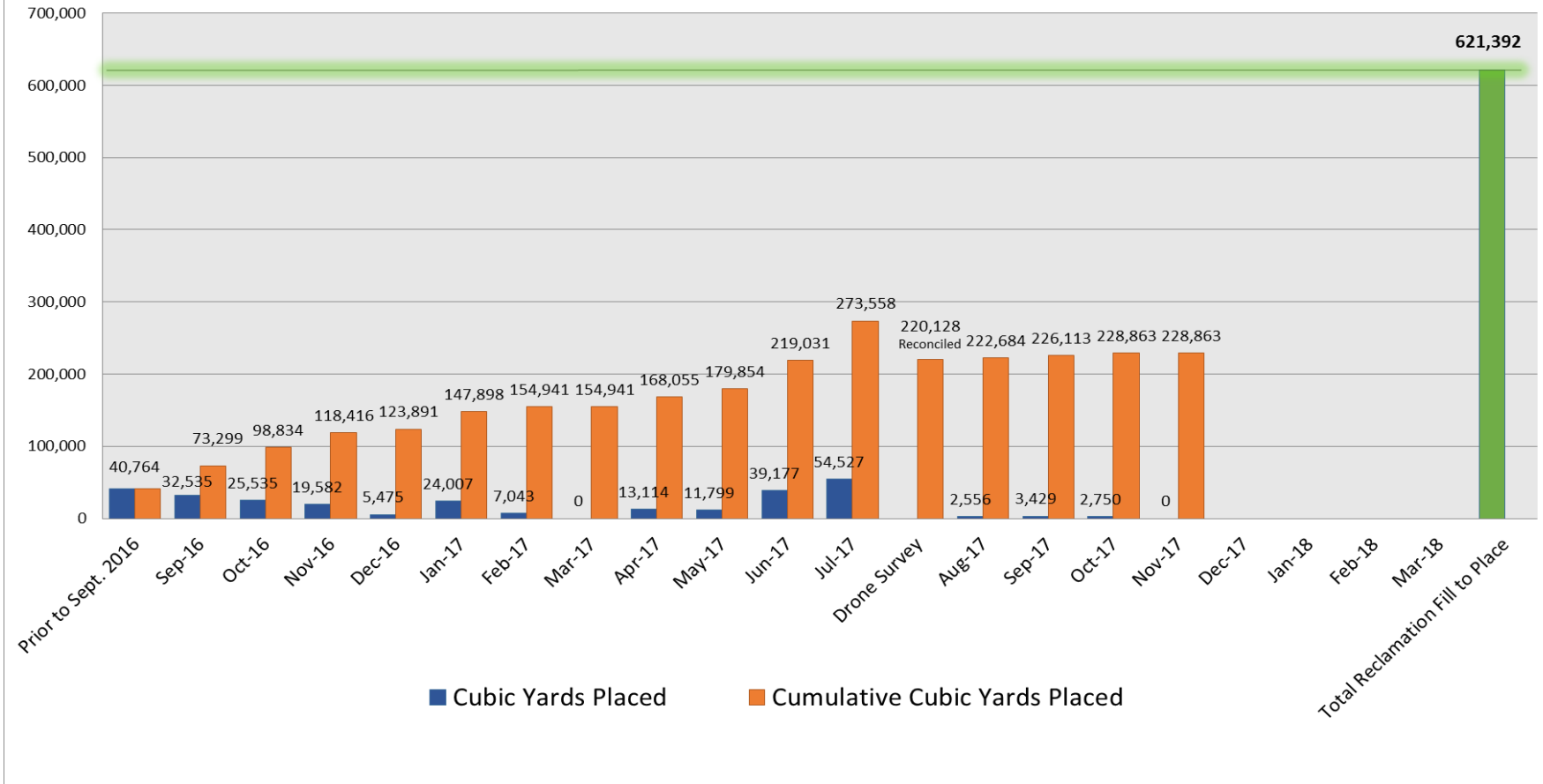

Water Level Tracking

Water Level Status

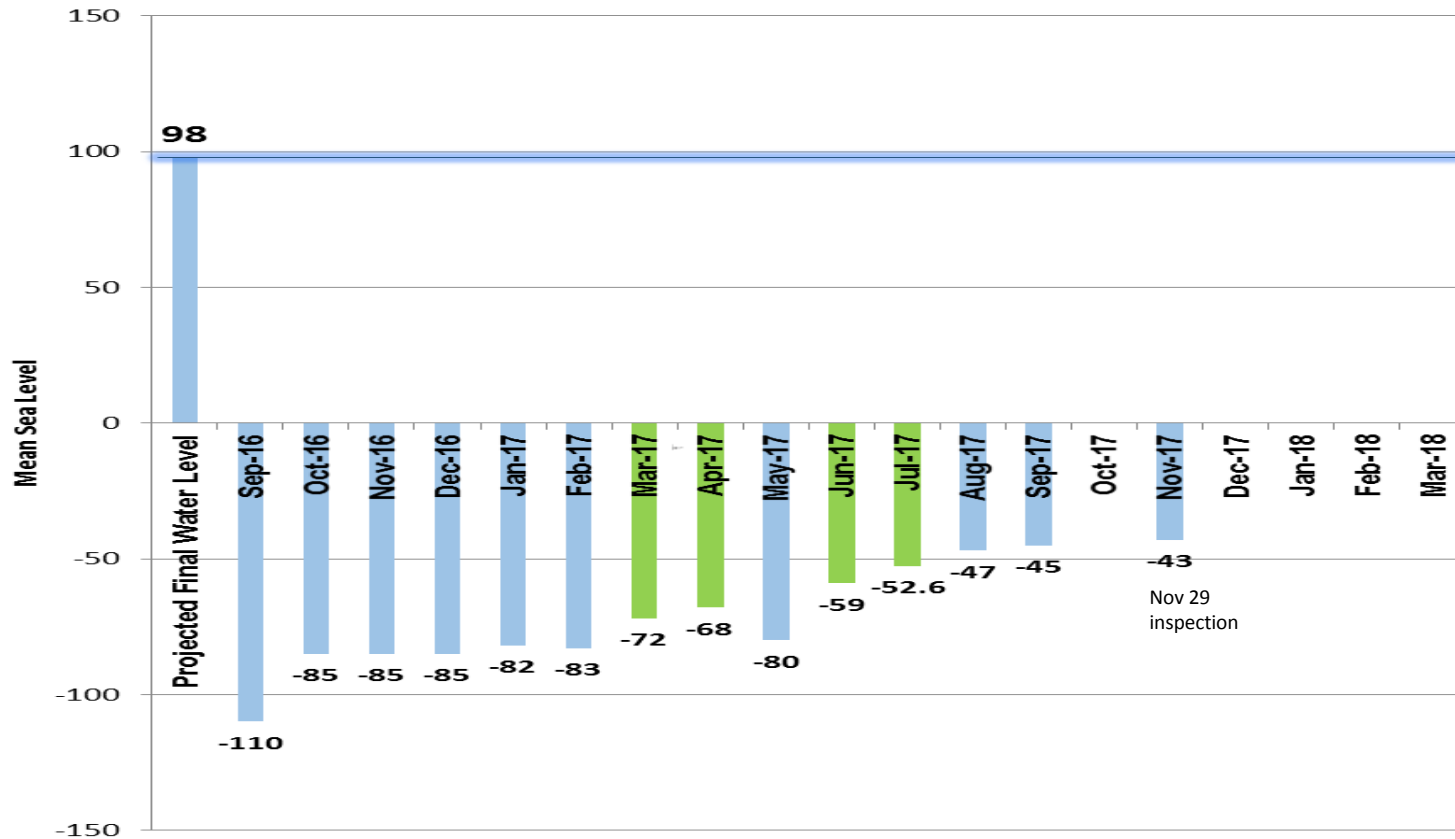

Nov 29 inspection

Blue bar = Estimated

Green bar = NHCS consultant, EarthRes, PE stamped reports

NHCS Monitoring Well Locations



Monitoring well locations are noted by MW1 and MW2 to the right and MW8 at the top center. The fourth in the center is for the plants water use.

Bucks County Precipitation: 2016-2017

BUCKS COUNTY PRECIPITATION
 USGS PLOT OF NATIONAL WEATHER SERVICE DATA
 MOVING 365-DAY TOTAL PRECIPITATION
 DATE OF PLOT=12/11/17

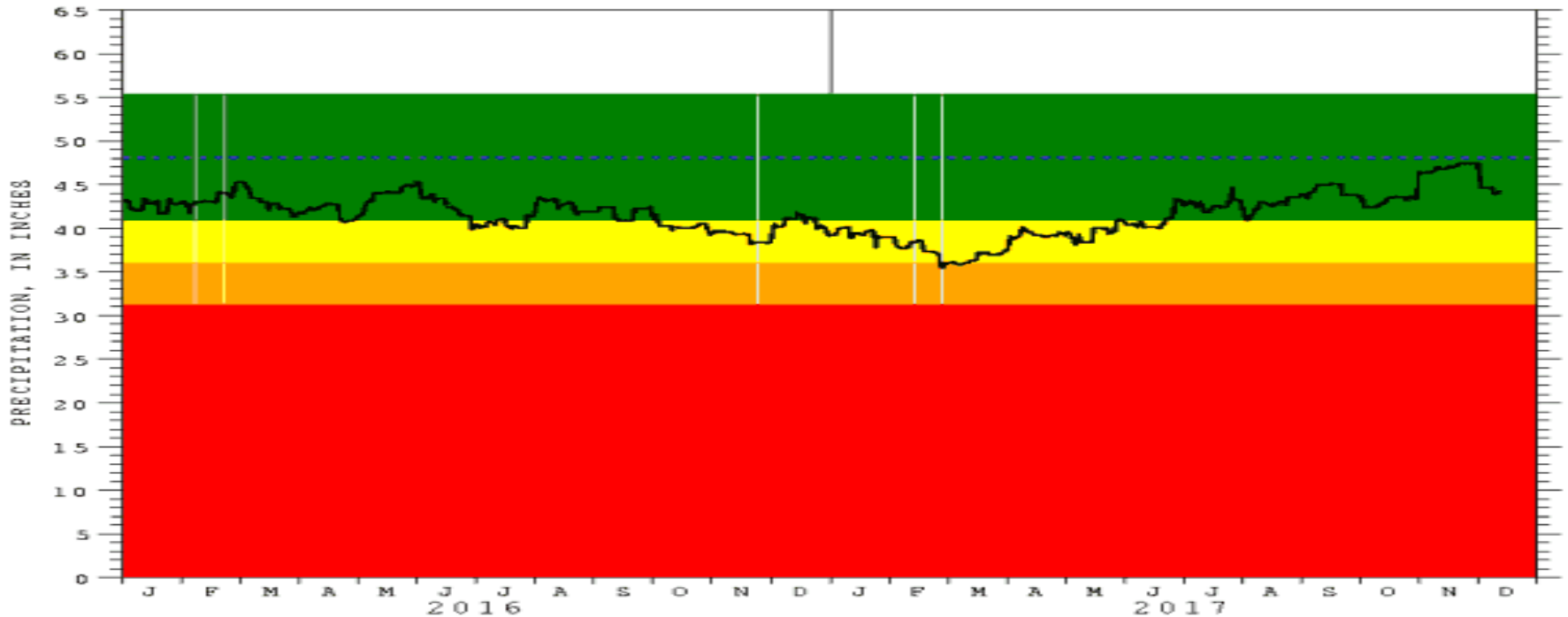

COLORED BANDS REPRESENT DROUGHT INDICATOR CRITERIA USED BY THE PENNSYLVANIA DEPARTMENT OF ENVIRONMENTAL PROTECTION FOR DROUGHT MONITORING

SOLID LINE = CURRENT MOVING 365-DAY TOTAL, IN INCHES
 DASHED LINE = MOVING AVERAGE 365-DAY TOTAL FOR 1981-2010, MARFC 2013

GREEN (TOP) BAND = 15 PERCENT ABOVE TO 15 PERCENT BELOW AVERAGE (NORMAL)
 YELLOW BAND = 15 TO 25 PERCENT BELOW AVERAGE (WATCH)
 ORANGE BAND = 25 TO 35 PERCENT BELOW AVERAGE (WARNING)
 RED (BOTTOM) BAND = GREATER THAN 35 PERCENT BELOW AVERAGE (EMERGENCY)

NHCS Bench Levels

- Bench 2 60' MSL
- Bench 3 10' MSL
- Bench 4 -35 MSL
- Bench 5 -85 MSL
- Bench 6 -120 MSL



Photo Vantage Points

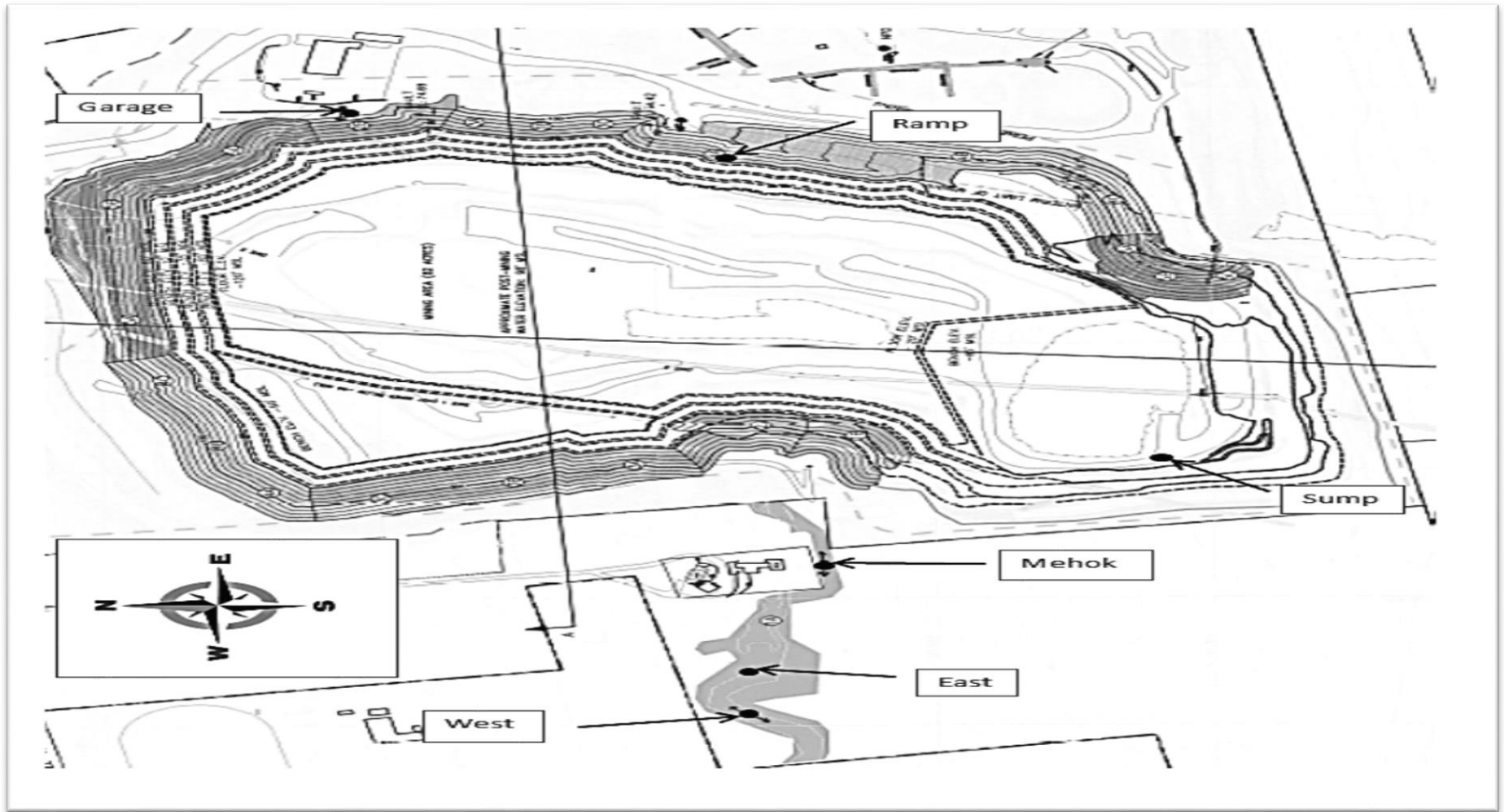

Note: Sump view is taken from opposite side due to the water level in the pit. It will be adjusted as the water continues to rise.

Sump Area Looking West



11/29/17



9/29/17

Quarry Overview



11/29/17



East Wall



11/29/17

Stream Views: East and West



Stream View: West Looking North



11/29/17



pennsylvania
DEPARTMENT OF ENVIRONMENTAL PROTECTION



Active and Abandoned Mine Operations

For More Information

Monthly Updates, Inspection Reports,
Communications and more, posted as available.

Please visit: www.dep.pa.gov

Regional Resources > Southeast Region > Community Information

Tom Wolf, Governor

Patrick McDonnell, Secretary