

PUMPING LOCATION PLAN
0 200 400

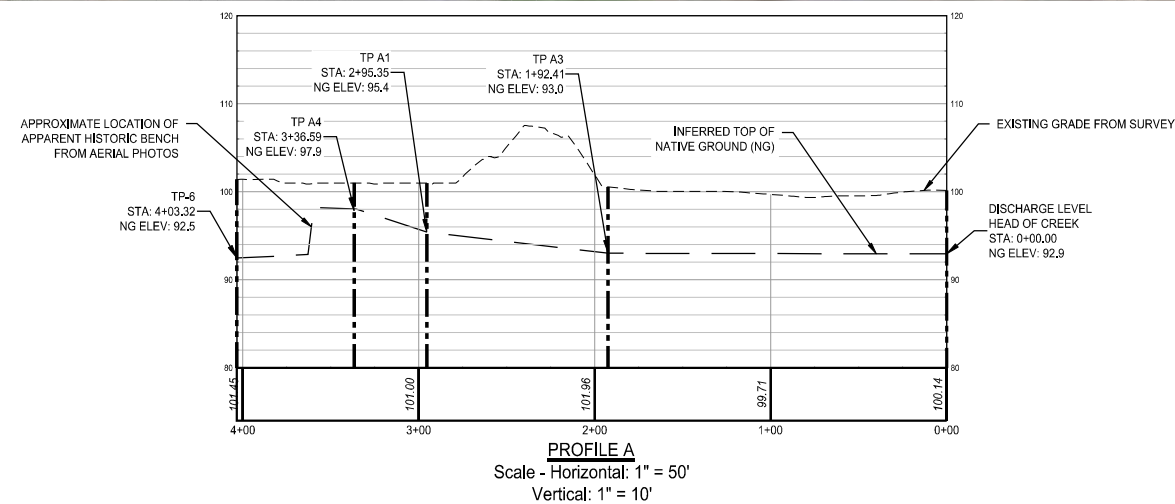

- NOTES:
1. EXISTING GROUND CONTOUR DATA SURVEYED BY NORTHEAST SURVEYORS, LLC, DATED OCTOBER 2022.
 2. ALL AND ANY UTILITY LOCATIONS ARE UNKNOWN.
 3. TEST PIT LOCATIONS WERE VISUALLY IDENTIFIED. TEST PIT "A" LOCATIONS WERE LOCATED WITH EOS ARROW GOLD AND IPAD WITH ACTIVE CELLULAR SERVICE.
 4. AERIAL IMAGERY SHOWN IS PER GOOGLE EARTH MAPPING DATED 2023.
 5. TETRA TECH IS NOT RESPONSIBLE FOR ANY DAMAGE TO THE EXISTING DISCHARGE SPILLWAY.



www.tetratech.com



NO.	BY	DATE	DESCRIPTION
0	JNB	08/02/23	ISSUED FOR REVIEW
REVISIONS			

SUBMITTED BY:	DATE:	PLOT DATE:	SCALE:
Heather Trexler, PG, Project Manager TETRA TECH, INC.	07/06/2022	8/2/2023	0 50' 100'
APPROVED BY:	DRAWN BY:	CHECKED BY:	ACAD FILE NAME:
	JNB	HT	

ALL EXISTING CONDITIONS SHALL BE CHECKED AND VERIFIED BY THE CONTRACTOR AT THE SITE

QUARRY DISCHARGE OUTLET PROJECT
NEW HOPE CRUSHED STONE & LIME CO.

SOLEBURY TOWNSHIP BUCKS COUNTY

EXISTING SITE PLAN 02248-C-100