

*Atlantic Sunrise Project – PA DEP Chapter 105 Joint Permit Application
Transcontinental Gas Pipe Line Company, LLC
Wyoming County*

**ATTACHMENT O -1
FLOODPLAIN ANALYSIS AND CONSISTENCY**

*Atlantic Sunrise Project – PA DEP Chapter 105 Joint Permit Application
Transcontinental Gas Pipe Line Company, LLC
Wyoming County*

Please refer to Attachment C of this application for copies of the letters and consistency requests which have been sent to each County and Municipality. Floodplain management analysis letters that have been provided to the County / Municipality, as well as any concurrence letters received at the time of the application submittal, have been included in this section. Additional concurrence letters will be provided upon receipt; however, because this Project is subject to the jurisdiction of the Federal Energy Regulatory Commission (FERC) under the Natural Gas Act, FERC has exclusive jurisdiction over siting. Therefore, local zoning is preempted.



October 26, 2016

Clinton Township
Floodplain Administrator
P.O. Box 256, Creek Road
Factoryville, PA 18419

Re: Atlantic Sunrise Project
Central Penn Line North
Clinton Township, Wyoming County
Floodplain Management Analysis

Dear Sir or Madam:

Transcontinental Gas Pipeline Company, LLC (Transco) proposes to construct and operate the Atlantic Sunrise Project (Project) to provide 1.7 million dekatherms per day of incremental firm transportation of natural gas from the Marcellus Shale production areas in northern Pennsylvania (PA) to its existing market areas, extending to as far south as the Station 85 Pooling Point in Choctaw County, Alabama. The Project includes modifications to the existing Transco Mainline System to reverse the direction of flow, enabling new north-to-south capabilities (bi-directional flow) to transport this new source of natural gas to existing markets. The Project consists of the following primary components within PA:

- Installing greenfield pipeline facilities of approximately 58.6 miles of new 30-inch-diameter pipe from Susquehanna County, PA to Columbia County, PA.
- Installing greenfield pipeline facilities of approximately 127.3 miles of 42-inch-diameter pipe from Columbia County, PA to Lancaster County, PA.;
- Installing two pipeline loops (pipeline laid parallel to existing facilities):
 - 8.56 miles of 42-inch pipeline loop located in Lycoming County, PA known as the Unity Loop;
 - 2.50 miles of 36-inch pipeline in Clinton County, PA, known as the Chapman Loop;
- Constructing two new compressor stations, one in Wyoming County and one in Columbia County, PA;
- Additional ancillary facilities, such as mainline valves, cathodic protection, communication facilities, and internal inspection device (e.g., pig) launchers and receivers;
- Two new meter stations and three new regulator stations with interconnecting piping;
- Additional compression and related modifications to one existing compressor station; and,
- Modification to an existing meter station for use of shared facilities with a new meter station.

Transco's consultants, BL Companies and TRC Solutions (TRC), have completed an analysis of potential impacts on FEMA delineated floodways from the Project in accordance with 25 Pa. Code § 105.13. The analysis for Clinton Township is provided below for your review and comment.

**ATLANTIC SUNRISE PROJECT
FEMA FLOODPLAIN CROSSINGS
CLINTON TOWNSHIP, WYOMING COUNTY, PENNSYLVANIA**

| Description of Impact | Structure Type and Dimensions | Resource ID | Resource Name | Chapter 93 Classification, Wetland Classification (EV or Other), or Floodway Type | Floodway Fill (cu. yds.) | Impact area (acres) | | Latitude | Longitude |
|---------------------------|-----------------------------------|--------------|--|---|--------------------------|---------------------|-----------|----------|-----------|
| | | | | | | Temporary | Permanent | | |
| Utility Pipeline Crossing | Equipment Access and E&S Controls | WW-T19-20005 | Floodway to Trout Brook | FEMA Detailed | N/A | 0.0993 | 0.0092 | 41.55036 | -75.82332 |
| Utility Pipeline Crossing | Equipment Access and E&S Controls | WW-T14-20003 | Floodway to UNT South Branch Tunkhannock Creek | FEMA Detailed | N/A | 1.1702 | 0.0571 | 41.56393 | -75.80648 |

The floodway crossings listed above are depicted on the enclosed plans from the Project’s PADEP Chapter 105 Permit Application.

Please note that construction activities are not expected to create permanent loss of flood storage capacity or hydraulic capacity, as all pre-construction surface elevations will be re-established during restoration. The temporary and permanent impacts noted above are associated with vegetation management and underground pipe installation only, and do not represent a permanent modification of ground elevation or loss of flood storage capacity or hydraulic capacity. No structures are proposed within the FEMA 100-year floodplain, no fill will be placed in the floodways, and no increase in 100-year flood elevation is anticipated as a result of the proposed Project.

On behalf of Transco, BL and TRC respectfully request that Clinton Township review this analysis and, if applicable, provide comments to:

Steve Crescenzo
TRC Environmental Corporation
2200 Liberty Avenue, Suite 100
Pittsburgh, PA 15222

Please do not send comments directly to the PADEP, as we must include them with our permit application. Should you have any questions or concerns regarding this notification, please contact Al Busher at (717)-651-9850 or via email at abusher@blcompanies.com.

Sincerely,



Alaric J. Busher, PE
Senior Engineer

Enclosures: Water Obstruction and Encroachment Permit Impact Maps

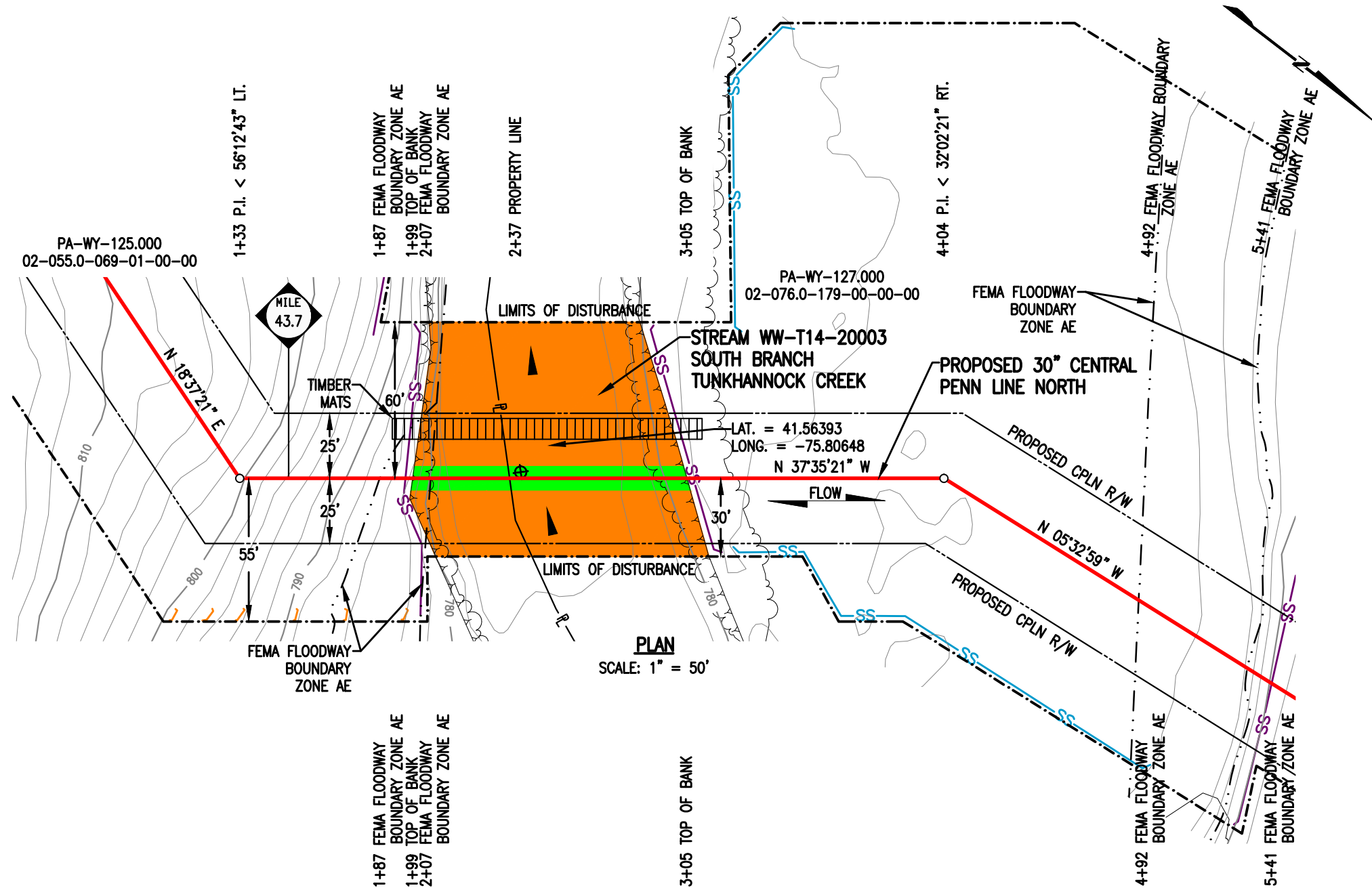

PLAN
SCALE: 1" = 50'

STREAM DISTURBANCE:

| STREAM WW-T14-20003 | ACRE |
|-----------------------------------|---------------|
| TEMPORARY STREAM DISTURBANCE | 0.1768 |
| PERMANENT STREAM DISTURBANCE | 0.0242 |
| TOTAL STREAM DISTURBANCE | 0.2010 |
| TEMPORARY FLOODWAY DISTURBANCE | 1.1702 |
| PERMANENT FLOODWAY DISTURBANCE | 0.0571 |
| TOTAL FLOODWAY DISTURBANCE | 1.2273 |

| STREAM DIMENSION | FT. |
|---------------------------|--------|
| STREAM WIDTH (TOB TO TOB) | 105.38 |
| STREAM LENGTH | 94.82 |

GENERAL NOTES:

1. STREAM CROSSING METHOD SHALL BE DAM AND PUMP (DPX). EQUIPMENT TO CROSS STREAM UTILIZING A BRIDGE EQUIPMENT CROSSING (BEC).
2. THIS SITE IS LOCATED WITHIN THE 100 YEAR FLOOD PLAIN PER FEMA FLOOD MAP DATA.
3. STATION 2+00 SHOWN IS EQUAL TO STATION 2307+84 ON THE EROSION AND SEDIMENT CONTROL PLAN.

SURVEY NOTES:

1. T.B.M. SURVEY CONTROL POINT - 50' RT. OF M.P. 43.72, ELEV. = 775.93' (NAVD88).

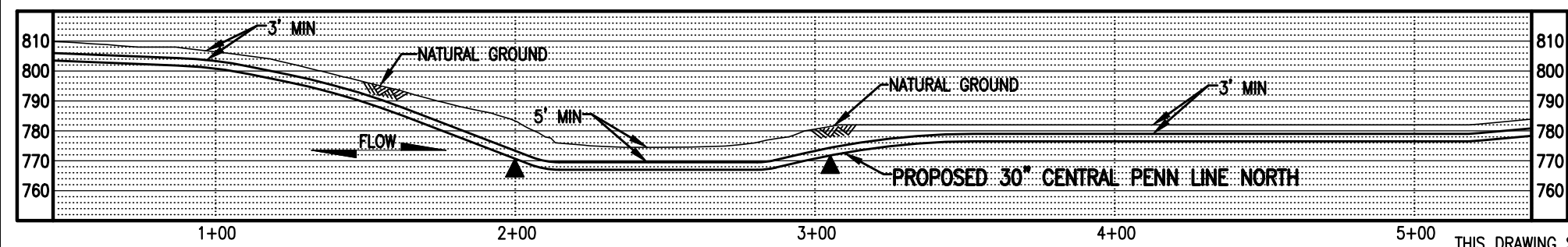

PROFILE
SCALE: 1" = 50' HORIZONTAL
1" = 50' VERTICAL



LEGEND

| | | | |
|--|--------------------------------------|--|-------------------------|
| | PROPOSED 30" CENTRAL PENN LINE NORTH | | WETLAND FLAGS |
| | EXISTING PIPELINES | | PHOTO DATA POINT |
| | EXISTING TGPL R/W | | WETLAND DATA POINT |
| | LIMITS OF DISTURBANCE | | UPLAND DATA POINT |
| | PROPOSED CPLN R/W | | WELL POINT |
| | PROPERTY LINE | | TRENCH PLUG |
| | FOREIGN PIPELINE | | WATERBODY |
| | WETLAND AREA | | TREE LINE |
| | STREAM FLOW | | FLOODWAY BOUNDARY |
| | EXISTING POWER LINE | | FEMA FLOODWAY BOUNDARY |
| | EXISTING FENCE | | 12" SEDIMENT BARRIER |
| | | | 18" SEDIMENT BARRIER |
| | | | 24" SEDIMENT BARRIER |
| | | | 32" SEDIMENT BARRIER |
| | | | TOP OF BANK |
| | | | PERMANENT STREAM IMPACT |
| | | | TEMPORARY STREAM IMPACT |



| DRAWING NO. | REFERENCE TITLE | | | | | |
|-------------|-----------------|----|-------------------------------|----------|------|------|
| NO. | DATE | BY | REVISION DESCRIPTION | W.O. NO. | CHK. | APP. |
| 0 | 08/11/15 | AT | ISSUED FOR PADEP 105 PERMIT | 1161481 | CLR | MJH |
| 1 | 10/13/16 | AT | ISSUED FOR PADEP SUBMITTAL #2 | 1161481 | CLR | MJH |

TRANSCONTINENTAL GAS PIPE LINE COMPANY LLC
WATER OBSTRUCTION AND ENCROACHMENT PERMIT IMPACT MAPS
ATLANTIC SUNRISE PROJECT
PROPOSED 30" CENTRAL PENN LINE NORTH
STREAM CROSSING WW-T14-20003
© M.P. 43.72
CLINTON TOWNSHIP, WYOMING COUNTY, PENNSYLVANIA

| | | | |
|----------------------|----------------|--|-----------------|
| DRAWN BY: LL | DATE: 12/27/14 | ISSUED FOR BID: | SCALE: 1" = 50' |
| CHECKED BY: ML | DATE: 03/07/15 | ISSUED FOR CONSTRUCTION: | REVISION: 1 |
| APPROVED BY: MJH | DATE: 04/17/15 | DRAWING NUMBER: 24-1601-70-09-A/43.71-02 | SHEET 1 OF 1 |
| W.O. NUMBER: 1161481 | 9/20/2016 | 11r.o.j.d | |

THIS DRAWING SUPERCEDES 24-1601-70-09-A/43.71-01

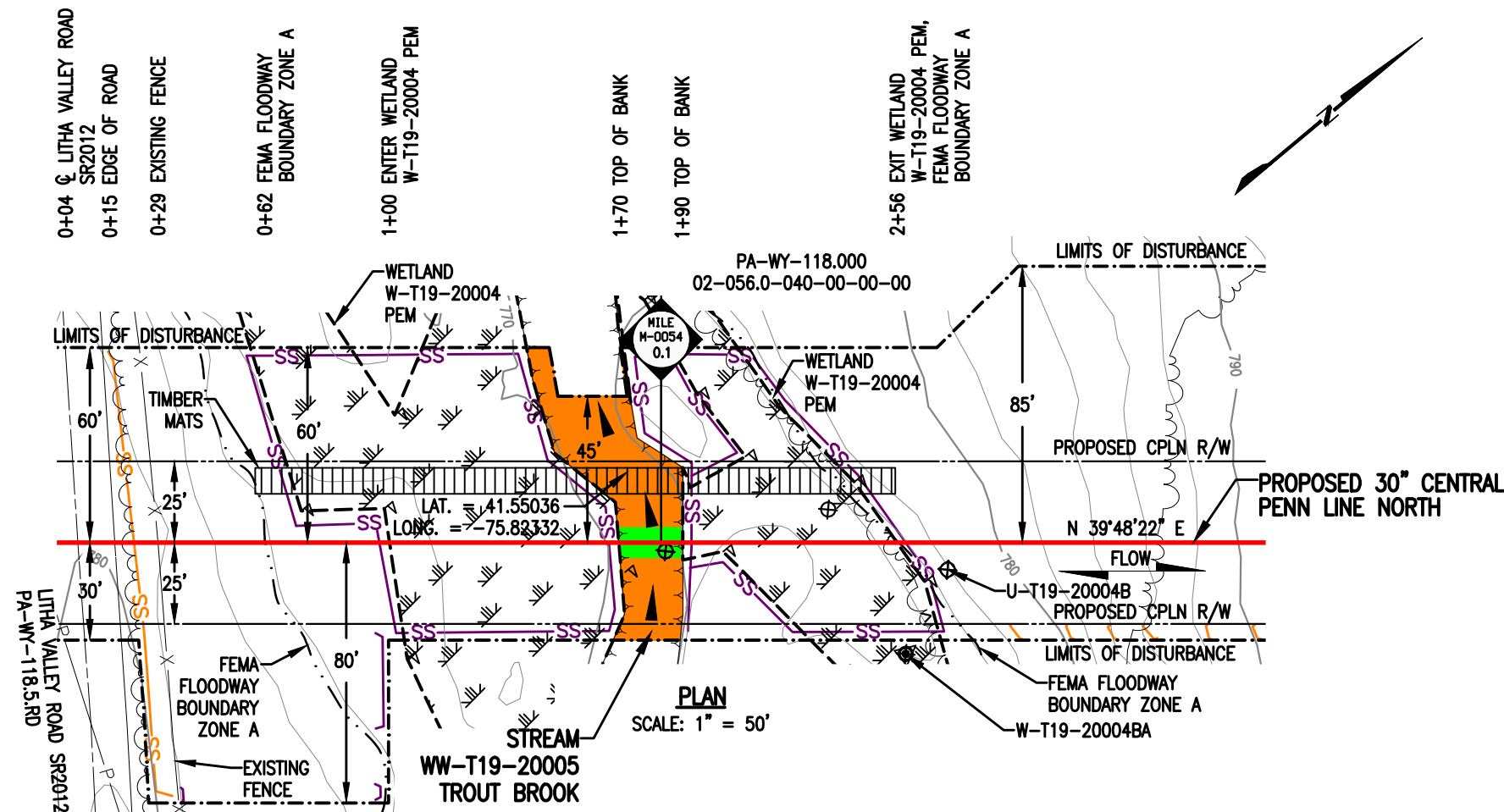

STREAM DISTURBANCE:

| | |
|--------------------------------|--------|
| STREAM WW-T19-20005 | ACRE |
| TEMPORARY STREAM DISTURBANCE | 0.0382 |
| PERMANENT STREAM DISTURBANCE | 0.0045 |
| TOTAL STREAM DISTURBANCE | 0.0427 |
| TEMPORARY FLOODWAY DISTURBANCE | 0.0993 |
| PERMANENT FLOODWAY DISTURBANCE | 0.0092 |
| TOTAL FLOODWAY DISTURBANCE | 0.1085 |

| | |
|---------------------------|-------|
| STREAM DIMENSION | FT. |
| STREAM WIDTH (TOB TO TOB) | 19.71 |
| STREAM LENGTH | 85.85 |

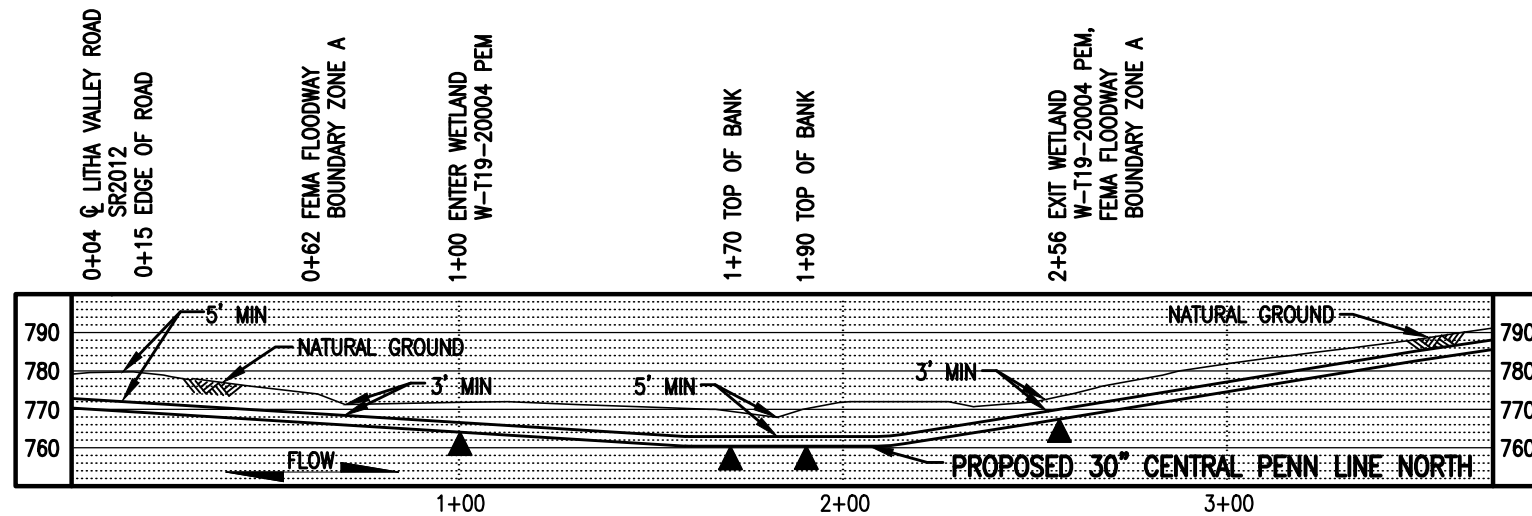

GENERAL NOTES:

1. STREAM CROSSING METHOD SHALL BE DAM AND PUMP (DPX). EQUIPMENT TO CROSS STREAM UTILIZING A BRIDGE EQUIPMENT CROSSING (BEC).
2. THIS SITE IS LOCATED WITHIN THE 100 YEAR FLOOD PLAIN PER FEMA FLOOD MAP DATA.
3. STATION 1+00 SHOWN IS EQUAL TO M-0054 STATION 4+44 ON THE EROSION AND SEDIMENT CONTROL PLAN.

SURVEY NOTES:

1. T.B.M. SURVEY CONTROL POINT - 6' RT. OF M-0054 M.P. 0.07, ELEV. = 779.17' (NAVD88).

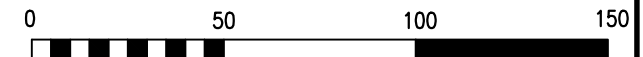

THIS DRAWING SUPERCEDES 24-1601-70-09-A/M-0054-0.10-01

LEGEND

| | | | |
|--|--------------------------------------|--|-------------------------|
| | PROPOSED 30" CENTRAL PENN LINE NORTH | | WETLAND FLAGS |
| | EXISTING PIPELINES | | PHOTO DATA POINT |
| | EXISTING TGPL R/W | | WETLAND DATA POINT |
| | LIMITS OF DISTURBANCE | | UPLAND DATA POINT |
| | PROPOSED CPLN R/W | | WELL POINT |
| | PROPERTY LINE | | TRENCH PLUG |
| | FOREIGN PIPELINE | | WATERBODY |
| | WETLAND AREA | | TREE LINE |
| | STREAM FLOW | | FLOODWAY BOUNDARY |
| | EXISTING POWER LINE | | FEMA FLOODWAY BOUNDARY |
| | EXISTING FENCE | | PERMANENT STREAM IMPACT |
| | | | TEMPORARY STREAM IMPACT |



| DRAWING NO. | REFERENCE TITLE | | | | | |
|-------------|-----------------|----|-------------------------------|----------|------|------|
| NO. | DATE | BY | REVISION DESCRIPTION | W.O. NO. | CHK. | APP. |
| 0 | 08/11/15 | AT | ISSUED FOR PADEP 105 PERMIT | 1161481 | CLR | MJH |
| 1 | 10/13/16 | AT | ISSUED FOR PADEP SUBMITTAL #2 | 1161481 | CLR | MJH |

TRANSCONTINENTAL GAS PIPE LINE COMPANY LLC
WATER OBSTRUCTION AND ENCROACHMENT PERMIT IMPACT MAPS
ATLANTIC SUNRISE PROJECT
PROPOSED 30" CENTRAL PENN LINE NORTH
STREAM CROSSING WW-T19-20005
● M-0054 M.P. 0.10
CLINTON TOWNSHIP, WYOMING COUNTY, PENNSYLVANIA

Williams

| | | | |
|------------------|----------------|--|-----------------|
| DRAWN BY: LL | DATE: 01/06/15 | ISSUED FOR BID: | SCALE: 1" = 50' |
| CHECKED BY: ML | DATE: 03/07/15 | ISSUED FOR CONSTRUCTION: | REVISION: 1 |
| APPROVED BY: MJH | DATE: 04/17/15 | DRAWING NUMBER: 24-1601-70-09-A/M-0054-0.10-02 | SHEET 1 |
| WC: 1161481 | | 4:02pm 9/20/2016 ltrc.jal | OF 1 |



October 26, 2016

Eaton Township
Floodplain Administrator
1331 Hunter Highway
P.O. Box 476
Tunkhannock, PA 18657

Re: Atlantic Sunrise Project
Central Penn Line North
Eaton Township, Wyoming County
Floodplain Management Analysis

Dear Sir or Madam:

Transcontinental Gas Pipeline Company, LLC (Transco) proposes to construct and operate the Atlantic Sunrise Project (Project) to provide 1.7 million dekatherms per day of incremental firm transportation of natural gas from the Marcellus Shale production areas in northern Pennsylvania (PA) to its existing market areas, extending to as far south as the Station 85 Pooling Point in Choctaw County, Alabama. The Project includes modifications to the existing Transco Mainline System to reverse the direction of flow, enabling new north-to-south capabilities (bi-directional flow) to transport this new source of natural gas to existing markets. The Project consists of the following primary components within PA:

- Installing greenfield pipeline facilities of approximately 58.6 miles of new 30-inch-diameter pipe from Susquehanna County, PA to Columbia County, PA.
- Installing greenfield pipeline facilities of approximately 127.3 miles of 42-inch-diameter pipe from Columbia County, PA to Lancaster County, PA.;
- Installing two pipeline loops (pipeline laid parallel to existing facilities):
 - 8.56 miles of 42-inch pipeline loop located in Lycoming County, PA known as the Unity Loop;
 - 2.50 miles of 36-inch pipeline in Clinton County, PA, known as the Chapman Loop;
- Constructing two new compressor stations, one in Wyoming County and one in Columbia County, PA;
- Additional ancillary facilities, such as mainline valves, cathodic protection, communication facilities, and internal inspection device (e.g., pig) launchers and receivers;
- Two new meter stations and three new regulator stations with interconnecting piping;
- Additional compression and related modifications to one existing compressor station; and,
- Modification to an existing meter station for use of shared facilities with a new meter station.

Transco's consultants, BL Companies and TRC Solutions (TRC), have completed an analysis of potential impacts on FEMA delineated floodways from the Project in accordance with 25 Pa. Code § 105.13. The analysis for Eaton Township is provided below for your review and comment.

**ATLANTIC SUNRISE PROJECT
FEMA FLOODPLAIN CROSSINGS
EATON TOWNSHIP, WYOMING COUNTY, PENNSYLVANIA**

| Description of Impact | Structure Type and Dimensions | Resource ID | Resource Name | Chapter 93 Classification, Wetland Classification (EV or Other), or Floodway Type | Floodway Fill (cu. yds.) | Impact area (acres) | | Latitude | Longitude |
|---------------------------|-----------------------------------|--------------|-------------------------------|---|--------------------------|---------------------|-----------|----------|-----------|
| | | | | | | Temporary | Permanent | | |
| Utility Pipeline Crossing | Equipment Access and E&S Controls | WW-T21-19001 | Floodway to Susquehanna River | FEMA Detailed ¹ | N/A | 2.0395 | 0.0958 | 41.48052 | -75.90543 |

Notes:
¹ Multiple streams are included in these calculations as the floodways overlap.

The floodway crossing listed above is depicted on the enclosed plans from the Project’s PADEP Chapter 105 Permit Application.

Please note that construction activities are not expected to create permanent loss of flood storage capacity or hydraulic capacity, as all pre-construction surface elevations will be re-established during restoration. The temporary and permanent impacts noted above are associated with vegetation management and underground pipe installation only, and do not represent a permanent modification of ground elevation or loss of flood storage capacity or hydraulic capacity. No structures are proposed within the FEMA 100-year floodplain, no fill will be placed in the floodways, and no increase in 100-year flood elevation is anticipated as a result of the proposed Project.

On behalf of Transco, BL and TRC respectfully request that Eaton Township review this analysis and, if applicable, provide comments to:

Steve Crescenzo
 TRC Environmental Corporation
 2200 Liberty Avenue, Suite 100
 Pittsburgh, PA 15222

Please do not send comments directly to the PADEP, as we must include them with our permit application. Should you have any questions or concerns regarding this notification, please contact Al Busher at (717)-651-9850 or via email at abusher@blcompanies.com.

Sincerely,



Alaric J. Busher, PE
 Senior Engineer

Enclosures: Water Obstruction and Encroachment Permit Impact Maps

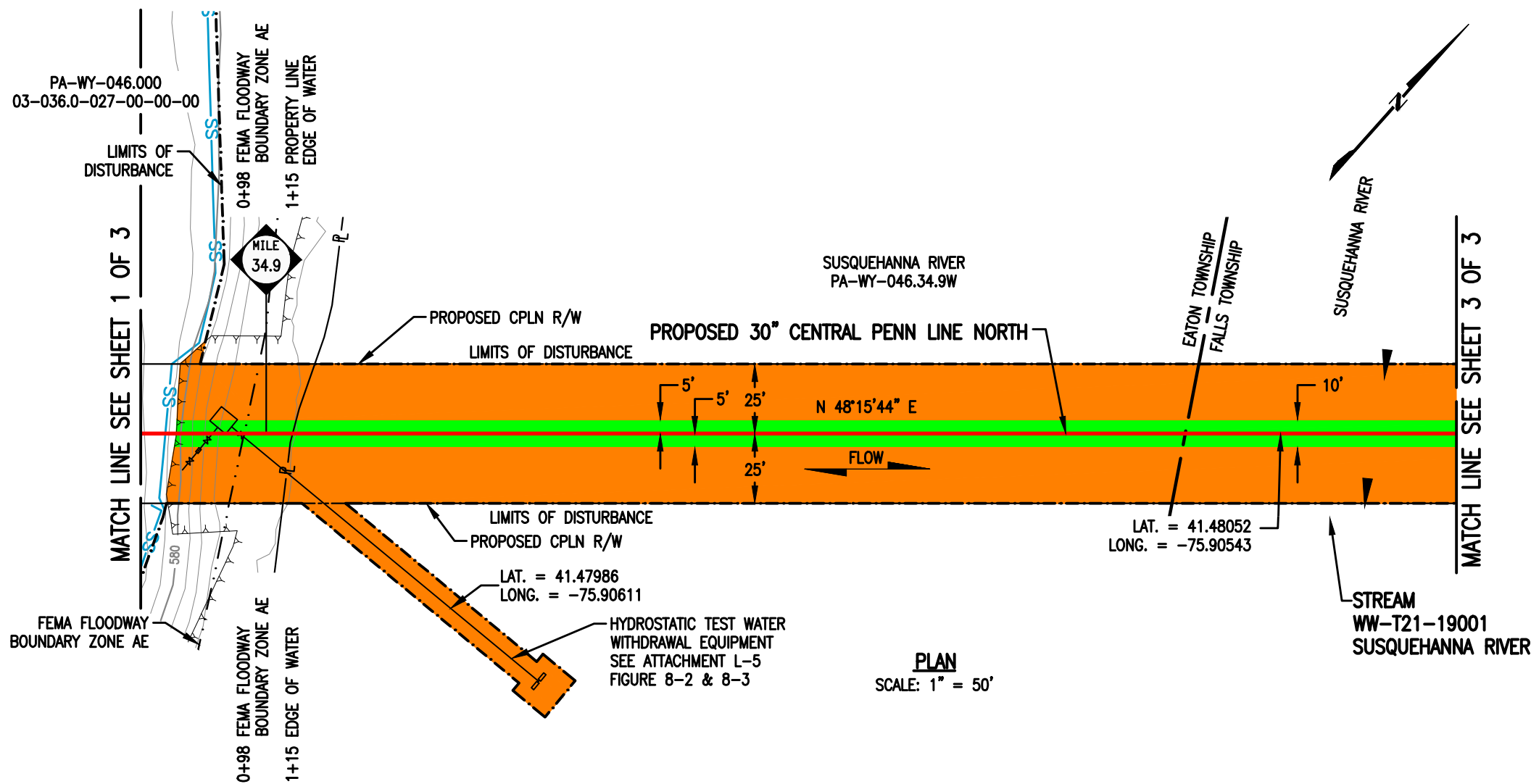

STREAM DISTURBANCE:

SEE TABLE ON PAGE 1 OF 3

STREAM DISTURBANCE FOR HYDROSTATIC TEST WATER WITHDRAWAL EQUIPMENT

| STREAM WW-T21-19001 | ACRE |
|--------------------------------|--------|
| TEMPORARY STREAM DISTURBANCE | 0.0277 |
| PERMANENT STREAM DISTURBANCE | 0.0000 |
| TOTAL STREAM DISTURBANCE | 0.0277 |
| TEMPORARY FLOODWAY DISTURBANCE | 0.0000 |
| PERMANENT FLOODWAY DISTURBANCE | 0.0000 |
| TOTAL FLOODWAY DISTURBANCE | 0.0000 |

| STREAM DIMENSION | FT. |
|---------------------------|--------|
| STREAM WIDTH (TOB TO TOB) | 798.73 |
| STREAM LENGTH | 116.28 |

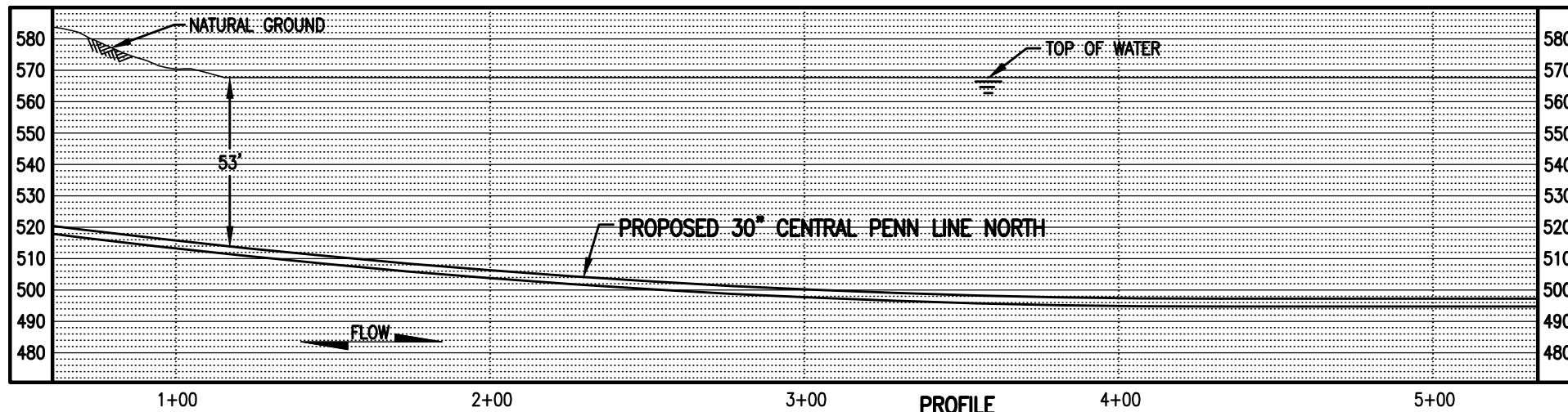

PROFILE
SCALE: 1" = 50' HORIZONTAL
1" = 50' VERTICAL

THIS DRAWING SUPERCEDES 24-1601-70-09-A/34.98-01



LEGEND

- PROPOSED 30" CENTRAL PENN LINE NORTH
- EXISTING PIPELINES
- EXISTING TGPL R/W
- - - - - LIMITS OF DISTURBANCE
- - - - - PROPOSED CPLN R/W
- PROPERTY LINE
- FOREIGN PIPELINE
- WETLAND AREA
- STREAM FLOW
- EXISTING POWER LINE
- EXISTING FENCE
- ▲ WETLAND FLAGS
- ⊗ PHOTO DATA POINT
- ⊠ WETLAND DATA POINT
- ⊡ UPLAND DATA POINT
- ☀ WELL POINT
- ▲ TRENCH PLUG
- ▲ WATERBODY
- TREE LINE
- FLOODWAY BOUNDARY
- FEMA FLOODWAY BOUNDARY
- 12" SEDIMENT BARRIER
- 18" SEDIMENT BARRIER
- 24" SEDIMENT BARRIER
- 32" SEDIMENT BARRIER
- TOP OF BANK
- PERMANENT STREAM IMPACT
- TEMPORARY STREAM IMPACT



| DRAWING NO. | REFERENCE TITLE | | | | | |
|-------------|-----------------|----|-------------------------------|----------|------|------|
| NO. | DATE | BY | REVISION DESCRIPTION | W.O. NO. | CHK. | APP. |
| 0 | 08/11/15 | TL | ISSUED FOR PADEP 105 PERMIT | 1161481 | CLR | MJH |
| 1 | 10/13/16 | CL | ISSUED FOR PADEP SUBMITTAL #2 | 1161481 | CLR | MJH |

TRANSCONTINENTAL GAS PIPE LINE COMPANY LLC
WATER OBSTRUCTION AND ENCROACHMENT PERMIT IMPACT MAPS
ATLANTIC SUNRISE PROJECT
PROPOSED 30" CENTRAL PENN LINE NORTH
STREAM CROSSINGS WW-T21-19001 @ M.P. 34.97 &
WW-T93-19001 @ M.P. 35.05
EATON & FALLS TOWNSHIPS, WYOMING COUNTY, PENNSYLVANIA

Williams

| | | | |
|------------------|----------------|--|-----------------|
| DRAWN BY: LL | DATE: 01/07/15 | ISSUED FOR BID: | SCALE: 1" = 50' |
| CHECKED BY: ML | DATE: 04/13/15 | ISSUED FOR CONSTRUCTION: | REVISION: 1 |
| APPROVED BY: MJH | DATE: 04/17/15 | DRAWING NUMBER: 24-1601-70-09-A/34.98-02 | SHEET 2 |
| IWO: 1161481 | 10/3/2016 | altraha | OF 3 |

STREAM DISTURBANCE:
SEE TABLE ON PAGE 1 OF 3

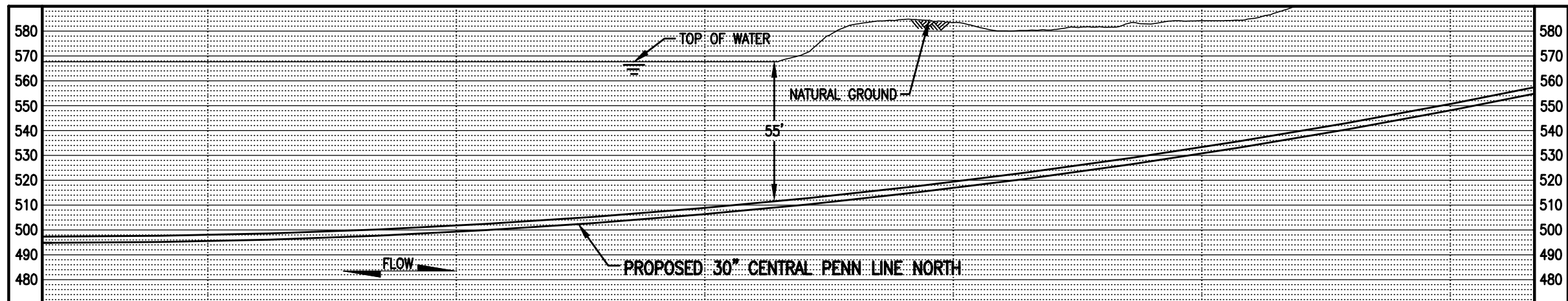
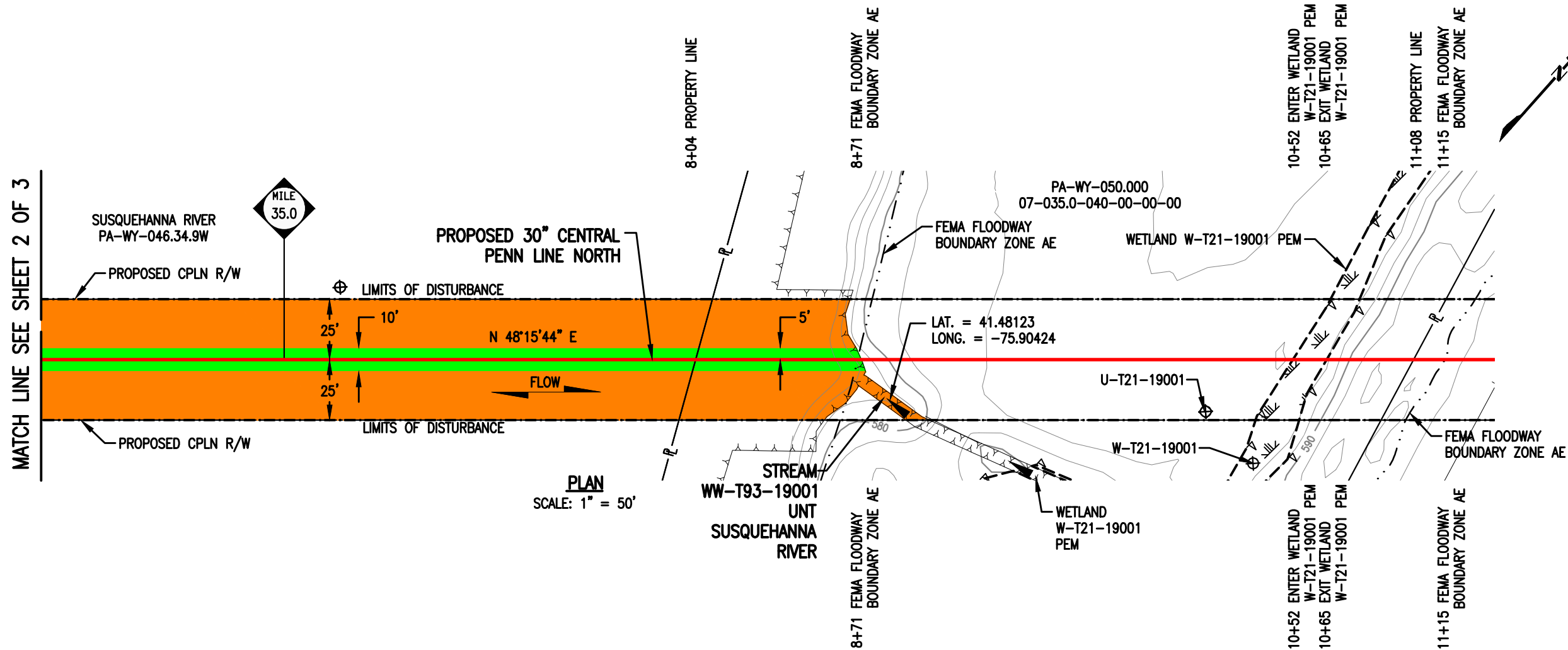

THIS DRAWING SUPERCEDES 24-1601-70-09-A/34.98-01

LEGEND

| | | | |
|--|--------------------------------------|--|-------------------------|
| | PROPOSED 30" CENTRAL PENN LINE NORTH | | WETLAND FLAGS |
| | EXISTING PIPELINES | | PHOTO DATA POINT |
| | EXISTING TGPL R/W | | WETLAND DATA POINT |
| | LIMITS OF DISTURBANCE | | UPLAND DATA POINT |
| | PROPOSED CPLN R/W | | WELL POINT |
| | PROPERTY LINE | | TRENCH PLUG |
| | FOREIGN PIPELINE | | WATERBODY |
| | WETLAND AREA | | TREE LINE |
| | STREAM FLOW | | FLOODWAY BOUNDARY |
| | EXISTING POWER LINE | | FEMA FLOODWAY BOUNDARY |
| | EXISTING FENCE | | 12" SEDIMENT BARRIER |
| | | | 18" SEDIMENT BARRIER |
| | | | 24" SEDIMENT BARRIER |
| | | | 32" SEDIMENT BARRIER |
| | | | TOP OF BANK |
| | | | PERMANENT STREAM IMPACT |
| | | | TEMPORARY STREAM IMPACT |

WOOD GROUP MUSTANG, INC.

| NO. | DATE | BY | REVISION DESCRIPTION | W.O. NO. | CHK. | APP. |
|-----|----------|----|-------------------------------|----------|------|------|
| 0 | 08/11/15 | TL | ISSUED FOR PADEP 105 PERMIT | 1161481 | CLR | MJH |
| 1 | 10/13/16 | CL | ISSUED FOR PADEP SUBMITTAL #2 | 1161481 | CLR | MJH |

TRANSCONTINENTAL GAS PIPE LINE COMPANY LLC
WATER OBSTRUCTION AND ENCROACHMENT PERMIT IMPACT MAPS
ATLANTIC SUNRISE PROJECT
PROPOSED 30" CENTRAL PENN LINE NORTH
STREAM CROSSINGS WW-T21-19001 @ M.P. 34.97 &
WW-T93-19001 @ M.P. 35.05
FALLS TOWNSHIP, WYOMING COUNTY, PENNSYLVANIA

Williams

| | | | |
|----------------------|----------------|--|-----------------|
| DRAWN BY: LL | DATE: 01/07/15 | ISSUED FOR BID: | SCALE: 1" = 50' |
| CHECKED BY: ML | DATE: 04/13/15 | ISSUED FOR CONSTRUCTION: | REVISION: 1 |
| APPROVED BY: MJH | DATE: 04/17/15 | DRAWING NUMBER: 24-1601-70-09-A/34.98-02 | SHEET 3 |
| W.O. NUMBER: 1161481 | | | OF 3 |



October 26, 2016

Nicholson Township
Floodplain Administrator
90 Padula Road
Tunkhannock, PA 18657

Re: Atlantic Sunrise Project
Central Penn Line North
Nicholson Township, Wyoming County
Floodplain Management Analysis

Dear Sir or Madam:

Transcontinental Gas Pipeline Company, LLC (Transco) proposes to construct and operate the Atlantic Sunrise Project (Project) to provide 1.7 million dekatherms per day of incremental firm transportation of natural gas from the Marcellus Shale production areas in northern Pennsylvania (PA) to its existing market areas, extending to as far south as the Station 85 Pooling Point in Choctaw County, Alabama. The Project includes modifications to the existing Transco Mainline System to reverse the direction of flow, enabling new north-to-south capabilities (bi-directional flow) to transport this new source of natural gas to existing markets. The Project consists of the following primary components within PA:

- Installing greenfield pipeline facilities of approximately 58.6 miles of new 30-inch-diameter pipe from Susquehanna County, PA to Columbia County, PA.
- Installing greenfield pipeline facilities of approximately 127.3 miles of 42-inch-diameter pipe from Columbia County, PA to Lancaster County, PA.;
- Installing two pipeline loops (pipeline laid parallel to existing facilities):
 - 8.56 miles of 42-inch pipeline loop located in Lycoming County, PA known as the Unity Loop;
 - 2.50 miles of 36-inch pipeline in Clinton County, PA, known as the Chapman Loop;
- Constructing two new compressor stations, one in Wyoming County and one in Columbia County, PA;
- Additional ancillary facilities, such as mainline valves, cathodic protection, communication facilities, and internal inspection device (e.g., pig) launchers and receivers;
- Two new meter stations and three new regulator stations with interconnecting piping;
- Additional compression and related modifications to one existing compressor station; and,
- Modification to an existing meter station for use of shared facilities with a new meter station.

Transco's consultants, BL Companies and TRC Solutions (TRC), have completed an analysis of potential impacts on FEMA delineated floodways from the Project in accordance with 25 Pa. Code § 105.13. The analysis for Nicholson Township is provided below for your review and comment.

**ATLANTIC SUNRISE PROJECT
FEMA FLOODPLAIN CROSSINGS
NICHOLSON TOWNSHIP, WYOMING COUNTY, PENNSYLVANIA**

| Description of Impact | Structure Type and Dimensions | Resource ID | Resource Name | Chapter 93 Classification, Wetland Classification (EV or Other), or Floodway Type | Floodway Fill (cu. yds.) | Impact area (acres) | | Latitude | Longitude |
|---------------------------|-----------------------------------|--------------|-------------------------------|---|--------------------------|---------------------|-----------|----------|-----------|
| | | | | | | Temporary | Permanent | | |
| Utility Pipeline Crossing | Equipment Access and E&S Controls | WW-T54-21001 | Floodway to Tunkhannock Creek | FEMA Detailed | N/A | 4.1235 | 0.3523 | 41.62682 | -75.76035 |

Notes:

¹ Multiple streams are included in these calculations as the floodways overlap.

The floodway crossing listed above is depicted on the enclosed plans from the Project's PADEP Chapter 105 Permit Application.

Please note that construction activities are not expected to create permanent loss of flood storage capacity or hydraulic capacity, as all pre-construction surface elevations will be re-established during restoration. The temporary and permanent impacts noted above are associated with vegetation management and underground pipe installation only, and do not represent a permanent modification of ground elevation or loss of flood storage capacity or hydraulic capacity. No structures are proposed within the FEMA 100-year floodplain, no fill will be placed in the floodways, and no increase in 100-year flood elevation is anticipated as a result of the proposed Project.

On behalf of Transco, BL and TRC respectfully request that Nicholson Township review this analysis and, if applicable, provide comments to:

Steve Crescenzo
TRC Environmental Corporation
2200 Liberty Avenue, Suite 100
Pittsburgh, PA 15222

Please do not send comments directly to the PADEP, as we must include them with our permit application. Should you have any questions or concerns regarding this notification, please contact Al Busher at (717)-651-9850 or via email at abusher@blcompanies.com.

Sincerely,



Alaric J. Busher, PE
Senior Engineer

Enclosures: Water Obstruction and Encroachment Permit Impact Maps

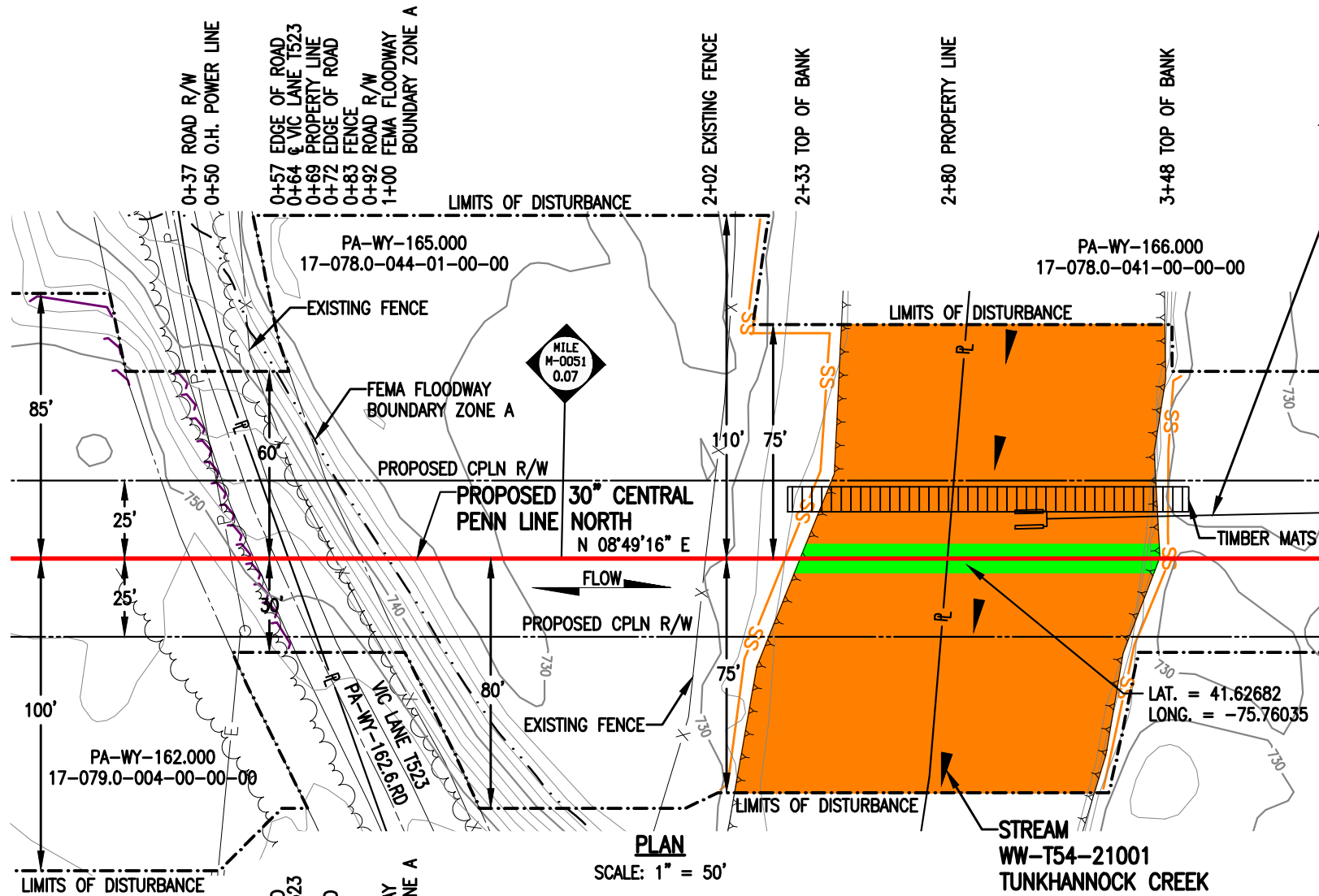

MATCH LINE SEE SHEET 2 OF 4

STREAM DISTURBANCE:

| | |
|--------------------------------|--------|
| STREAM WW-T54-21001 | ACRE |
| TEMPORARY STREAM DISTURBANCE | 0.3552 |
| PERMANENT STREAM DISTURBANCE | 0.0263 |
| TOTAL STREAM DISTURBANCE | 0.3815 |
| TEMPORARY FLOODWAY DISTURBANCE | 4.1235 |
| PERMANENT FLOODWAY DISTURBANCE | 0.3523 |
| TOTAL FLOODWAY DISTURBANCE | 4.4758 |

| | |
|---------------------------|--------|
| STREAM DIMENSION | FT. |
| STREAM WIDTH (TOB TO TOB) | 115.08 |
| STREAM LENGTH | 152.36 |

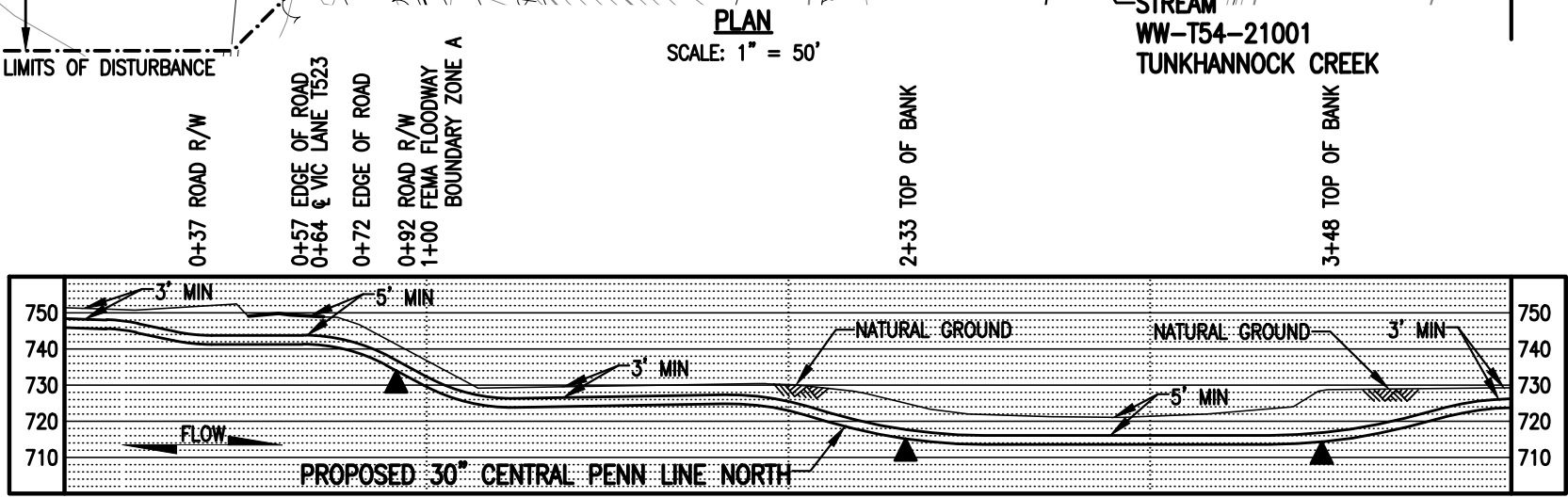

GENERAL NOTES:

1. STREAM CROSSING METHOD FOR WW-T54-21001 SHALL BE DAM AND PUMP (DPX). EQUIPMENT TO CROSS STREAM UTILIZING A BRIDGE EQUIPMENT CROSSING (BEC).
2. THIS SITE IS LOCATED WITHIN THE 100 YEAR FLOOD PLAIN PER FEMA FLOOD MAP DATA.
3. STATION 2+00 SHOWN IS EQUAL TO STATION 2640+88 ON THE EROSION AND SEDIMENT CONTROL PLAN.

SURVEY NOTES:

1. T.B.M. IRON ROD - 79.53' LT. OF M-0051 M.P. 0.04, ELEV. = 745.41' (NAVD88).



LEGEND

| | | | |
|--|--------------------------------------|--|-------------------------|
| | PROPOSED 30" CENTRAL PENN LINE NORTH | | WETLAND FLAGS |
| | EXISTING PIPELINES | | PHOTO DATA POINT |
| | EXISTING TGPL R/W | | WETLAND DATA POINT |
| | LIMITS OF DISTURBANCE | | UPLAND DATA POINT |
| | PROPOSED CPLN R/W | | WELL POINT |
| | PROPERTY LINE | | TRENCH PLUG |
| | FOREIGN PIPELINE | | WATERBODY |
| | WETLAND AREA | | TREE LINE |
| | STREAM FLOW | | FLOODWAY BOUNDARY |
| | EXISTING POWER LINE | | FEMA FLOODWAY BOUNDARY |
| | EXISTING FENCE | | 12" SEDIMENT BARRIER |
| | | | 18" SEDIMENT BARRIER |
| | | | 24" SEDIMENT BARRIER |
| | | | 32" SEDIMENT BARRIER |
| | | | TOP OF BANK |
| | | | PERMANENT STREAM IMPACT |
| | | | TEMPORARY STREAM IMPACT |

| | | | |
|-------------|----------|-----------------|--------------------------------------|
| DRAWING NO. | | REFERENCE TITLE | |
| NO. | DATE | BY | REVISION DESCRIPTION |
| 0 | 10/13/16 | DG | ISSUED FOR PADEP SUBMITTAL #21161481 |
| W.O. NO. | CHK. | APP. | |
| | CLR | MJH | |

TRANSCONTINENTAL GAS PIPE LINE COMPANY LLC
WATER OBSTRUCTION AND ENCROACHMENT PERMIT IMPACT MAPS
ATLANTIC SUNRISE PROJECT
PROPOSED 30" CENTRAL PENN LINE NORTH
STREAM CROSSING WW-T54-21001
© M-0051 M.P. 0.08
NICHOLSON TOWNSHIP, WYOMING COUNTY, PENNSYLVANIA

| | | | |
|------------------|----------------|--|-----------------|
| DRAWN BY: TL | DATE: 06/16/16 | ISSUED FOR BID: | SCALE: 1" = 50' |
| CHECKED BY: CLR | DATE: 06/28/16 | ISSUED FOR CONSTRUCTION: | REVISION: 0 |
| APPROVED BY: MJH | DATE: 06/29/16 | DRAWING NUMBER: 24-1601-70-09-A/M-0051-0.08-01 | SHEET 1 |
| WC: 1161481 | | 10/20/2016 | OF 4 |

STREAM DISTURBANCE:
SEE TABLE ON SHEET 1 OF 4

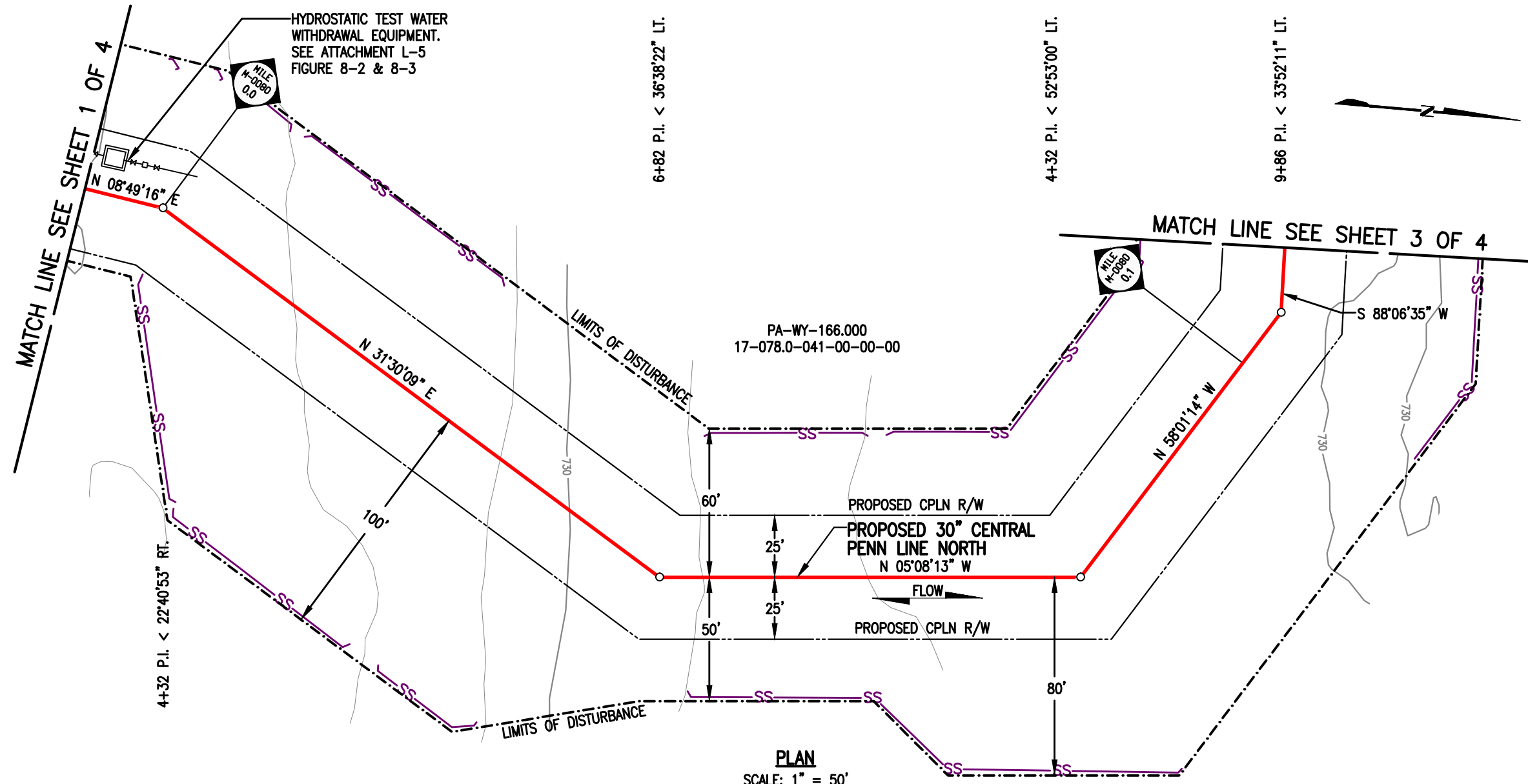

PLAN
SCALE: 1" = 50'

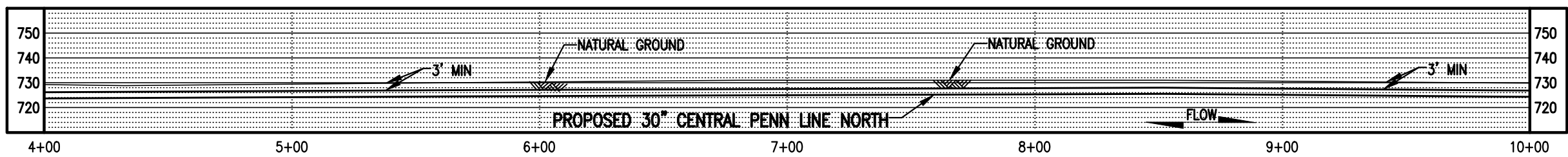

PROFILE
SCALE: 1" = 50' HORIZONTAL
1" = 50' VERTICAL



| LEGEND | |
|--------|--------------------------------------|
| | PROPOSED 30" CENTRAL PENN LINE NORTH |
| | EXISTING PIPELINES |
| | EXISTING TGPL R/W |
| | LIMITS OF DISTURBANCE |
| | PROPOSED CPLN R/W |
| | PROPERTY LINE |
| | FOREIGN PIPELINE |
| | WETLAND AREA |
| | STREAM FLOW |
| | EXISTING POWER LINE |
| | EXISTING FENCE |
| | WETLAND FLAGS |
| | PHOTO DATA POINT |
| | WETLAND DATA POINT |
| | UPLAND DATA POINT |
| | WELL POINT |
| | TRENCH PLUG |
| | WATERBODY |
| | TREE LINE |
| | FLOODWAY BOUNDARY |
| | FEMA FLOODWAY BOUNDARY |
| | 12" SEDIMENT BARRIER |
| | 18" SEDIMENT BARRIER |
| | 24" SEDIMENT BARRIER |
| | 32" SEDIMENT BARRIER |
| | PERMANENT STREAM IMPACT |
| | TEMPORARY STREAM IMPACT |

WOOD GROUP MUSTANG, INC.

| DRAWING NO. | REFERENCE TITLE | | | | | |
|-------------|-----------------|----|--------------------------------------|----------|------|------|
| NO. | DATE | BY | REVISION DESCRIPTION | W.O. NO. | CHK. | APP. |
| 0 | 10/13/16 | DG | ISSUED FOR PADEP SUBMITTAL #21161481 | CLR | MJH | |

TRANSCONTINENTAL GAS PIPE LINE COMPANY LLC
WATER OBSTRUCTION AND ENCROACHMENT PERMIT IMPACT MAPS
ATLANTIC SUNRISE PROJECT
PROPOSED 30" CENTRAL PENN LINE NORTH
STREAM CROSSING WW-T54-21001
● M-0051 M.P. 0.08
NICHOLSON TOWNSHIP, WYOMING COUNTY, PENNSYLVANIA

Williams

| | | | |
|------------------|----------------|--|-----------------|
| DRAWN BY: TL | DATE: 06/16/16 | ISSUED FOR BID: | SCALE: 1" = 50' |
| CHECKED BY: CLR | DATE: 06/28/16 | ISSUED FOR CONSTRUCTION: | REVISION: 0 |
| APPROVED BY: MJH | DATE: 06/29/16 | DRAWING NUMBER: 24-1601-70-09-A/M-0051-0.08-01 | SHEET 2 |
| WC: 1161481 | 10/19/2016 | 1:56pm | OF 4 |

STREAM DISTURBANCE:
SEE TABLE ON SHEET 1 OF 4

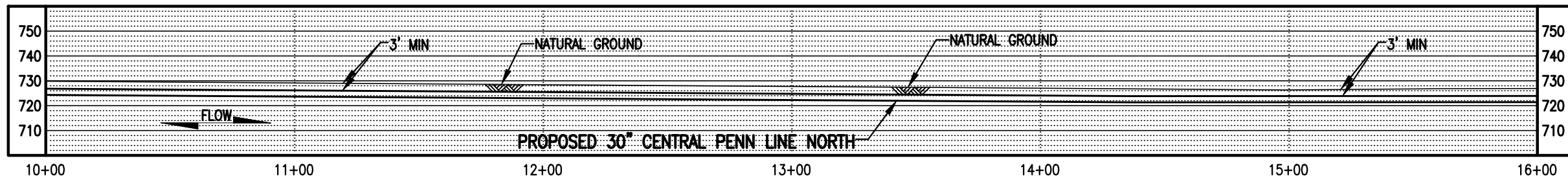
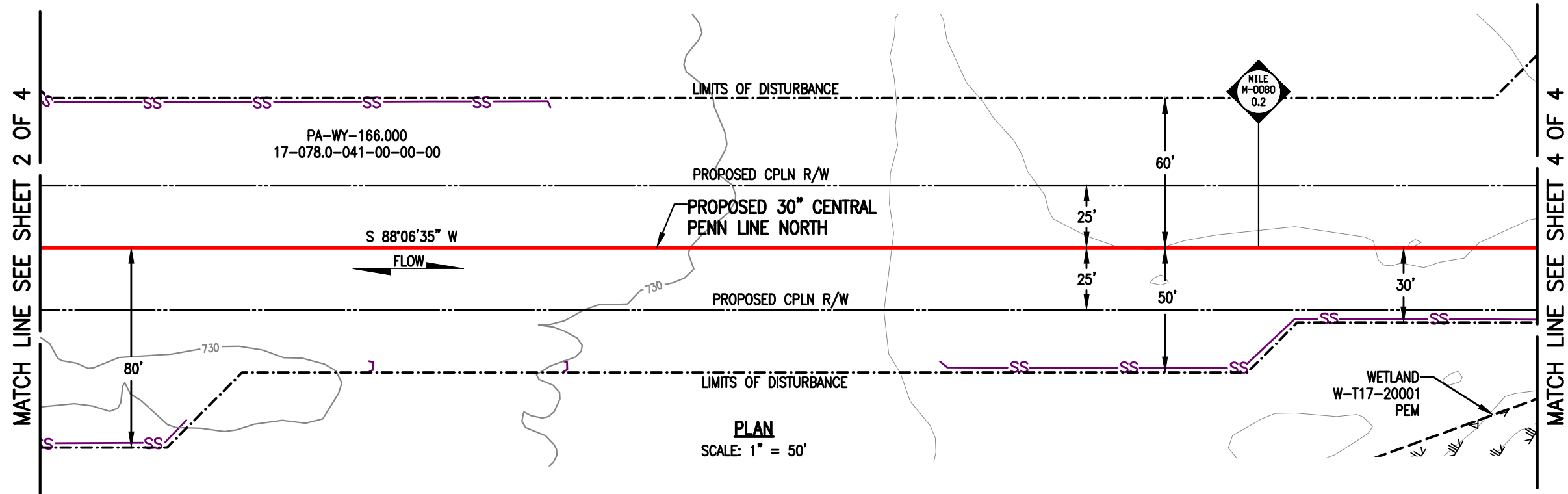

PROFILE
SCALE: 1" = 50' HORIZONTAL
1" = 50' VERTICAL



| LEGEND | | WOOD GROUP MUSTANG, INC. | |
|--------|--------------------------------------|--------------------------|-------------------------|
| | PROPOSED 30" CENTRAL PENN LINE NORTH | | WETLAND FLAGS |
| | EXISTING PIPELINES | | PHOTO DATA POINT |
| | EXISTING TGPL R/W | | WETLAND DATA POINT |
| | LIMITS OF DISTURBANCE | | UPLAND DATA POINT |
| | PROPOSED CPLN R/W | | WELL POINT |
| | PROPERTY LINE | | TRENCH PLUG |
| | FOREIGN PIPELINE | | WATERBODY |
| | WETLAND AREA | | TREE LINE |
| | STREAM FLOW | | FLOODWAY BOUNDARY |
| | EXISTING POWER LINE | | FEMA FLOODWAY BOUNDARY |
| | EXISTING FENCE | | PERMANENT STREAM IMPACT |
| | | | TEMPORARY STREAM IMPACT |

| DRAWING NO. | | REFERENCE TITLE | |
|-------------|----------|-----------------|--------------------------------------|
| NO. | DATE | BY | REVISION DESCRIPTION |
| 0 | 10/13/16 | DG | ISSUED FOR PADEP SUBMITTAL #21161481 |

TRANSCONTINENTAL GAS PIPE LINE COMPANY LLC
WATER OBSTRUCTION AND ENCROACHMENT PERMIT IMPACT MAPS
ATLANTIC SUNRISE PROJECT
PROPOSED 30" CENTRAL PENN LINE NORTH
STREAM CROSSING WW-T54-21001
M-0051 M.P. 0.08
NICHOLSON TOWNSHIP, WYOMING COUNTY, PENNSYLVANIA

Williams

| | | | |
|------------------|----------------|--|-----------------|
| DRAWN BY: TL | DATE: 06/16/16 | ISSUED FOR BID: | SCALE: 1" = 50' |
| CHECKED BY: CLR | DATE: 06/28/16 | ISSUED FOR CONSTRUCTION: | REVISION: 0 |
| APPROVED BY: MJH | DATE: 06/29/16 | DRAWING NUMBER: 24-1601-70-09-A/M-0051-0.08-01 | SHEET 3 |
| WC: 1161481 | | 10/19/2016 | OF 4 |

STREAM DISTURBANCE:
SEE TABLE ON SHEET 1 OF 4

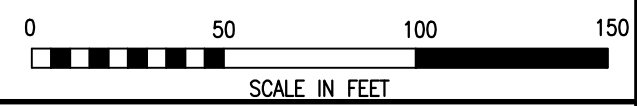
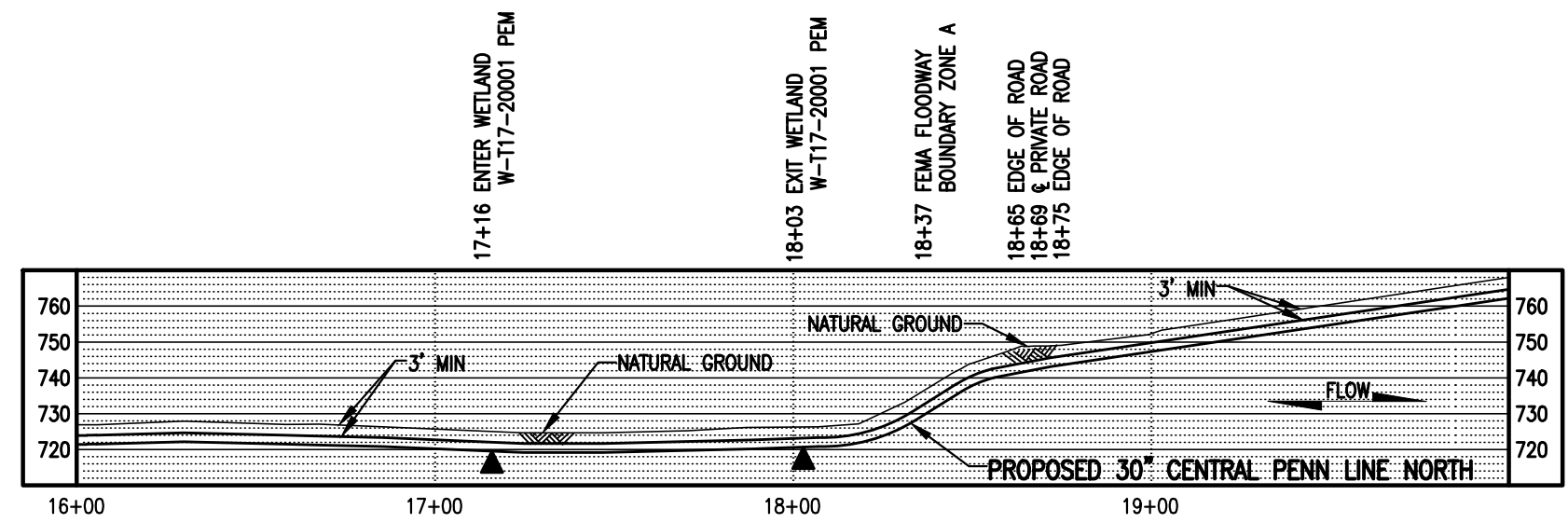
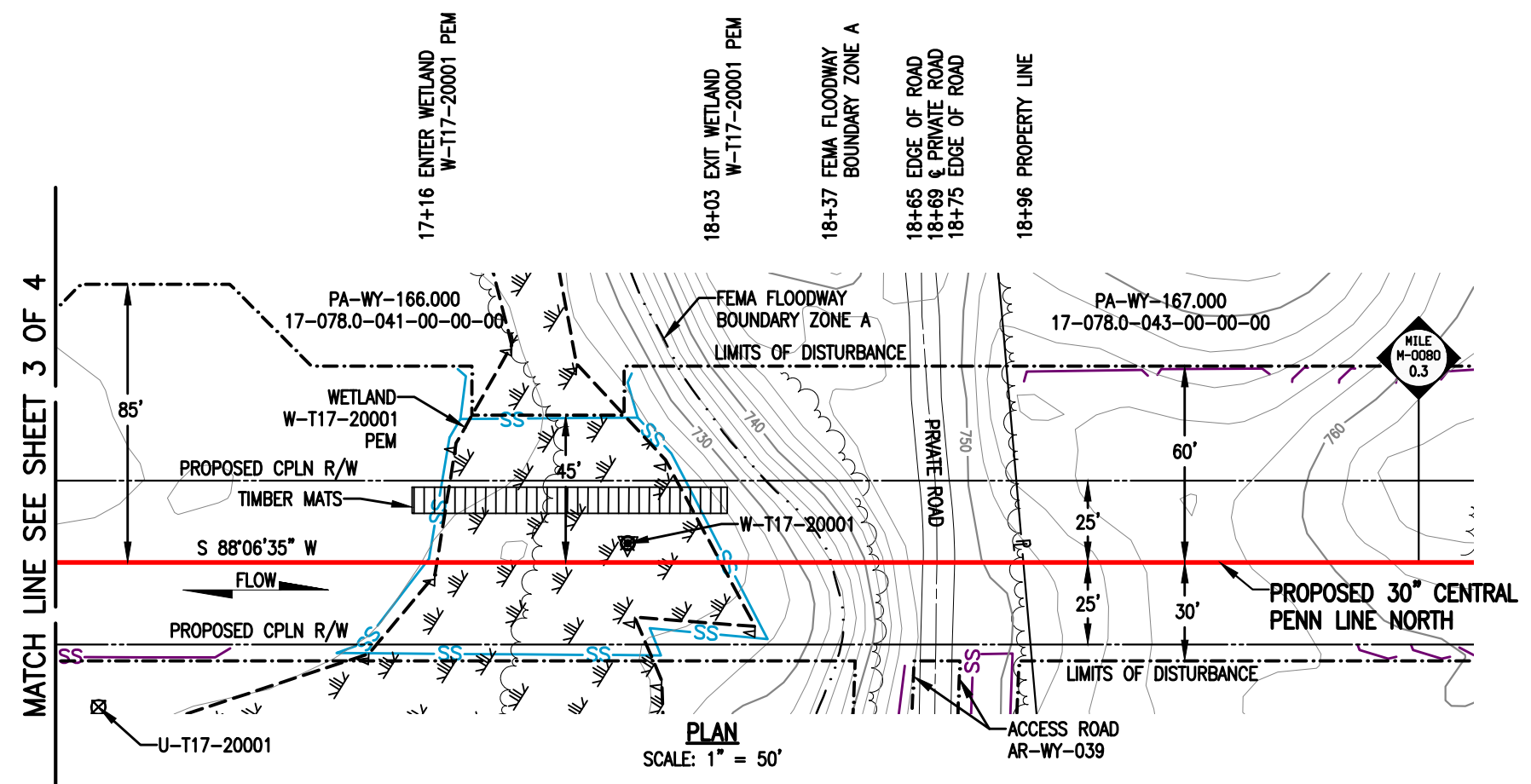

| LEGEND | | WOOD GROUP MUSTANG, INC. | |
|--------|--------------------------------------|--------------------------|-------------------------|
| | PROPOSED 30" CENTRAL PENN LINE NORTH | | WETLAND FLAGS |
| | EXISTING PIPELINES | | PHOTO DATA POINT |
| | EXISTING TGPL R/W | | WETLAND DATA POINT |
| | LIMITS OF DISTURBANCE | | UPLAND DATA POINT |
| | PROPOSED CPLN R/W | | WELL POINT |
| | PROPERTY LINE | | TRENCH PLUG |
| | FOREIGN PIPELINE | | WATERBODY |
| | WETLAND AREA | | TREE LINE |
| | STREAM FLOW | | FLOODWAY BOUNDARY |
| | EXISTING POWER LINE | | FEMA FLOODWAY BOUNDARY |
| | EXISTING FENCE | | PERMANENT STREAM IMPACT |
| | | | TEMPORARY STREAM IMPACT |

| DRAWING NO. | REFERENCE TITLE |
|-------------|-----------------|
| | |

| NO. | DATE | BY | REVISION DESCRIPTION | W.O. NO. | CHK. | APP. |
|-----|----------|----|--------------------------------------|----------|------|------|
| 0 | 10/13/16 | DG | ISSUED FOR PADEP SUBMITTAL #21161481 | CLR | MJH | |

TRANSCONTINENTAL GAS PIPE LINE COMPANY LLC
 WATER OBSTRUCTION AND ENCROACHMENT PERMIT IMPACT MAPS
 ATLANTIC SUNRISE PROJECT
 PROPOSED 30" CENTRAL PENN LINE NORTH
 STREAM CROSSING WW-T54-21001
 M-0051 M.P. 0.08
 NICHOLSON TOWNSHIP, WYOMING COUNTY, PENNSYLVANIA

Williams

| | | | |
|------------------|----------------|--|-----------------|
| DRAWN BY: TL | DATE: 06/16/16 | ISSUED FOR BID: | SCALE: 1" = 50' |
| CHECKED BY: CLR | DATE: 06/28/16 | ISSUED FOR CONSTRUCTION: | REVISION: 0 |
| APPROVED BY: MJH | DATE: 06/29/16 | DRAWING NUMBER: 24-1601-70-09-A/M-0051-0.08-01 | SHEET 4 |
| WC: 1161481 | | 10/19/2016 | OF 4 |



October 26, 2016

Northmoreland Township
Floodplain Administrator
15 Municipal Lane
Dallas, PA 18612

Re: Atlantic Sunrise Project
Central Penn Line North
Northmoreland Township, Wyoming County
Floodplain Management Analysis

Dear Sir or Madam:

Transcontinental Gas Pipeline Company, LLC (Transco) proposes to construct and operate the Atlantic Sunrise Project (Project) to provide 1.7 million dekatherms per day of incremental firm transportation of natural gas from the Marcellus Shale production areas in northern Pennsylvania (PA) to its existing market areas, extending to as far south as the Station 85 Pooling Point in Choctaw County, Alabama. The Project includes modifications to the existing Transco Mainline System to reverse the direction of flow, enabling new north-to-south capabilities (bi-directional flow) to transport this new source of natural gas to existing markets. The Project consists of the following primary components within PA:

- Installing greenfield pipeline facilities of approximately 58.6 miles of new 30-inch-diameter pipe from Susquehanna County, PA to Columbia County, PA.
- Installing greenfield pipeline facilities of approximately 127.3 miles of 42-inch-diameter pipe from Columbia County, PA to Lancaster County, PA.;
- Installing two pipeline loops (pipeline laid parallel to existing facilities):
 - 8.56 miles of 42-inch pipeline loop located in Lycoming County, PA known as the Unity Loop;
 - 2.50 miles of 36-inch pipeline in Clinton County, PA, known as the Chapman Loop;
- Constructing two new compressor stations, one in Wyoming County and one in Columbia County, PA;
- Additional ancillary facilities, such as mainline valves, cathodic protection, communication facilities, and internal inspection device (e.g., pig) launchers and receivers;
- Two new meter stations and three new regulator stations with interconnecting piping;
- Additional compression and related modifications to one existing compressor station; and,
- Modification to an existing meter station for use of shared facilities with a new meter station.

Transco's consultants, BL Companies and TRC Solutions (TRC), have completed an analysis of potential impacts on FEMA delineated floodways from the Project in accordance with 25 Pa. Code § 105.13. The analysis for Northmoreland Township is provided below for your review and comment.

**ATLANTIC SUNRISE PROJECT
FEMA FLOODPLAIN CROSSINGS
NORTHMORELAND TOWNSHIP, WYOMING COUNTY, PENNSYLVANIA**

| Description of Impact | Structure Type and Dimensions | Resource ID | Resource Name | Chapter 93 Classification, Wetland Classification (EV or Other), or Floodway Type | Floodway Fill (cu. yds.) | Impact area (acres) | | Latitude | Longitude |
|---------------------------|-----------------------------------|--------------|------------------------|---|--------------------------|---------------------|-----------|----------|-----------|
| | | | | | | Temporary | Permanent | | |
| Utility Pipeline Crossing | Equipment Access and E&S Controls | WW-T05-18001 | Floodway to Mill Creek | FEMA Detailed ¹ | N/A | 0.8285 | 0.1110 | 41.43833 | -75.93058 |

Notes:

¹ Multiple streams are included in these calculations as the floodways overlap.

The floodway crossing listed above is depicted on the enclosed plans from the Project's PADEP Chapter 105 Permit Application.

Please note that construction activities are not expected to create permanent loss of flood storage capacity or hydraulic capacity, as all pre-construction surface elevations will be re-established during restoration. The temporary and permanent impacts noted above are associated with vegetation management and underground pipe installation only, and do not represent a permanent modification of ground elevation or loss of flood storage capacity or hydraulic capacity. No structures are proposed within the FEMA 100-year floodplain, no fill will be placed in the floodways, and no increase in 100-year flood elevation is anticipated as a result of the proposed Project.

On behalf of Transco, BL and TRC respectfully request that Northmoreland Township review this analysis and, if applicable, provide comments to:

Steve Crescenzo
TRC Environmental Corporation
2200 Liberty Avenue, Suite 100
Pittsburgh, PA 15222

Please do not send comments directly to the PADEP, as we must include them with our permit application. Should you have any questions or concerns regarding this notification, please contact Al Busher at (717)-651-9850 or via email at abusher@blcompanies.com.

Sincerely,



Alaric J. Busher, PE
Senior Engineer

Enclosures: Water Obstruction and Encroachment Permit Impact Maps

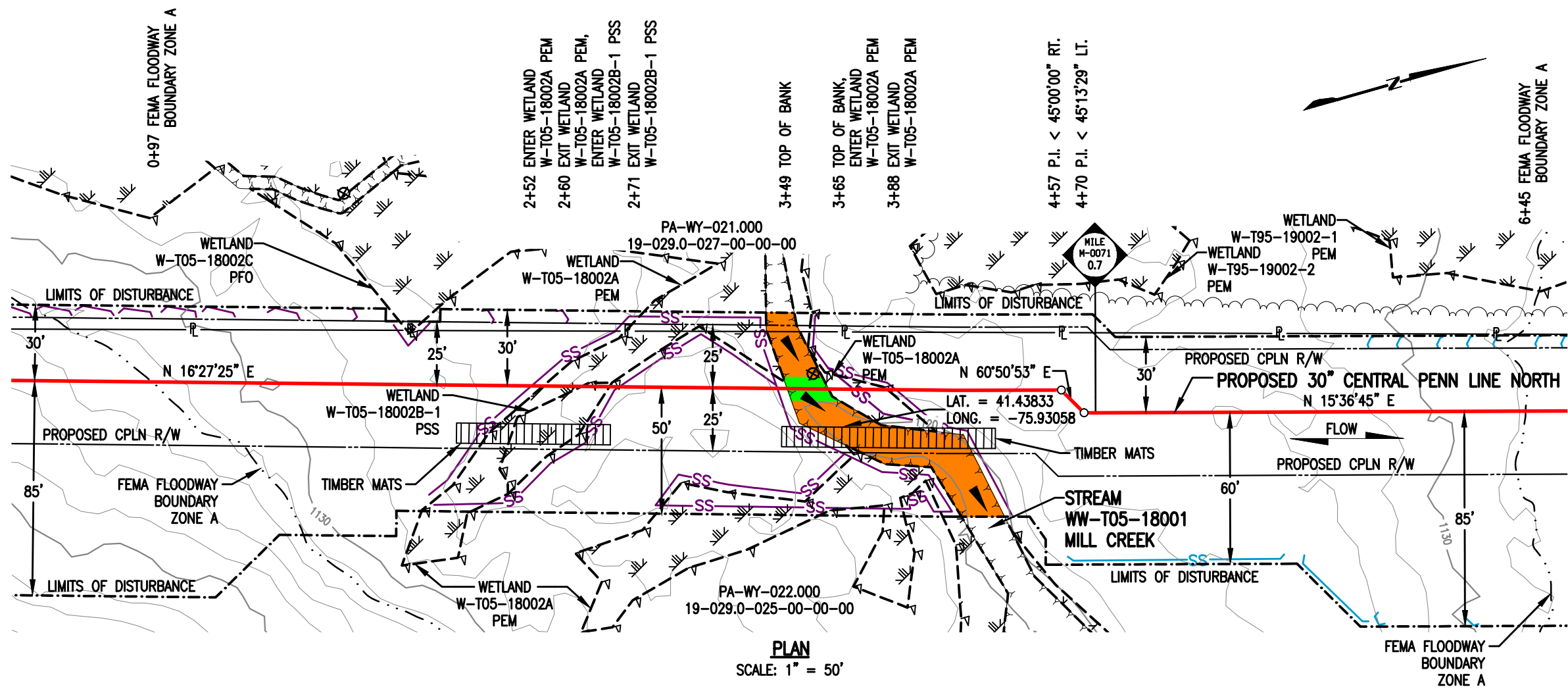

PLAN
SCALE: 1" = 50'

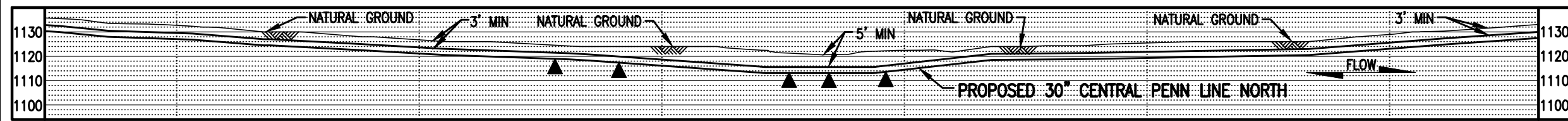

PROFILE
SCALE: 1" = 50' HORIZONTAL
1" = 50' VERTICAL

STREAM DISTURBANCE:

| | |
|--------------------------------|--------|
| STREAM WW-T05-18001 | ACRE |
| TEMPORARY STREAM DISTURBANCE | 0.0383 |
| PERMANENT STREAM DISTURBANCE | 0.0038 |
| TOTAL STREAM DISTURBANCE | 0.0421 |
| TEMPORARY FLOODWAY DISTURBANCE | 0.8285 |
| PERMANENT FLOODWAY DISTURBANCE | 0.1110 |
| TOTAL FLOODWAY DISTURBANCE | 0.9395 |

| | |
|---------------------------|--------|
| STREAM DIMENSION | FT. |
| STREAM WIDTH (TOB TO TOB) | 16.34 |
| STREAM LENGTH | 118.60 |

GENERAL NOTES:

1. STREAM CROSSING METHOD SHALL BE DAM AND PUMP (DPX). EQUIPMENT TO CROSS STREAM UTILIZING A BRIDGE EQUIPMENT CROSSING (BEC).
2. THIS IS LOCATED WITHIN THE 100 YEAR FLOOD PLAIN PER FEMA FLOOD MAP DATA.
3. STATION 1+00 IS EQUAL TO STATION M-0071 33+22 ON THE EROSION AND SEDIMENT CONTROL PLAN.

SURVEY NOTES:

1. T.B.M. SURVEY CONTROL POINT - 53' LT. OF M-0071 M.P. 0.67, ELEV. = 1123.77' (NAVD88).

LEGEND

| | | | |
|--|--------------------------------------|--|------------------------|
| | PROPOSED 30" CENTRAL PENN LINE NORTH | | WETLAND FLAGS |
| | EXISTING PIPELINES | | PHOTO DATA POINT |
| | EXISTING TGPL R/W | | WETLAND DATA POINT |
| | LIMITS OF DISTURBANCE | | UPLAND DATA POINT |
| | PROPOSED CPLN R/W | | WELL POINT |
| | PROPERTY LINE | | TRENCH PLUG |
| | FOREIGN PIPELINE | | WATERBODY |
| | WETLAND AREA | | TREE LINE |
| | STREAM FLOW | | FLOODWAY BOUNDARY |
| | EXISTING POWER LINE | | FEMA FLOODWAY BOUNDARY |
| | EXISTING FENCE | | |

WOOD GROUP MUSTANG, INC.

| | | | |
|--|----------------------|--|-------------------------|
| | 12" SEDIMENT BARRIER | | PERMANENT STREAM IMPACT |
| | 18" SEDIMENT BARRIER | | TEMPORARY STREAM IMPACT |
| | 24" SEDIMENT BARRIER | | |
| | 32" SEDIMENT BARRIER | | |
| | TOP OF BANK | | |

| | | | | | |
|-------------------|----------|-----------------|--|--|-----------|
| DRAWING NO. | | REFERENCE TITLE | | TRANSCONTINENTAL GAS PIPE LINE COMPANY LLC WATER OBSTRUCTION AND ENCROACHMENT PERMIT IMPACT MAPS ATLANTIC SUNRISE PROJECT PROPOSED 30" CENTRAL PENN LINE NORTH STREAM CROSSING WW-T05-18001 M-0071 M.P. 0.68 NORTHMORELAND TOWNSHIP, WYOMING COUNTY, PENNSYLVANIA | |
| NO. | DATE | BY | REVISION DESCRIPTION | W.O. NO. | CHK. APP. |
| 0 | 02/03/16 | TL | ISSUED FOR INTERNAL USE | 1161481 | CLR MJH |
| 1 | 10/13/16 | AT | ISSUED FOR PADEP SUBMITTAL #2 | 1161481 | CLR MJH |
| DRAWN BY: LL | | DATE: 03/06/15 | ISSUED FOR BID: | SCALE: 1" = 50' | |
| CHECKED BY: ML | | DATE: 04/13/15 | ISSUED FOR CONSTRUCTION: | REVISION: 1 | |
| APPROVED BY: MJH | | DATE: 04/17/15 | DRAWING NUMBER: 24-1601-70-09-A/M-0071-0.68-01 | SHEET 1 | |
| W.O. NO.: 1161481 | | DATE: 9/20/2016 | FILE: 1161481.dwg | OF 1 | |



October 27, 2016

Dear Customer:

The following is the proof-of-delivery for tracking number **690511409243**.

Delivery Information:

| | | | |
|--------------------------|--------------------------|---------------------------|---|
| Status: | Delivered | Delivered to: | Receptionist/Front Desk |
| Signed for by: | R.JOHNSON | Delivery location: | CLINTON TOWNSHIP MUNICIPAL BUI FACTORYVILLE, PA 18419 |
| Service type: | FedEx Priority Overnight | Delivery date: | Oct 27, 2016 11:17 |
| Special Handling: | Deliver Weekday | | |



Shipping Information:

| | | | |
|-------------------------|--------------|-------------------|----------------|
| Tracking number: | 690511409243 | Ship date: | Oct 26, 2016 |
| | | Weight: | 0.5 lbs/0.2 kg |

Recipient:
FLOODPLAIN ADMINISTRATOR
CLINTON TOWNSHIP
CLINTON TOWNSHIP MUNICIPAL BUILDING
RR1 CREEK ROAD
FACTORYVILLE, PA 18419 US

Reference
Purchase order number:
Department number

Shipper:
SUSAN MCDOWELL
BLCOMPANIES, INC.
355 RESEARCH PARKWAY
Meriden, CT 06450 US

14C4909-B
BUSHER/CPLN CH105 CONSISTENCY
CIVIL

Thank you for choosing FedEx.



October 27, 2016

Dear Customer:

The following is the proof-of-delivery for tracking number **690511409221**.

Delivery Information:

| | | | |
|--------------------------|---|---------------------------|--|
| Status: | Delivered | Delivered to: | Residence |
| Signed for by: | Signature not required | Delivery location: | 1331 HUNTER HIGHWAY TUNKHANNOCK, PA 18657 |
| Service type: | FedEx Priority Overnight | Delivery date: | Oct 27, 2016 11:33 |
| Special Handling: | Deliver Weekday Residential Delivery | | |

NO SIGNATURE REQUIRED

Proof-of-delivery details appear below; however, no signature is available for this FedEx Express shipment because a signature was not required.

Shipping Information:

| | | | |
|-------------------------|--------------|-------------------|----------------|
| Tracking number: | 690511409221 | Ship date: | Oct 26, 2016 |
| | | Weight: | 0.5 lbs/0.2 kg |

Recipient:
FLOODPLAIN ADMINISTRATOR
EATON TOWNSHIP
1331 HUNTER HIGHWAY
TUNKHANNOCK, PA 18657 US

Reference
Purchase order number:
Department number

Shipper:
SUSAN MCDOWELL
BLCOMPANIES, INC.
355 RESEARCH PARKWAY
Meriden, CT 06450 US

14C4909-B
BUSER/CPLN CH105 CONSISTENCY
CIVIL

Thank you for choosing FedEx.



October 27, 2016

Dear Customer:

The following is the proof-of-delivery for tracking number **690511409254**.

Delivery Information:

| | | | |
|--------------------------|---|---------------------------|---|
| Status: | Delivered | Delivered to: | Residence |
| Signed for by: | Signature not required | Delivery location: | 90 PADULA ROAD TUNKHANNOCK, PA 18657 |
| Service type: | FedEx Priority Overnight | Delivery date: | Oct 27, 2016 12:53 |
| Special Handling: | Deliver Weekday Residential Delivery | | |

NO SIGNATURE REQUIRED

Proof-of-delivery details appear below; however, no signature is available for this FedEx Express shipment because a signature was not required.

Shipping Information:

| | | | |
|-------------------------|--------------|-------------------|----------------|
| Tracking number: | 690511409254 | Ship date: | Oct 26, 2016 |
| | | Weight: | 0.5 lbs/0.2 kg |

Recipient:

FLOODPLAIN ADMINISTRATOR
NICHOLSON TOWNSHIP
90 PADULA ROAD
TUNKHANNOCK, PA 18657 US

Reference

Purchase order number:
Department number

Shipper:

SUSAN MCDOWELL
BLCOMPANIES, INC.
355 RESEARCH PARKWAY
Meriden, CT 06450 US

14C4909-B

BUSHER/CPLN CH105 CONSISTENCY
CIVIL

Thank you for choosing FedEx.



October 27,2016

Dear Customer:

The following is the proof-of-delivery for tracking number **690511409210**.

Delivery Information:

| | | | |
|--------------------------|--------------------------|---------------------------|-------------------------------------|
| Status: | Delivered | Delivered to: | Receptionist/Front Desk |
| Signed for by: | J.JUDY | Delivery location: | 15 MUNICIPAL LN DALLAS, PA 18612 |
| Service type: | FedEx Priority Overnight | Delivery date: | Oct 27, 2016 11:11 |
| Special Handling: | Deliver Weekday | | |

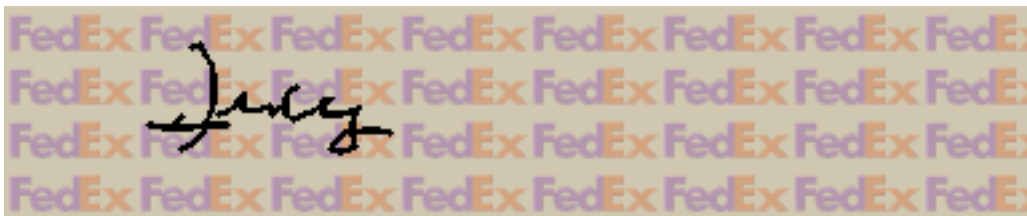

Shipping Information:

| | | | |
|-------------------------|--------------|-------------------|----------------|
| Tracking number: | 690511409210 | Ship date: | Oct 26, 2016 |
| | | Weight: | 0.5 lbs/0.2 kg |

Recipient:
FLOODPLAIN ADMINISTRATOR
NORTHMORELAND TOWNSHIP
15 MUNICIPAL LANE
DALLAS, PA 18612 US

Reference
Purchase order number:
Department number

Shipper:
SUSAN MCDOWELL
BLCOMPANIES, INC.
355 RESEARCH PARKWAY
Meriden, CT 06450 US
14C4909-B
BUSER/CPLN CH105 CONSISTENCY
CIVIL

Thank you for choosing FedEx.