

*Atlantic Sunrise Project – PA DEP Chapter 105 Joint Permit Application
Transcontinental Gas Pipe Line Company, LLC
Lancaster County*

ATTACHMENT H -3
HDD AND CONVENTIONAL BORE CONTINGENCIES
CHAPTER 105 IMPACT MAPPING
(UNDER SEPARATE COVER)

Revised April 2017

Note: This Attachment has been replaced in its entirety

ATTACHMENT H-3
CONTINGENCY PLAN SET
LANCASTER COUNTY



Transcontinental Gas Pipe Line Company LLC
ATLANTIC SUNRISE PROJECT
PROPOSED 42" CENTRAL PENN LINE SOUTH
CONTINGENCY PLAN IMPACT MAPS

M.P. 0.00 TO M.P. 36.51

LANCASTER COUNTY, PENNSYLVANIA

DRAWING NUMBER	DESCRIPTION	SHEET	REVISION
24-1600-70-09A-A/11.00-01	WW-T35-1002A	1 OF 1	0
24-1600-70-20A-A/11.00-01	W-T35-1001	1 OF 1	0
24-1600-70-09A-A/20.81-01	WW-T10-2005	1 OF 1	0

24-1600-70-09A-A-01_Lancaster-PKG
Issued for PADEP Submittal #3
Rev. 0
04-12-2017

ISSUED DATE: APRIL 12, 2017



Transcontinental Gas Pipe Line Company LLC
ATLANTIC SUNRISE PROJECT
PROPOSED 42" CENTRAL PENN LINE SOUTH
CONTINGENCY PLAN IMPACT MAPS

M.P. 0.00 TO M.P. 36.51

LANCASTER COUNTY, PENNSYLVANIA

DRAWING NUMBER	DESCRIPTION	SHEET	REVISION
24-1600-70-09A-A/11.00-01	WW-T35-1002A	1 OF 1	0
24-1600-70-20A-A/11.00-01	W-T35-1001	1 OF 1	0
24-1600-70-09A-A/20.81-01	WW-T10-2005	1 OF 1	0

ISSUED FOR PADEP SUBMITTAL #3
ISSUED DATE: APRIL 12, 2017

WOOD GROUP MUSTANG INC.
17325 PARK ROW
HOUSTON TX, 77084
(832) 809-8000

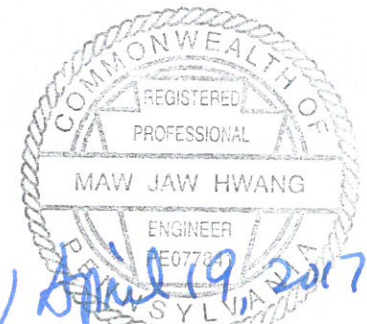

MAW JAW HWANG
PA. PE NO. PE077841

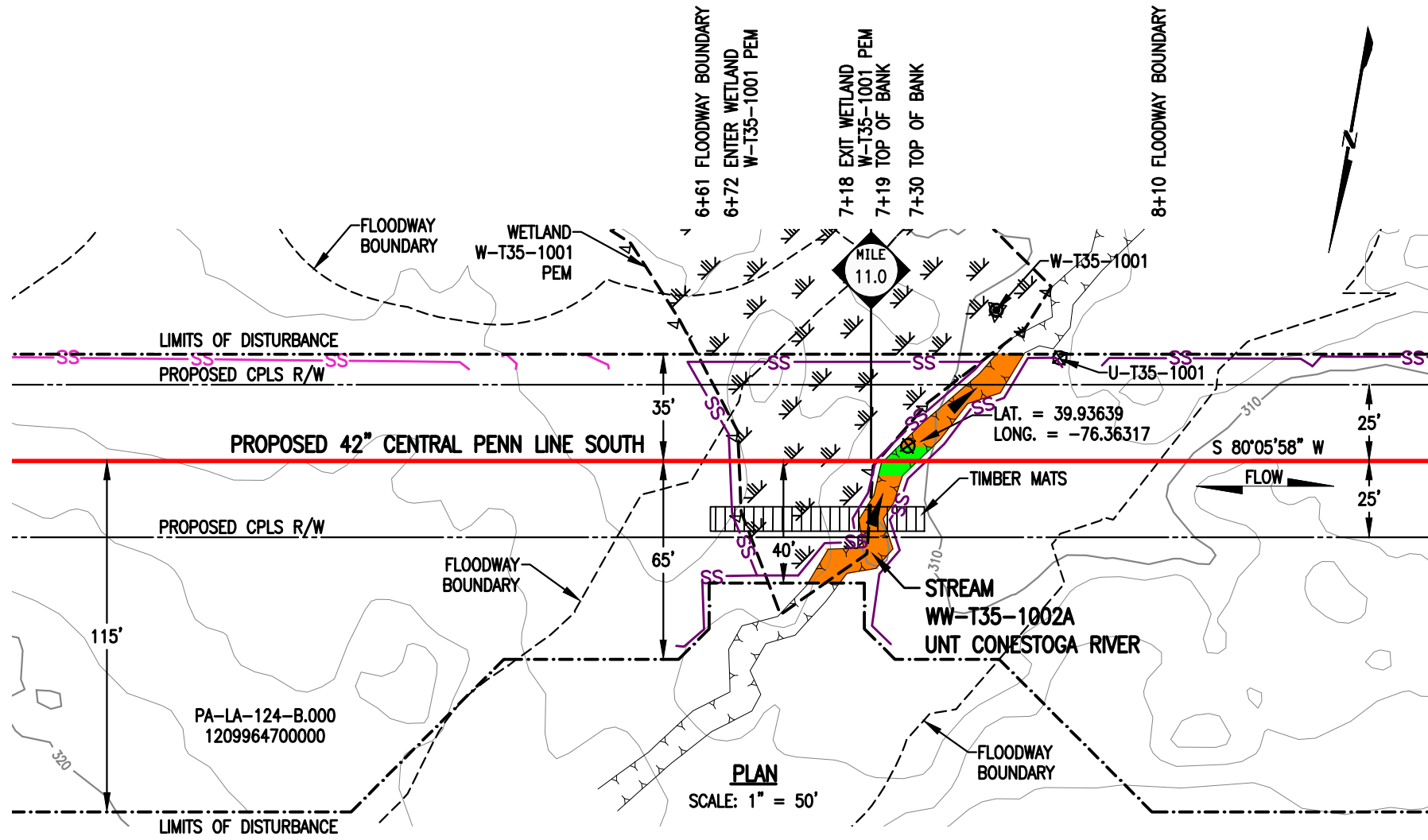

STREAM DISTURBANCE:

STREAM WW-T35-1002A	ACRE
TEMPORARY STREAM DISTURBANCE	0.0159
PERMANENT STREAM DISTURBANCE	0.0024
TOTAL STREAM DISTURBANCE	0.0183
TEMPORARY FLOODWAY DISTURBANCE	0.1985
PERMANENT FLOODWAY DISTURBANCE	0.0214
TOTAL FLOODWAY DISTURBANCE	0.2199

STREAM DIMENSION	FT.
STREAM WIDTH (TOB TO TOB)	11.12
STREAM LENGTH	102.78

GENERAL NOTES:

1. STREAM CROSSING METHOD SHALL BE DAM AND PUMP (DPX). EQUIPMENT TO CROSS STREAM UTILIZING A BRIDGE EQUIPMENT CROSSING (BEC).
2. WATERBODIES WITHOUT A FEMA-ESTABLISHED FLOODPLAIN, THE FLOODWAY IS COINCIDENT WITH A 50-FOOT OFFSET MEASURED Laterally FROM THE PHYSICAL TOP OF BANK OF THE WATERBODY.
3. STATION 6+00 SHOWN IS EQUAL TO STATION 579+64 ON THE EROSION AND SEDIMENT CONTROL PLAN.

SURVEY NOTES:

1. T.B.M. SURVEY CONTROL POINT - 174' LT. OF M.P. 11.03, ELEV. = 305.25' (NAVD88).

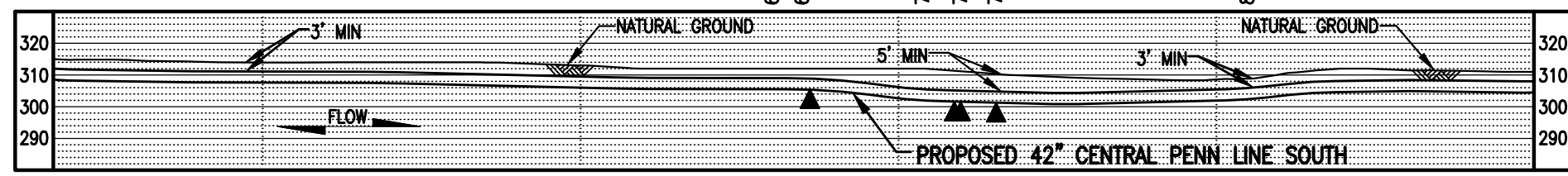

PROFILE
SCALE: 1" = 50' HORIZONTAL
1" = 50' VERTICAL



LEGEND

	PROPOSED 42" CENTRAL PENN LINE SOUTH		WETLAND FLAGS
	EXISTING PIPELINES		PHOTO DATA POINT
	EXISTING TGPL R/W		WETLAND DATA POINT
	LIMITS OF DISTURBANCE		UPLAND DATA POINT
	PROPOSED CPLS R/W		WELL POINT
	PROPERTY LINE		TRENCH PLUG
	FOREIGN PIPELINE		WATERBODY
	WETLAND AREA		TREE LINE
	STREAM FLOW		FLOODWAY BOUNDARY
	EXISTING POWER LINE		FEMA FLOODWAY BOUNDARY
	EXISTING FENCE		PERMANENT STREAM IMPACT
			TEMPORARY STREAM IMPACT

DRAWING NO.		REFERENCE TITLE				
24-1600-70-09-A/11.00-01		WATER OBSTRUCTION AND ENCROACHMENT PERMIT IMPACT MAPS				
NO.	DATE	BY	REVISION DESCRIPTION	W.O. NO.	CHK.	APP.
0	04/12/17	THL	ISSUED FOR PADEP SUBMITTAL #3	1161503	CLR	MJH

TRANSCONTINENTAL GAS PIPE LINE COMPANY LLC
CONTINGENCY PLAN IMPACT MAPS
ATLANTIC SUNRISE PROJECT
PROPOSED 42" CENTRAL PENN LINE SOUTH
STREAM CROSSING WW-T35-1002A
M.P. 11.00
CONESTOGA TOWNSHIP, LANCASTER COUNTY, PENNSYLVANIA

DRAWN BY: THL	DATE: 03/30/17	ISSUED FOR BID:	SCALE: 1" = 50'
CHECKED BY: AT	DATE: 03/30/17	ISSUED FOR CONSTRUCTION:	REVISION: 0
APPROVED BY: MJH	DATE: 03/30/17	DRAWING NUMBER: 24-1600-70-09A-A/11.00-01	SHEET 1
IWO: 1161503		4/20/2017	FILED

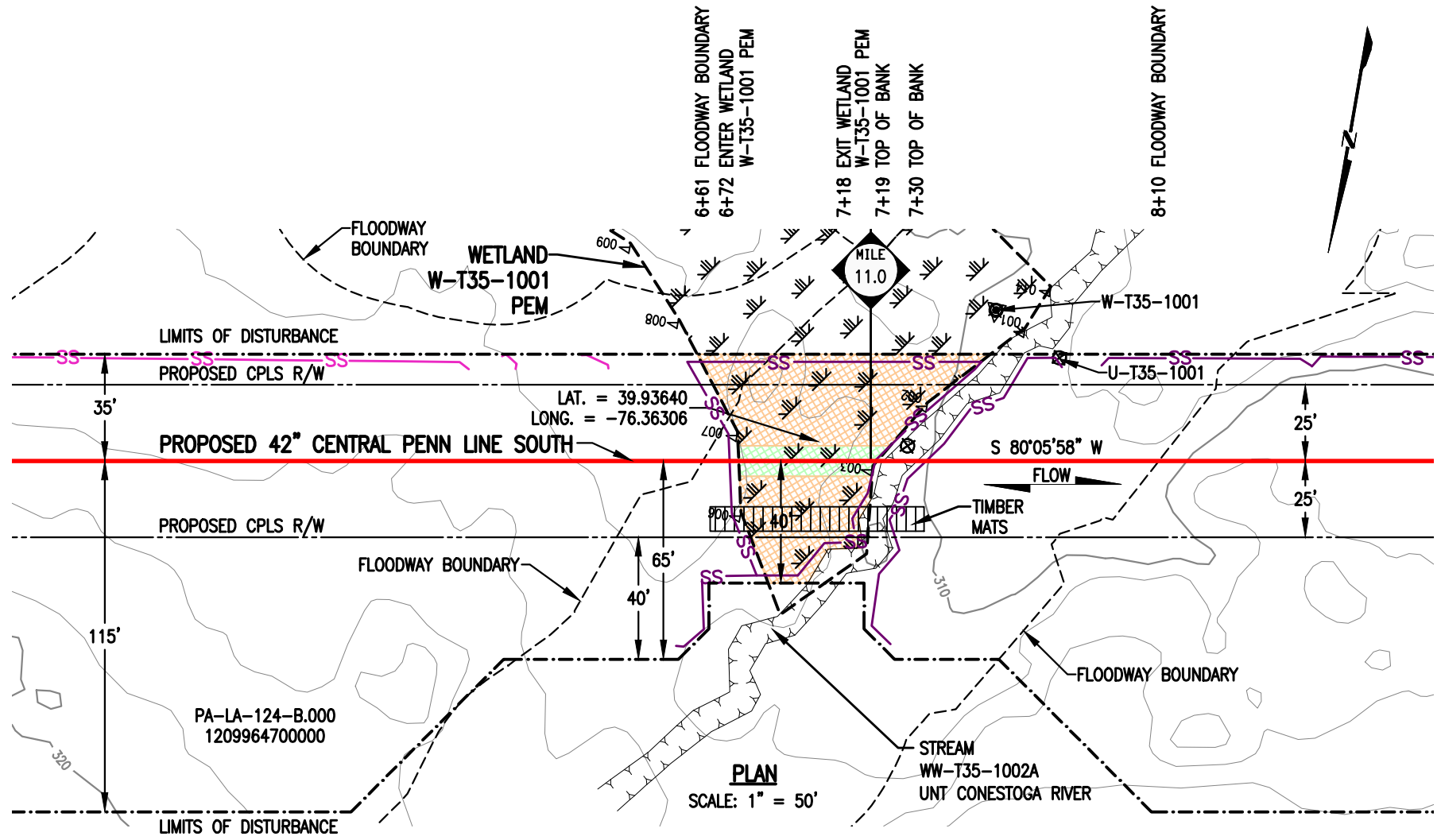

WETLAND DISTURBANCE:

WETLAND W-T35-1001	ACRE
TEMPORARY DISTURBANCE	0.0750
PERMANENT DISTURBANCE	0.0105
TOTAL DISTURBANCE	0.0855

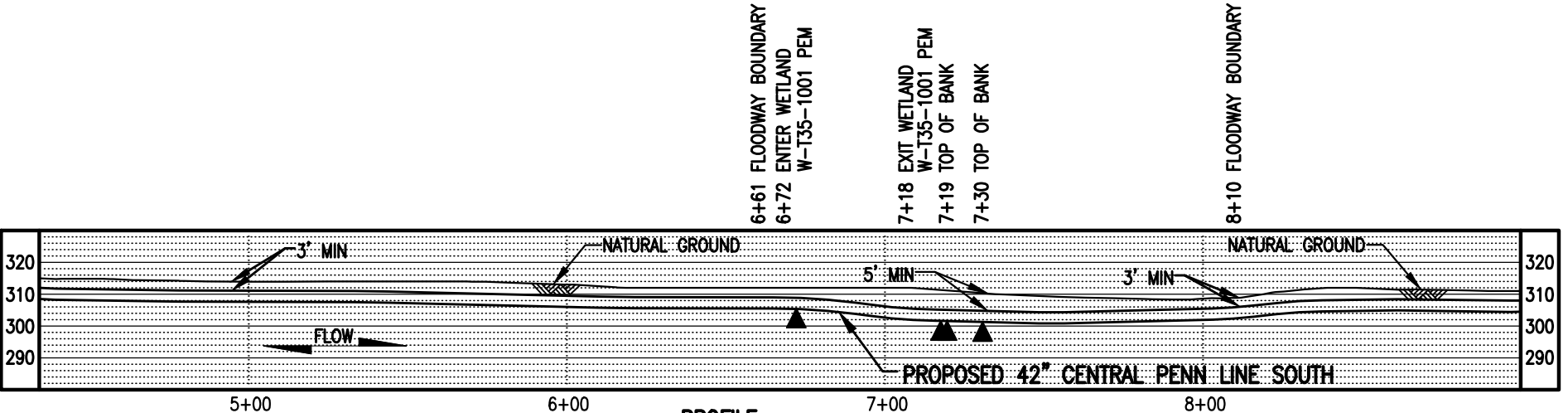

NOTES:

- UTILIZE A WETLAND EQUIPMENT CROSSING (WEC) AND WCC.3.
- STATION 6+00 SHOWN IS EQUAL TO STATION 579+64 ON THE EROSION AND SEDIMENT CONTROL PLAN.

SURVEY NOTES:

- T.B.M. SURVEY CONTROL POINT - 174' LT. OF M.P. 11.03, ELEV. = 305.25' (NAVD88).

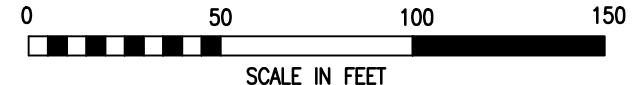

LEGEND

	PROPOSED 42" CENTRAL PENN LINE SOUTH		WETLAND FLAGS		WOOD GROUP MUSTANG, INC.
	EXISTING PIPELINES		PHOTO DATA POINT		WETLAND DATA POINT
	EXISTING TGPL R/W		UPLAND DATA POINT		WELL POINT
	LIMITS OF DISTURBANCE		TRENCH PLUG		WATERBODY
	PROPOSED CPLS R/W		TREE LINE		FLOODWAY BOUNDARY
	PROPERTY LINE		FEMA FLOODWAY BOUNDARY		12" SEDIMENT BARRIER
	FOREIGN PIPELINE		PERMANENT WETLAND IMPACT		18" SEDIMENT BARRIER
	WETLAND AREA		TEMPORARY WETLAND IMPACT		24" SEDIMENT BARRIER
	EXISTING POWER LINE				32" SEDIMENT BARRIER
	EXISTING FENCE				TOP OF BANK

DRAWING NO.		REFERENCE TITLE				
24-1600-70-20-A/11.00-01		WATER OBSTRUCTION AND ENCROACHMENT PERMIT IMPACT MAPS				
NO.	DATE	BY	REVISION DESCRIPTION	W.O. NO.	CHK.	APP.
0	04/12/17	THL	ISSUED FOR PADEP SUBMITTAL #3	1161503	CLR	MJH

TRANSCONTINENTAL GAS PIPE LINE COMPANY LLC
CONTINGENCY PLAN IMPACT MAPS
ATLANTIC SUNRISE PROJECT
PROPOSED 42" CENTRAL PENN LINE SOUTH
WETLAND CROSSING W-T35-1001
© M.P. 11.00
CONESTOGA TOWNSHIP, LANCASTER COUNTY, PENNSYLVANIA

DRAWN BY: THL	DATE: 03/30/17	ISSUED FOR BID:	SCALE: 1" = 50'
CHECKED BY: AT	DATE: 03/30/17	ISSUED FOR CONSTRUCTION:	REVISION: 0
APPROVED BY: MJH	DATE: 03/30/17	DRAWING NUMBER: 24-1600-70-20A-A/11.00-01	SHEET 1
IWC: 1161503		189pm 4/27/2017 nIsbell	OF 1

K:\LP10471\Maping\Wetlands\CPLS_PASVPADEP_IP_24-24-2017\Contingency Drawings\24-1600-70-20A-A_1100-01.dwg

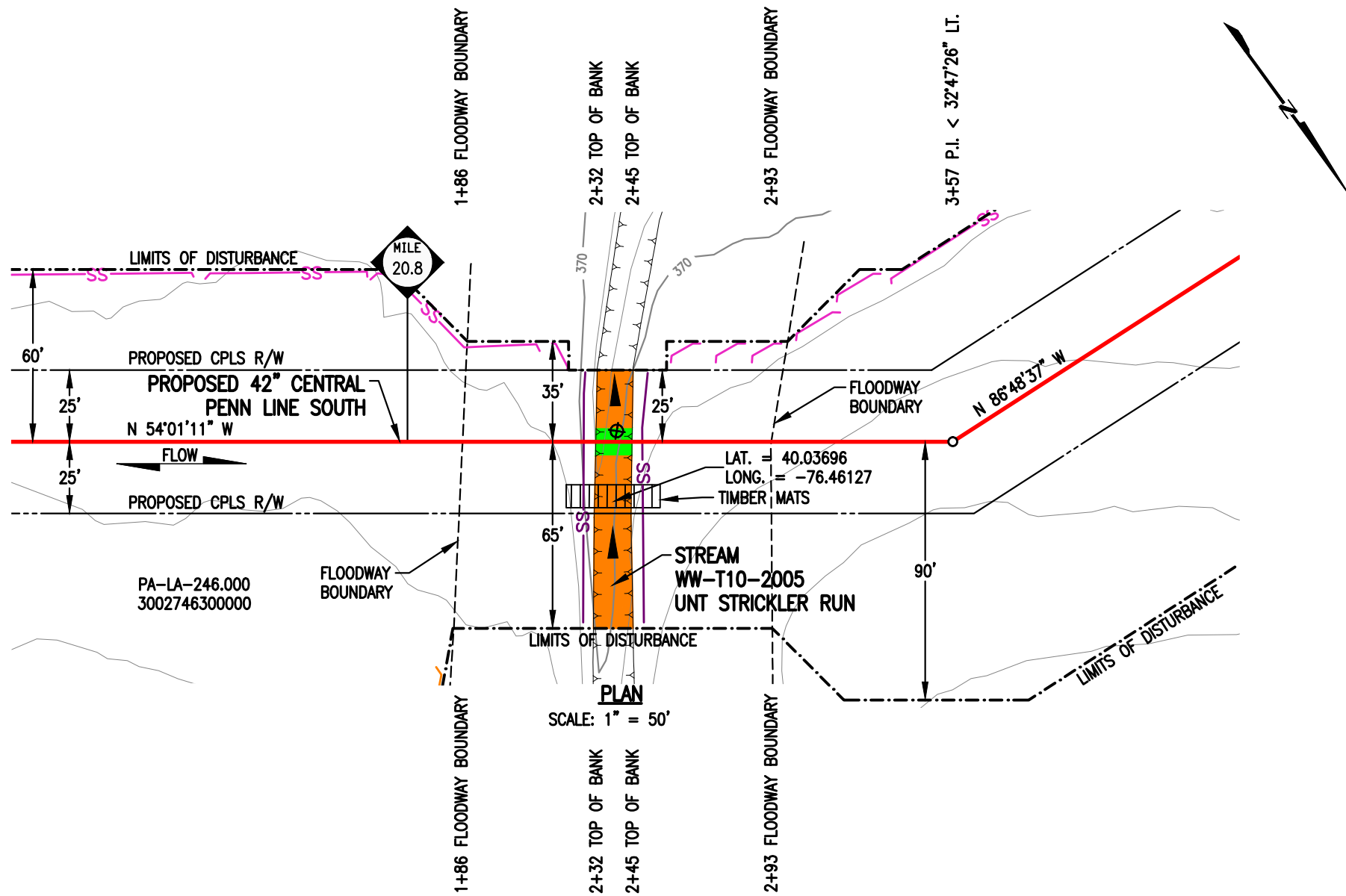

PLAN
SCALE: 1" = 50'

STREAM DISTURBANCE:

STREAM WW-T10-2005	ACRE
TEMPORARY STREAM DISTURBANCE	0.0238
PERMANENT STREAM DISTURBANCE	0.0029
TOTAL STREAM DISTURBANCE	0.0267
TEMPORARY FLOODWAY DISTURBANCE	0.1948
PERMANENT FLOODWAY DISTURBANCE	0.0218
TOTAL FLOODWAY DISTURBANCE	0.2166

STREAM DIMENSION	FT.
STREAM WIDTH (TOB TO TOB)	12.61
STREAM LENGTH	90.12

GENERAL NOTES:

1. STREAM CROSSING METHOD SHALL BE DAM AND PUMP (DPX). EQUIPMENT TO CROSS STREAM UTILIZING A BRIDGE EQUIPMENT CROSSING (BEC).
2. WATERBODIES WITHOUT A FEMA-ESTABLISHED FLOODPLAIN, THE FLOODWAY IS COINCIDENT WITH A 50-FOOT OFFSET MEASURED Laterally FROM THE PHYSICAL TOP OF BANK OF THE WATERBODY.
3. STATION 1+00 SHOWN IS EQUAL TO STATION 1097+56 ON THE EROSION AND SEDIMENT CONTROL PLAN.

SURVEY NOTES:

1. T.B.M. I.R. POINT - 60' LT. OF M.P. 20.70, ELEV. = 375.32' (NAVD88).

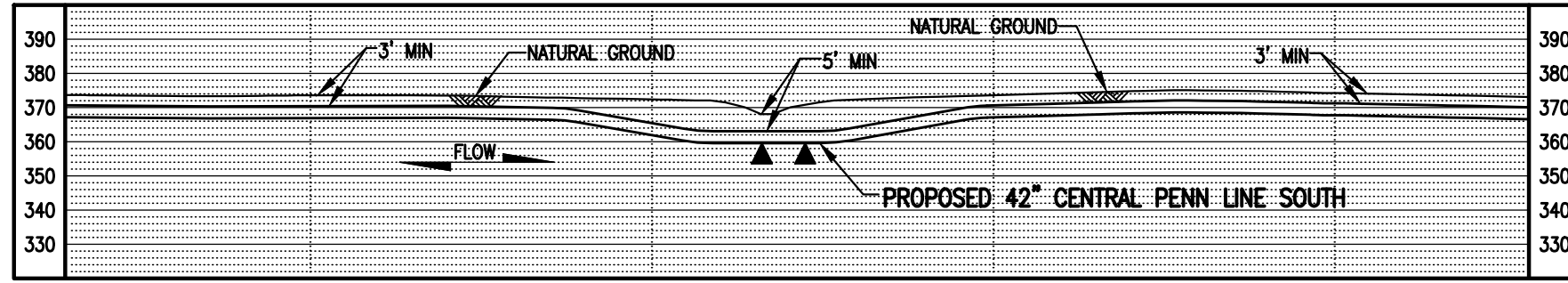

PROFILE
SCALE: 1" = 50' HORIZONTAL
1" = 50' VERTICAL

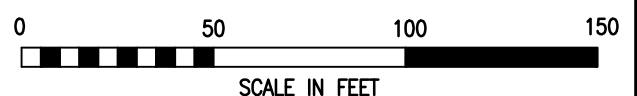

LEGEND

	PROPOSED 42" CENTRAL PENN LINE SOUTH		WETLAND FLAGS		WOOD GROUP MUSTANG, INC.
	EXISTING PIPELINES		PHOTO DATA POINT		12" SEDIMENT BARRIER
	EXISTING TGPL R/W		WETLAND DATA POINT		18" SEDIMENT BARRIER
	LIMITS OF DISTURBANCE		UPLAND DATA POINT		24" SEDIMENT BARRIER
	PROPOSED CPLS R/W		WELL POINT		32" SEDIMENT BARRIER
	PROPERTY LINE		TRENCH PLUG		TOP OF BANK
	FOREIGN PIPELINE		WATERBODY		PERMANENT STREAM IMPACT
	WETLAND AREA		TREE LINE		TEMPORARY STREAM IMPACT
	STREAM FLOW		FLOODWAY BOUNDARY		
	EXISTING POWER LINE		FEMA FLOODWAY BOUNDARY		
	EXISTING FENCE				

DRAWING NO. 24-1600-70-09-A/20.81-01		REFERENCE TITLE WATER OBSTRUCTION AND ENCROACHMENT PERMIT IMPACT MAPS		TRANSCONTINENTAL GAS PIPE LINE COMPANY LLC CONTINGENCY PLAN IMPACT MAPS ATLANTIC SUNRISE PROJECT PROPOSED 42" CENTRAL PENN LINE SOUTH STREAM CROSSING WW-T10-2005 © M.P. 20.81 WEST HEMPFIELD TOWNSHIP, LANCASTER COUNTY, PENNSYLVANIA						
NO.	DATE	BY	REVISION DESCRIPTION	W.O. NO.	CHK.	APP.	DRAWN BY: THL	DATE: 03/31/17	ISSUED FOR BID:	SCALE: 1" = 50'
0	04/12/17	THL	ISSUED FOR PADEP SUBMITTAL #3	1161503	CLR	MJH	CHECKED BY: AT	DATE: 03/31/17	ISSUED FOR CONSTRUCTION:	REVISION: 0
APPROVED BY: MJH		DATE: 03/31/17		DRAWING NUMBER: 24-1600-70-09A-A/20.81-01		SHEET 1				
W.O. NUMBER: 1161503		DATE: 4/20/2017		PROJECT: F1huert		OF 1				