

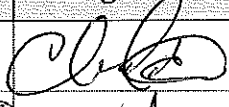
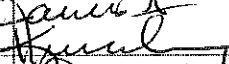

Applicant	Transcontinental Gas Pipeline Company (Transco)	Engineer	TRC Environmental	App #	E41-667
Municipality	Jordan, Franklin & Penn Township	County	Lycoming	APS #	877531

Engineer Record of Decision		Signature	Date	Approve	Deny	Withdraw
Reviewing Engineer	Chris Mileto		8/30/17	<input checked="" type="checkbox"/>	<input type="checkbox"/>	<input type="checkbox"/>
Group Manager	James Kuncelman		8/30/17	<input checked="" type="checkbox"/>	<input type="checkbox"/>	<input type="checkbox"/>
Program Manager	David Garg		8/30/17	<input checked="" type="checkbox"/>	<input type="checkbox"/>	<input type="checkbox"/>
					Yes	No
Has any of the regulated work been completed?					<input type="checkbox"/>	<input checked="" type="checkbox"/>

GENERAL INFORMATION:

- Stream: West Branch Little Muncy Creek (CWF, EV) and unnamed tributaries thereof, Little Indian Run (CWF, MF) and unnamed tributaries thereof, Little Muncy Creek (CWF, MF) and unnamed tributaries thereof, Beaver Run (CWF, MF) and unnamed tributaries thereof, Big Run (CWF, MF) and unnamed tributaries thereof, Sugar Run (CWF, MF) and unnamed tributaries thereof, Greg's Run (CWF, MF) and unnamed tributaries thereof, and Larrys Creek (HQ-CWF, EV).
- Drainage Area: Multiple.
- Detailed FEMA Study: YES NO
- Floodway Delineated by FEMA? YES NO (Greggs Run (42081C0379F), Sugar Run (42081C0383F), Big Run (42081C0390F), Little Indian Run & Little Muncy Creek (42081C0395F))
- E&S and Stormwater Management Summary? YES NO N/A
- Approved Stormwater Plan? YES NO N/A
- Local Floodplain Management Consistency Letter? YES NO N/A

PROJECT DESCRIPTION:

As referenced above, Water Obstruction and Encroachment (WOEP) Application E41-667 was submitted by Transcontinental Gas Pipe Line Company LLC (Transco). Within Pennsylvania, Transco has proposed a multiple component natural gas transmission pipeline installation project. Transco has titled this pipeline installation project their Atlantic Sunrise Project, which hereinafter will be abbreviated as "ASR." The project proposes to install approximately 198.7 miles of natural gas transmission lines within Pennsylvania. WOEP Application No. E41-667 encompasses a 8.6-mile section pipeline which has been termed as the "Unity Loop" Project in Lycoming County. The Unity Loop generally traverses Lycoming County from Penn Township proceeding through Franklin Township, and into Jordan Township. An associated 2.5-mile component has been termed as the "Chapman Loop" Project in Clinton County. A 60.4-mile component of ASR Transco has titled Central Penn Line North, and another 127.3-mile ASR component has been titled Central Penn Line South.

Transco has applied for a Standard – Joint Permit to construct, operate and maintain 8.6-miles of 42-inch diameter natural gas pipeline, which is co-located with the existing Leidy Line system in Jordan, Franklin and Penn Townships – Lycoming County. Hereinafter, this Review will reference and abbreviate that Lycoming County Section of Atlantic Sunrise as "ASR-Unity Loop."

APPLICANT	Transco	PROJECT LOCATION	Atlantic Sunrise Project – Unity Loop Jordan, Franklin and Penn Township Lycoming County	APPLICATION NUMBER	E41-667
------------------	---------	-------------------------	--	---------------------------	---------

Subject of this engineering staff report is the final ASR-Unity Loop water obstruction and encroachment activities expected to be incurred within Regulated Waters of this Commonwealth (25 Pa. Code § 105.1) along the pipeline alignment approved by the Federal Energy Regulatory Commission (FERC). The following is a summary of ASR-Unity Loop water obstruction and encroachment activities that will be included in public notice relative to Department action taken on ASR-Unity Loop WOEP Application E41-667:

A total of twenty (20) temporary and seventeen (17) permanent stream impacts are proposed to West Branch Little Muncy Creek (CWF, EV), UNT to West Branch Little Muncy Creek (CWF, EV), Little Indian Run (CWF, MF), UNT to Little Indian Run (CWF, MF), UNT Little Muncy Creek (CWF, MF), Beaver Run (CWF, MF), UNT to Beaver Run (CWF, MF), Big Run (CWF, MF), UNT to Big Run (CWF, MF), Sugar Run (CWF, MF), UNT to Sugar Run (CWF, MF), Larrys Creek (HQ-CWF, EV). Project watercourse impacts shall include and be limited to a total of 2322 linear feet (0.77 acres) of temporary stream impacts and a total of 2009 linear feet (0.25 acres) of permanent stream impacts.

A total of twenty-one (21) temporary and fourteen (14) permanent wetland impacts are proposed. Project wetland impacts shall include and be limited to a total of 2790 linear feet (4.06 acres) of temporary wetland impacts and a total of 1668 linear feet (0.28 acres) of permanent wetland impacts.

A total of nineteen (19) temporary and fourteen (14) permanent floodway impacts are proposed. Project floodway impacts shall include and be limited to a total of 4694 linear feet (4.77 acres) of temporary floodway impacts and a total of 1797 linear feet (0.16 acres) of permanent floodway impacts. Upon completing pipeline installation, the floodway impacts shall effectively be restored to reestablish pre-existing floodway current, course and cross-sections.

APPLICATION REVIEW INFORMATION:

County: Lycoming	Proposed Activity: Natural Gas Transmission Line	PNDI Receipt: See Below
Municipality: Jordan, Franklin and Penn Township,	E&S Plan Review By: Lycoming County Conservation District	PASPGP - 5: NO independent Federal authorization
Quadrangle: Sonestown, Picture Rocks, Salladasburg	Pre-app Meeting: 6/3/2015	ACOE Reporting: Reporting
Stream: West Branch Little Muncy Creek, Little Indian Run, Little Muncy Creek, Beaver Run, Big Run, Sugar Run, Greg's Run and Larry's Creek	Cultural Resource Notice: Sent 6/4/2015 Cleared 7/14/16; no further work required	Chapter 93: CWF, HQ-CWF, MF, EV, EV (Wetlands)
Latitude: Begin: 41.261518° End: 41.268885°	Municipal Consistency: 6/22/2015	Listed Trout: Wild Trout
Longitude: Begin: -76.526921° End: -76.689998°	Compliance Review: 8/13/2015	Temp. Wetland Impact: 4.06 acres
E-facts Tracking: YES	Date to Engineer: 8/26/2015	Perm. Wetland Impact: 0.28 acres
E-facts APS: 877531	Date to Biologist: 8/17/2015	Temp. Stream Impact: 0.77 acres
P.E. Seal Provided: YES	Admin. Complete: 9/3/2015	Perm. Stream Impact: 0.25 acres
Public Access: NO	PA Bulletin: Published 9/19/2015 Expired 10/19/2015	Temp. Floodway Impact: 4.77 acres
FEMA Floodway: YES	SLLA: Sent to CO – 4/18/17 Approved – 5/3/2017	Perm. Floodway Impact: 0.16 acres

PERMIT CONDITIONS:

1. STANDARD – See Water Obstruction and Encroachment Permit – 1 through 19
2. SPECIAL – See Water Obstruction and Encroachment Permit – 20 (A through NNN)

APPLICANT	Transco	PROJECT LOCATION	Atlantic Sunrise Project – Unity Loop Jordan, Franklin and Penn Township Lycoming County	APPLICATION NUMBER	E41-667
-----------	---------	------------------	--	--------------------	---------

HYDRAULIC DATA INFORMATION: N/A – HYDRAULICS NOT REQUIRED

A review of ASR WOEP Application E41-667 found that Transco has not proposed any permanent watercourse or wetland road crossings, for which hydrologic and hydraulic analysis would be required to design hydraulic openings in accordance with 25 Pa. Code § 105.151 and 25 Pa. Code § 105.161. Temporary installation for open-trench subsurface pipeline installation, specifically those at regulated watercourses, do however require bypass Best Management Practices (BMPs) (dam and pump) around pipeline installation areas. Where Transco proposed temporary watercourse bypass pipeline installations, a review of ASR WOEP Application E41-667 found sufficient hydrologic and hydraulic analysis was completed. Review confirmed dam and pump (i.e., full width coffer dam) was adequately designed to accommodate the 2-year frequency flood flow, which conservatively exceeds the scientifically accepted bank-full-flow or 1.5-year frequency flood flow. DEP North Central Regional Office (NCRO) engineering staff review of this hydrologic and hydraulic analysis for bypass determined prevailing professional engineering practices and principles were employed [25 Pa. Code§105.14(a)]. Given that the ASR-Unity Loop is entirely subsurface, all proposed impacts to streams are temporary in nature and will be restored to existing conditions within the right-of-way. For this reason, no permanent detrimental impacts to the existing hydrologic or hydraulic characteristics of these watercourses are anticipated.

IMPACT TABLES:

A review of ASR WOEP E41-667 Attachment E-2 and Appendix 1, showed that Transco designed and specified primary (i.e., preferred and anticipated) and secondary pipeline installation methods for installation of ASR beneath watercourses.

A review of Attachment E-2 and Appedix 1 showed that neither primary nor secondary specified pipeline installation method would result in an encroachment that directly, permanently changed, expanded, or diminished an identified watercourse current, course or cross-section (25 Pa. Code § 105.1 – “encroachment”). Accordingly, engineering staff review of the following specified primary pipeline installation methods at identified Lycoming County watercourses were determined as temporary impacts:

IMPACT TABLES: CROSSINGS 1 TO 5

Crossing #	Crossing 1 (Impacts 1 - 5)	Crossing 2 (Impacts 6 - 9)	Crossing 3 (Impacts 10 - 17)	Crossing 4 (Impacts 18 - 25)	Crossing 5 (Impacts 26 - 34)
Municipality:	Jordan	Jordan	Jordan	Franklin	Franklin
SOW:	Utility Pipeline Crossing Open Trench	Utility Pipeline Crossing Open Trench	Utility Pipeline Crossing Open Trench	Utility Pipeline Crossing Open Trench	Utility Pipeline Crossing Open Trench
Lat:	41.26185	41.26190	41.26185	41.26211	41.26226
Long:	76.53174	76.53191	76.53251	76.54800	76.56057
Resource:	W. Branch Little Muncy Creek	UNT W. Branch Little Muncy Creek	UNT W. Branch Little Muncy Creek	Little Indian Run	UNT Little Indian Run
ID:	WW-T01-22016	WW-T01-22016A	WW-T01-22015 WW-T01-22015A	WW-T01-22014	WW-T01-22012 WW-T01-22012A
Mile Post:	MP -120.56	MP -120.57	MP -120.60	MP -121.41	MP -122.09 & 122.10
Plan Sheet:	1	1	1	3	4
FEMA:	Assumed 50 ft	FEMA Detailed	Assumed 50 ft	FEMA Detailed	Assumed 50 ft
Chapter 93:	CWF, EV	CWF, EV	CWF, EV	CWF	CWF
Listed Trout:	Wild	Wild	Wild	Wild	Wild
Wetlands:	YES – EV W-T01-22016	NO	YES – EV W-T01-22015A W-T01-22015C	YES – EV W-T01-22014A W-T01-22014C	YES – EV W-T01-22013A W-T01-22013C
Quadrangle:	Sonestown	Sonestown	Sonestown	Sonestown	Sonestown
Temp. Wetland Impacts:	418.2 ft ² 0.0096 acres	0 ft ² 0 acres	5536.5 ft ² 0.1271 acres	13590.8 ft ² 0.3120 acres	3985.8 ft ² 0.0915 acres
Perm. Wetland Impacts:	0 ft ² 0 acres	0 ft ² 0 acres	344.2 ft ² 0.0079 acres	2339.2 ft ² 0.0537 acres	649.1 ft ² 0.0149 acres
Temp. Stream Impacts:	1398.3 ft ² 0.0321 acres	1712.0 ft ² 0.0393 acres	518.4 ft ² 0.0119 acres	1084.7 ft ² 0.0249 acres	1184.9 ft ² 0.0272 acres
Perm. Stream Impacts:	78.5 ft ² 0.0018 acres	104.6 ft ² 0.0024 acres	21.8 ft ² 0.0005 acres	74.1 ft ² 0.0017 acres	82.8 ft ² 0.0019 acres
Temp. Floodway Impacts:	6682.2 ft ² 0.1534 acres	4508.5 ft ² 0.1035 acres	5575.7 ft ² 0.128 acres	479.2 ft ² 0.011 acres	4194.9 ft ² 0.0963 acres
Perm. Floodway Impacts:	370.3ft ² 0.0085 acres	196.1 ft ² 0.0045 acres	374.7 ft ² 0.0086 acres	17.5 ft ² 0.0004 acres	265.8 ft ² 0.0061 acres

APPLICANT	Tranco	PROJECT LOCATION	Atlantic Sunrise Project -- Unity Loop Jordan, Franklin and Penn Township Lycoming County	APPLICATION NUMBER	E41-667
-----------	--------	------------------	---	--------------------	---------

IMPACT TABLES: CROSSINGS 6 TO 10

Crossing #	Crossing 6 (Impacts 35 - 40)	Crossing 7 (Impacts 41 - 46)	Crossing 8 (Impacts 47 - 54)	Crossing 9 (Impacts 55 - 63)	Crossing 10 (Impacts 65)
Municipality:	Franklin	Franklin	Franklin	Penn	Penn
SOW:	Utility Pipeline Crossing Open Trench	Utility Pipeline Crossing Open Trench	Utility Pipeline Crossing Open Trench	Utility Pipeline Crossing Open Trench	Utility Pipeline Crossing Open Trench
Lat:	41.26269	41.26327	41.26391	41.26465	41.26496
Long:	76.56980	76.58225	76.59270	76.60409	76.61570
Resource ID:	UNT Little Muncy Creek WW-T01-22011	UNT Beaver Run WW-T01-22010	Beaver Run WW-T01-22009	UNT Beaver Run WW-T01-22008 WW-T01-22008A WW-T01-22008B	
Mile Post:	MP -122.57	MP -123.22	MP -123.77	MP -124.36	MP -124.97
Plan Sheet:	5	6	7	9	10
FEMA:	Assumed 50 ft	FEMA Detailed	FEMA Detailed	Assumed 50 ft	N/A
Chapter 93:	CWF	CWF	CWF	CWF	N/A
Listed Trout:	Wild	Wild	Wild	Wild	None
Wetlands:	YES - EV W-T01-22012	YES - EV W-T01-22011-1	YES - EV W-T01-22010A W-T01-22010C	YES - EV W-T01-22009	YES W-T01-22007
Quadrangle:	Sonestown	Sonestown	Sonestown	Sonestown	Sonestown
Temp. Wetland Impacts:	15455.1 ft ² 0.3548 acres	152.5 ft ² 0.0035 acres	3558.9 ft ² 0.0817 acres	10550.3 ft ² 0.24220 acres	235.3 ft ² 0.0054 acres
Perm. Wetland Impacts:	988.9 ft ² 0.0227 acres	17.5 ft ² 0.0004 acres	566.3 ft ² 0.013 acres	670.9 ft ² 0.0154 acres	0 ft ² 0.00 acres
Temp. Stream Impacts:	1572.6 ft ² 0.0361 acres	3981.4 ft ² 0.0914 acres	5540.9 ft ² 0.1272 acres	5850.2 ft ² 0.1343 acres	0 ft ² 0.00 acres
Perm. Stream Impacts:	87.2 ft ² 0.002 acres	204.8 ft ² 0.0047 acres	300.6 ft ² 0.0069 acres	230.9 ft ² 0.0053 acres	0 ft ² 0.00 acres
Temp. Floodway Impacts:	3977.1 ft ² 0.0913 acres	888.7 ft ² 0.0204 acres	3746.2 ft ² 0.086 acres	13691 ft ² 0.3143 acres	0 ft ² 0.00 acres
Perm. Floodway Impacts:	248.3 ft ² 0.0057 acres	30.5 ft ² 0.0007 acres	187.4 ft ² 0.0043 acres	657.8 ft ² 0.0151 acres	0 ft ² 0.00 acres

IMPACT TABLES: CROSSINGS 11 TO 15

Crossing #	Crossing 11 (Impacts 66 - 70)	Crossing 12 (Impacts 71 - 76)	Crossing 13 (Impacts 77 - 82)	Crossing 14 (Impacts 83 - 86)	Crossing 15 (Impacts 87 - 92)
Municipality:	Penn	Penn	Penn		Penn
SOW:	Utility Pipeline Crossing Open Trench	Utility Pipeline Crossing Open Trench	Utility Pipeline Crossing Open Trench	Crossing was deleted. Alignment changed.	Utility Pipeline Crossing Open Trench
Lat:	41.26480	41.26494	41.26506		41.26643
Long:	76.61861	76.62088	76.62246		76.64225
Resource ID:	UNT Big Run WW-T01-22006	UNT Big Run WW-T01-22006B	Big Run WW-T01-22007		UNT Sugar Run WW-T01-22003
Mile Post:	MP -125.13	MP -125.24	MP -125.32		MP -126.36
Plan Sheet:	10	10	11		13
FEMA:	Assumed 50 ft	Assumed 50 ft	Assumed 50 ft		Assumed 50 ft
Chapter 93:	CWF	CWF	CWF		CWF
Listed Trout:	None	None	None		Wild Trout
Wetlands:	YES W-T01-22004	YES W-T01-22006	YES W-T01-22005A W-T01-22005C		YES - EV W-T01-22001
Quadrangle:	Sonestown	Sonestown	Sonestown		Picture Rocks
Temp. Wetland Impacts:	4604.3 ft ² 0.1057 acres	6494.8 ft ² 0.1491 acres	18099.2 ft ² 0.4155 acres		1341.7 ft ² 0.0308 acres
Perm. Wetland Impacts:	48.0 ft ² 0.0011 acres	466.1 ft ² 0.0107 acres	1145.7 ft ² 0.0263 acres		82.8 ft ² 0.0019 acres
Temp. Stream Impacts:	0 ft ² 0.00 acres	2696.4 ft ² 0.0619 acres	1202.3 ft ² 0.0276 acres		840.8 ft ² 0.0193 acres
Perm. Stream Impacts:	0 ft ² 0.00 acres	204.8 ft ² 0.0047 acres	95.9 ft ² 0.0022 acres		48 ft ² 0.0011 acres
Temp. Floodway Impacts:	24459.0 ft ² 0.5615 acres	17990.3 ft ² 0.4130 acres	161.2 ft ² 0.0037 acres		8455.0 ft ² 0.1941 acres
Perm. Floodway Impacts:	1128.3 ft ² 0.0259 acres	553.3 ft ² 0.0127 acres	0 ft ² 0.00 acres		422.6 ft ² 0.0097 acres

APPLICANT	Transco	PROJECT LOCATION	Atlantic Sunrise Project – Unity Loop Jordan, Franklin and Penn Township Lycoming County	APPLICATION NUMBER	E41-667
-----------	---------	------------------	--	--------------------	---------

IMPACT TABLES: CROSSINGS 16 TO 20

Crossing #	Crossing 16 (Impacts 93 - 96)	Crossing 17 (Impacts 97 - 103)	Crossing 18 (Impact 104 & 105)	Crossing 19 (Impact 106)	Crossing 20 (Impact 107)
Municipality:	Penn	Penn	Penn	Franklin	Penn
SOW:	Utility Pipeline Crossing Open Trench	Utility Pipeline Crossing Open Trench	Staging Area Open Trench	Road Crossing	Road Crossing
Lat:	41.26670	41.26710	41.26870	41.26552	41.26670
Long:	76.65584	76.65992	76.69109	76.58082	76.65584
Resource:	Sugar Run	UNT Sugar Run WW-T65-27001	Greg's Run	UNT Beaver Run	Sugar Run
ID:	WW-T01-22002	WW-T65-27001A WW-T65-27001B	WW-T46-22001	WW-T24-22003	WW-T01-22002
Mile Post:	MP -127.09	MP -127.3	MP -128.87		MP -127.09
Plan Sheet:	14	15	18	22	14
FEMA:	FEMA Detailed	Assumed 50 ft	FEMA Detailed	Assumed 50 ft	FEMA Detailed
Chapter 93:	CWF	CWF	CWF	CWF	CWF
Listed Trout:	Wild Trout	Wild Trout	None	None	None
Wetlands:		YES – EV W-T65-27001A W-T65-27001B			
Quadrangle:	Picture Rocks	Picture Rocks	Picture Rocks	Sonestown	Picture Rocks
Temp. Wetland Impacts:	0 ft ² 0.00 acres	56.7 ft ² 0.0013 acres	0 ft ² 0.00 acres	0 ft ² 0.00 acres	0 ft ² 0.00 acres
Perm. Wetland Impacts:	0 ft ² 0.00 acres	0 ft ² 0 acres	0 ft ² 0.00 acres	0 ft ² 0.00 acres	0 ft ² 0.00 acres
Temp. Stream Impacts:	1955.9 ft ² 0.0449 acres	1816.5 ft ² 0.0417 acres	0 ft ² 0.00 acres	0 ft ² 0.00 acres	0 ft ² 0.00 acres
Perm. Stream Impacts:	95.9 ft ² 0.0022 acres	43.6 ft ² 0.0010 acres	0 ft ² 0.00 acres	0 ft ² 0.00 acres	0 ft ² 0.00 acres
Temp. Floodway Impacts:	23383.1 ft ² 0.5368 acres	26101.2 ft ² 0.5992 acres	54010.1 ft ² 1.2399 acres	1529.0 ft ² 0.0351 acres	8054.3 ft ² 0.1849 acres
Perm. Floodway Impacts:	1119.5 ft ² 0.0257 acres	1481.1 ft ² 0.034 acres	0 ft ² 0.00 acres	0 ft ² 0.00 acres	0 ft ² 0.00 acres

IMPACT TABLES: CROSSINGS 21

Crossing #	Crossing 21 (Impacts 108 - 111)
Municipality:	Anthony
SOW:	Larrys Mitigation PRM site
Lat:	41.30724
Long:	77.18718
Resource:	Larrys Creek
ID:	
Mile Post:	
Plan Sheet:	
FEMA:	FEMA Detailed
Chapter 93:	HQ-CWF, EV
Listed Trout:	Wild Trout
Wetlands:	
Quadrangle:	Salladasburg
Temp. Wetland Impacts:	92782.8 ft ² 2.13 acres
Perm. Wetland Impacts:	4791.6 ft ² 0.11 acres
Temp. Stream Impacts:	2178.0 ft ² 0.05 acres
Perm. Stream Impacts:	9147.6 ft ² 0.21 acres
Temp. Floodway Impacts:	0 ft ² 0 acres
Perm. Floodway Impacts:	0 ft ² 0 acres

	TOTAL IMPACTS	
	WITHOUT PRM SITE	WITH PRM SITE
Temporary Wetland Impacts:	84028 ft ² 1.9302 ac	176863 ft ² 4.0602 ac → 4.06 ac
Permanent Wetland Impacts:	7319 ft ² 0.1680 ac	12110 ft ² 0.2780 ac → 0.28 ac
Temporary Stream Impacts:	31355 ft ² 0.7198 ac	33533 ft ² 0.7698 ac → 0.77 ac
Permanent Stream Impacts:	1674 ft ² 0.0384 ac	10821 ft ² 0.2484 ac → 0.25 ac
Temp. Floodway Impacts:	207886 ft ² 4.7724 ac	207886 ft ² 4.7724 ac → 4.77 ac
Perm. Floodway Impacts:	7053 ft ² 0.1619 ac	7053 ft ² 0.1619 ac → 0.16 ac

*square footage was calculated from data provided in the permit application. It is an accurate depiction of impacts but may not be exact

APPLICANT	Transco	PROJECT LOCATION	Atlantic Sunrise Project – Unity Loop Jordan, Franklin and Penn Township Lycoming County	APPLICATION NUMBER	E41-667
-----------	---------	------------------	--	--------------------	---------

STREAM IMPACT TABLE: N/A

Resource ID	Cross# Mile Post	Resource Name	Municipality	Activity	Chapter 93	Listed Trout	Impact Length Temp. (LF)	Impact Area Temp. (acres)	Impact Length Perm. (LF)	Impact Area Perm. (acres)	Lat. Long.	
WW-T01-22016	1 120.56	West Branch Little Muncy Creek	Jordan	Pipeline Crossing	CWF, EV	Wild	109.84	0.0321	5.32	0.0018	41.26185 76.53174	
WW-T01-22016A	2 120.57	UNT West Branch Little Muncy Creek	Jordan	Pipeline Crossing	CWF, EV	Wild	95.72	0.0393	5.04	0.0024	41.26190 76.53191	
WW-T01-22015	3 120.60	UNT West Branch Little Muncy Creek	Jordan	Pipeline Crossing	CWF, EV	Wild	76.23	0.0082	6.28	0.0005	41.26185 76.53251	
WW-T01-22015A	3 120.61	UNT West Branch Little Muncy Creek	Jordan	Pipeline Crossing	CWF, EV	Wild	28.25	0.0037			41.26194 76.53249	
WW-T01-22014	4 121.41	Little Indian Run	Franklin	Pipeline Crossing	CWF, MF	Wild	72.34	0.0249	5.14	0.0017	41.26211 76.54800	
WW-T01-22012	5 122.09	UNT Little Indian Run	Franklin	Pipeline Crossing	CWF, MF	Wild	71.53	0.0177	5.04	0.0013	41.26226 76.56057	
WW-T01-22012A	5 122.10	UNT Little Indian Run	Franklin	Pipeline Crossing	CWF, MF	Wild	96.97	0.0095	5.30	0.0006	41.26233 76.56067	
WW-T01-22011	6 122.57	UNT Little Muncy Creek	Franklin	Pipeline Crossing	CWF, MF	Wild	97.48	0.0361	5.04	0.0020	41.26269 76.56980	
WW-T01-22010	7 123.22	UNT Beaver Run	Franklin	Pipeline Crossing	CWF, MF	Wild	106.04	0.0914	5.02	0.0047	41.26327 76.58225	
WW-T01-22009	8 123.77	Beaver Run	Franklin	Pipeline Crossing	CWF, MF	Wild	114.12	0.1272	5.73	0.0069	41.26391 76.59270	
WW-T01-22008A	9 124.36	UNT Beaver Run	Penn	Pipeline Crossing	CWF, MF	Wild	59.35	0.0314			41.26475 76.60401	
WW-T01-22008	9 124.36	UNT Beaver Run	Penn	Pipeline Crossing	CWF, MF	Wild	100.16	0.0526	5.15	0.0034	41.26465 76.60409	
WW-T01-22008B	9 124.39	UNT Beaver Run	Penn	Pipeline Crossing	CWF, MF	Wild	165.66	0.0503	6.64	0.0019	41.26470 76.60449	
WW-T01-22006B	12 125.24	UNT Big Run	Penn	Pipeline Crossing	CWF, MF	Wild	211.30	0.0619	10.82	0.0047	41.26494 76.62088	
WW-T01-22007	13 125.32	Big Run	Penn	Pipeline Crossing	CWF, MF	Wild	85.93	0.0276	6.51	0.0022	41.26506 76.62246	
WW-T01-22003	15 126.36	UNT Sugar Run	Penn	Pipeline Crossing	CWF, MF	Wild	98.56	0.0193	5.13	0.0011	41.26643 76.64225	
WW-T01-22002	16 127.09	Sugar Run	Penn	Pipeline Crossing	CWF, MF	Wild	95.94	0.0449	5.01	0.0022	41.26670 76.65584	
WW-T65-27001	17 127.3	UNT Sugar Run	Penn	Pipeline Crossing	CWF, MF	Wild	98.63	0.0182	5.07	0.0010	41.26710 76.65992	
WW-T65-27001A	17 127.3	UNT Sugar Run	Penn	Pipeline Crossing	CWF, MF	Wild	214.04	0.0235			41.26710 76.66030	
TOTAL STREAMS IMPACTS WITHOUT PRM SITE							TOTAL	1998.09	0.7198 acres	92.24	0.0384 acres	

UNT1		Larrys Creek	Anthony	PRM Site Wetland Mitigation	HQ-CWF; EV	Wild	323.40	0.0500	1916.81	0.2100	41.30724 77.18718
------	--	--------------	---------	-----------------------------	------------	------	--------	--------	---------	--------	----------------------

TOTAL STREAMS IMPACTS WITH PRM SITE							TOTAL	2321.49	0.7698 acres	2009.05	0.2484 acres
									33533 SF		10821 SF

APPLICANT	Transco	PROJECT LOCATION	Atlantic Sunrise Project – Unity Loop Jordan, Franklin and Penn Township Lycoming County	APPLICATION NUMBER	E41-667
-----------	---------	------------------	--	--------------------	---------

WETLAND IMPACT TABLE: N/A

Resource ID	Cross# Mile Post	Resource Name	Municipality	Activity	Chapter 93	Listed Trout	Impact Length Temp. (LF)	Impact Area Temp. (acres)	Impact Length Perm. (LF)	Impact Area Perm. (acres)	Lat. Long.	
W-T01-22016	1 120.56	Wetland	Jordan	Pipeline Crossing	EV	Wild	147.92	0.0096			41.26176 76.53175	
W-T01-22015C	3 120.61	Wetland	Jordan	Pipeline Crossing	EV	Wild	15.27	0.0005			41.26204 76.53266	
W-T01-22015A	3 120.62	Wetland	Jordan	Pipeline Crossing	EV	Wild	188.62	0.1266	134.73	0.0079	41.26182 76.53290	
W-T01-22014A	4 121.40	Wetland	Franklin	Pipeline Crossing	EV	Wild	320.05	0.2203	235.11	0.0184	41.26206 76.54771	
W-T01-22014C	4 121.40	Wetland	Franklin	Pipeline Crossing	EV	Wild	299.63	0.0917	179.88	0.0353	41.26216 76.54779	
W-T01-22013A	5 122.09	Wetland	Franklin	Pipeline Crossing	EV	Wild	145.84	0.0597			41.26218 76.56039	
W-T01-22013C	5 122.10	Wetland	Franklin	Pipeline Crossing	EV	Wild	65.31	0.0318	53.34	0.0149	41.26229 76.56072	
W-T01-22012	6 122.58	Wetland	Franklin	Pipeline Crossing	EV	Wild	284.40	0.3548	272.30	0.0227	41.26270 76.57002	
W-T01-22011-1	7 123.23	Wetland	Franklin	Pipeline Crossing	EV	Wild	53.90	0.0035	7.12	0.0004	41.26321 76.58238	
W-T01-22010C	8 123.75	Wetland	Franklin	Pipeline Crossing	EV	Wild	75.44	0.0483	46.91	0.0098	41.26393 76.59242	
W-T01-22010A	8 123.75	Wetland	Franklin	Pipeline Crossing	EV	Wild	170.96	0.0334	74.86	0.0032	41.26381 76.59237	
W-T01-22009 & 22009-1	9 124.40	Wetland	Penn	Pipeline Crossing	EV	Wild	250.65	0.2422	220.79	0.0154	41.26469 76.60473	
W-T01-22007	10 124.97	Wetland	Penn	Pipeline Crossing	EV	Wild	28.46	0.0054			41.26496 76.61570	
W-T01-22004	11 125.13	Wetland	Penn	Pipeline Crossing	EV	Wild	130.79	0.1057	12.01	0.0011	41.26472 76.61879	
W-T01-22006	12 125.22	Wetland	Penn	Pipeline Crossing	EV	Wild	259.46	0.1491	163.50	0.0107	41.26491 76.62049	
W-T01-22005A	13 125.31	Wetland	Penn	Pipeline Crossing	EV	Wild	249.94	0.4154	249.65	0.0263	41.26503 76.62218	
W-T01-22005C	13 125.32	Wetland	Penn	Pipeline Crossing	EV	Wild	9.25	0.0001			41.26516 76.62231	
W-T01-22001	15 126.37	Wetland	Penn	Pipeline Crossing	EV	Wild	77.03	0.0308	18.19	0.0019	41.26647 76.64240	
W-T65-27001B	17 127.3	Wetland	Penn	Pipeline Crossing	EV	Wild	1.40	0.0001			41.26695 76.65971	
W-T65-27001A	17 127.3	Wetland	Penn	Pipeline Crossing	EV	Wild	15.76	0.0012			41.26724 76.65996	
TOTAL WETLAND IMPACTS WITHOUT PRM SITE							TOTAL	2790.08	1.9302 acres	1668.39	0.1680 acres	

W1		Wetland	Anthony	PRM Site Wetland Mitigation	EV	Wild		2.1300		0.1100	41.30724 77.18718
----	--	---------	---------	-----------------------------	----	------	--	--------	--	--------	----------------------

TOTAL WETLAND IMPACTS WITHOUT PRM SITE							TOTAL	2790.08	4.0602 acres	1668.39	0.2780 acres
								176863 SF			12110 SF

APPLICANT	Transco	PROJECT LOCATION	Atlantic Sunrise Project – Unity Loop Jordan, Franklin and Penn Township Lycoming County	APPLICATION NUMBER	E41-667
-----------	---------	------------------	--	--------------------	---------

FLOODWAY IMPACT TABLE: N/A

Resource ID	Cross# Mile Post	Resource Name	Municipality	Activity	Chapter 93	Impact Length Temp. (LF)	Impact Area Temp. (acres)	Impact Length Perm. (LF)	Impact Area Perm. (acres)	Lat. Long.
WW-T01-22016	1 120.56	West Branch Little Muncy Creek	Jordan	Pipeline Crossing	CWF, EV	132.03	0.1534	91.39	0.0085	41.26185 76.53174
WW-T01-22016A	2 120.57	UNT West Branch Little Muncy Creek	Jordan	Pipeline Crossing	CWF, EV	100.00	0.1035	61.51	0.0045	41.26190 76.53191
WW-T01-22015	3 120.60	UNT West Branch Little Muncy Creek	Jordan	Pipeline Crossing	CWF, EV	150.12	0.1280	128.80	0.0086	41.26185 76.53251
WW-T01-22014	4 121.41	Little Indian Run	Franklin	Pipeline Crossing	CWF, MF	72.92	0.0110	10.56	0.0004	41.26211 76.54800
WW-T01-22012	5 122.09	UNT Little Indian Run	Franklin	Pipeline Crossing	CWF, MF	114.95	0.0963	112.08	0.0061	41.26226 76.56057
WW-T01-22011	6 122.57	UNT Little Muncy Creek	Franklin	Pipeline Crossing	CWF, MF	124.87	0.0913	50.39	0.0057	41.26269 76.56980
WW-T01-22010	7 123.22	UNT Beaver Run	Franklin	Pipeline Crossing	CWF, MF	153.33	0.0204	9.21	0.0007	41.26327 76.58225
WW-T01-22009	8 123.77	Beaver Run	Franklin	Pipeline Crossing	CWF, MF	149.28	0.0860	99.47	0.0043	41.26391 76.59270
WW-T01-22008	9 124.36	UNT Beaver Run	Penn	Pipeline Crossing	CWF, MF	244.20	0.3143	167.07	0.0151	41.26465 76.60409
WW-T01-22006	11 125.13	UNT Big Run	Penn	Pipeline Crossing	CWF, MF	792.92	0.5615	240.72	0.0259	41.26480 76.61861
WW-T01-22006B	12 125.24	UNT Big Run	Penn	Pipeline Crossing	CWF, MF	524.20	0.4130	162.32	0.0127	41.26494 76.62088
WW-T01-22007	13 125.32	Big Run	Penn	Pipeline Crossing	CWF, MF	148.38	0.0037			41.26506 76.62246
WW-T01-22003	15 126.36	UNT Sugar Run	Penn	Pipeline Crossing	CWF, MF	122.95	0.1941	111.12	0.0097	41.26643 76.64225
WW-T01-22002	16 127.09	Sugar Run	Penn	Pipeline Crossing	CWF, MF	273.12	0.5368	246.52	0.0257	41.26670 76.65584
WW-T65-27001A	17 127.3	UNT Sugar Run	Penn	Pipeline Crossing	CWF, MF	376.80	0.5992	305.88	0.0340	41.26710 76.65992
WW-T46-22001	18 128.87	Greg's Run	Penn	Staging Area	CWF, MF	733.80	1.1192			41.26870 76.69109
WW-T71-22001	18 128.87	Greg's Run	Penn	Staging Area	CWF, MF	159.52	0.1207			41.26928 76.68895
WW-T24-22003	19	UNT to Beaver Run	Franklin	Road Crossing	CWF, MF	135.19	0.0351			41.26552 76.58082
WW-T01-22002	20 127.09	Sugar Run	Penn	Road Crossing	CWF, MF	185.22	0.1849			41.26670 76.65584

TOTAL	4693.80	4.7724 acres	1797.04	0.1619 acres
		207886 SF		7053 SF

APPLICANT	Transco	PROJECT LOCATION	Atlantic Sunrise Project – Unity Loop Jordan, Franklin and Penn Township Lycoming County	APPLICATION NUMBER	E41-667
-----------	---------	------------------	--	--------------------	---------

TYPICAL SECTIONS:

Dam and Pump Stream Crossing (DPX).

Temporary Conditions (Streams):

The proposed dam and pump crossings involve the installation of cofferdams upstream and downstream of the utility crossing, removal of the water between the two cofferdams so that the installation of the natural gas transmission line can be constructed in the dry. The sizing of the pumps will be to maintain 1.5 times the flow present in the stream at the time of construction.

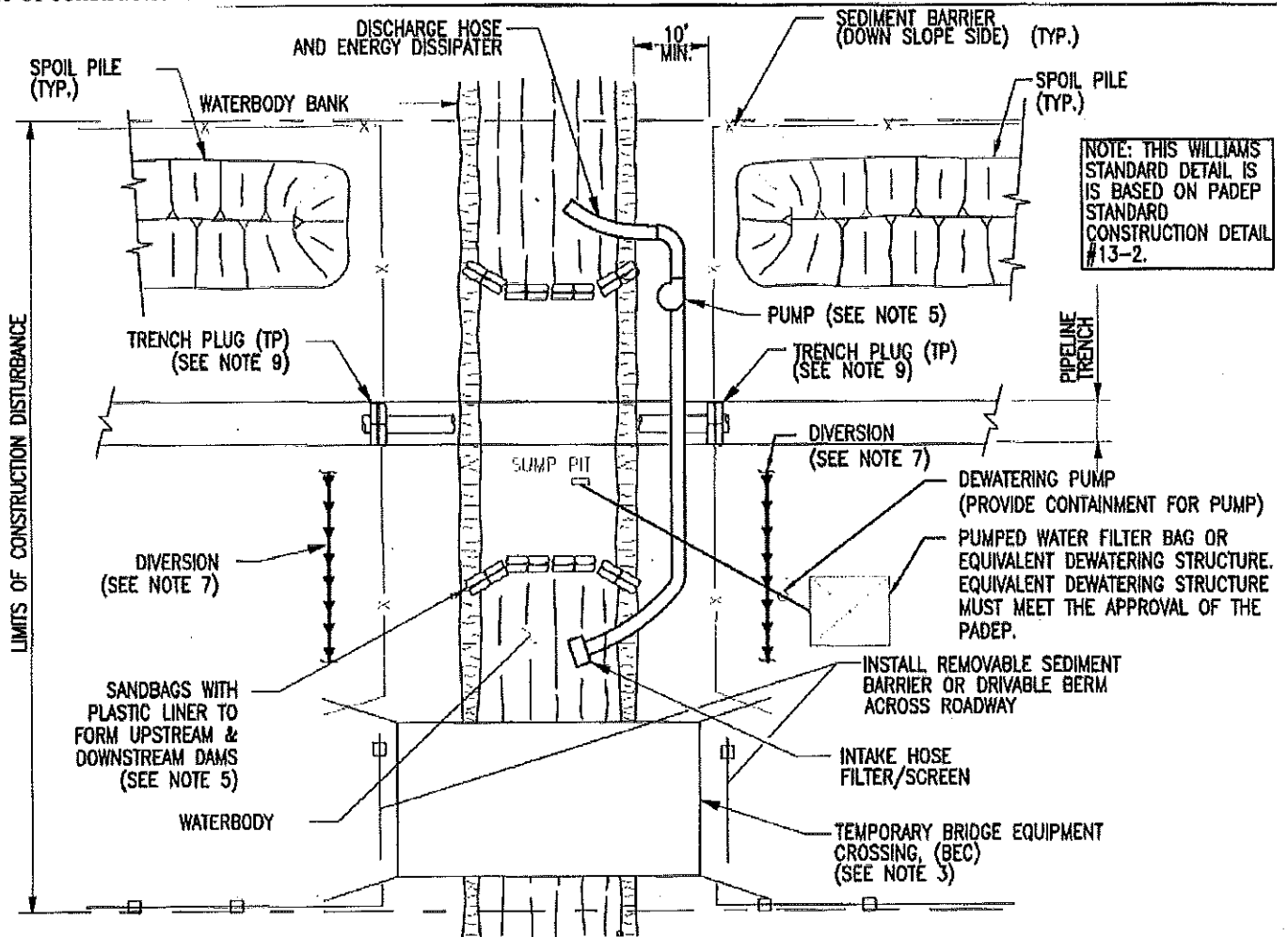

APPLICANT Transco	PROJECT LOCATION Atlantic Sunrise Project – Unity Loop Jordan, Franklin and Penn Township Lycoming County	APPLICATION NUMBER E41-667
----------------------	--	-------------------------------

Along with the utility stream crossings, there are equipment bridge crossings which will be placed for equipment crossing the stream during the construction of the utility line. These equipment crossing bridges will be temporary, however they will remain in place until the final restoration of the crossing site has been completed. The type of equipment crossing bridges for Lycoming County are as follows:

Temporary Bridge Equipment Crossing (BEC).

Timber mat bridge that does not have any culverts. It is a single span bridge which will be used for small stream crossings less than 40 feet in width. The proposed temporary bridge equipment crossing will span the stream bank-to-bank. Geo-textile material will be placed underneath the bridge to limit the amount of sediment from falling off the timbers into the stream.

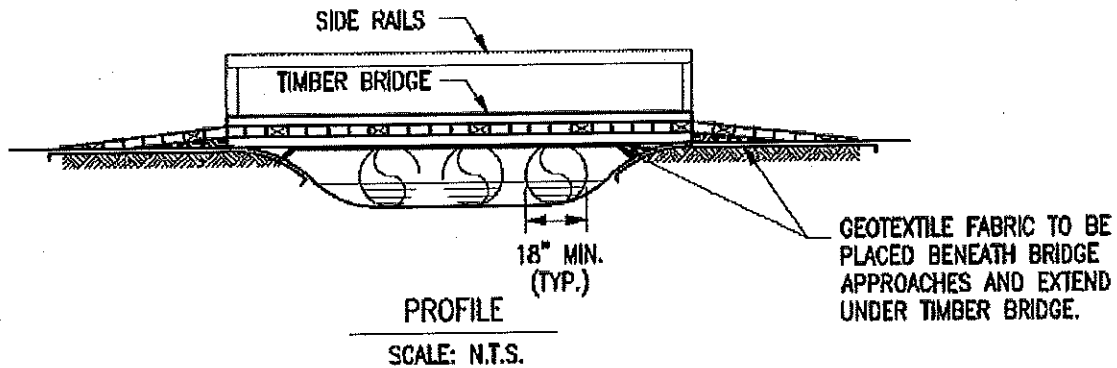
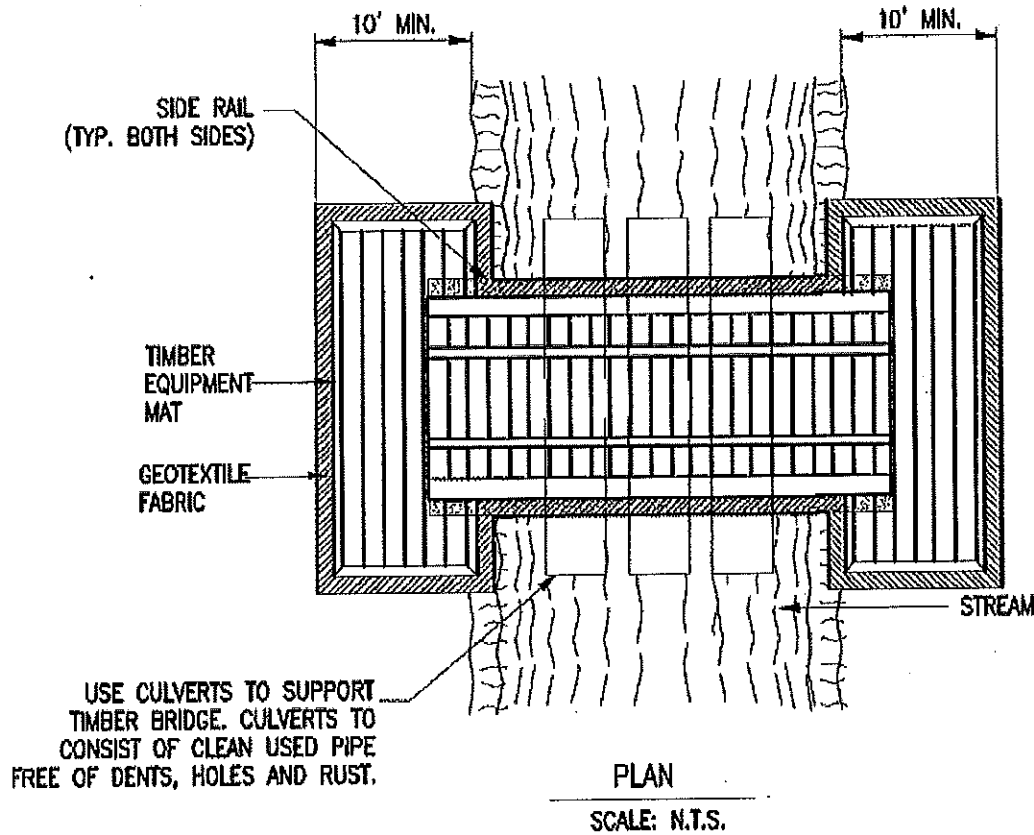

APPLICANT	Transco	PROJECT LOCATION	Atlantic Sunrise Project – Unity Loop Jordan, Franklin and Penn Township Lycoming County	APPLICATION NUMBER	E41-667
-----------	---------	------------------	--	--------------------	---------

Wetland Equipment Crossing (WEC)

Temporary Conditions (Wetlands):

Wetlands will be crossed using the Wetland Equipment Crossing. This crossing has timber mats that will be placed on grade with the wetland. All equipment mats, temporary timber, riprap and other construction debris will be removed during the final grading of the wetland. Trench plugs will be installed at the base of slopes near the boundary of the wetland and adjacent upland areas and the bottom of the trench will be sealed to maintain the original wetland hydrology. The wetlands will be restored to their original contours. In Forested Wetlands, the regrowth of woody vegetation will be permitted; however, Palustrine Forested (PFO) wetlands will be converted to Palustrine Scrub-Shrub (PSS)/ Palustrine Emergent (PEM) wetlands within the permanently maintained right-of-way.

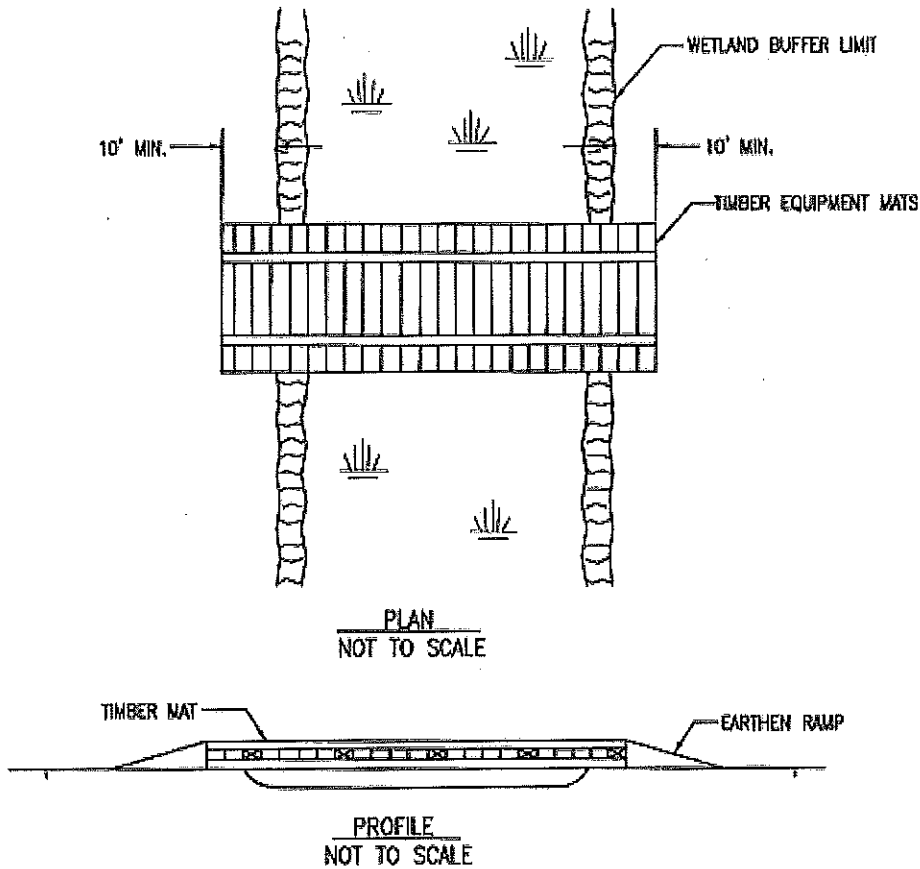

APPLICANT	Transco	PROJECT LOCATION	Atlantic Sunrise Project – Unity Loop Jordan, Franklin and Penn Township Lycoming County	APPLICATION NUMBER	E41-667
-----------	---------	------------------	--	--------------------	---------

Stream bank stabilization will be of two types. One will be a Stream Bank Stabilization with Reinforcement Blanket and the other will be a Rip Rap Stream Bank Stabilization. The existing streambed material will be stockpiled separately and after the pipeline has been constructed, the streambed material will be placed in its original position to restore the streambed.

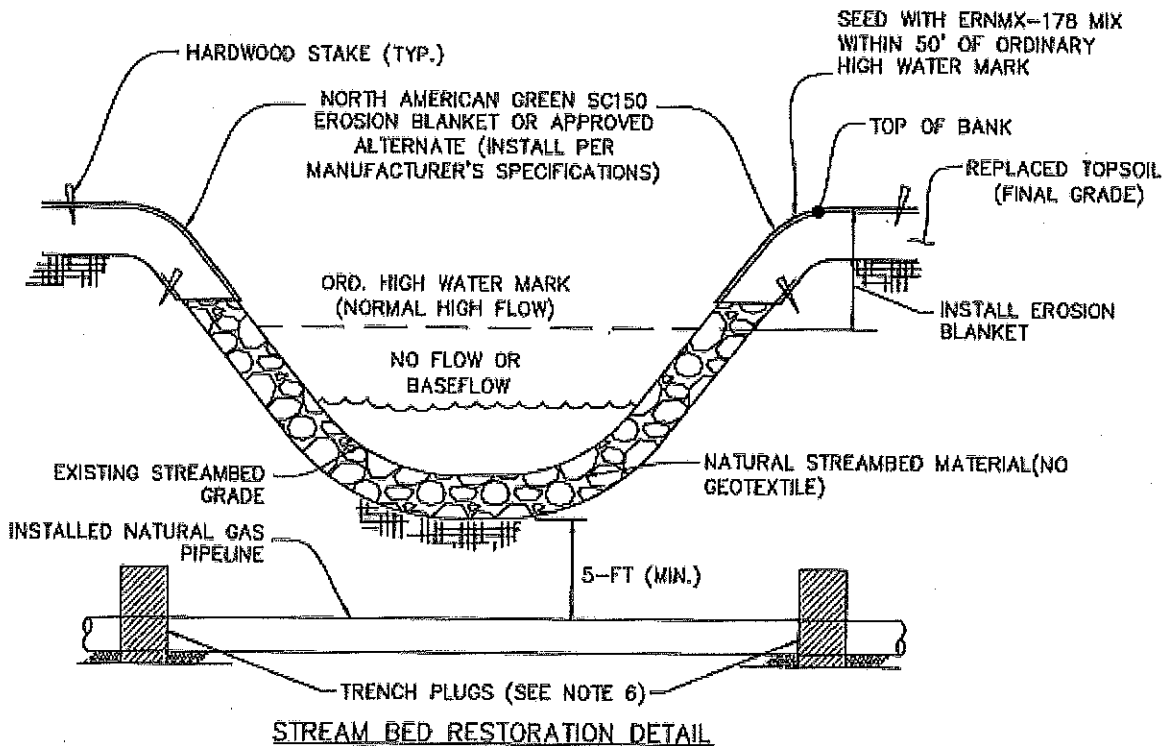
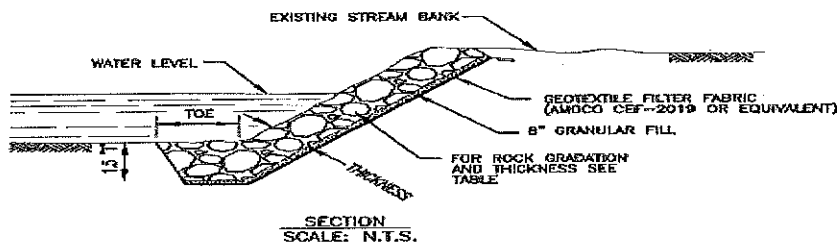
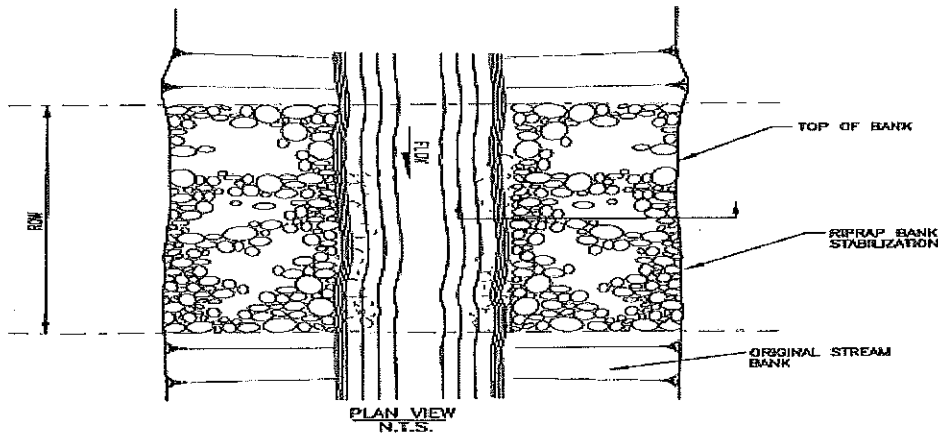

APPLICANT	Transco	PROJECT LOCATION	Atlantic Sunrise Project – Unity Loop Jordan, Franklin and Penn Township Lycoming County	APPLICATION NUMBER	E41-667
-----------	---------	------------------	--	--------------------	---------

PROJECT COORDINATION:

1. **Pre-App Meeting:** Several pre-application meetings were held, with the final meeting being on June 3, 2015 with PA Fish and Boat Commission, Army Corps of Engineers (ACOE) and DEP.
2. **ACOE Reporting:** 401 Water Quality Certification is included in this approval and the ACOE will issue their own permit. The PASPGP-5 Permit is not included in this review.
3. **Submerged Land License Agreement (SLLA) Submittal History:** SLLA application for natural gas pipeline crossing under Beaver Run was sent to Central Office on 4/18/2017. SLLA for E41-667, Transcontinental Gas Pipe Line Company, has been approved and the agreement date is 5/3/2017.
4. **PHMC Submittal History:** Transco submitted the project to Pennsylvania Historical and Museum Commission (PHMC) on June 4, 2015. March 8, 2016, letter from PHMC requires additional information. On July 14, 2016, a letter from PHMC, indicated that no further work is necessary from Transco.
5. **PNDI Search History:** See the Environmental Review for Chapter 105 Applications for the Pennsylvania Natural Diversity Index (PNDI) Submittal History. PNDIs were first submitted to US Fish and Wildlife Service (USFWS), PA Department of Conservation and Natural Resources (DCNR), PA Game Commission (PGC) and PA Fish and Boat Commission (PAFBC) on March 7, 2014. Follow-up PNDI requests were submitted to the agencies on January 15, 2015.
 - a. USFWS – April 28, 2014 – Northern long eared bat & Indian Bat
 - December 21, 2016. USFWS clear both bat species
 - b. DCNR – May 28, 2014, April 2, 2015 and May 28, 2015 (Dwarf Juniper and Vaey’s Pondweed)
 - February 23, 2016. DCNR has determined that no impact is likely.
 - c. PAFBC – April 14, 2014, January 27, 2015 and February 11, 2015 (Timber Rattlesnake)
 - May 31, 2016. PAFB provided clearance letter with no adverse impact.
 - d. PGC – April 3, 2014
 - June 2, 2016. PAGC provided clearance letter with recommended conservation measures.
6. **P.E. Seal Required?** YES NO N/A
7. **Risk Assessment Required?** YES NO N/A
8. **Flowage Easement Required?** YES NO N/A

FINAL PROJECT DESIGN:

Transco and their consultant team met with multiple Federal and State regulatory agencies at a pre-application meeting on June 3, 2015.

ASR WOEP Application E41-667 was initially received by DEP North Central Regional Office Waterways and Wetland Program (NCRO) on August 10, 2015. NCRO engineering and environmental staff conducted administrative completeness review, deeming the application administratively complete on September 3, 2015.

NCRO engineering and environmental staff conducted application review. Technical deficiencies were found and listed in a technical deficiency notification. This technical deficiency notification listing ASR-Unity Loop was sent to Transco on January 25, 2016. Responses to the technical deficiency notification were received by NCRO on March 15, 2016 and April 25, 2016.

NCRO engineering and environmental staff conducted application review and technical deficiencies were found and listed in a technical deficiency notification. This technical deficiency notification listing ASR-Unity Loop was sent to Transco on June 29, 2016. A project review meeting was held on July 6, 2016 at DEP – NCRO to discuss the comments and response matrix. Responses to this technical deficiency notification were received by NCRO on August 25, 2016. Transco provided NCRO revisions and application updates on January 20, 2017.

APPLICANT	Transco	PROJECT LOCATION	Atlantic Sunrise Project – Unity Loop Jordan, Franklin and Penn Township Lycoming County	APPLICATION NUMBER	E41-667
-----------	---------	------------------	--	--------------------	---------

COMMENTS AND CONCLUSION:

Transco proposes to install approximately 8.6-miles of 42-inch diameter natural gas pipeline, which is co-located with the existing Leidy Line system in Jordan, Franklin and Penn Township – Lycoming County (Approximately 1.1 miles in Jordan Township, 2.4 miles in Franklin Township and 5.1 miles in Penn Township)

All in-stream pipeline construction activities shall be performed in dry work conditions by dam and pumping flow around the work areas. All streams encountered by pipeline construction are wild trout or tributary to wild trout fisheries. No pipeline construction or future maintenance work shall be performed in or along the stream channels between October 1 and December 31 without prior written approval from the Pennsylvania Fish and Boat Commission.

West Branch Muncy Creek has an Existing Use of Exceptional Value (EV). The Department requested justification for the use of an open trench versus a trenchless crossing method for this EV watershed and the applicant provided justification that trenchless methods were not feasible. Subsequently, the applicant provided justification for all open-cut crossing methods. Open-cut crossing will be made under dry conditions, either when the stream is not flowing or through the use of dam-and-pump or other dry crossing methods.

Engineering staff review of final technical plans, drawing and specifications concluded ASR Unity Loop, required a random wide temporary construction right-of-way and a 50-foot permanent right-of way for maintenance of the pipeline. Review of various final project site plans also led to the conclusion that temporary work spaces and alternate temporary work spaces were required. These temporary and alternative work spaces were designed for site specific conditions for pipeline construction. For example, additional and alternate work spaces are required to adhere to safety standards established by Federal (e.g., U.S. Occupational Safety and Health Administration) or State (e.g., Pennsylvania Department of Transportation) agencies for pipeline installation approaching railroads, public roads, watercourses, wetlands and agricultural lands. With respect to subsurface pipeline installation crossing beneath watercourses, floodways and wetlands, specialized construction techniques are required.

Final technical plans, drawings and specifications established all temporary and alternate temporary work spaces are to be reverted to prior land use. Technical plans also specified the restoration and revegetation at temporary work spaces, alternate temporary work spaces, and temporary construction right-of-way. Trees, shrubs and other types of pre-existing vegetative cover, of course, would have been removed for subsurface pipeline installation. Design specifications established that all open-trench pipeline installation areas crossing watercourses, floodways and wetlands are to be restored to pre-existing contours and elevations to the maximum extent practicable. Similarly, design specifications established temporary bridge equipment crossings at watercourse and wetland crossings, along with temporary access roads in floodways, are also to be restored to original contours to the greatest extent practicable. Final design plans, cross-sections and specifications also established that stream banks, disturbed by open trench pipeline installation, are to be stabilized per accepted DEP design standards. Federally required operation and maintenance performance standards outlined by Transco indicated ASR requires regular inspections including watercourse floodway and wetland crossing locations.

ENVIRONMENTAL COMMENTS AND CONCLUSIONS:

Biologist Amanda Allison has reviewed this project and has recommended approval. Recommendations and concerns are addressed in attached Record of Decision provided by Allison.

For the complete Atlantic Sunrise Project, five mitigation sites have been proposed, distributed across the watersheds impacted by the project. For the Unity Loop in Lycoming County, the applicant has proposed to mitigate for wetland impacts at the Headwaters to Larry’s Creek, at a site located along Windy Ridge Road in Anthony Township, Lycoming County (41° 18’ 24.1” N, 77° 11’ 17.0” W). The mitigation site consists of a total of 9.98 acres, with 5.50 acres of PEM wetlands currently on site. Larrys Creek traverses the site from east to west. As Larrys Creek is an EV watershed and a Wild Trout stream, the wetlands on the mitigation site are EV.

Since the 42-inch diameter ASR-Unity Loop has been designed for installation and operation entirely subsurface with all disturbances restored, any proposed impacts incurred at Regulated Waters of this Commonwealth, (i.e., watercourses,

APPLICANT	Tranco	PROJECT LOCATION	Atlantic Sunrise Project – Unity Loop Jordan, Franklin and Penn Township Lycoming County	APPLICATION NUMBER	E41-667
-----------	--------	------------------	--	--------------------	---------

floodways and wetlands) were determined by engineering review staff as effectively being temporary. For this reason, no permanent detrimental impacts to the existing hydrologic or hydraulic characteristics of the identified watercourses, floodways and wetlands are anticipated.

The reviewers found the proposed pipeline met the regulatory requirements of Chapter 105, Subchapter G, 25 Pa. Code § 105.1 *et seq.*, as related to pipeline crossings. The engineering review specifically included 25 Pa. Code §§105.13, 105.14, 105.21, 105.161, 105.301, 105.302, 105.311, 105.312, 105.313, and 105.314. The reviewing engineering staff incorporated all special conditions and limitations that were recommended by the reviewing Water Pollution Control Biologist into the permit. In conclusion, since the ASR WOEP E41-667 Application comports with the requirements of the Department's Chapter 25 Pa. Code § 105 Regulations, 25 Pa. Code § 105.1 *et seq.*, and the proposed project does not pose any significant threat to life, health, safety, or property, permit issuance was recommended.

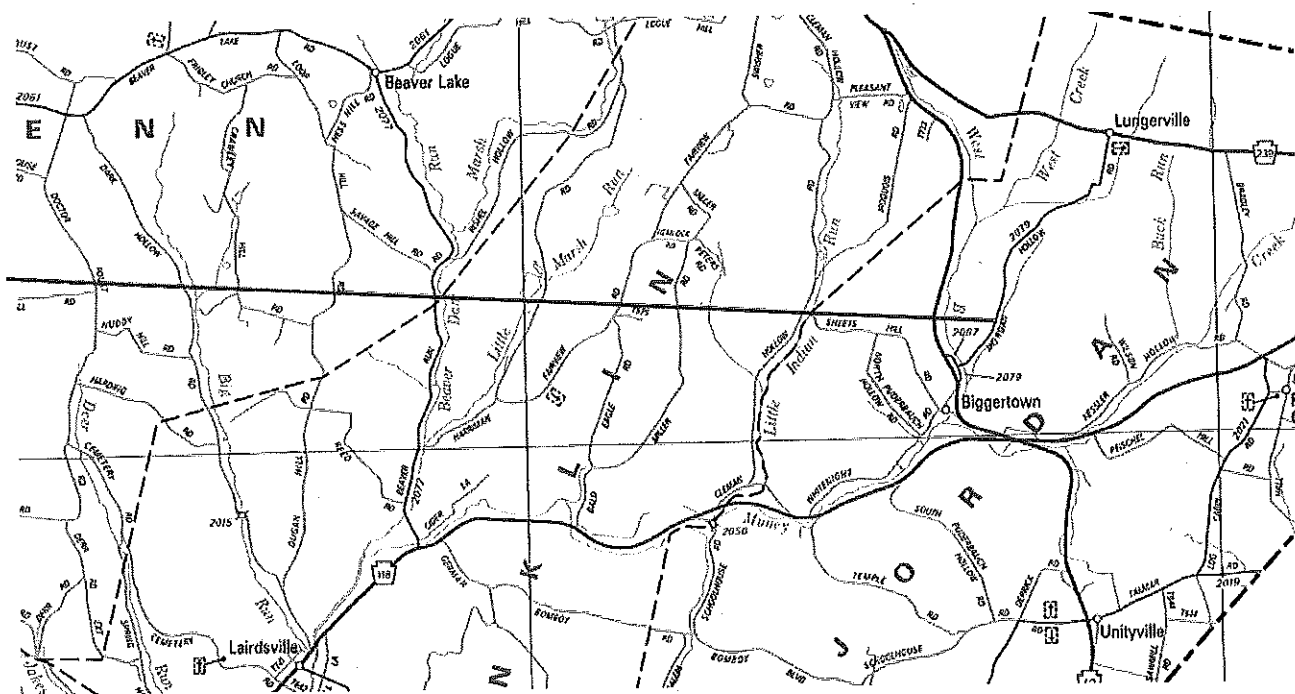
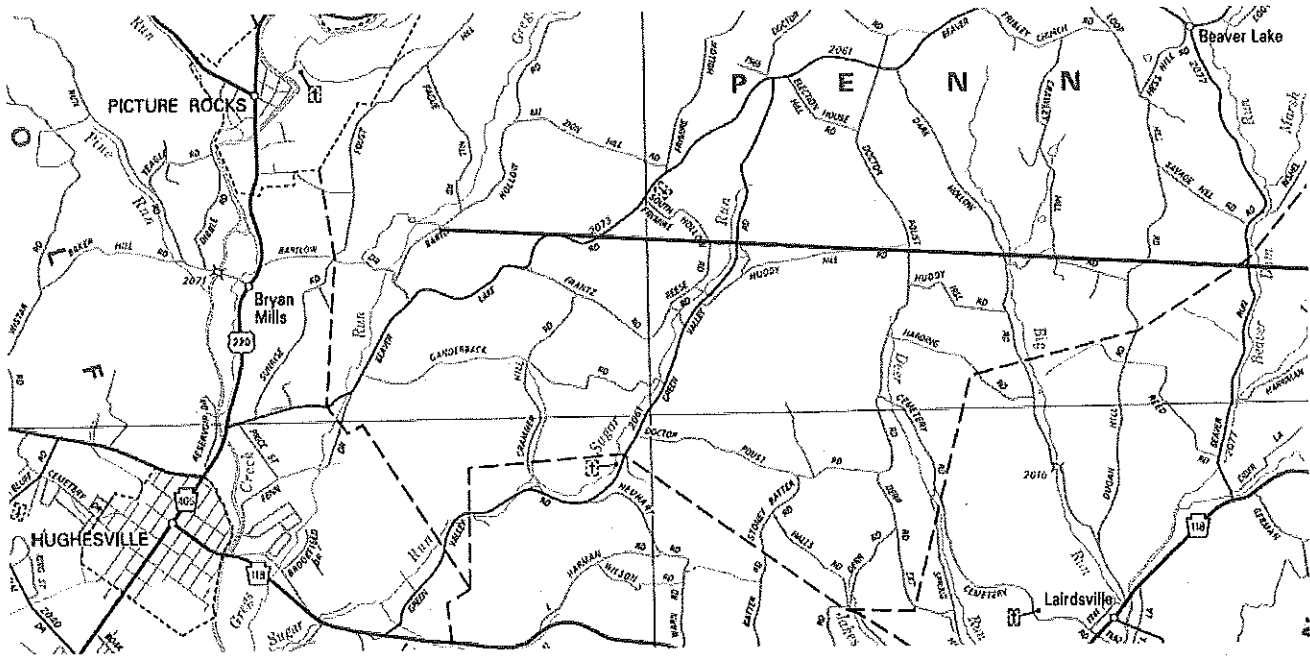

APPLICANT	Transco	PROJECT LOCATION	Atlantic Sunrise Project – Unity Loop Jordan, Franklin and Penn Township Lycoming County	APPLICATION NUMBER	E41-667
-----------	---------	------------------	--	--------------------	---------

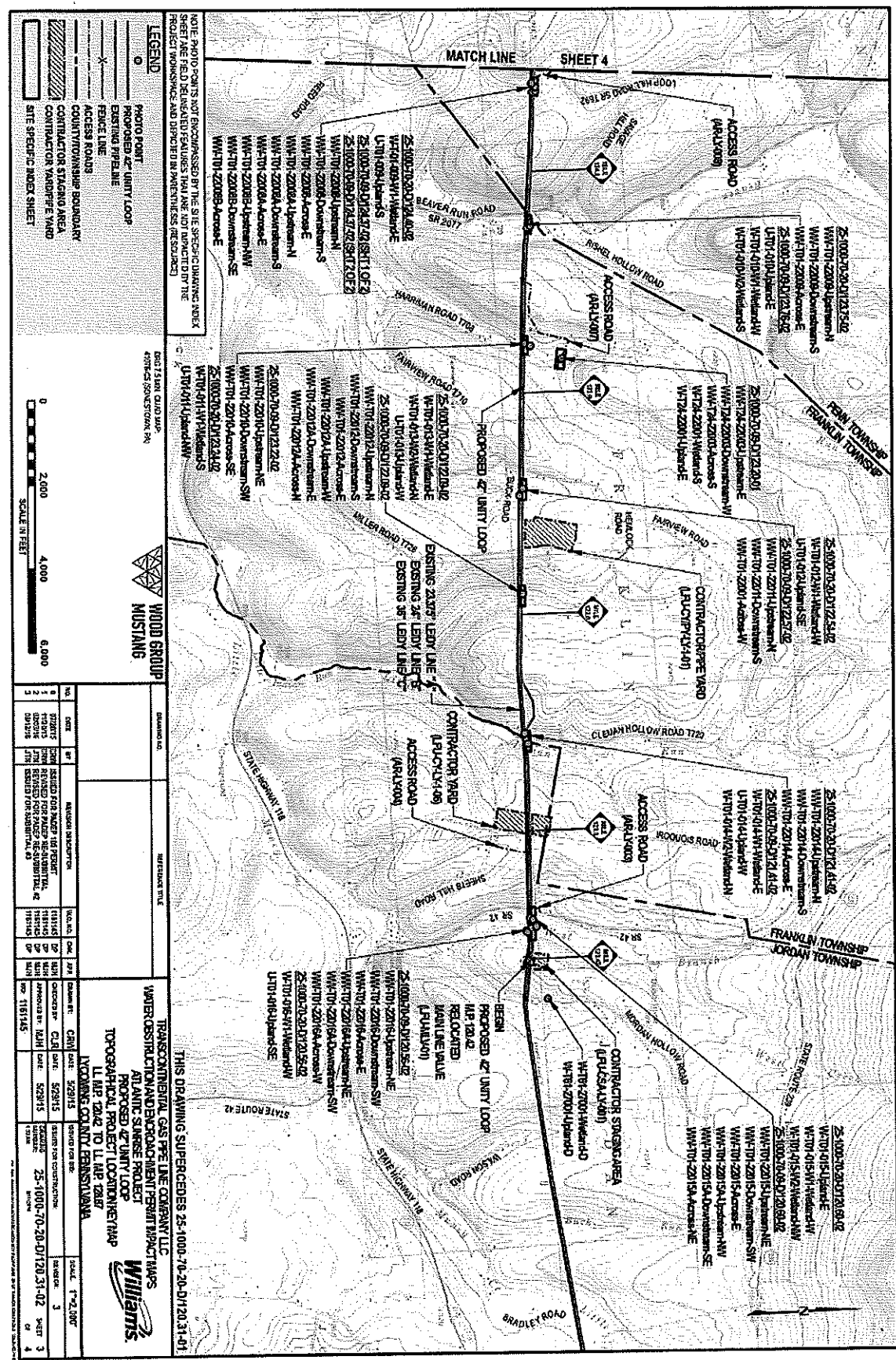

LEGEND

- PHOTO POINT
- PROPOSED G.P. UNITY LOOP
- EXISTING PIPELINE
- FENCE LINE
- ACCESS ROADS
- CONTRACTOR STAGING AREA
- CONTRACTOR WAREHOUSE YARD
- SITE SPECIFIC INDEX SHEET

NOTE: PHOTO POINTS NOT INCORPORATED BY THE SITE SPECIFIC CHANGING INDEX SHEET. THESE POINTS WILL BE LOCATED BY THE FIELD SURVEYOR. THE PROJECT WORKSPACE AND DEPICTED IN PARALLEL WITH THE PROJECT.

WOOD GROUP
MUSTANG

NO.	DATE	BY	REVISION
1	08/11/15	WJ	ISSUED FOR PERMIT
2	08/11/15	WJ	REVISED FOR PERMIT
3	08/11/15	WJ	REVISED FOR PERMIT

THIS DRAWING SUPERSEDES 25-1000-70-20-D120.31-01
 TRANSCO CONTINGENTIAL GAS PIPE LINE COMPANY LLC
 UNDER CONTRACT AND DEVELOPMENT PERMIT PROJECTS
 ATLANTIC SUNRISE PROJECT
 PROPOSED G.P. UNITY LOOP
 TOPOGRAPHICAL PROJECT LOCATION MAP
 LI MAP 2042 TO LI MAP 2048
 LYCOMING COUNTY, PENNSYLVANIA



DATE	08/11/15
SCALE	1"=2,000'
SHEET	3
TOTAL SHEETS	3

APPLICANT	Transco	PROJECT LOCATION	Atlantic Sunrise Project – Unity Loop Jordan, Franklin and Penn Township Lycoming County	APPLICATION NUMBER	E41-667
-----------	---------	------------------	--	--------------------	---------

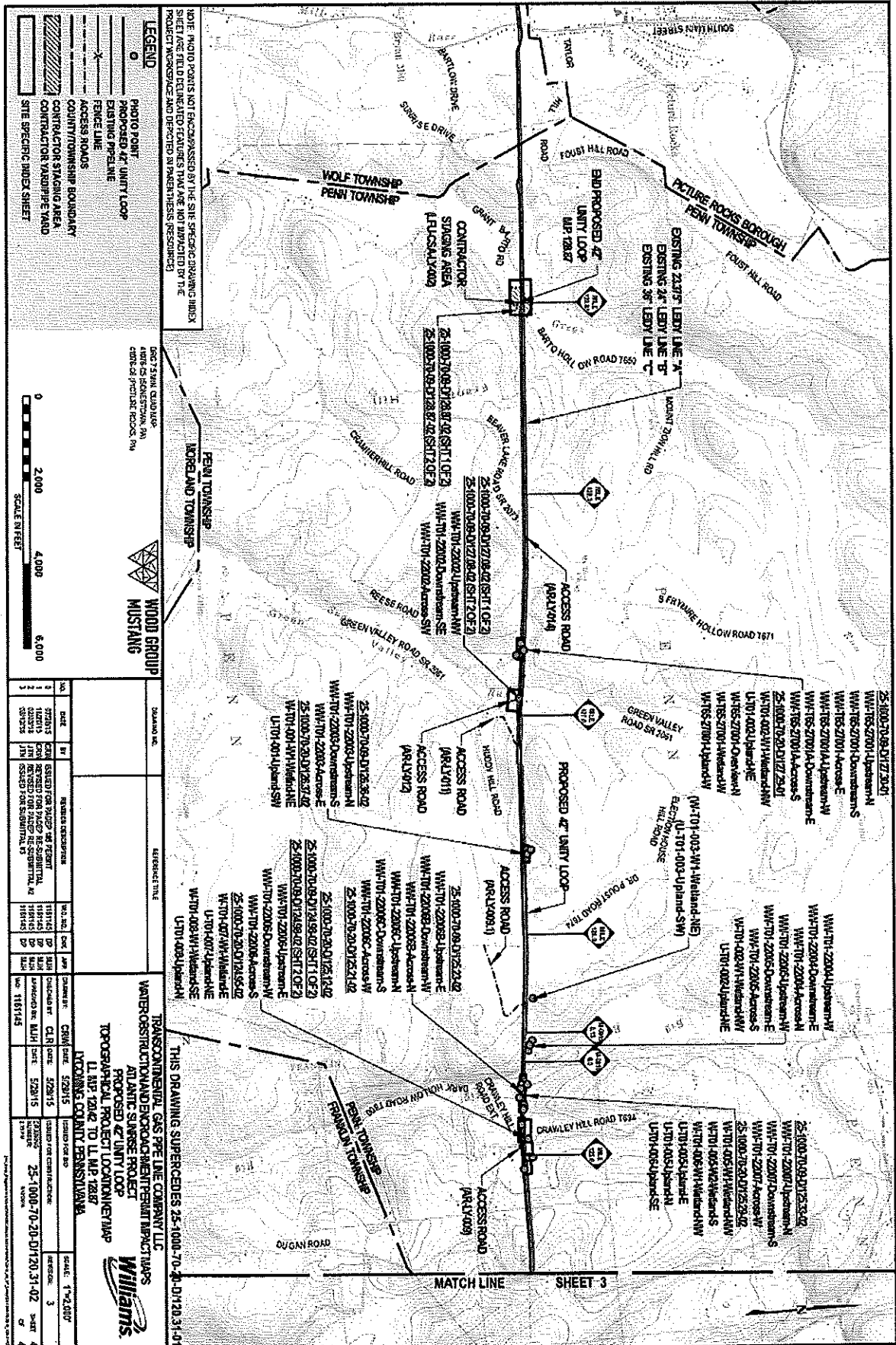

NOTE: PHOTO POINTS NOT ENCOMPASSED BY THE SITE SPECIFIC DRAWING INDEX SHEET ARE FIELD DELINEATED FEATURES THAT ARE NOT IMPACTED BY THE PROJECT WORKSPACE AND DIRECTED TO PERTINENT RESOURCES.

LEGEND

- PHOTO POINT
- PROPOSED 42" UNITY LOOP
- EXISTING PIPELINE
- FENCE LINE
- ACCESS ROADS
- COUNTY/TOWNSHIP BOUNDARY
- CONTRACTOR STAGING AREA
- CONTRACTOR YARD/PIPE YARD
- SITE SPECIFIC INDEX SHEET

SOFT TISSUE VEGETATION
APRIL 25, 2015
DATE OF PHOTO POINT, IN



NO.	DATE	BY	REVISIONS
1	07/27/15	CEM	ISSUED FOR PERMIT
2	08/11/15	CEM	REVISION FOR PERMIT
3	08/11/15	CEM	REVISION FOR PERMIT
4	08/11/15	CEM	REVISION FOR PERMIT

THIS DRAWING SUPERSEDES 25-1000-70-20-D1720-31-01

TRANSCONTINENTAL GAS PIPE LINE COMPANY LLC
WATER OBSTRUCTION AND ENCROACHMENT PERMIT IMPACT STUDY
ATLANTIC SUNRISE PROJECT
PROPOSED 42" UNITY LOOP
TOPOGRAPHICAL PROJECT LOCATION/IMPACT
L1 IMP 1242 TO L1 IMP 1247



NO.	DATE	BY	REVISIONS
1	07/27/15	CEM	ISSUED FOR PERMIT
2	08/11/15	CEM	REVISION FOR PERMIT
3	08/11/15	CEM	REVISION FOR PERMIT
4	08/11/15	CEM	REVISION FOR PERMIT

APPENDIX I

Stream Impact Table: Lycoming County																	
Crossing Number	Impact Number	Identification		Location				Stream Impacts				Floodway Impacts		Crossing Information			
		Stream Identification	Stream Name	Chapter 93 Designated Use	Latitude	Longitude	Municipality (Township)	Quadrangle	Temporary Crossing Length (feet)	Permanent Crossing Length (feet)	Temporary Impact Area (acres)	Permanent Impact Area (acres)	Temporary Impact (acres)	Permanent Impact (acres)	Crossing Type	Crossing Method	Trou Identification
1	2, 3, 4, 5	WW-T01-22016	West Branch Little Muncy Creek	CWF, EV	41.26185	-76.53174	Jordan	Sonestown	109.84	5.32	0.0321	0.0018	0.1534	0.0085	GAS	I	WT
		WW-T01-22016A	UNT to West Branch Little Muncy Creek	CWF, EV	41.26190	-76.53191	Jordan	Sonestown	95.72	5.04	0.0393	0.0024	0.1035	0.0045	GAS	I	WT
2	6, 7, 8, 9	WW-T01-22015	UNT to West Branch Little Muncy Creek	CWF, EV	41.26185	-76.53251	Jordan	Sonestown	76.23	6.28	0.0082	0.0005	0.1280	0.0086	GAS	I	WT
		WW-T01-22015A	UNT to West Branch Little Muncy Creek	CWF, EV	41.26194	-76.53249	Jordan	Sonestown	28.25	0.00	0.0037	0.0000	0.0000	0.0000	GAS	V	WT
3	14	WW-T01-22014	Little Indian Run	CWF, MF	41.26211	-76.54800	Franklin	Sonestown	72.34	5.14	0.0249	0.0017	0.0110	0.0004	GAS	I	WT
		WW-T01-22012	UNT to Little Indian Run	CWF, MF	41.26226	-76.56057	Franklin	Sonestown	71.53	5.04	0.0177	0.0013	0.0963	0.0061	GAS	I	WT
4	26, 27, 29, 30	WW-T01-22012A	UNT to Little Indian Run	CWF, MF	41.26233	-76.56067	Franklin	Sonestown	96.97	5.30	0.0095	0.0006	0.0000	0.0000	GAS	I	WT
		WW-T01-22011	UNT to Little Muncy Creek	CWF, MF	41.26269	-76.56980	Franklin	Sonestown	97.48	5.04	0.0361	0.0020	0.0913	0.0057	GAS	I	WT
5	33, 34	WW-T01-22010	UNT Beaver Run	CWF, MF	41.26327	-76.58225	Franklin	Sonestown	106.04	5.02	0.0914	0.0047	0.0204	0.0007	GAS	I	WT
		WW-T01-22009	Beaver Run	CWF, MF	41.26391	-76.59270	Franklin	Sonestown	114.12	5.73	0.1272	0.0069	0.0860	0.0043	GAS	I	WT
6	51, 52, 53, 54	WW-T01-22008A	UNT Beaver Run	CWF, MF	41.26475	-76.60401	Penn	Sonestown	59.35	0.00	0.0314	0.0000	0.0000	0.0000	GAS	V	WT
		WW-T01-22008	UNT Beaver Run	CWF, MF	41.26465	-76.60409	Penn	Sonestown	100.16	5.15	0.0526	0.0034	0.3143	0.0151	GAS	I	WT
7	56, 57, 58, 59	WW-T01-22008B	UNT to Beaver Run	CWF, MF	41.26470	-76.60449	Penn	Sonestown	165.66	6.64	0.0503	0.0019	0.0000	0.0000	GAS	I	WT
		WW-T01-22006	UNT Big Run	CWF, MF	41.26480	-76.61861	Penn	Sonestown	0.00	0.00	0.0000	0.0000	0.5615	0.0259	GAS	IV	None
8	60, 61	WW-T01-22006B	UNT Big Run	CWF, MF	41.26494	-76.62088	Penn	Sonestown	211.30	10.82	0.0619	0.0047	0.4130	0.0127	GAS	I	None
		WW-T01-22007	Big Run	CWF, MF	41.26506	-76.62246	Penn	Sonestown	85.93	6.51	0.0276	0.0022	0.0037	0.0000	GAS	I	None

APPENDIX I

15	87, 88, 89, 90	WW-T01-22003	UNT to Sugar Run	CWF, MF	41.26643	-76.64225	Penn	Picture Rocks	98.56	5.13	0.0193	0.0011	0.1941	0.0097	GAS	I	WT
16	93, 94, 95, 96	WW-T01-22002	Sugar Run	CWF, MF	41.26670	-76.65584	Penn	Picture Rocks	95.94	5.01	0.0449	0.0022	0.5368	0.0257	GAS	I	WT
17	99, 100, 101, 102	WW-T65-27001	UNT to Sugar Run	CWF, MF	41.26710	-76.65992	Penn	Picture Rocks	98.63	5.07	0.0182	0.0010	0.5992	0.0340	GAS	I	WT
	103	WW-T65-27001A	UNT to Sugar Run	CWF, MF	41.26709	-76.66030	Penn	Picture Rocks	214.04	0.00	0.0235	0.0000	0.0000	0.0000	GAS	V	WT
18	104	WW-T46-22001	Greg's Run	CWF, MF	41.26870	-76.69109	Penn	Picture Rocks	0.00	0.00	0.0000	0.0000	1.1192	0.0000	GAS	IV	None
	105	WW-T71-22001	UNT to Greg's Run	CWF, MF	41.26928	-76.68895	Penn	Picture Rocks	0.00	0.00	0.0000	0.0000	0.1207	0.0000	GAS	IV	None
19	106	WW-T24-22003	UNT to Beaver Run	CWF, MF	41.26552	-76.58082	Franklin	Sonestown	0.00	0.00	0.0000	0.0000	0.0351	0.0000	TEMPRD	IV	WT
20	107	WW-T01-22002	Sugar Run	CWF, MF	41.26670	-76.65584	Penn	Picture Rocks	0.00	0.00	0.0000	0.0000	0.1849	0.0000	TEMPRD	IV	WT
Totals									1998.11	92.25	0.7197	0.0386	4.7724	0.1620			

^a Impact numbers correspond to the impact numbers presented in Attachment E-2 of Transco's Chapter 105 Application.

^b Gas=gas pipeline crossing or floodway impacts, TBC=temporary bridge crossing, TEMPRD = temporary road crossing

^c I=Dry Crossing Method includes Dam & Pump, Flume, or Cofferdam, II=Trenchless Crossing Method - Horizontal Directional Drill, III=Trenchless Crossing Method - Conventional Bore, IV=Floodway Impacts Only; V=Bridge Equipment Crossing

^d PAFBC Designations: ST = Stocked Trout; WT = Wild Trout; CA = Class A Trout

APPENDIX I

Wetland Impact Table: Locoming County

Identification		Location			Wetland Impacts						Crossing Information		State Wetland Classification (Other OR BV)		
Crossing Number	Impact Number	Wetland Identification	Latitude	Longitude	Municipality (Township)	Quadrangle	Temporary Impact Area (acres)		Permanent Impact Area (acres)		Crossing Type	Crossing Method			
							PEO	PSS	PEM	PFO	PSS	PEM			
1	1	W-T01-22016	41.26176	-76.53175	Jordan	Sonestown	0.0000	0.0000	0.0096	0.0000	0.0000	0.0000	GAS	IV	EV
3	15, 16, 17	W-T01-22015	41.26204	-76.53266	Jordan	Sonestown	0.0005	0.0000	0.1266	0.0000	0.0000	0.0079	GAS	I	EV
4	18, 19, 20, 21	W-T01-22014	41.26206	-76.54771	Franklin	Sonestown	0.0917	0.0000	0.2203	0.0353	0.0000	0.0184	GAS	I	EV
5	28, 31, 32	W-T01-22013	41.26218	-76.56039	Franklin	Sonestown	0.0318	0.0000	0.0597	0.0149	0.0000	0.0000	GAS	I	EV
6	39, 40	W-T01-22012	41.26270	-76.57002	Franklin	Sonestown	0.0000	0.0000	0.3548	0.0000	0.0000	0.0227	GAS	I	EV
7	45, 46	W-T01-22011-1	41.26321	-76.58238	Franklin	Sonestown	0.0000	0.0000	0.0035	0.0000	0.0000	0.0004	GAS	I	EV
8	47, 48, 49, 50	W-T01-22010	41.26393	-76.59242	Franklin	Sonestown	0.0483	0.0000	0.0334	0.0098	0.0000	0.0032	GAS	I	EV
9	62, 63	W-T01-22009 / W-T01-22009-1	41.26469	-76.60473	Penn	Sonestown	0.0000	0.0000	0.2422	0.0000	0.0000	0.0154	GAS	I	EV
10	65	W-T01-22007	41.26496	-76.61570	Penn	Sonestown	0.0054	0.0000	0.0000	0.0000	0.0000	0.0000	GAS	IV	EV
11	67, 68	W-T01-22004	41.26472	-76.61879	Penn	Sonestown	0.0000	0.0000	0.1057	0.0000	0.0000	0.0011	GAS	I	EV
12	71, 72	W-T01-22006	41.26491	-76.62049	Penn	Sonestown	0.0000	0.0000	0.1491	0.0000	0.0000	0.0107	GAS	I	EV
13	77, 78, 79	W-T01-22005	41.26503	-76.62218	Penn	Sonestown	<0.0001	0.0000	0.4154	0.0000	0.0000	0.0263	GAS	I	EV
15	91, 92	W-T01-22001	41.26647	-76.64240	Penn	Picture Rocks	0.0000	0.0000	0.0308	0.0000	0.0000	0.0019	GAS	I	EV
17	97, 98	W-T65-27001	41.26695	-76.65971	Penn	Picture Rocks	0.0000	<0.0001	0.0012	0.0000	0.0000	0.0000	GAS	IV	EV
Totals							0.1777	0.0000	1.7524	0.0600	0.0000	0.1080			

*Atlantic Sunrise Project – PA DEP Chapter 105 Permit Application
Transcontinental Gas Pipeline Company, LLC
Lycoming County*

**ATTACHMENT E -2
PA DEP IMPACT TABLE**

Revised August 25, 2016

Impact Table for Individual Permit Application

Applicant: Transcontinental Gas Pipe Line Company, LLC (Tranco)
 Project Name: Atlantic Sunrise Project (Project)

Impact Plan Sheet Number	Description of Impact (P1, road/utility crossing, grading)	Structure Type and Dimensions	Resource Type (stream, wetland, floodway, body of water)	Resource Name*	Chapter 99 Classification, Wetland Classification (EV or Other), or Floodway Type	Wetland (Downstream Classification)	Stream Type (Intermittent, Perennial)	Stream Trout Status (Class A Wild Trout, Wild Trout, Trout Stocked)	Temporary or Permanent Impact	Crossing Method	Impact Dimensions (Length x Width) (feet)	Floodway Fill (cu. yds)	Impacts Area (acres)	Latitude	Longitude	Municipality	USGS Quad
1	Utility Pipeline Crossing	Equipment Access and E&S Controls	Wetland	W-701-22015	EV	PEM	N/A	N/A	Temporary	N/A	147.92 x 10.13	N/A	0.0396	41.26176	-76.53175	Jordan	Sonestown
2	Utility Pipeline Crossing	Equipment Access and E&S Controls	Stream	West Branch Little Muncy Creek	CMF, EV	N/A	Perennial	Wild Trout Waters	Temporary	Dam-and-Pump	109.84 x 15.98	N/A	0.0921	41.26185	-76.53174	Jordan	Sonestown
3	Utility Pipeline Crossing	Equipment Access and E&S Controls	Stream	West Branch Little Muncy Creek	CMF, EV	N/A	Perennial	Wild Trout Waters	Permanent	Dam-and-Pump	5.32 x 15.98	N/A	0.0018	41.26185	-76.53174	Jordan	Sonestown
4	Utility Pipeline Crossing	Equipment Access and E&S Controls	Floodway	Floodway to West Branch Little Muncy Creek	Assumed 50 Feet	N/A	N/A	N/A	Temporary	N/A	137.09 x 94.33	N/A	0.1354	41.26185	-76.53174	Jordan	Sonestown
5	Utility Pipeline Crossing	Equipment Access and E&S Controls	Floodway	Floodway to West Branch Little Muncy Creek	Assumed 50 Feet	N/A	N/A	N/A	Permanent	N/A	91.39 x 5.00	N/A	0.0085	41.26185	-76.53174	Jordan	Sonestown
6	Utility Pipeline Crossing	Equipment Access and E&S Controls	Stream	UNT to West Branch Little Muncy Creek	CMF, EV	N/A	Ephemeral	Wild Trout Waters	Temporary	Dam-and-Pump	95.72 x 21.04	N/A	0.0363	41.26190	-76.53151	Jordan	Sonestown
7	Utility Pipeline Crossing	Equipment Access and E&S Controls	Stream	UNT to West Branch Little Muncy Creek	CMF, EV	N/A	Ephemeral	Wild Trout Waters	Permanent	Dam-and-Pump	5.04 x 21.04	N/A	0.0024	41.26190	-76.53151	Jordan	Sonestown
8	Utility Pipeline Crossing	Equipment Access and E&S Controls	Floodway	Floodway to UNT to West Branch Little Muncy Creek	FEBA Detailed	N/A	N/A	N/A	Temporary	N/A	100.00 x 87.38	N/A	0.1035	41.26190	-76.53151	Jordan	Sonestown
9	Utility Pipeline Crossing	Equipment Access and E&S Controls	Floodway	Floodway to UNT to West Branch Little Muncy Creek	FEBA Detailed	N/A	N/A	N/A	Permanent	N/A	61.51 x 5.00	N/A	0.0045	41.26190	-76.53151	Jordan	Sonestown
10	Utility Pipeline Crossing	Equipment Access and E&S Controls	Stream	UNT to West Branch Little Muncy Creek	CMF, EV	N/A	Intermittent	Wild Trout Waters	Temporary	Dam-and-Pump	76.23 x 4.70	N/A	0.0082	41.26185	-76.53251	Jordan	Sonestown
11	Utility Pipeline Crossing	Equipment Access and E&S Controls	Stream	UNT to West Branch Little Muncy Creek	CMF, EV	N/A	Intermittent	Wild Trout Waters	Permanent	Dam-and-Pump	6.28 x 4.70	N/A	0.0005	41.26185	-76.53251	Jordan	Sonestown
12	Utility Pipeline Crossing	Equipment Access and E&S Controls	Floodway	Floodway to UNT to West Branch Little Muncy Creek	Assumed 50 Feet ³	N/A	N/A	N/A	Temporary	N/A	150.12 x 101.95	N/A	0.1380	41.26185	-76.53251	Jordan	Sonestown
13	Utility Pipeline Crossing	Equipment Access and E&S Controls	Floodway	Floodway to UNT to West Branch Little Muncy Creek	Assumed 50 Feet ⁴	N/A	N/A	N/A	Permanent	N/A	128.80 x 5.00	N/A	0.0085	41.26185	-76.53251	Jordan	Sonestown
14	Utility Pipeline Crossing	Equipment Access and E&S Controls	Stream	UNT to West Branch Little Muncy Creek	CMF, EV	N/A	Intermittent	Wild Trout Waters	Temporary	NA	28.25 x 14.39	N/A	0.0087	41.26184	-76.53249	Jordan	Sonestown

CROSSING #1

CROSSING #2

CROSSING #3

Impact Table for Individual Permit Application

Applicant: Transcontinental Gas Pipe-Line Company, LLC (Traseco)
 Project Name: Atlantic Sunrise Project (Project)

Impact Number	Plan Sheet	Description of Impact (Fill, road/utility crossing, grading)	Structure Type and Dimensions	Resource Type (stream, wetland, floodway, body of water)	Resource Name*	Chapter 33 Classification, (Clear, Amend, or Other), or Roadway Type	Wetland (Conservation Classification)	Stream Type (Intermittent, Perennial)	Stream Trout Status (Clear, Wild Trout, Wild Trout Stocked)	Temporary or Permanent Impact	Crossing Method	Impact Dimensions (Length x Width) (feet)	Floodway Fill (cu. Yds.)	Impact area (acres)	Latitude	Longitude	Municipality	USGS Quad
15	1	Utility Pipeline Crossing	Equipment Access and EES Controls	Wetland	W-704-22015C	EV	PFO	N/A	N/A	Temporary ¹	N/A	15.27	2.85	0.0005	41.26204	-76.53286	Jordan	Sonetown
16	1	Utility Pipeline Crossing	Equipment Access and EES Controls	Wetland	W-704-22015A	EV	PEM	N/A	N/A	Temporary	N/A	188.62	75.00	0.1286	41.26182	-76.53290	Jordan	Sonetown
17	1	Utility Pipeline Crossing	Equipment Access and EES Controls	Wetland	W-704-22015A	EV	PEM	N/A	N/A	Permanent	N/A	134.73	5.00	0.0079	41.26182	-76.53290	Jordan	Sonetown
18	3	Utility Pipeline Crossing	Equipment Access and EES Controls	Wetland	W-704-22014A	EV	PEM	N/A	N/A	Temporary	N/A	330.05	42.69	0.2209	41.26206	-76.54771	Franklin	Sonetown
19	3	Utility Pipeline Crossing	Equipment Access and EES Controls	Wetland	W-704-22014A	EV	PEM	N/A	N/A	Permanent	N/A	235.11	5.00	0.0184	41.26206	-76.54771	Franklin	Sonetown
20	3	Utility Pipeline Crossing	Equipment Access and EES Controls	Wetland	W-704-22014C	EV	PFO	N/A	N/A	Temporary ²	N/A	258.63	48.75	0.0917	41.26216	-76.54779	Franklin	Sonetown
21	3	Utility Pipeline Crossing	Equipment Access and EES Controls	Wetland	W-704-22014C	EV	PFO	N/A	N/A	Permanent	N/A	173.88	14.69	0.0353	41.26216	-76.54779	Franklin	Sonetown
22	3	Utility Pipeline Crossing	Equipment Access and EES Controls	Stream	Little Indian Run	CVF, MF	N/A	Perennial	Wild Trout Waters	Temporary	Dam-and-Pump	72.34	14.07	0.0249	41.26211	-76.54800	Franklin	Sonetown
23	3	Utility Pipeline Crossing	Equipment Access and EES Controls	Stream	Little Indian Run	CVF, MF	N/A	Perennial	Wild Trout Waters	Permanent	Dam-and-Pump	5.14	14.07	0.0017	41.26211	-76.54800	Franklin	Sonetown
24	3	Utility Pipeline Crossing	Equipment Access and EES Controls	Floodway	Floodway to Little Indian Run	FEMA Detailed	N/A	N/A	N/A	Temporary	N/A	72.92	9.90	0.0210	41.26211	-76.54800	Franklin	Sonetown
25	3	Utility Pipeline Crossing	Equipment Access and EES Controls	Floodway	Floodway to Little Indian Run	FEMA Detailed	N/A	N/A	N/A	Permanent	N/A	10.56	3.02	0.0004	41.26214	-76.54800	Franklin	Sonetown
26	4	Utility Pipeline Crossing	Equipment Access and EES Controls	Floodway	Floodway to UNT to Little Indian Run	Assumed 50 Feet ³	N/A	N/A	N/A	Temporary	N/A	114.95	91.74	0.0263	41.26226	-76.55057	Franklin	Sonetown
27	4	Utility Pipeline Crossing	Equipment Access and EES Controls	Floodway	Floodway to UNT to Little Indian Run	Assumed 50 Feet ³	N/A	N/A	N/A	Permanent	N/A	112.08	5.00	0.0061	41.26226	-76.55057	Franklin	Sonetown
28	4	Utility Pipeline Crossing	Equipment Access and EES Controls	Wetland	W-704-22013A	EV	PEM	N/A	N/A	Temporary	N/A	145.84	30.50	0.0557	41.26218	-76.55039	Franklin	Sonetown

Crossing # 3

Crossing # 4

Crossing # 5

Impact Table for Individual Permit Application

Applicant: Transcontinental Gas Pipe Line Company, LLC (Traseco)
 Project Name: Atlantic Sunrise Project (Project)

Impact Number	Plan Sheet	Description of Impact (Fill, road/utility crossing, grading)	Structure Type and Dimensions	Resource Type and Location (Stream, wetland, floodway, body of water)	Resource Name*	Character 83 Classification, Wetland Classification (EV or Other), or Floodway Type	Wetland (Cowardin Classification)	Stream Type (Intermittent, perennial)	Stream Trout Status (Class A Wild Trout, Wild Trout, Trout Stocked)	Temporary or Permanent Impact	Crossing Method	Impact Dimensions (Length x Width) (Feet)		Floodway Fill (cu. Yds.)	Impact area (acres)	Latitude	Longitude	Municipality	USGS Quad
												Length	Width						
29	4	Utility Pipeline Crossing	Equipment Access and EES Controls	Stream	UNT to Little Indian Run	CWF, MF	N/A	Perennial	Wild Trout Waters	Temporary	Dam-and-Pump	71.53	11.64	N/A	0.0177	41.26226	-76.56057	Franklin	Sonestown
30	4	Utility Pipeline Crossing	Equipment Access and EES Controls	Stream	UNT to Little Indian Run	CWF, MF	N/A	Perennial	Wild Trout Waters	Permanent	Dam-and-Pump	5.04	11.64	N/A	0.0013	41.26226	-76.56057	Franklin	Sonestown
31	4	Utility Pipeline Crossing	Equipment Access and EES Controls	Wetland	W-701-22013C	EV	PFO	N/A	N/A	Temporary	N/A	65.31	53.04	N/A	0.0918	41.26229	-76.56072	Franklin	Sonestown
32	4	Utility Pipeline Crossing	Equipment Access and EES Controls	Wetland	W-701-22013C	EV	PFO	N/A	N/A	Permanent	N/A	53.34	13.00	N/A	0.0049	41.26229	-76.56072	Franklin	Sonestown
33	4	Utility Pipeline Crossing	Equipment Access and EES Controls	Stream	UNT to Little Indian Run	CWF, MF	N/A	Intermittent	Wild Trout Waters	Temporary	Dam-and-Pump	96.37	5.28	N/A	0.0095	41.26233	-76.56067	Franklin	Sonestown
34	4	Utility Pipeline Crossing	Equipment Access and EES Controls	Stream	UNT to Little Indian Run	CWF, MF	N/A	Intermittent	Wild Trout Waters	Permanent	Dam-and-Pump	5.30	5.28	N/A	0.0006	41.26233	-76.56067	Franklin	Sonestown
35	5	Utility Pipeline Crossing	Equipment Access and EES Controls	Stream	UNT to Little Indian Run	CWF, MF	N/A	Intermittent	Wild Trout Waters	Temporary	Dam-and-Pump	97.48	17.37	N/A	0.0361	41.26269	-76.56680	Franklin	Sonestown
36	5	Utility Pipeline Crossing	Equipment Access and EES Controls	Stream	UNT to Little Indian Run	CWF, MF	N/A	Intermittent	Wild Trout Waters	Permanent	Dam-and-Pump	5.64	17.37	N/A	0.0020	41.26269	-76.56680	Franklin	Sonestown
37	5	Utility Pipeline Crossing	Equipment Access and EES Controls	Floodway	Floodway to UNT to Little Indian Run	Assumed 50 Feet	N/A	N/A	N/A	Temporary	N/A	124.87	81.82	N/A	0.0913	41.26269	-76.56680	Franklin	Sonestown
38	5	Utility Pipeline Crossing	Equipment Access and EES Controls	Floodway	Floodway to UNT to Little Indian Run	Assumed 50 Feet	N/A	N/A	N/A	Permanent	N/A	50.39	5.00	N/A	0.0057	41.26269	-76.56680	Franklin	Sonestown
39	5	Utility Pipeline Crossing	Equipment Access and EES Controls	Wetland	W-701-22012	EV	PEM	N/A	N/A	Temporary	N/A	284.40	91.81	N/A	0.3548	41.26270	-76.57002	Franklin	Sonestown
40	5	Utility Pipeline Crossing	Equipment Access and EES Controls	Wetland	W-701-22012	EV	PEM	N/A	N/A	Permanent	N/A	273.30	5.00	N/A	0.0227	41.26270	-76.57002	Franklin	Sonestown
41	6	Utility Pipeline Crossing	Equipment Access and EES Controls	Stream	UNT Beaver Run	CWF, MF	N/A	Perennial	Wild Trout Waters	Temporary	Dam-and-Pump	105.04	40.51	N/A	0.0914	41.26327	-76.58225	Franklin	Sonestown
42	6	Utility Pipeline Crossing	Equipment Access and EES Controls	Stream	UNT Beaver Run	CWF, MF	N/A	Perennial	Wild Trout Waters	Permanent	Dam-and-Pump	5.02	40.61	N/A	0.0047	41.26327	-76.58225	Franklin	Sonestown
43	5	Utility Pipeline Crossing	Equipment Access and EES Controls	Floodway	Floodway to UNT Beaver Run	FEWA Detailed	N/A	N/A	N/A	Temporary	N/A	159.33	40.65	N/A	0.0204	41.26327	-76.58225	Franklin	Sonestown

Crossing # 5

Crossing # 6

Crossing # 7

Impact Table for Individual Permit Application

Applicant: Transcontinental Gas Pipe Line Company, LLC (Transex)
 Project Name: Atlantic Sunrise Project (Project)

Impact Number	Plan Sheet Number	Description of Impact (fill, road/utility crossing, grading)	Structure Type and Dimensions	Resource Type (stream, wetland, roadway, body of water)	Resource Name*	Chapter 93 Classification, Wetland Classification (EV or Other), or Floodway Type	Wetland (Cowardin Classification)	Stream Type (Intermittent, Perennial)	Stream Trout Status (Class A Wild Trout, Wild Trout, Trout Stocked)	Temporary or Permanent Impact	Crossing Method	Impact Dimensions (Length x Width) (Feet)	Floodway Fill (cu. Yds.)	Impact Area (Acres)	Latitude	Longitude	Municipality	USGS Quad
44	5	Utility Pipeline Crossing	Equipment Access and EES Controls	Floodway	Floodway to UNT Beaver Run	FEMA Detailed	N/A	N/A	N/A	Permanent	N/A	9.21	N/A	0.0007	41.26327	-76.59225	Franklin	Sonestown
45	5	Utility Pipeline Crossing	Equipment Access and EES Controls	Wetland	W-704-2201A-3	EV	PEM	N/A	N/A	Temporary	N/A	53.90	N/A	0.0095	41.26321	-76.59238	Franklin	Sonestown
46	5	Utility Pipeline Crossing	Equipment Access and EES Controls	Wetland	W-704-2201A-3	EV	PEM	N/A	N/A	Permanent	N/A	7.12	N/A	0.0004	41.26321	-76.59238	Franklin	Sonestown
47	7	Utility Pipeline Crossing	Equipment Access and EES Controls	Wetland	W-704-2201C	EV	PFD	N/A	N/A	Temporary	N/A	75.44	N/A	0.0483	41.26393	-76.59242	Franklin	Sonestown
48	7	Utility Pipeline Crossing	Equipment Access and EES Controls	Wetland	W-704-2201C	EV	PFD	N/A	N/A	Permanent	N/A	46.81	N/A	0.0086	41.26393	-76.59242	Franklin	Sonestown
49	7	Utility Pipeline Crossing	Equipment Access and EES Controls	Wetland	W-704-2201A	EV	PEM	N/A	N/A	Temporary	N/A	170.96	N/A	0.0394	41.26381	-76.59237	Franklin	Sonestown
50	7	Utility Pipeline Crossing	Equipment Access and EES Controls	Wetland	W-704-2201A	EV	PEM	N/A	N/A	Permanent	N/A	74.86	N/A	0.0392	41.26381	-76.59237	Franklin	Sonestown
51	7	Utility Pipeline Crossing	Equipment Access and EES Controls	Floodway	Floodway to Beaver Run	FEMA Detailed	N/A	N/A	N/A	Temporary	N/A	149.28	N/A	0.0860	41.26391	-76.59270	Franklin	Sonestown
52	7	Utility Pipeline Crossing	Equipment Access and EES Controls	Floodway	Floodway to Beaver Run	FEMA Detailed	N/A	N/A	N/A	Permanent	N/A	99.47	N/A	0.0043	41.26391	-76.59270	Franklin	Sonestown
53	7	Utility Pipeline Crossing	Equipment Access and EES Controls	Stream	Beaver Run	CWF, MF	N/A	Perennial	Wild Trout Waters	Temporary	Dam-and-Pump	114.12	N/A	0.1372	41.26391	-76.59270	Franklin	Sonestown
54	7	Utility Pipeline Crossing	Equipment Access and EES Controls	Stream	Beaver Run	CWF, MF	N/A	Perennial	Wild Trout Waters	Permanent	Dam-and-Pump	5.73	N/A	0.0069	41.26391	-76.59270	Franklin	Sonestown
55	9	Utility Pipeline Crossing	Equipment Access and EES Controls	Stream	UNT to Beaver Run	CWF, MF	N/A	Intermittent	Wild Trout Waters	Temporary	Dam-and-Pump	59.35	N/A	0.0314	41.26475	-76.60401	Penn	Sonestown
56	9	Utility Pipeline Crossing	Equipment Access and EES Controls	Stream	UNT to Beaver Run	CWF, MF	N/A	Perennial	Wild Trout Waters	Temporary	Dam-and-Pump	100.16	N/A	0.0526	41.26465	-76.60409	Penn	Sonestown
57	9	Utility Pipeline Crossing	Equipment Access and EES Controls	Stream	UNT to Beaver Run	CWF, MF	N/A	Perennial	Wild Trout Waters	Permanent	Dam-and-Pump	5.15	N/A	0.0084	41.26465	-76.60409	Penn	Sonestown
58	9	Utility Pipeline Crossing	Equipment Access and EES Controls	Floodway	Floodway to UNT to Beaver Run	Assumed 30 Feet	N/A	N/A	N/A	Temporary	N/A	244.20	N/A	0.3143	41.26465	-76.60409	Penn	Sonestown

Crossing # 7

Crossing # 8

Crossing # 9

Impact Table for Individual Permit Application

Applicant: Transcontinental Gas Pipe Line Company, LLC (Transco)
 Project Name: Atlantic Sunrise Project (Project)

Impact Number	Plan Sheet	Description of Impact (Fill, road/utility crossing, grading)	Structure Type and Dimensions	Resource Type (Stream, wetland, floodway, utility or other)	Resource Name*	Channel or Wetland Classification (Other) or Floodway Type	Wetland (Swamp) Classification	Stream Type (Intermittent, perennial)	Stream Trout Status (Class A Wild Trout, Wild Trout, Trout Stocked)	Temporary or Permanent Impact	Crossing Method	Impact Dimensions (Length x Width) (Feet)	Floodway Fill (cu. yds.)	Impact area (acres)	Latitude	Longitude	Municipality	USGS Quad
59	9	Utility Pipeline Crossing	Equipment Access and E&S Controls	Floodway	Floodway to UNT to Beaver Run	Assumed 50 Feet	N/A	N/A	N/A	Permanent	N/A	167.07	5.00	0.0151	41.26465	-76.60409	Penn	Sonnetown
60	9	Utility Pipeline Crossing	Equipment Access and E&S Controls	Stream	UNT to Beaver Run	CHF, MF	N/A	Perennial	Wild Trout Waters	Temporary	Dam-and-Pump	165.66	16.28	0.0503	41.26470	-76.60449	Penn	Sonnetown
61	9	Utility Pipeline Crossing	Equipment Access and E&S Controls	Stream	UNT to Beaver Run	CHF, MF	N/A	Perennial	Wild Trout Waters	Permanent	Dam-and-Pump	6.64	16.28	0.0019	41.26470	-76.60449	Penn	Sonnetown
62	9	Utility Pipeline Crossing	Equipment Access and E&S Controls	Wetland	W-701-22009 / W-701-22009-1	EV	PEM	N/A	N/A	Temporary	N/A	259.65	100.30	0.2422	41.26469	-76.60473	Penn	Sonnetown
63	9	Utility Pipeline Crossing	Equipment Access and E&S Controls	Wetland	W-701-22009 / W-701-22009-1	EV	PEM	N/A	N/A	Permanent	N/A	220.79	5.00	0.0154	41.26469	-76.60473	Penn	Sonnetown
64	10	Utility Pipeline Crossing	Equipment Access and E&S Controls	Wetland	W-701-22008	N/A	PEM	N/A	N/A	Temporary	N/A	98.54	0.28	0.0061	41.26469	-76.61693	Penn	Sonnetown
65	10	Utility Pipeline Crossing	Equipment Access and E&S Controls	Wetland	W-701-22007	N/A	PEM	N/A	N/A	Temporary	N/A	28.46	17.35	0.0054	41.26496	-76.61570	Penn	Sonnetown
66	10	Utility Pipeline Crossing	Equipment Access and E&S Controls	Stream	UNT Big Run	CHF, MF	N/A	Intermittent	N/A	Temporary	N/A	55.84	2.94	0.0093	41.26468	-76.61696	Penn	Sonnetown
67	10	Utility Pipeline Crossing	Equipment Access and E&S Controls	Wetland	W-701-22004	N/A	PEM	N/A	N/A	Temporary	N/A	130.79	72.48	0.1057	41.26472	-76.61879	Penn	Sonnetown
68	10	Utility Pipeline Crossing	Equipment Access and E&S Controls	Wetland	W-701-22004	N/A	PEM	N/A	N/A	Permanent	N/A	11.01	5.00	0.0011	41.26472	-76.61879	Penn	Sonnetown
69	10	Utility Pipeline Crossing	Equipment Access and E&S Controls	Floodway	Floodway to UNT Big Run	Assumed 50 Feet	N/A	N/A	N/A	Temporary	N/A	792.92	98.79	0.5615	41.26480	-76.61851	Penn	Sonnetown
70	10	Utility Pipeline Crossing	Equipment Access and E&S Controls	Floodway	Floodway to UNT Big Run	Assumed 50 Feet	N/A	N/A	N/A	Permanent	N/A	240.72	5.00	0.0239	41.26480	-76.61851	Penn	Sonnetown
71	10	Utility Pipeline Crossing	Equipment Access and E&S Controls	Wetland	W-701-22006	N/A	PEM	N/A	N/A	Temporary	N/A	239.46	88.03	0.1491	41.26491	-76.62049	Penn	Sonnetown
72	10	Utility Pipeline Crossing	Equipment Access and E&S Controls	Wetland	W-701-22006	N/A	PEM	N/A	N/A	Permanent	N/A	169.90	5.00	0.0107	41.26491	-76.62049	Penn	Sonnetown
73	10	Utility Pipeline Crossing	Equipment Access and E&S Controls	Stream	UNT Big Run	CHF, MF	N/A	Perennial	N/A	Temporary	Dam-and-Pump	211.30	36.39	0.0619	41.26494	-76.62088	Penn	Sonnetown

Crossing #9

Crossing #10

Crossing #11

Crossing #12

Impact Table for Individual Permit Application

Applicant: Transcontinental Gas Pipe Line Company, LLC (TranSCO)
 Project Name: Atlantic Sunrise Project (Project)

Impact Number	Plan Sheet	Description of Impact (fill, road/utility crossing, grading)	Structure Type and Dimensions	Resource Type (Stream, wetland, floodway, body of water)	Resource Name*	Channel, Wetland Classification (EV or Other), or Floodway Type	Wetland (Covarian Classification)	Stream Type (Intermittent, Perennial)	Stream Trout Status (Class A Wild Trout, Wild Trout, Trout Stocked)	Temporary or Permanent Impact	Crossing Method	Impact Dimensions (Length x Width) (feet)	Floodway Fill (cu. Yds)	Impact Area (Acres)	Latitude	Longitude	Municipality	USGS Quad
74	10	Utility Pipeline Crossing	Equipment Access and EES Controls	Stream	UNT Big Run	CWF, MF	N/A	Perennial	N/A	Permanent	Dam-and-Pump	10.82	36.58	0.0047	41.26494	-76.62088	Penn	Sonctown
75	10	Utility Pipeline Crossing	Equipment Access and EES Controls	Floodway	Floodway to UNT Big Run*	Assumed 50 Feet	N/A	N/A	N/A	Temporary	N/A	524.20	99.66	0.4130	41.26494	-76.62088	Penn	Sonctown
76	10	Utility Pipeline Crossing	Equipment Access and EES Controls	Floodway	Floodway to UNT Big Run*	Assumed 50 Feet	N/A	N/A	N/A	Permanent	N/A	162.32	5.00	0.0137	41.26494	-76.62088	Penn	Sonctown
77	11	Utility Pipeline Crossing	Equipment Access and EES Controls	Wetland	W-701-22005A	None	FEM	N/A	N/A	Temporary	N/A	249.94	89.49	0.4154	41.26503	-76.62218	Penn	Sonctown
78	11	Utility Pipeline Crossing	Equipment Access and EES Controls	Wetland	W-701-22005A	None	FEM	N/A	N/A	Permanent	N/A	249.65	5.00	0.0703	41.26503	-76.62218	Penn	Sonctown
79	11	Utility Pipeline Crossing	Equipment Access and EES Controls	Wetland	W-701-22005C	None	PFO	N/A	N/A	Temporary	N/A	9.25	0.25	<0.0001	41.26516	-76.62231	Penn	Sonctown
80	11	Utility Pipeline Crossing	Equipment Access and EES Controls	Stream	Big Run	CWF, MF	N/A	Perennial	N/A	Temporary	Dam-and-Pump	85.83	19.72	0.0276	41.26506	-76.62246	Penn	Sonctown
81	11	Utility Pipeline Crossing	Equipment Access and EES Controls	Stream	Big Run	CWF, MF	N/A	Perennial	N/A	Permanent	Dam-and-Pump	6.51	19.72	0.0022	41.26506	-76.62246	Penn	Sonctown
82	11	Utility Pipeline Crossing	Equipment Access and EES Controls	Floodway	Floodway to Big Run	Assumed 50 Feet	N/A	N/A	N/A	Temporary	N/A	148.38	18.15	0.0037	41.26506	-76.62246	Penn	Sonctown
83	11	Utility Pipeline Crossing	Equipment Access and EES Controls	Floodway	Floodway to UNT Big Run	Assumed 50 Feet	N/A	N/A	N/A	Temporary	N/A	282.23	69.02	0.3753	41.26527	-76.62310	Penn	Picture Rocks
84	11	Utility Pipeline Crossing	Equipment Access and EES Controls	Floodway	Floodway to UNT Big Run	Assumed 50 Feet	N/A	N/A	N/A	Permanent	N/A	379.26	6.00	0.0389	41.26527	-76.62310	Penn	Picture Rocks
85	11	Utility Pipeline Crossing	Equipment Access and EES Controls	Wetland	W-701-22004	None	FEM	N/A	N/A	Temporary	N/A	144.13	6.79	0.0052	41.26558	-76.62298	Penn	Picture Rocks
86	11	Utility Pipeline Crossing	Equipment Access and EES Controls	Floodway	Floodway to UNT Big Run	Assumed 50 Feet	N/A	N/A	N/A	Temporary	N/A	346.65	32.99	0.0099	41.2654882	-76.6233856	Penn	Picture Rocks
87	13	Utility Pipeline Crossing	Equipment Access and EES Controls	Stream	UNT to Sugar Run	CWF, MF	N/A	Intermittent	Wild Trout Waters (under review)	Temporary	Dam-and-Pump	88.86	9.25	0.0193	41.2649025	-76.6224567	Penn	Picture Rocks
88	13	Utility Pipeline Crossing	Equipment Access and EES Controls	Stream	UNT to Sugar Run	CWF, MF	N/A	Intermittent	Wild Trout Waters (under review)	Permanent	Dam-and-Pump	5.13	9.25	0.0011	41.2649025	-76.6224567	Penn	Picture Rocks

Crossing #12

Crossing #13

Crossing #14

Crossing #15

Impact Table for Individual Permit Application

Applicant: Transcontinental Gas Pipe Line Company, LLC (Tranco)
 Project Name: Atlantic Sunrise Project (Project)

Impact Number	Plan Sheet	Description of Impact (fill, road/utility crossing, grading)	Structure Type and Dimensions	Resource Type (stream, wetland, floodway, body of water)	Resource Name*	Chapter 93 Classification, Wetland Classification (EV or Other), or Floodway Type	Wetland (Cowardin Classification)	Stream Type (Intermittent, Perennial)	Stream Trout Status (Class Wild Trout, Wild Trout, Trout Stocked)	Temporary or Permanent Impact	Crossing Method	Impact Dimensions (Length x Width) (feet)	Roadway Fill (cu. yds.)	Impact Area (acres)	Latitude	Longitude	Municipality	USGS Quad
89	13	Utility Pipeline Crossing	Equipment Access and EES Controls	Floodway	Floodway to UNT to Sugar Run	Assumed 50 Feet	N/A	N/A	N/A	Temporary	N/A	222.95	N/A	0.1941	41.26643025	-76.6424557	Penn	Picture Rocks
90	13	Utility Pipeline Crossing	Equipment Access and EES Controls	Floodway	Floodway to UNT to Sugar Run	Assumed 50 Feet	N/A	N/A	N/A	Permanent	N/A	111.12	N/A	0.0097	41.26643025	-76.6424567	Penn	Picture Rocks
91	13	Utility Pipeline Crossing	Equipment Access and EES Controls	Wetland	W-704-22001	EV	PBM	N/A	N/A	Temporary	N/A	77.03	N/A	0.0308	41.26646709	-76.6423959	Penn	Picture Rocks
92	13	Utility Pipeline Crossing	Equipment Access and EES Controls	Wetland	W-704-22001	EV	PBM	N/A	N/A	Permanent	N/A	18.19	N/A	0.0019	41.26646709	-76.6423959	Penn	Picture Rocks
93	14	Utility Pipeline Crossing	Equipment Access and EES Controls	Floodway	Floodway to Sugar Run	FEMA Detailed	N/A	N/A	N/A	Temporary	N/A	273.12	N/A	0.3368	41.26659504	-76.65859986	Penn	Picture Rocks
94	14	Utility Pipeline Crossing	Equipment Access and EES Controls	Floodway	Floodway to Sugar Run	FEMA Detailed	N/A	N/A	N/A	Permanent	N/A	246.52	N/A	0.0237	41.26659504	-76.65859986	Penn	Picture Rocks
95	14	Utility Pipeline Crossing	Equipment Access and EES Controls	Stream	Sugar Run	CWF, MF	N/A	Perennial	Wild Trout Waters (under review)	Temporary	Dam-and-Pump	95.94	N/A	0.0449	41.26659504	-76.65859986	Penn	Picture Rocks
96	14	Utility Pipeline Crossing	Equipment Access and EES Controls	Stream	Sugar Run	CWF, MF	N/A	Perennial	Wild Trout Waters (under review)	Permanent	Dam-and-Pump	5.01	N/A	0.0022	41.26659504	-76.65859986	Penn	Picture Rocks
97	15	Utility Pipeline Crossing	Equipment Access and EES Controls	Wetland	W-765-27001A	EV	PSS	N/A	N/A	Temporary	N/A	1.40	N/A	<0.0001	41.26733815	-76.65971383	Penn	Picture Rocks
98	15	Utility Pipeline Crossing	Equipment Access and EES Controls	Wetland	W-765-27001A	EV	PBM	N/A	N/A	Temporary	N/A	13.76	N/A	0.0012	41.26733815	-76.6596229	Penn	Picture Rocks
99	15	Utility Pipeline Crossing	Equipment Access and EES Controls	Stream	UNT to Sugar Run	CWF, MF	N/A	Perennial	Wild Trout Waters (under review)	Temporary		88.63	N/A	0.0182	41.26709328	-76.65991795	Penn	Picture Rocks
100	15	Utility Pipeline Crossing	Equipment Access and EES Controls	Stream	UNT to Sugar Run	CWF, MF	N/A	Perennial	Wild Trout Waters (under review)	Permanent		5.07	N/A	0.0010	41.26709328	-76.65991795	Penn	Picture Rocks
101	15	Utility Pipeline Crossing	Equipment Access and EES Controls	Floodway	Floodway to UNT to Sugar Run	Assumed 50 Feet	N/A	N/A	N/A	Temporary	N/A	200.04	N/A	0.5592	41.26709328	-76.65991795	Penn	Picture Rocks
102	15	Utility Pipeline Crossing	Equipment Access and EES Controls	Floodway	Floodway to UNT to Sugar Run	Assumed 50 Feet	N/A	N/A	N/A	Permanent	N/A	305.89	N/A	0.0340	41.26709328	-76.65991795	Penn	Picture Rocks
103	15	Utility Pipeline Crossing	Equipment Access and EES Controls	Stream	UNT to Sugar Run	CWF, MF	N/A	Intermittent	Wild Trout Waters (under review)	Temporary		214.04	N/A	0.0235	41.26709328	-76.65028224	Penn	Picture Rocks

Crossing # 15

Crossing # 16

Crossing # 17

Impact Table for Individual Permit Application

Applicant: Transcontinental Gas Pipe Line Company, LLC (Transtar)
 Project Name: Atlantic Sunrise Project (Project)

Impact Number	Plan Sheet	Description of Impact (Fill, road/utility crossing, grading)	Structure Type and Dimensions	Resource Type (Stream, wetland, floodway, body of water)	Resource Name*	Channel 93 Classification, Wetland Classification (EV or Other), or Floodway Type	Wetland/Conservation Classification	Stream Type (Intermittent, Perennial)	Stream Trout Status (Class A Wild Trout, Wild Trout, Trout Stocked)	Temporary or Permanent Impact	Crossing Method	Impact Dimensions (Length x Width) (feet)	Floodway Fill (cu. yds.)	Impact Area (acres)	Latitude	Longitude	Municipality	USGS Quad
97		Utility-pipeline-crossing	Equipment Access and E&S Controls	Stream	Gregg Run	CWF-MF	N/A	Perennial	Wild Trout Stocked (Wilde-Covey)	Temporary	N/A	46.46	N/A	0.0047	42.2942	-76.6949	Penn	Picture Rocks
98		Utility-pipeline-crossing	Equipment Access and E&S Controls	Floodway	Floodway to Gregg Run	Assumed 50 Feet	N/A	N/A	N/A	Temporary	N/A	36.88	N/A	0.0493	42.2942	-76.6949	Penn	Picture Rocks
104	18	Contractor Staging Area	Equipment Access and E&S Controls	Floodway	Floodway to Greg's Run	FEMA Detailed	N/A	N/A	N/A	Temporary	N/A	733.80	N/A	1.1392	41.7670	-76.69109	Penn	Picture Rocks
105	19	Contractor Staging Area	Equipment Access and E&S Controls	Floodway	Floodway to UNT to Greg's Run	Assumed 50 Feet	N/A	N/A	N/A	Temporary	N/A	159.52	N/A	0.1207	41.76828	-76.68895	Penn	Picture Rocks
106	22	Road Crossing	Equipment Access and E&S Controls	Floodway	Floodway to UNT to Beaver Run	Assumed 50 Feet	N/A	N/A	N/A	Temporary	N/A	135.19	N/A	0.0351	41.26522	-76.53002	Franklin	Sonctown
107	14	Road Crossing	Equipment Access and E&S Controls	Floodway	Floodway to Sugar Run	FEMA Detailed	N/A	N/A	N/A	Temporary	N/A	185.22	N/A	0.1849	41.26570	-76.65584	Penn	Picture Rocks
108		Stream Channel Fill (filling existing stream channel and relocating elsewhere in the floodplain)	NA	Stream	UNT1	HQ-CWF	NA	Perennial	Wild Trout	Permanent	NA	191.61	232.62 (FILL)	0.2100	77°11'13.86" W	41°18'26.05" N	Anthony Township	Sallashburg
109		Stream enhancement (installing small log structures/woody debris to enhance habitat)	NA	Stream	UNT1	HQ-CWF	NA	Perennial	Wild Trout	Temporary	NA	322.40	0	0.0500	77°11'13.93" W	41°18'26.71" N	Anthony Township	Sallashburg
110		Stream Relocation - Areas where existing wetlands will be graded into the existing stream as part of the stream relocation.	NA	Wetland	W1	HQ-CWF	PEW	NA	Wild Trout	Permanent	NA	NA	99.07 (CUT)	0.1100	77°11'20.98" W	41°18'22.84" N	Anthony Township	Sallashburg
111		Wetland rehabilitation - minor wetland grading.	NA	Wetland	W1	HQ-CWF	PEW	NA	Wild Trout	Temporary	NA	NA	598.76 (CUT)	2.1300	77°11'19.88" W	41°18'23.16" N	Anthony Township	Sallashburg

* Temporary Impacts to PFD wetlands include temporal conversion from forested to scrub-shrub or emergent wetland. All impacts to PFD wetlands are within the temporary construction ROW; therefore, the wetland will be restored to PFD wetland. Include temporal conversion from forested to scrub-shrub or emergent wetland. Within this wetland, a 30-foot-wide corridor centered over the pipeline will be permanently converted.

CROSSING 21
 FROM MITIGATION
 STRIP